

.mdd

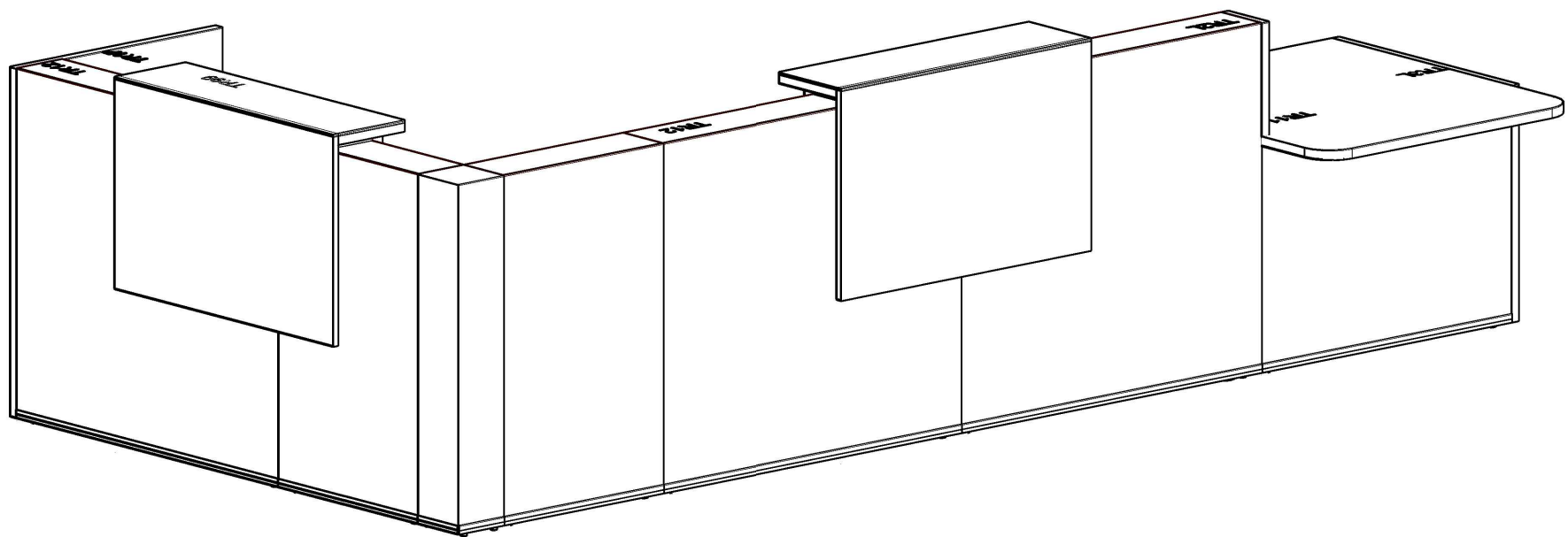

TRA44P

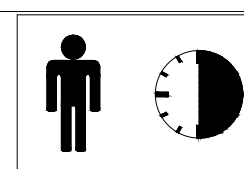

KOLEJNOŚĆ MONTAŻU
MIMOŚRODÓW.

THE FITTINGS SEQUENCE OF THE
CAMs.

DIE MONTAGEABFOLGE VON
EXZENTERN.

A

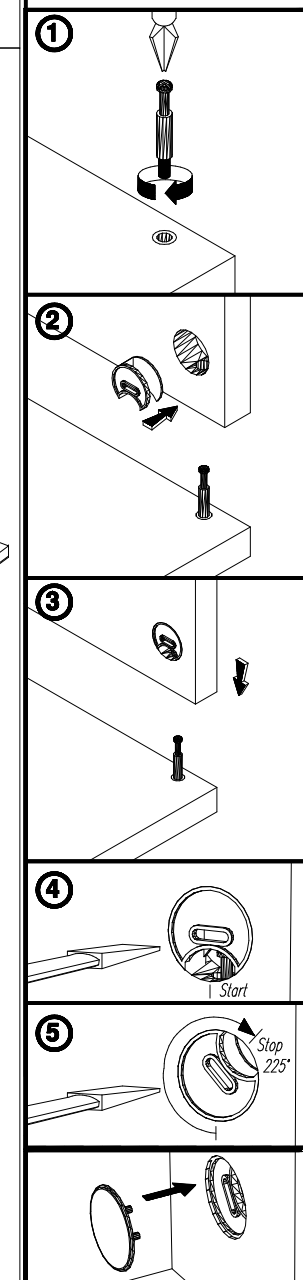
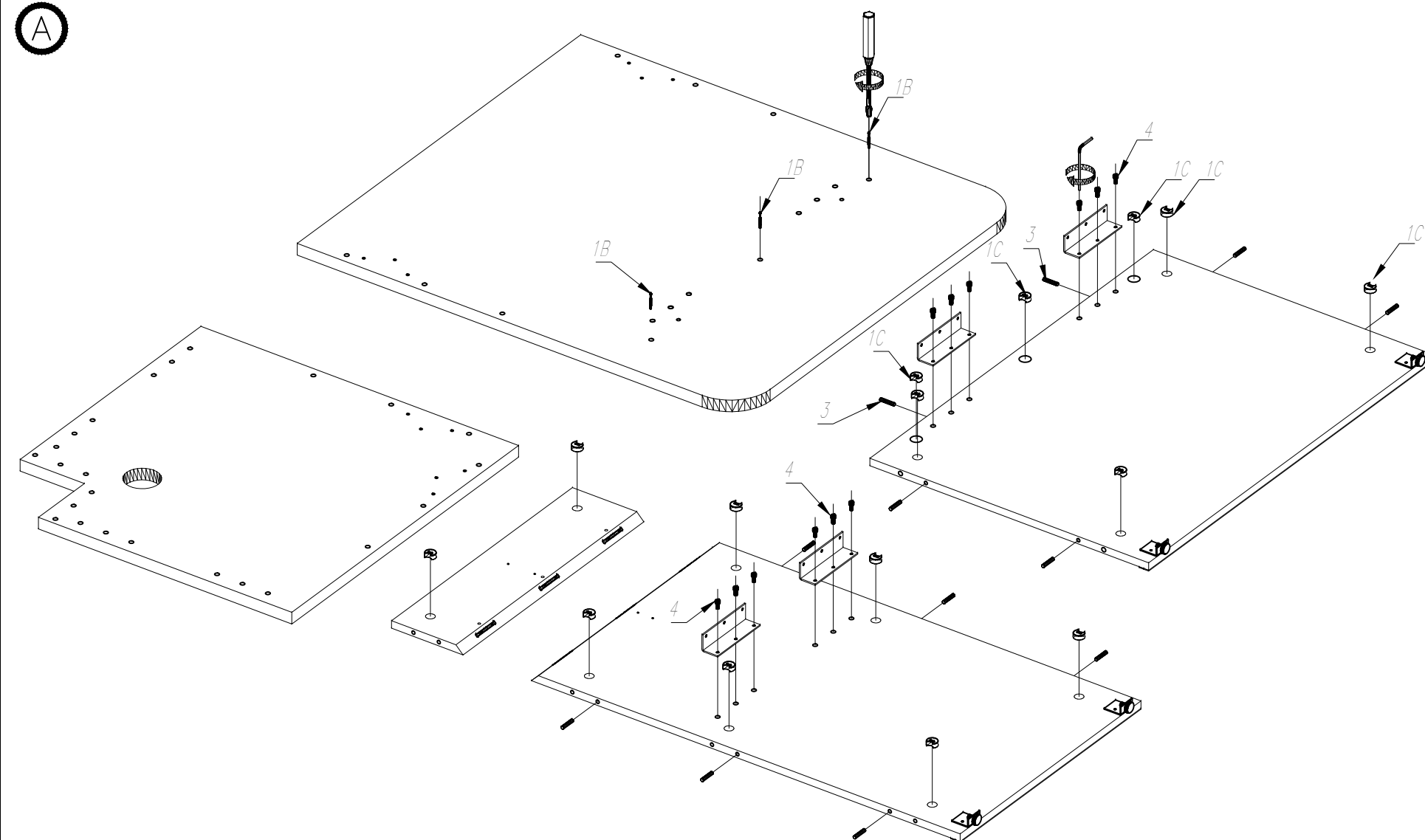



E

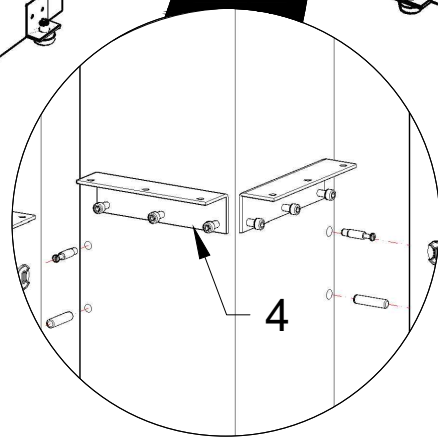
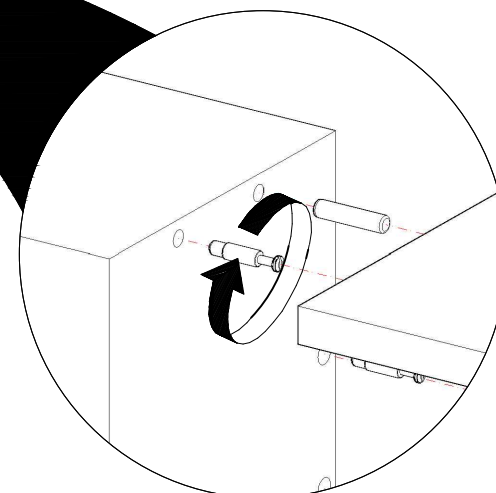
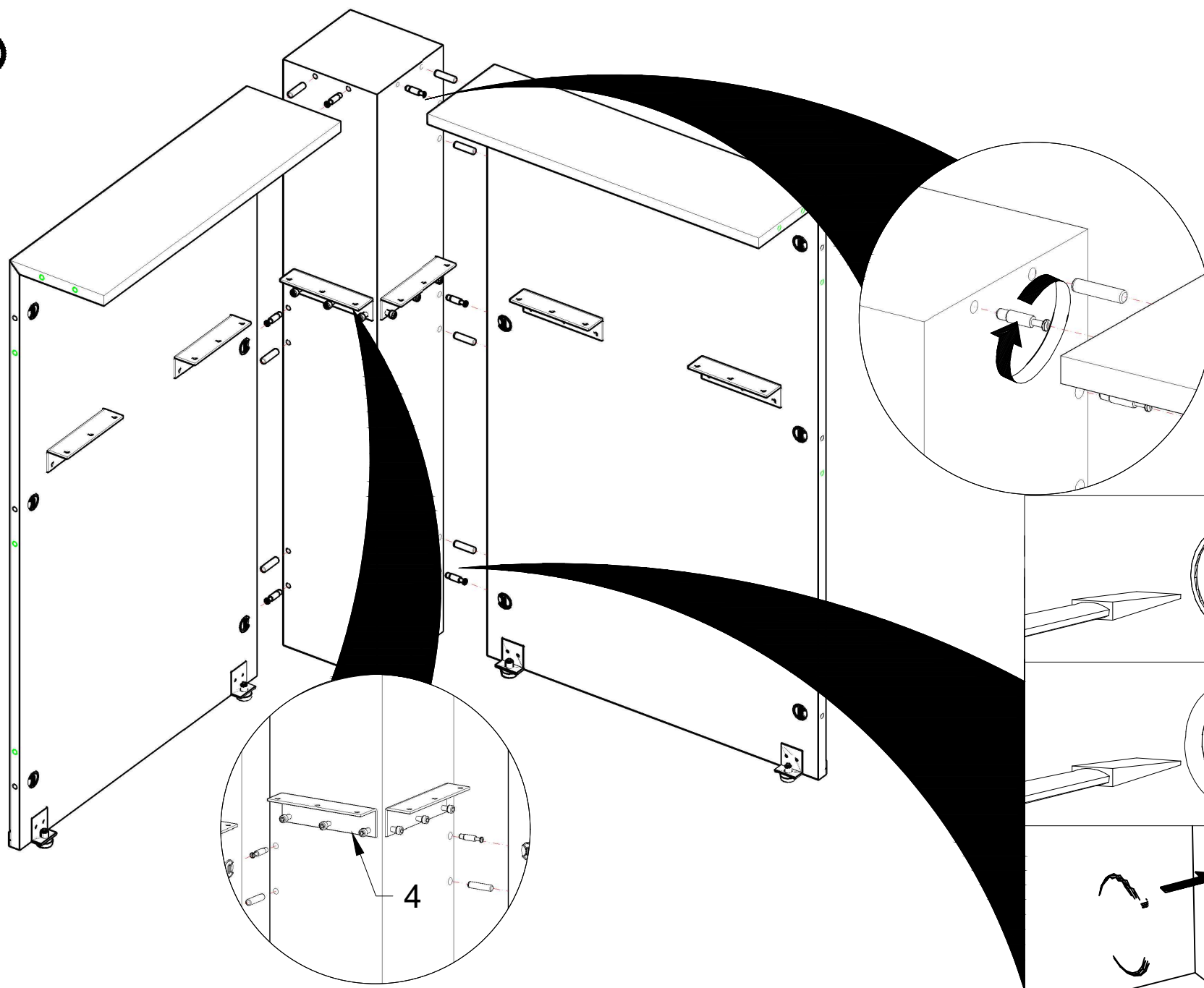

4

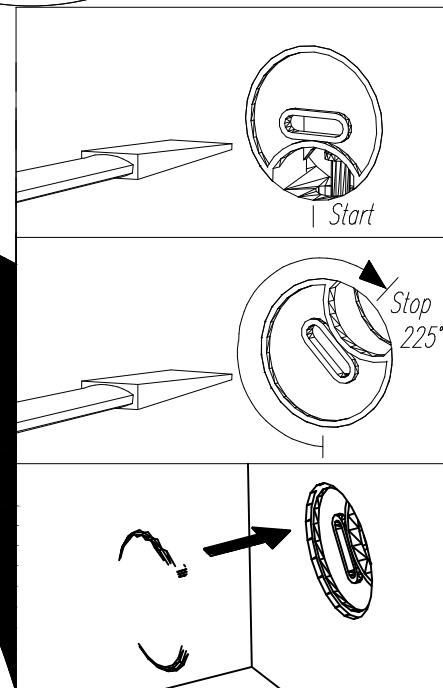

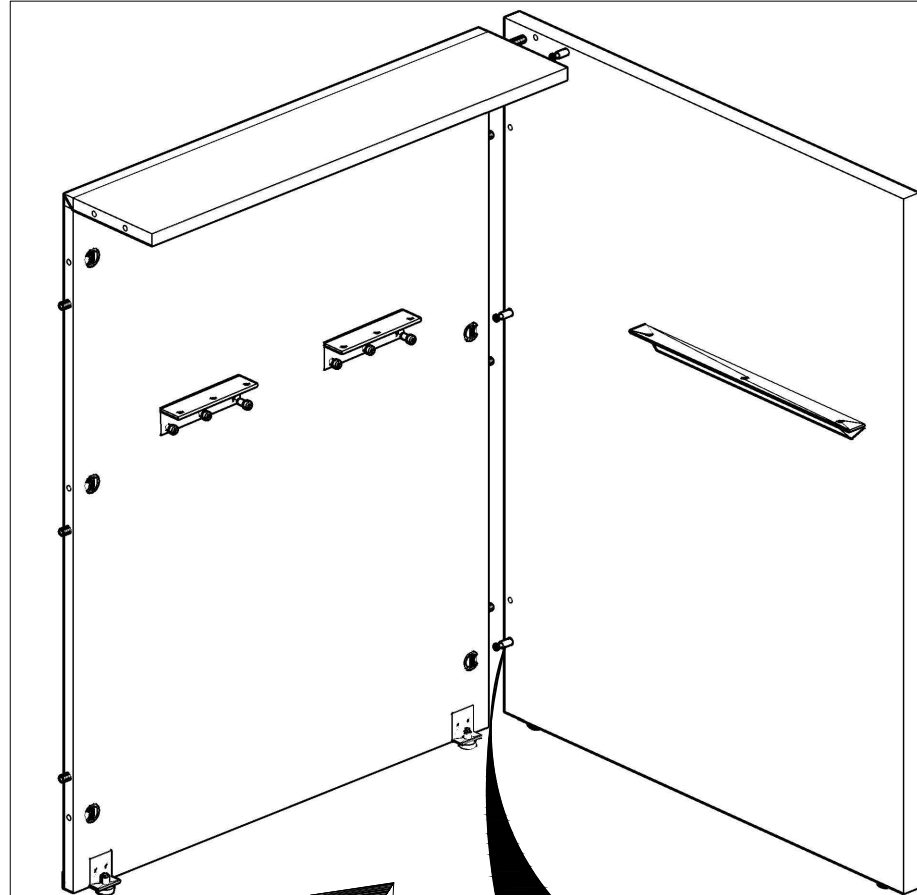

- VOLGENDE MONTELUU
 AANSLUITINGEN
 THE FITTING SEQUENCE OF THE
 CHMS
 DIE MONTAGEFOLGE VON
 EXZENTRIK
1. Insert the eccentric into the hole in the side panel.
 2. Tighten the screw to secure the eccentric.
 3. Insert the top panel into the top rail.
 4. Tighten the screw to secure the top panel.
 5. Insert the back panel into the back rail.
 6. Tighten the screw to secure the back panel.
 7. Insert the bottom panel into the bottom rail.
 8. Tighten the screw to secure the bottom panel.

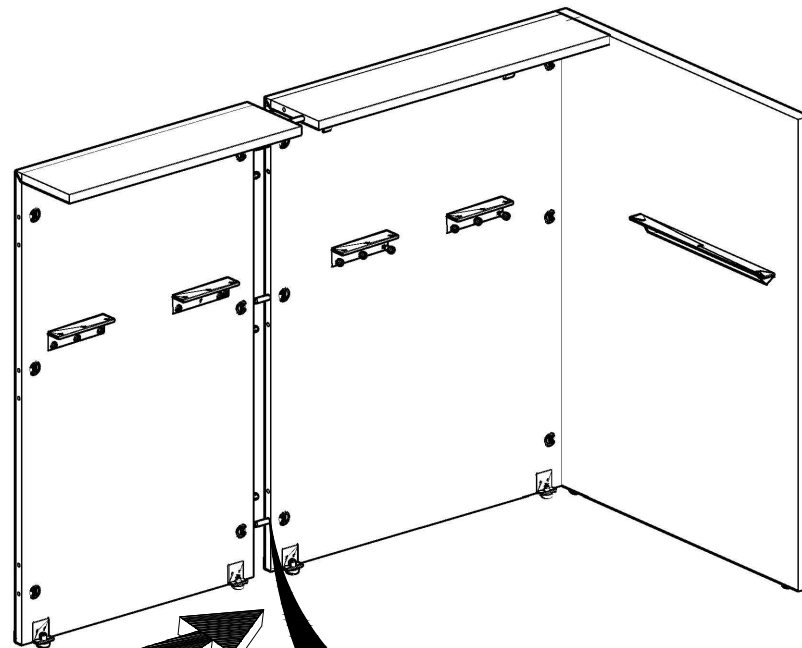
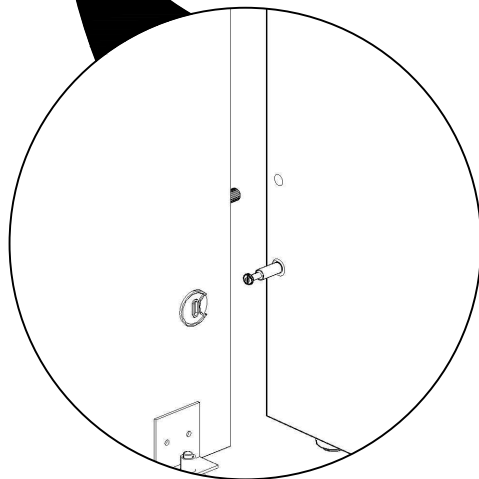

- VOLGENDE MONTELUU
 AANSLUITINGEN
 THE FITTING SEQUENCE OF THE
 CHMS
 DIE MONTAGEFOLGE VON
 EXZENTRIK
1. Insert the eccentric into the hole in the side panel.
 2. Tighten the screw to secure the eccentric.
 3. Insert the top panel into the top rail.
 4. Tighten the screw to secure the top panel.
 5. Insert the back panel into the back rail.
 6. Tighten the screw to secure the back panel.
 7. Insert the bottom panel into the bottom rail.
 8. Tighten the screw to secure the bottom panel.

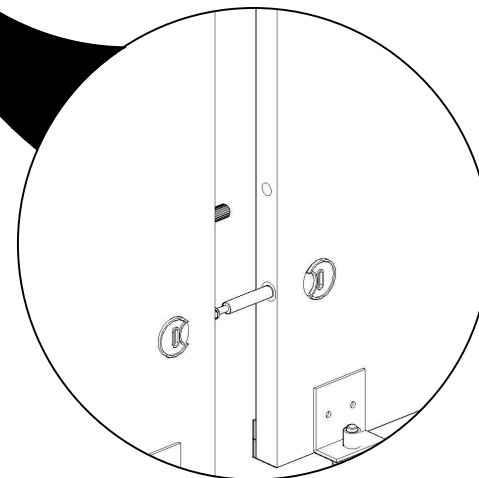

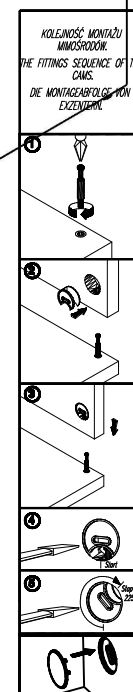
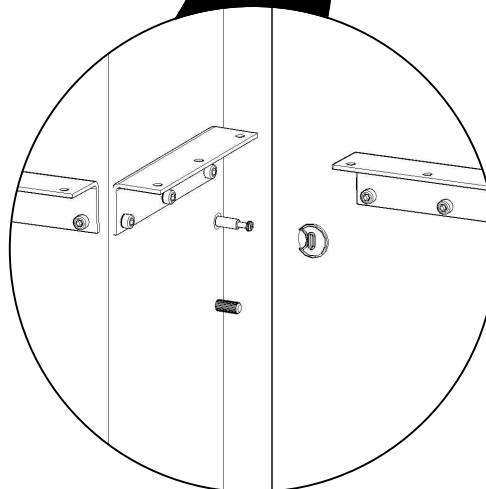
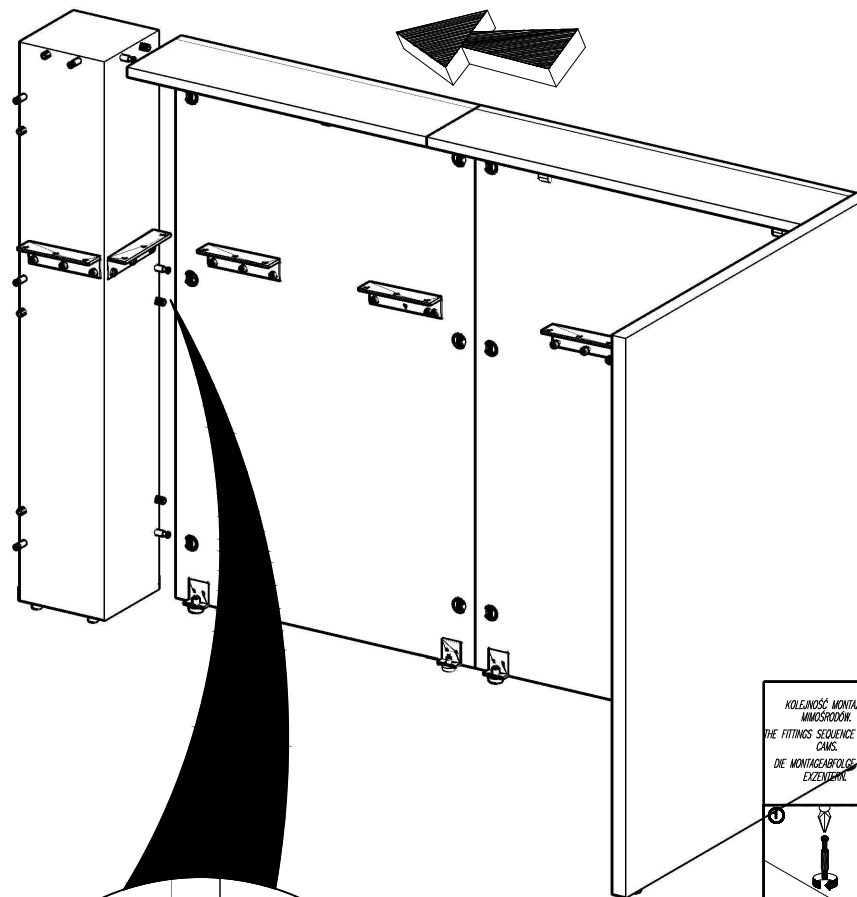
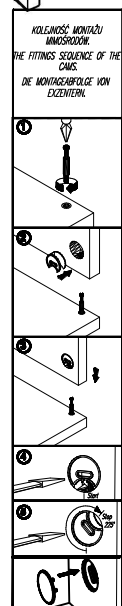
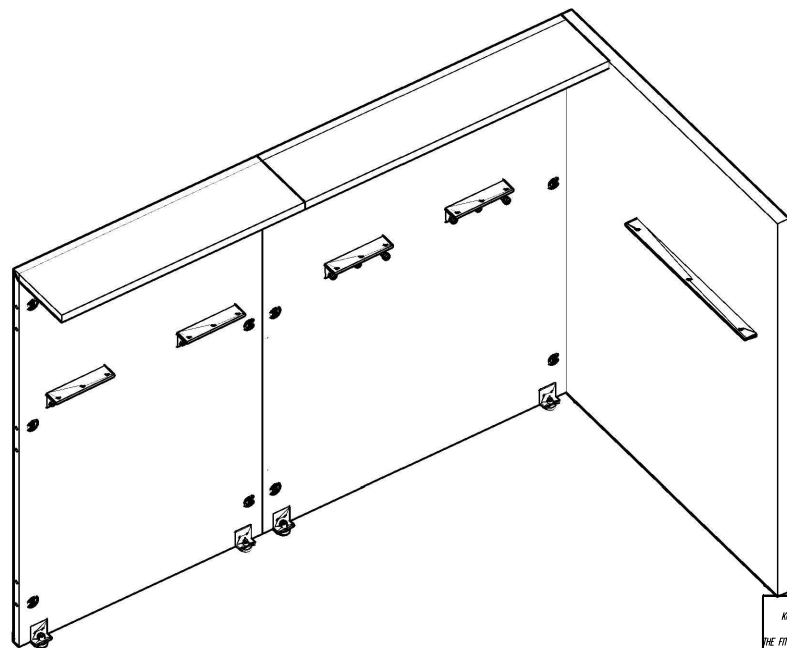

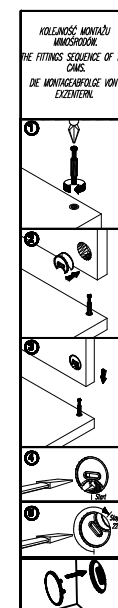
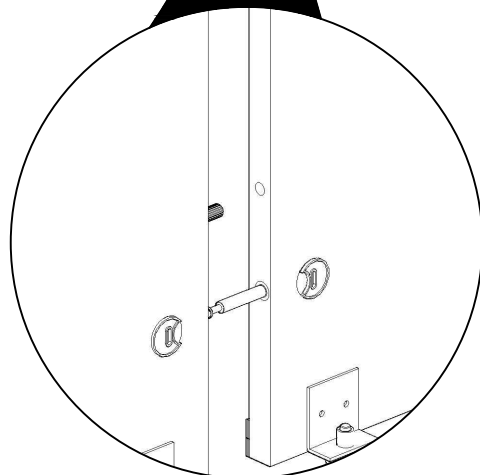
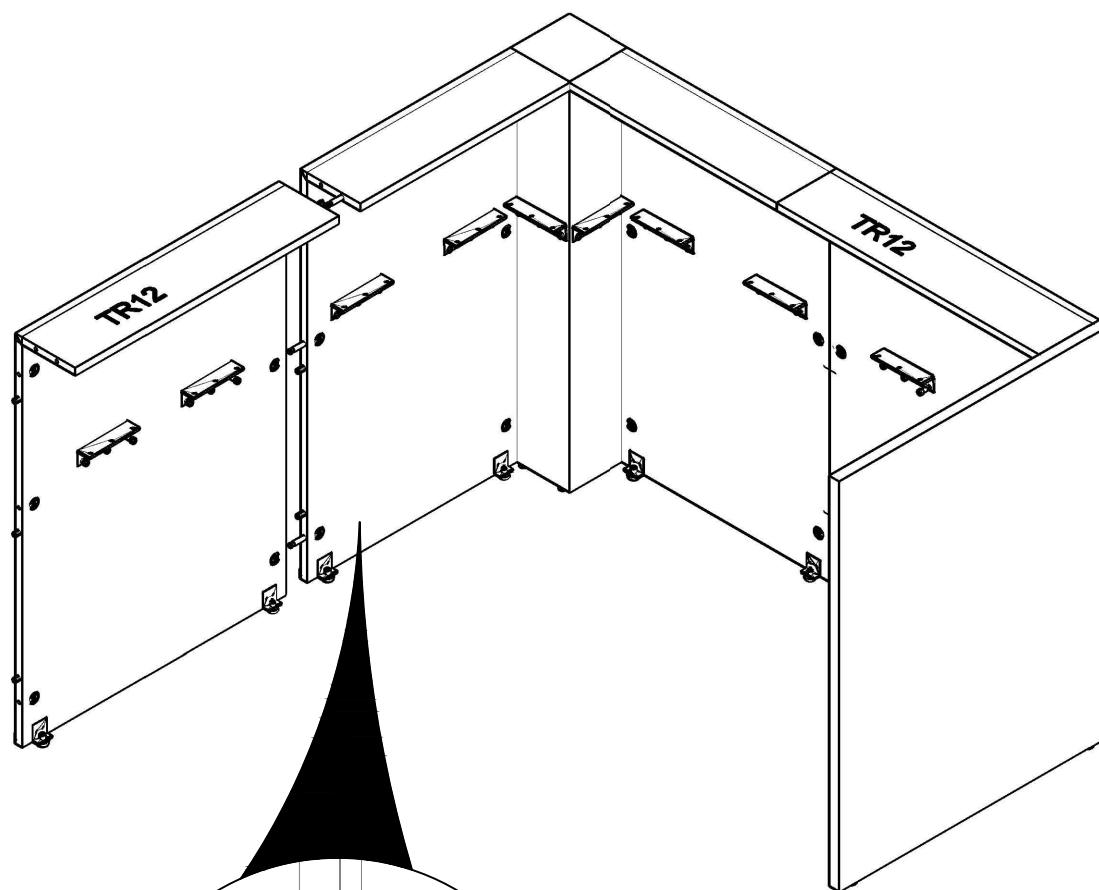

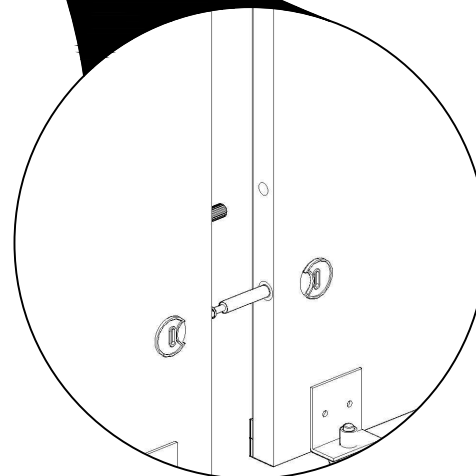
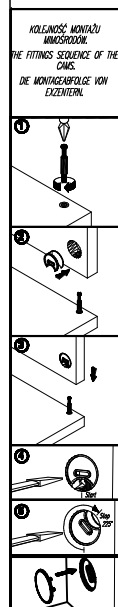
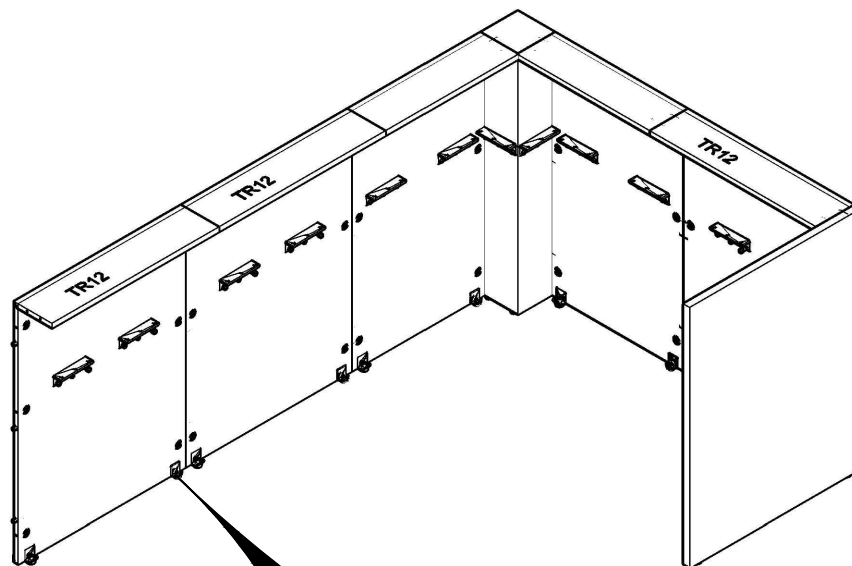
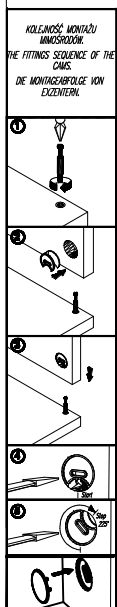
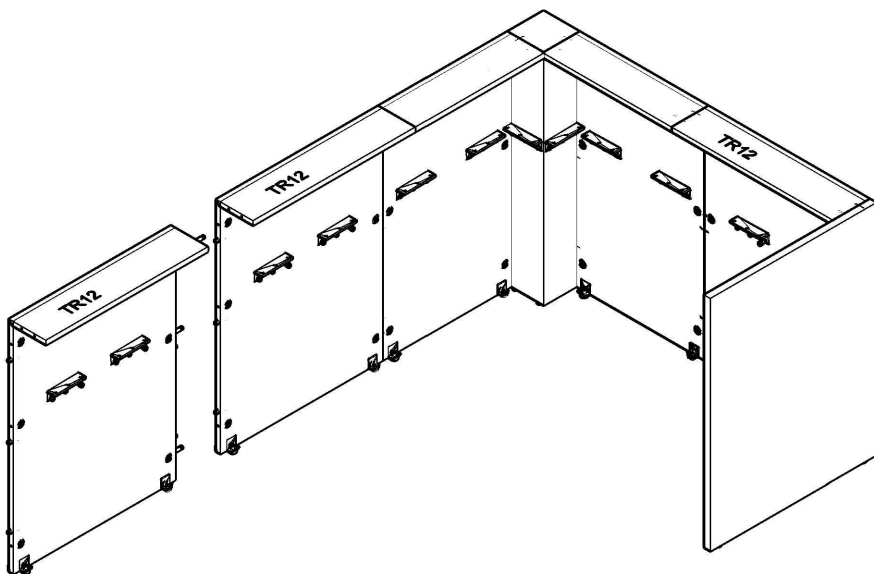

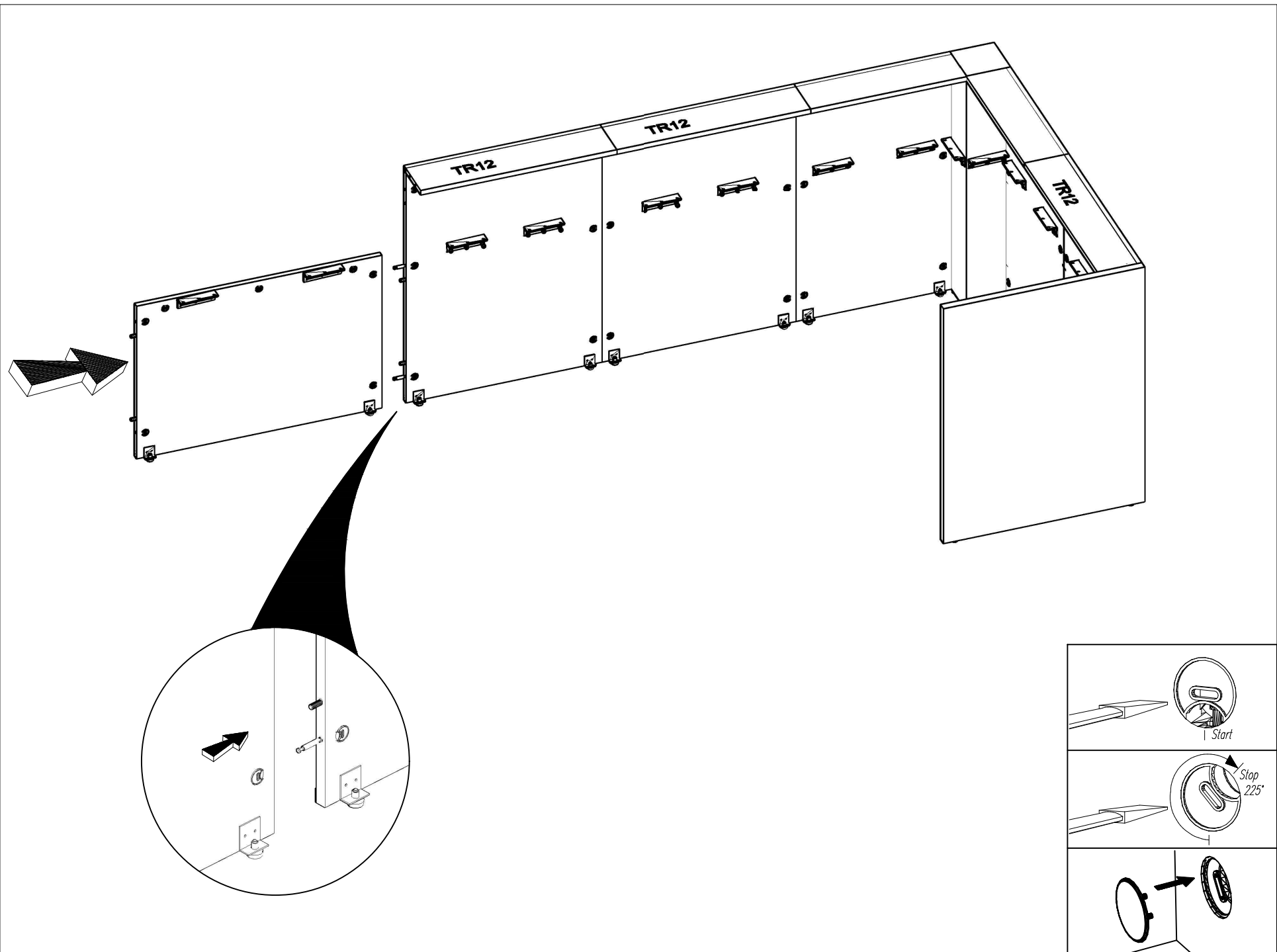

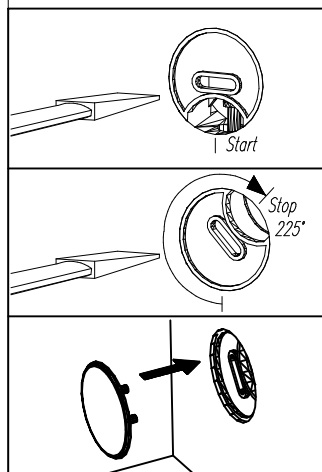
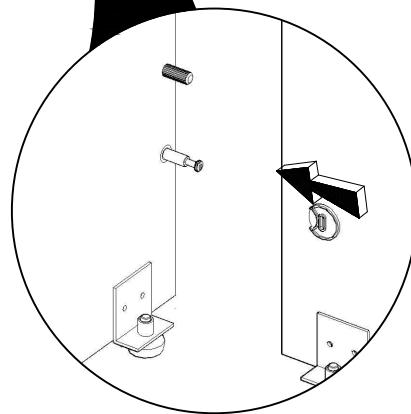
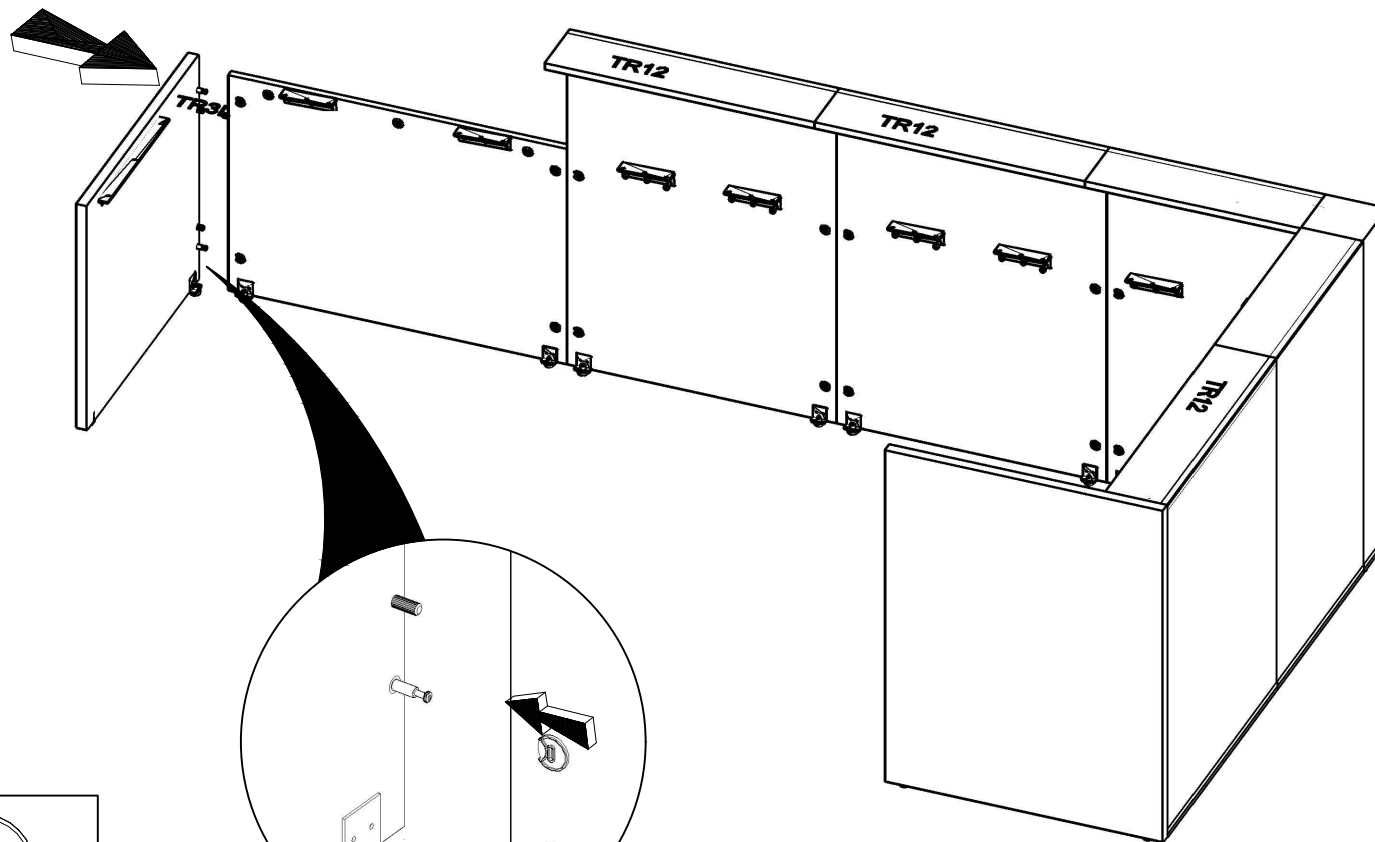

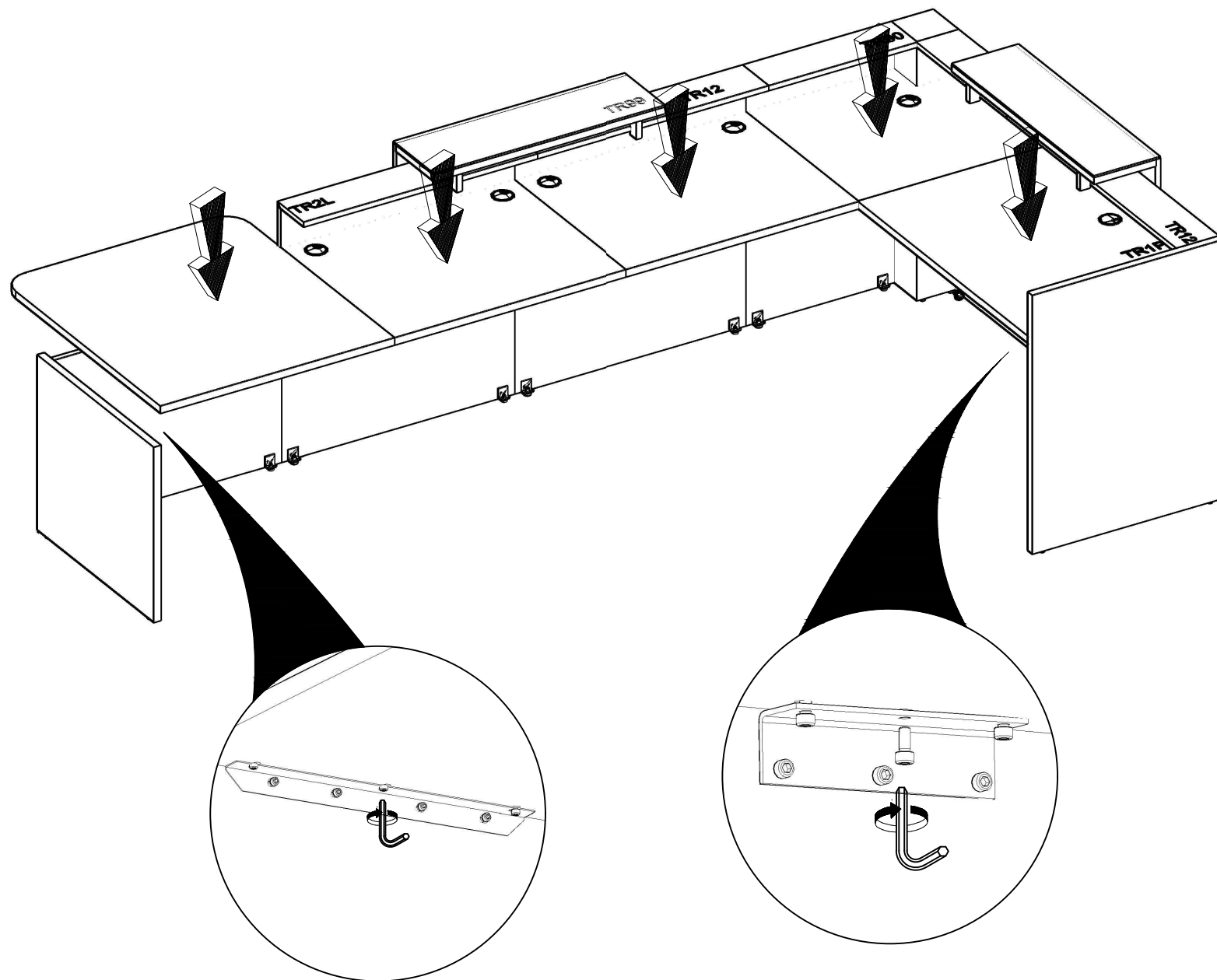

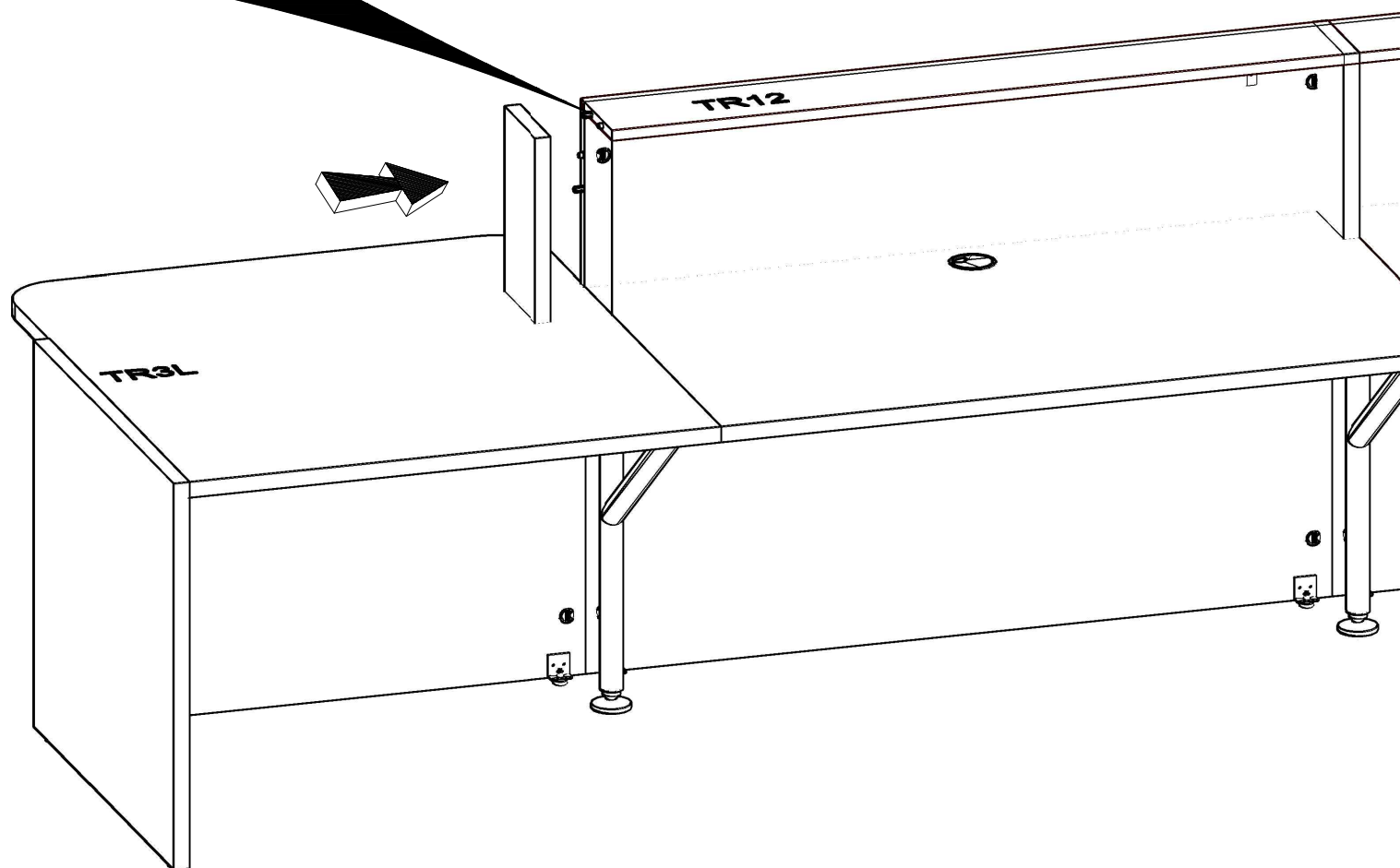
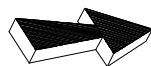
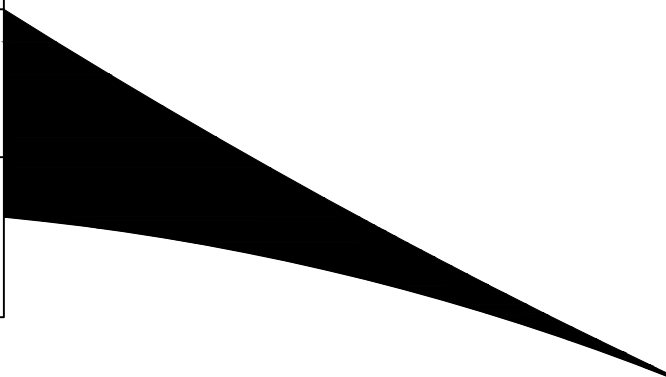
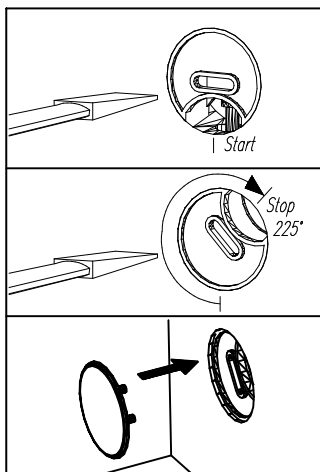

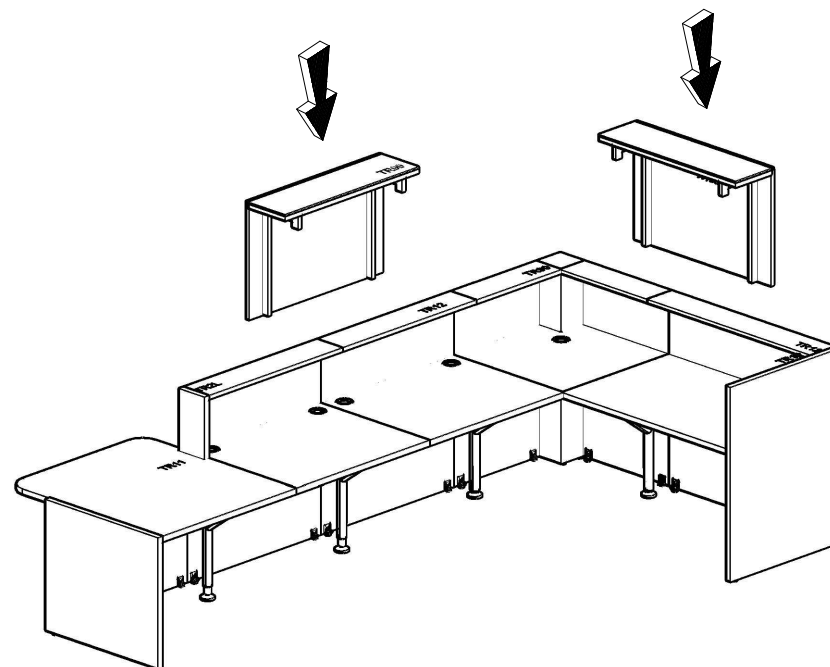
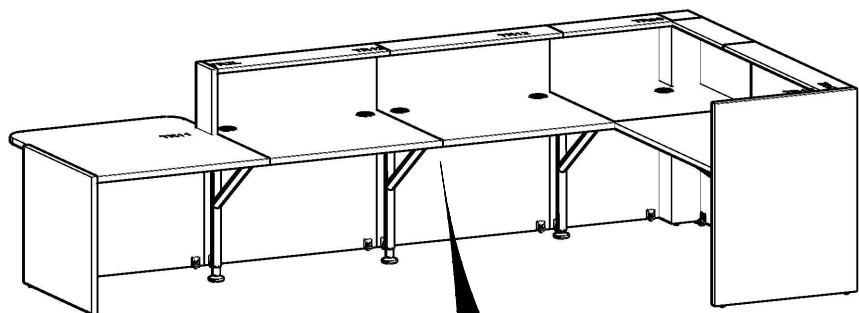

LED INSTALLATION

