

KOLEJNOŚĆ MONTAŻU
MIMOŚRÓDÓW.

THE FITTINGS SEQUENCE OF THE
CAMs.

DIE MONTAGEABFOLGE VON
EXZENTERN.

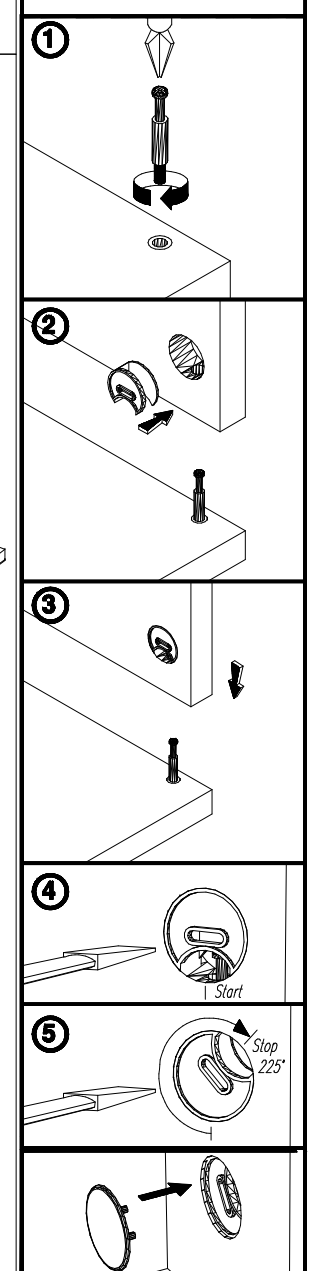
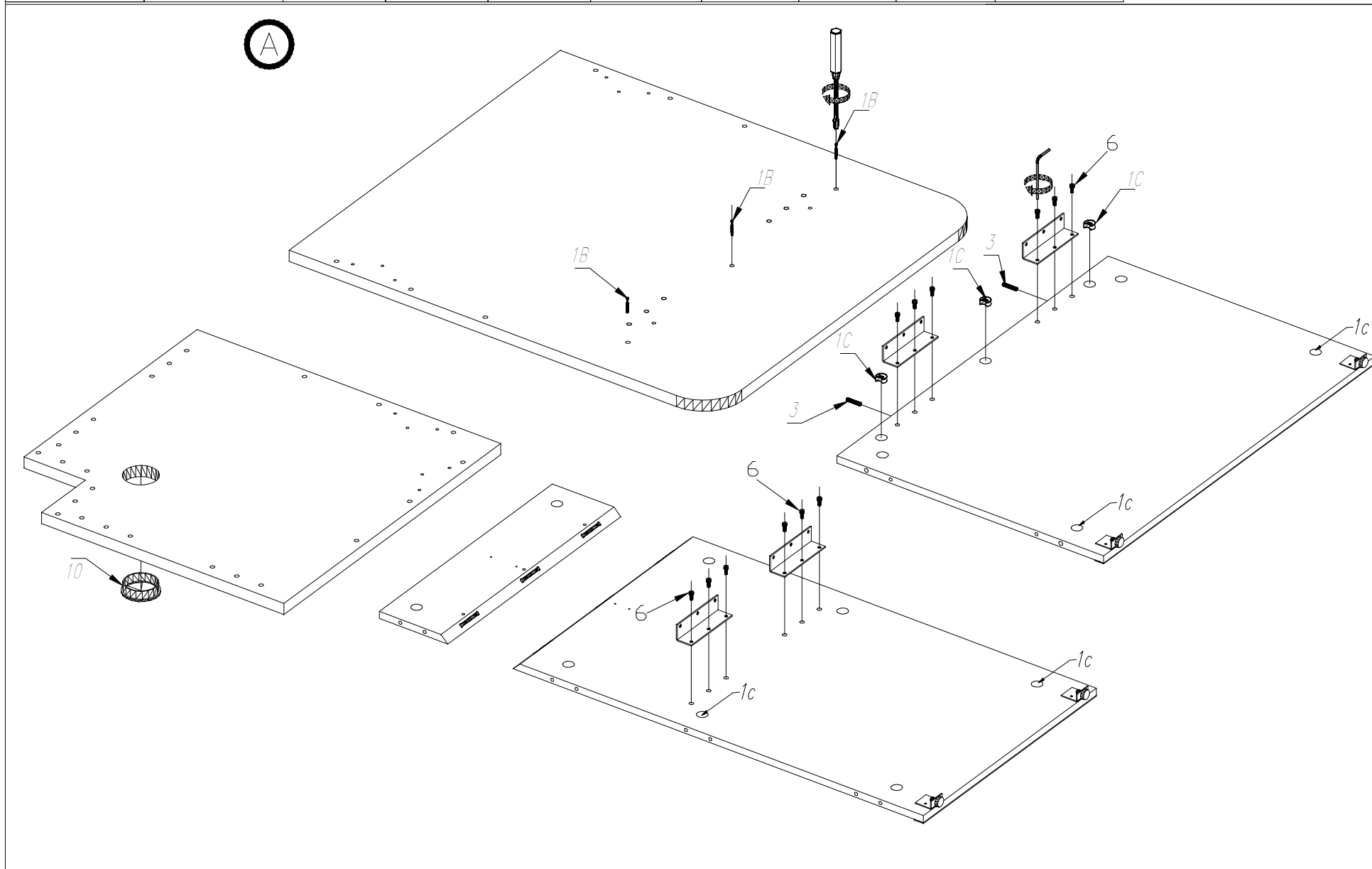

B

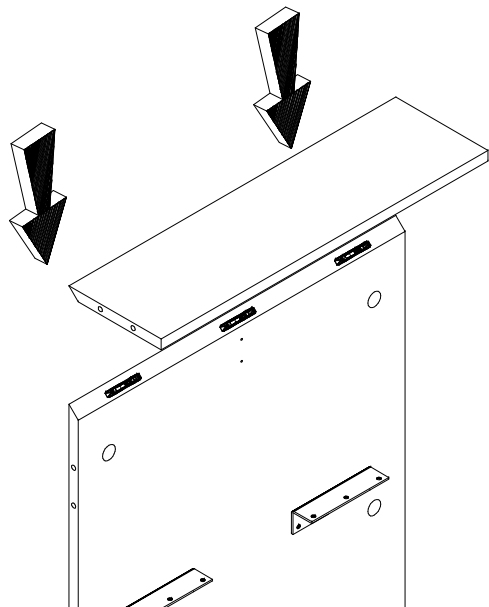

C

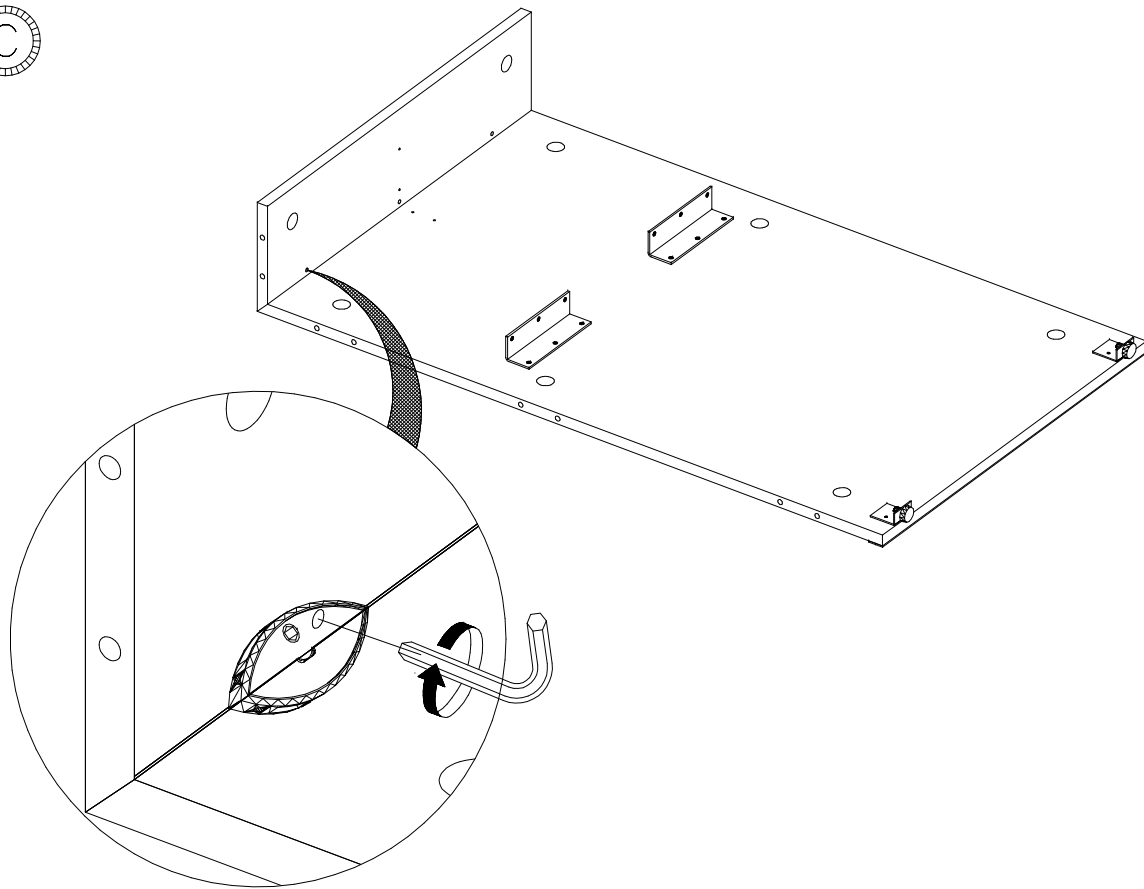

D

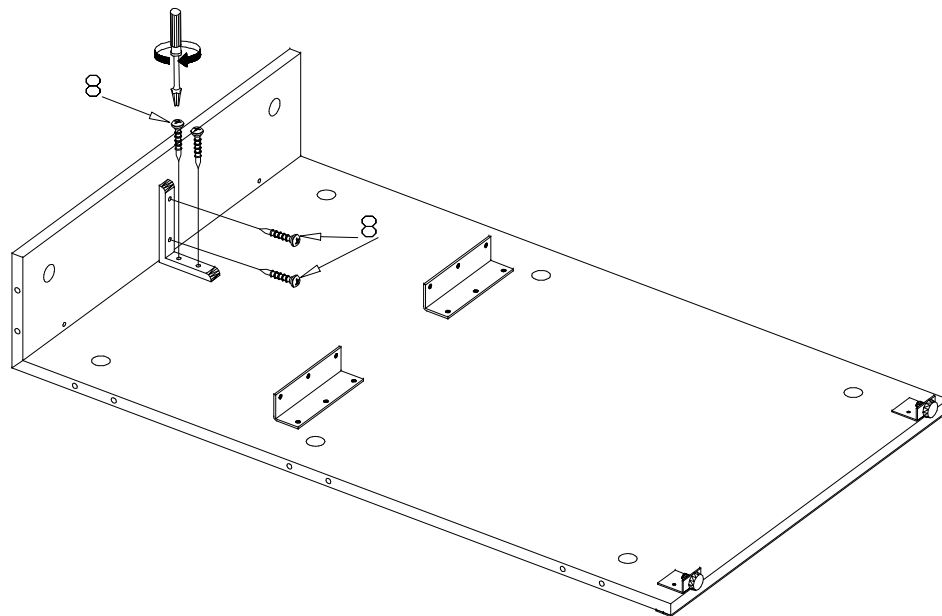

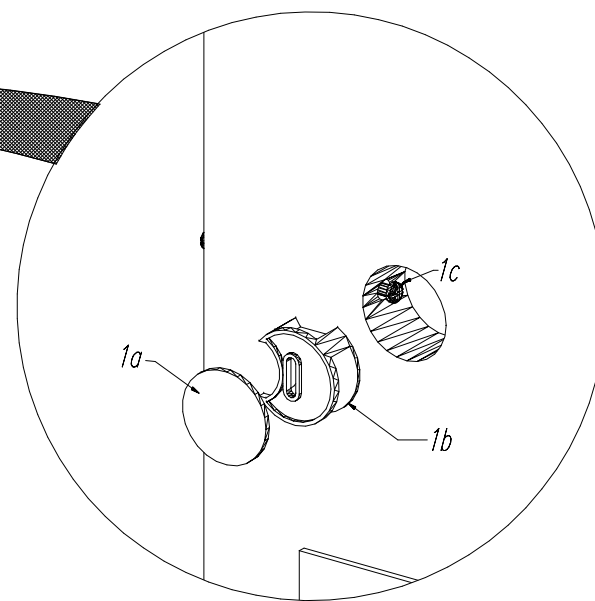
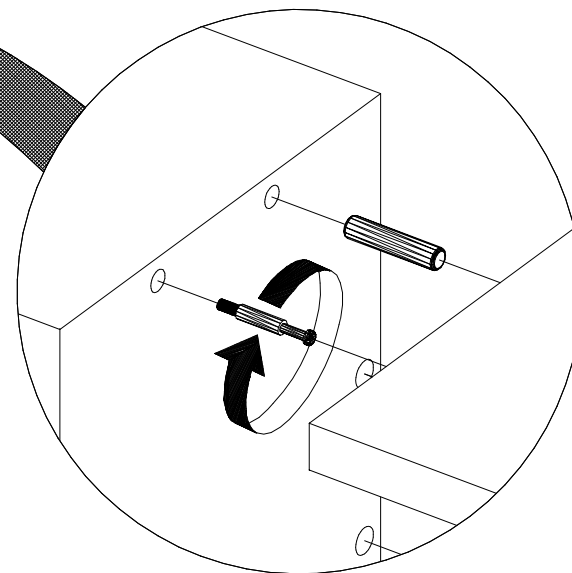
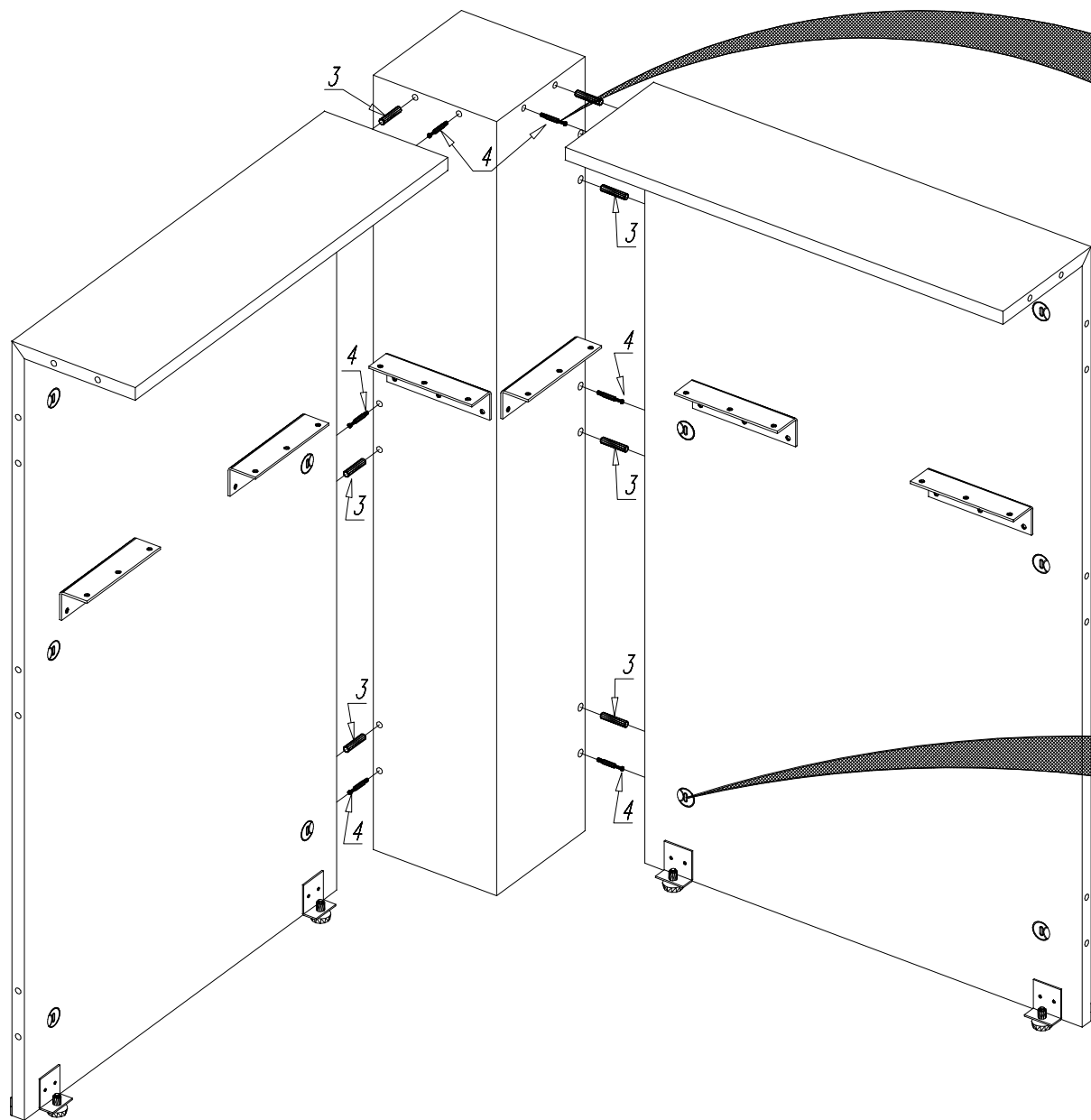

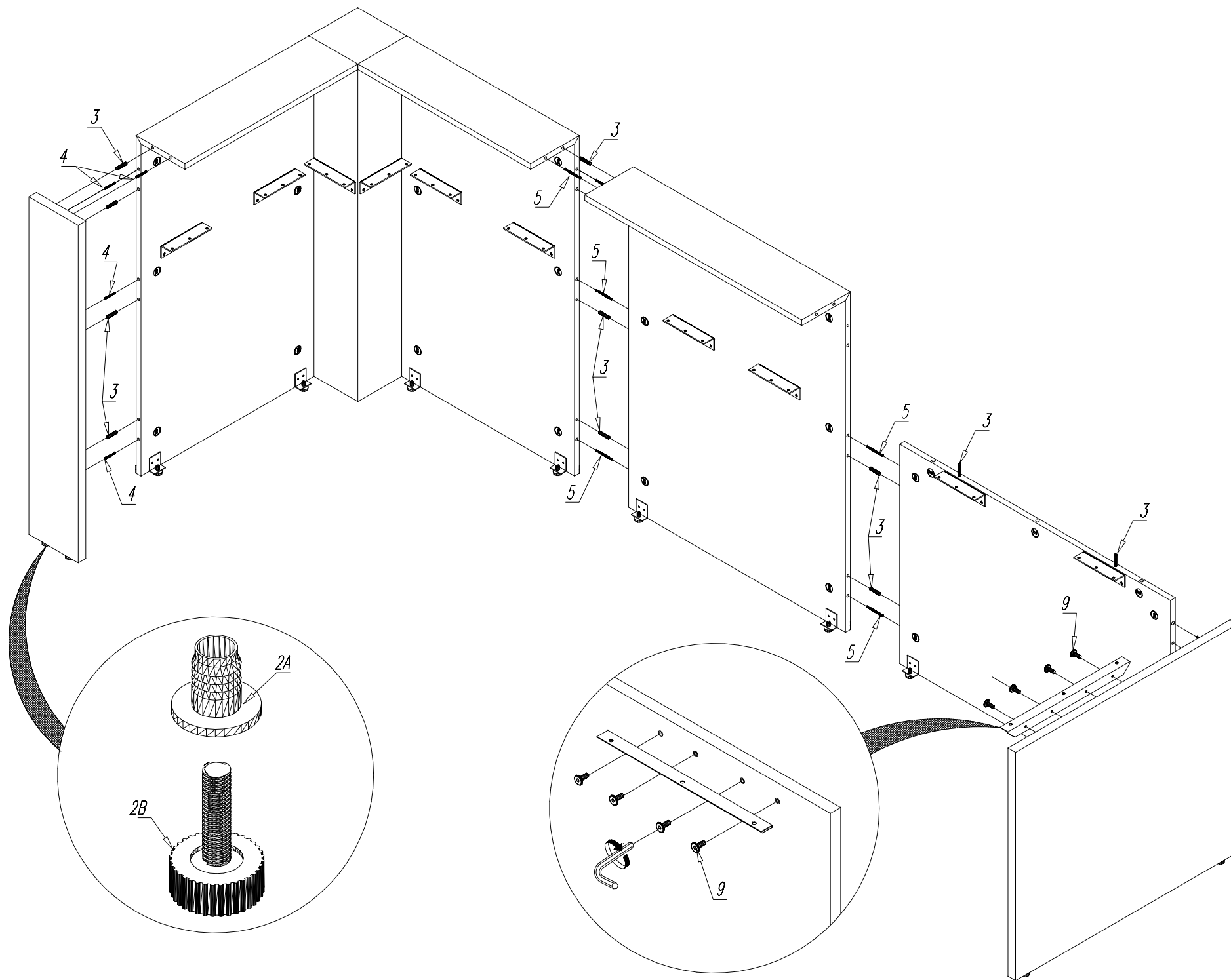

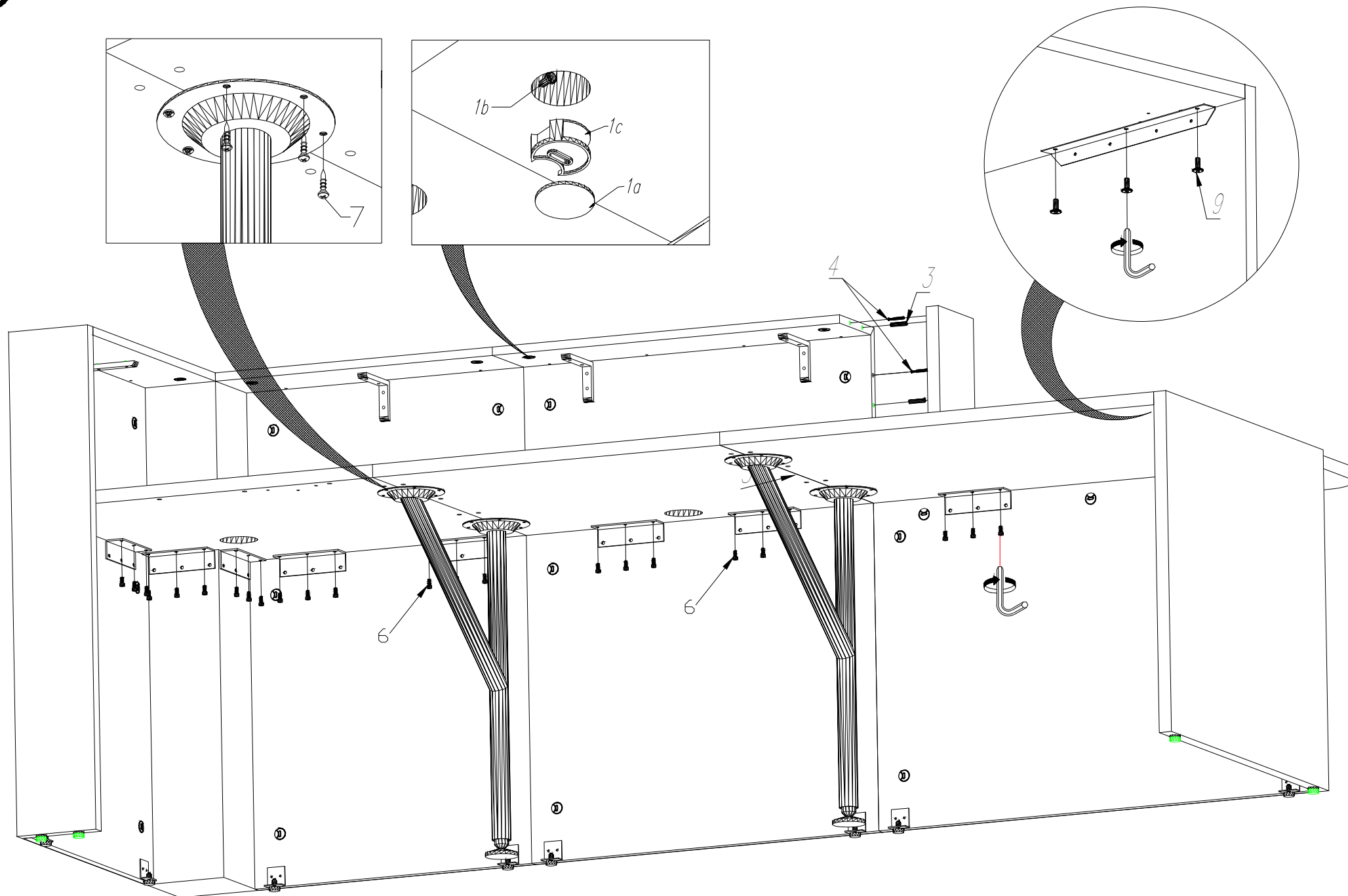

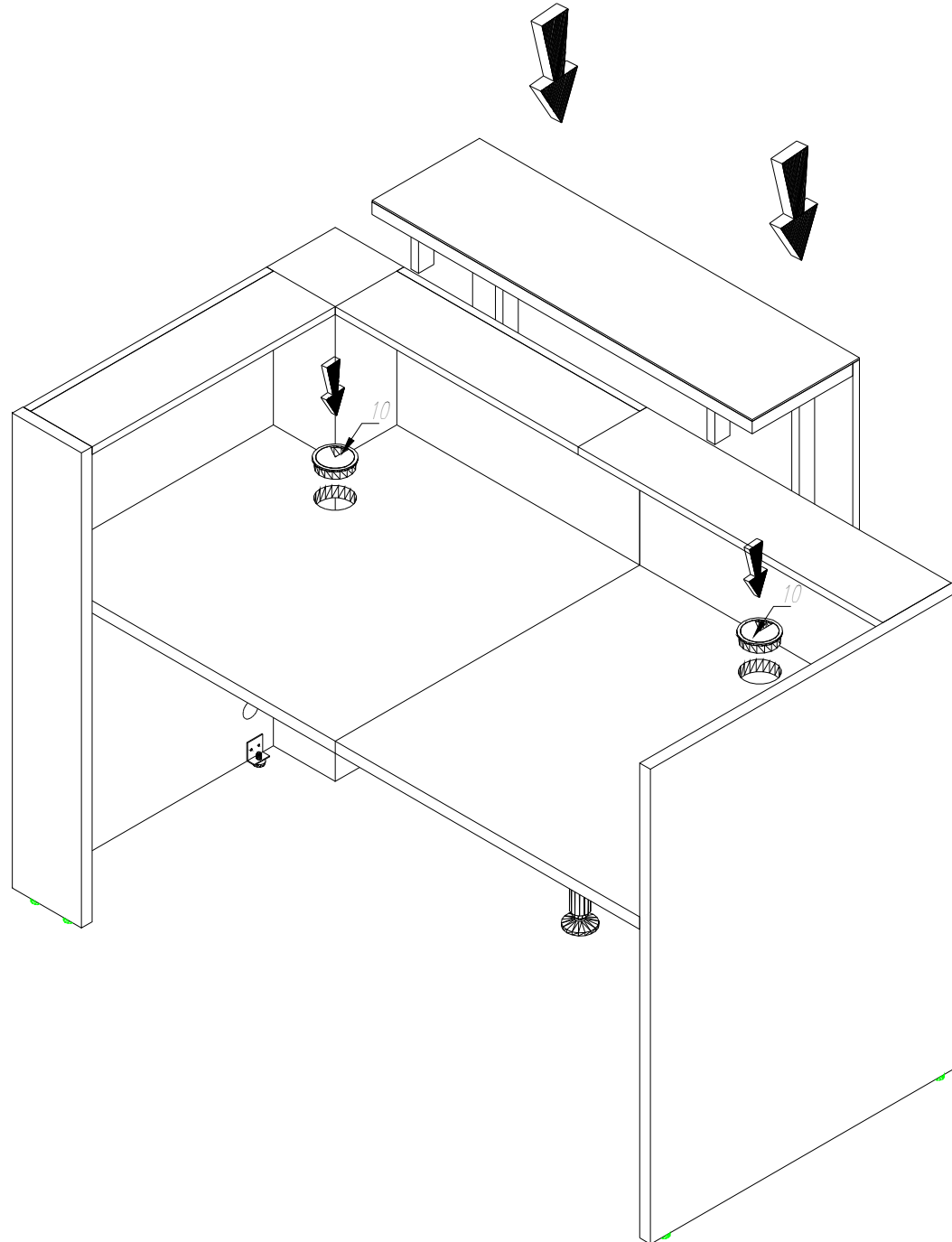

1

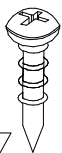
 $\varnothing 5 \times 17$ 

NL41

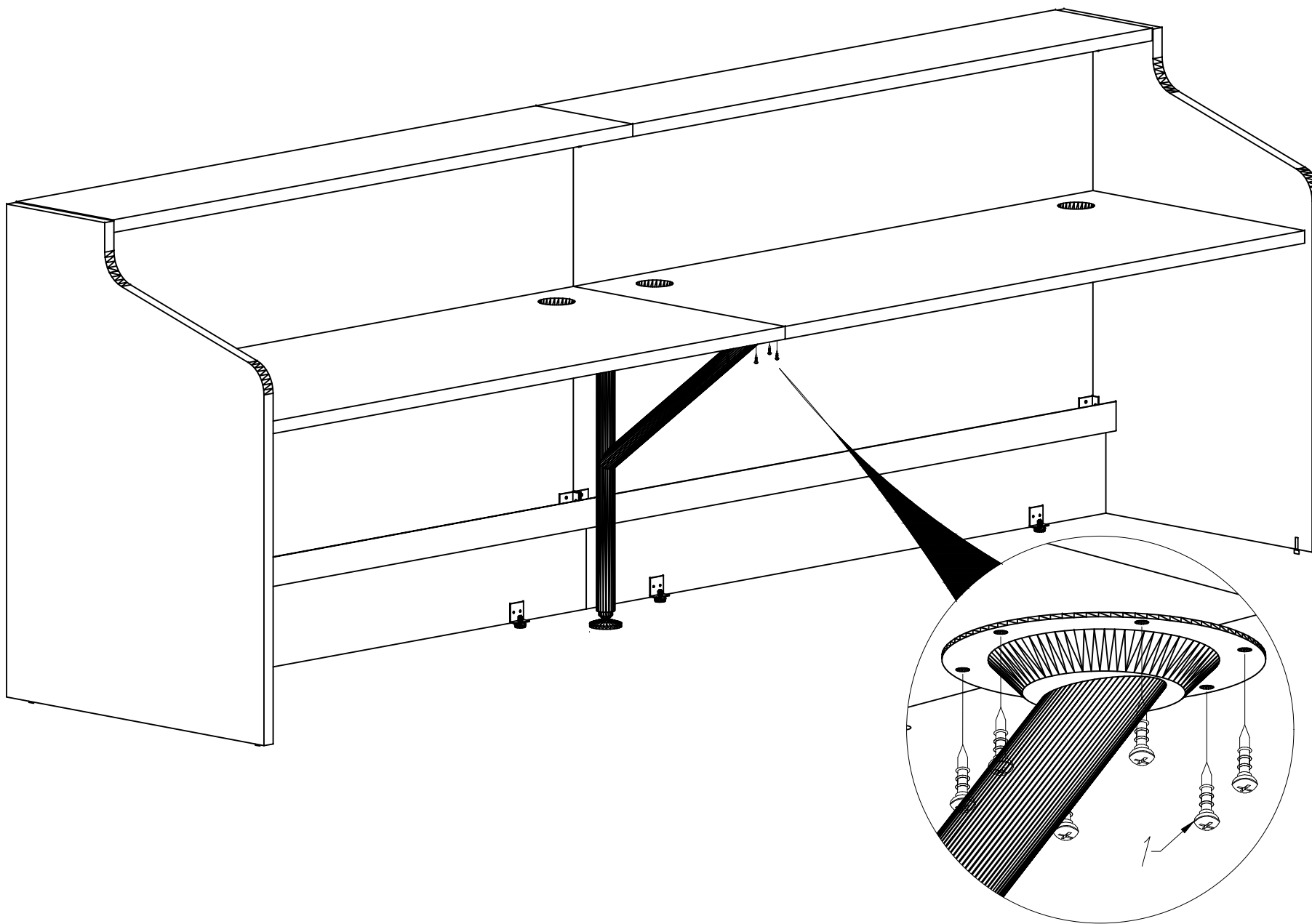

1

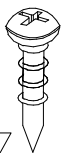
 $\varnothing 5 \times 17$ 

NL41

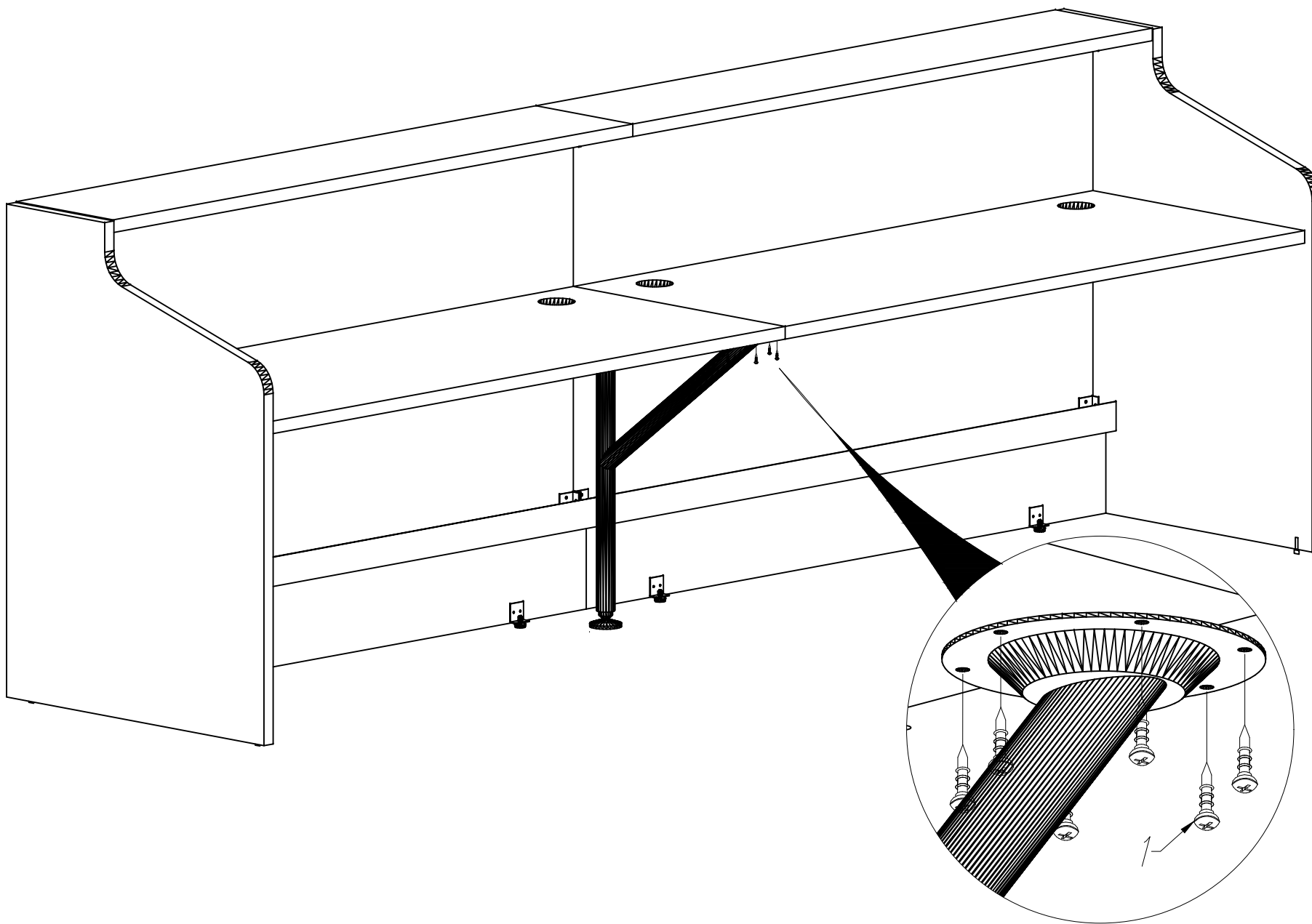

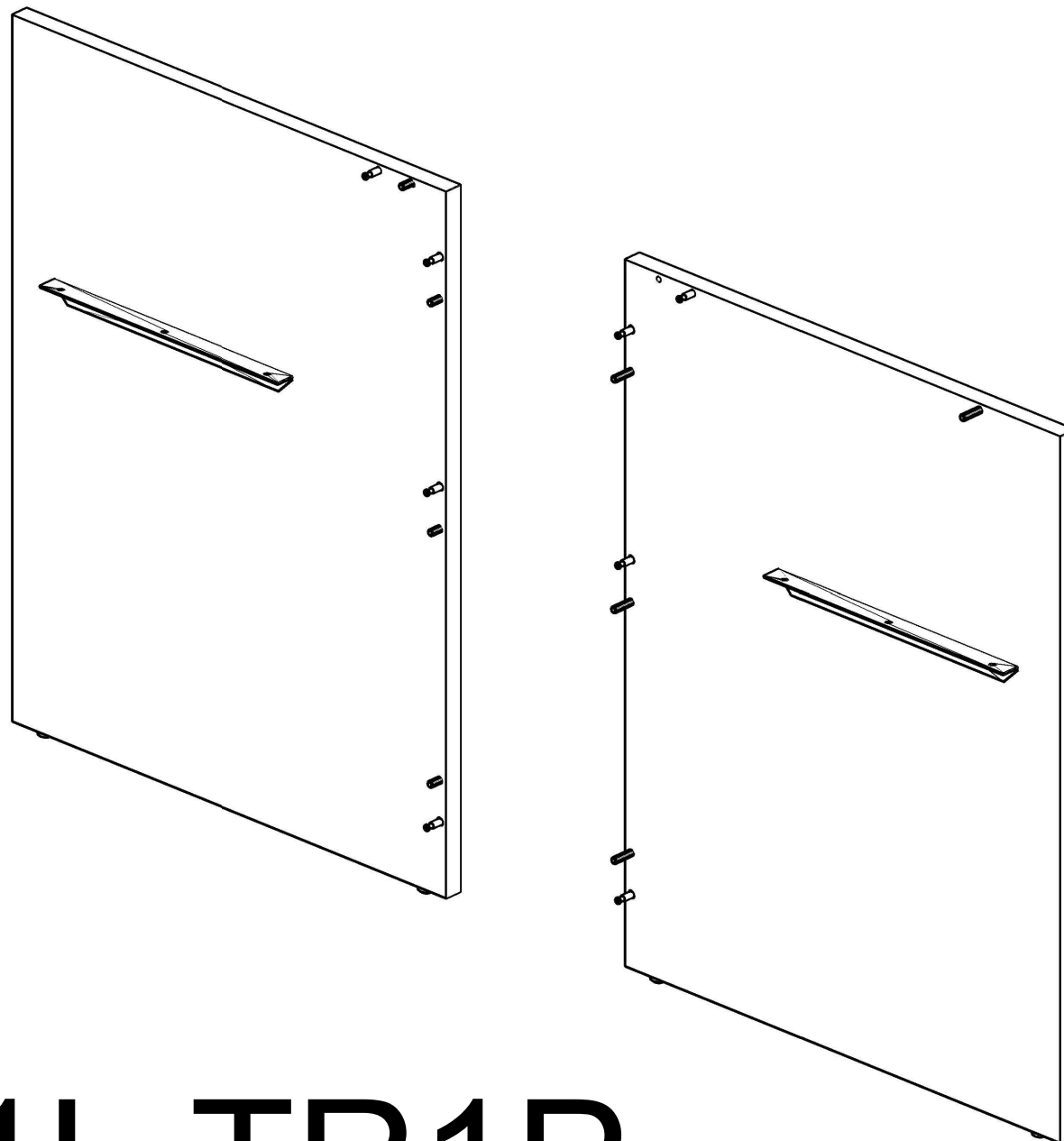

TR1L TR1P

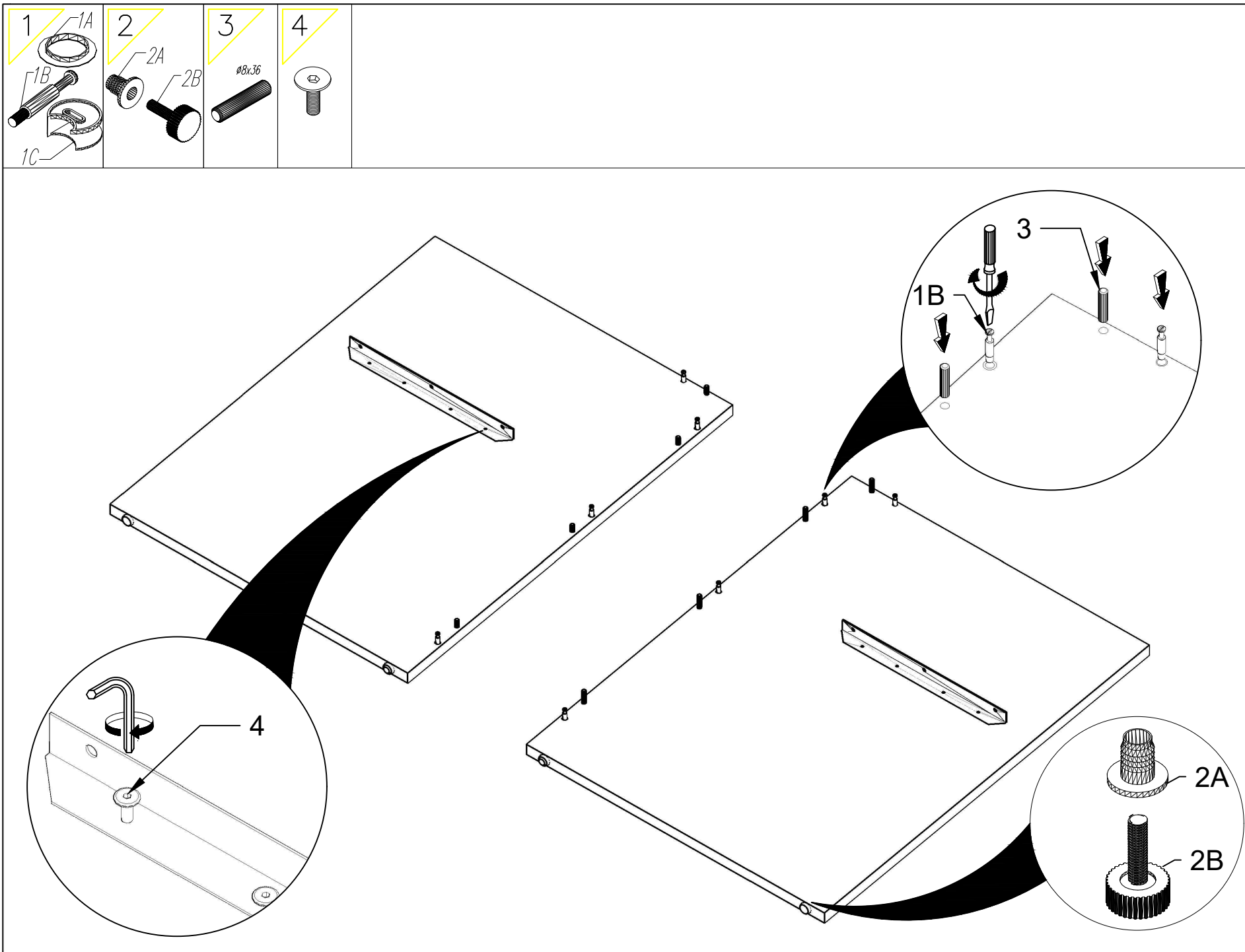

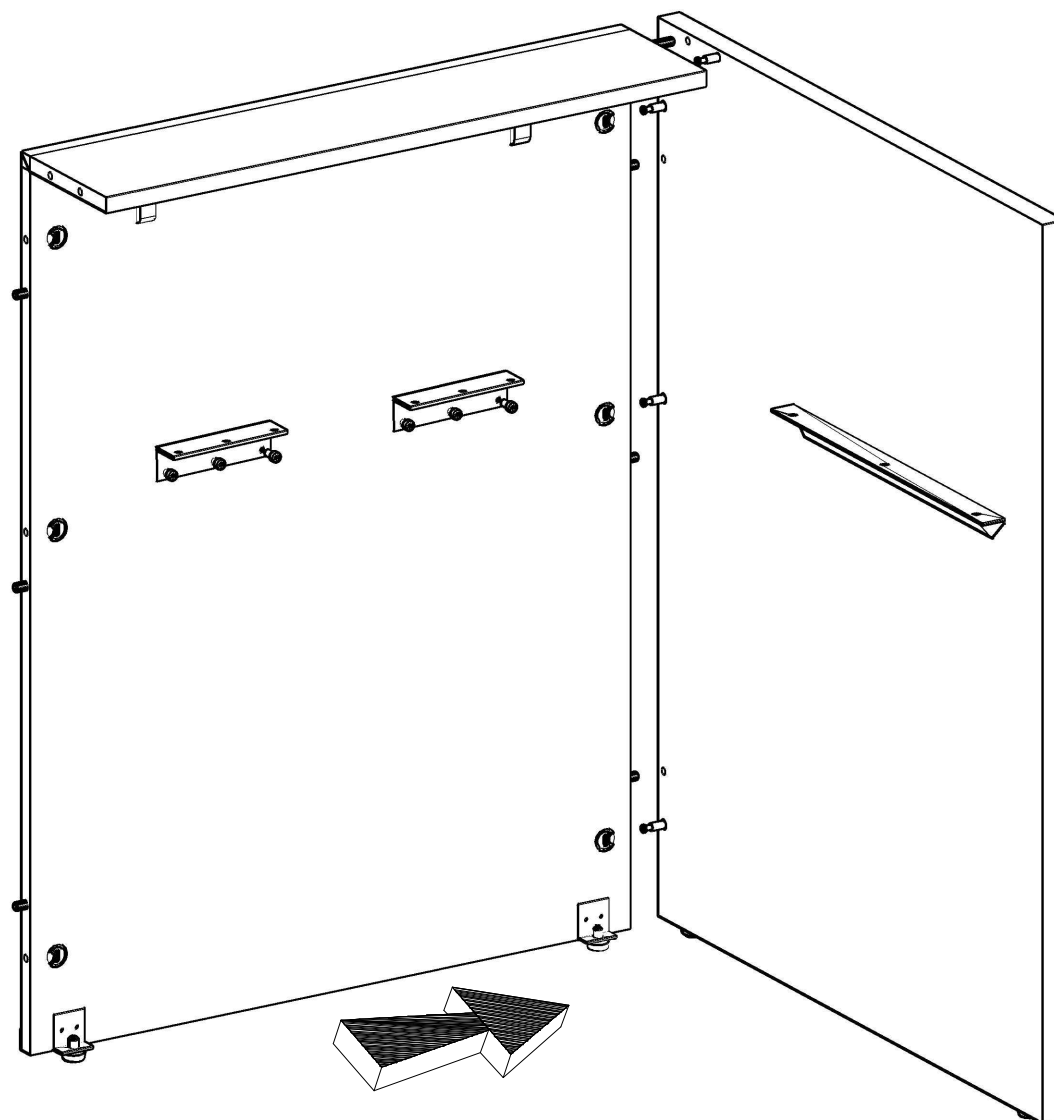

KOLEJNOŚĆ MONTAŻU
MIMOŚRODÓW.
THE FITTINGS SEQUENCE OF THE
CAMS.
DIE MONTAGEABFOLGE VON
EXZENTERN.

①

②

③

④

⑤

Start

Stop 225°

The sequence diagram shows the correct fitting sequence of the cams. It consists of five numbered steps (① to ⑤) illustrating the process of inserting and positioning the cam. Step ① shows the cam being inserted into the frame. Step ② shows the cam being pushed into the sash. Step ③ shows the cam being pushed into the frame. Step ④ shows the cam being pushed into the sash. Step ⑤ shows the cam being pushed into the frame. The sequence is labeled 'Start' and 'Stop 225°'.

LED INSTALLATION

