

A52P4

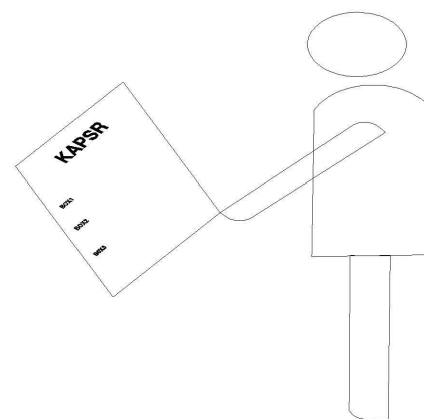

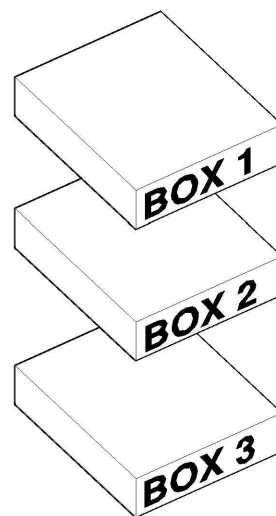

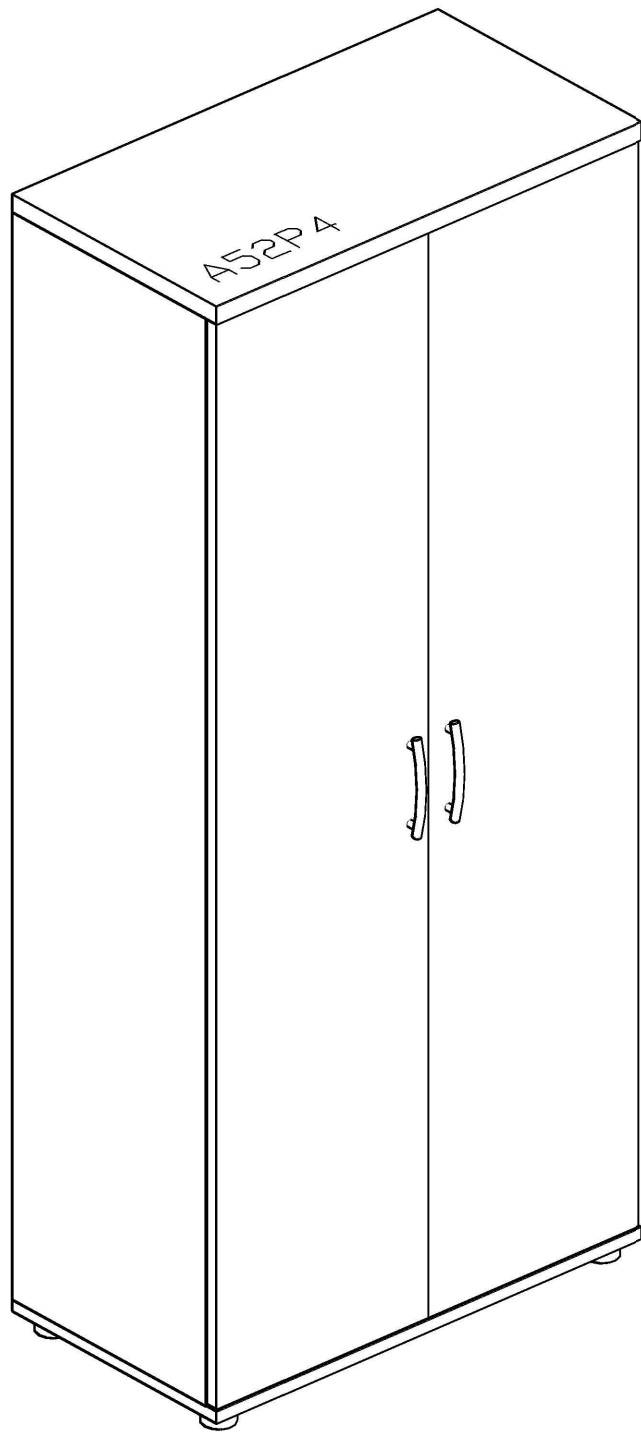

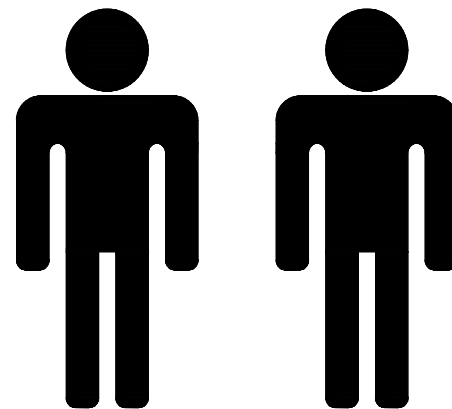
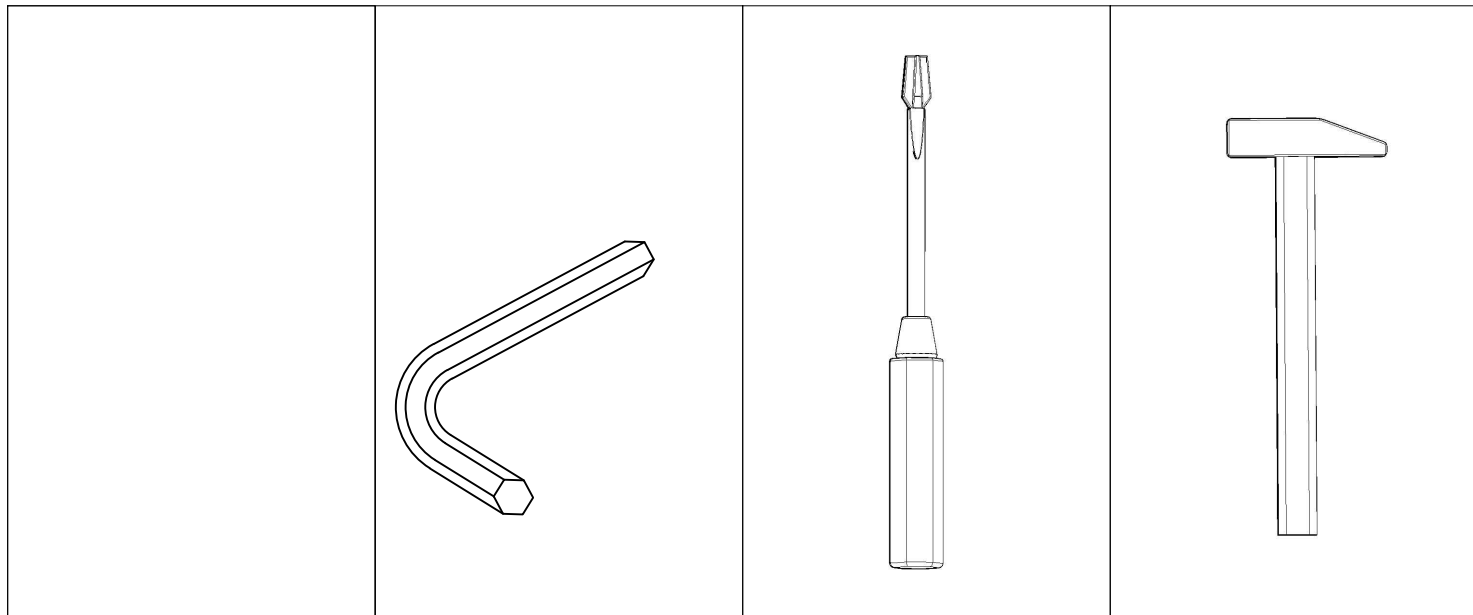
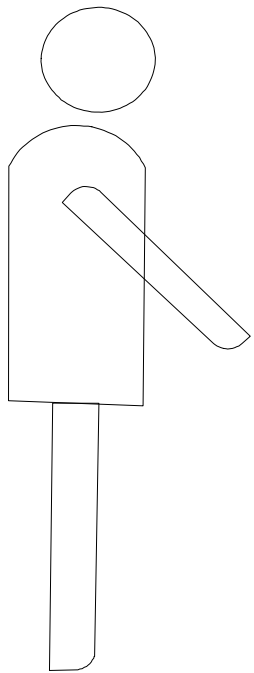
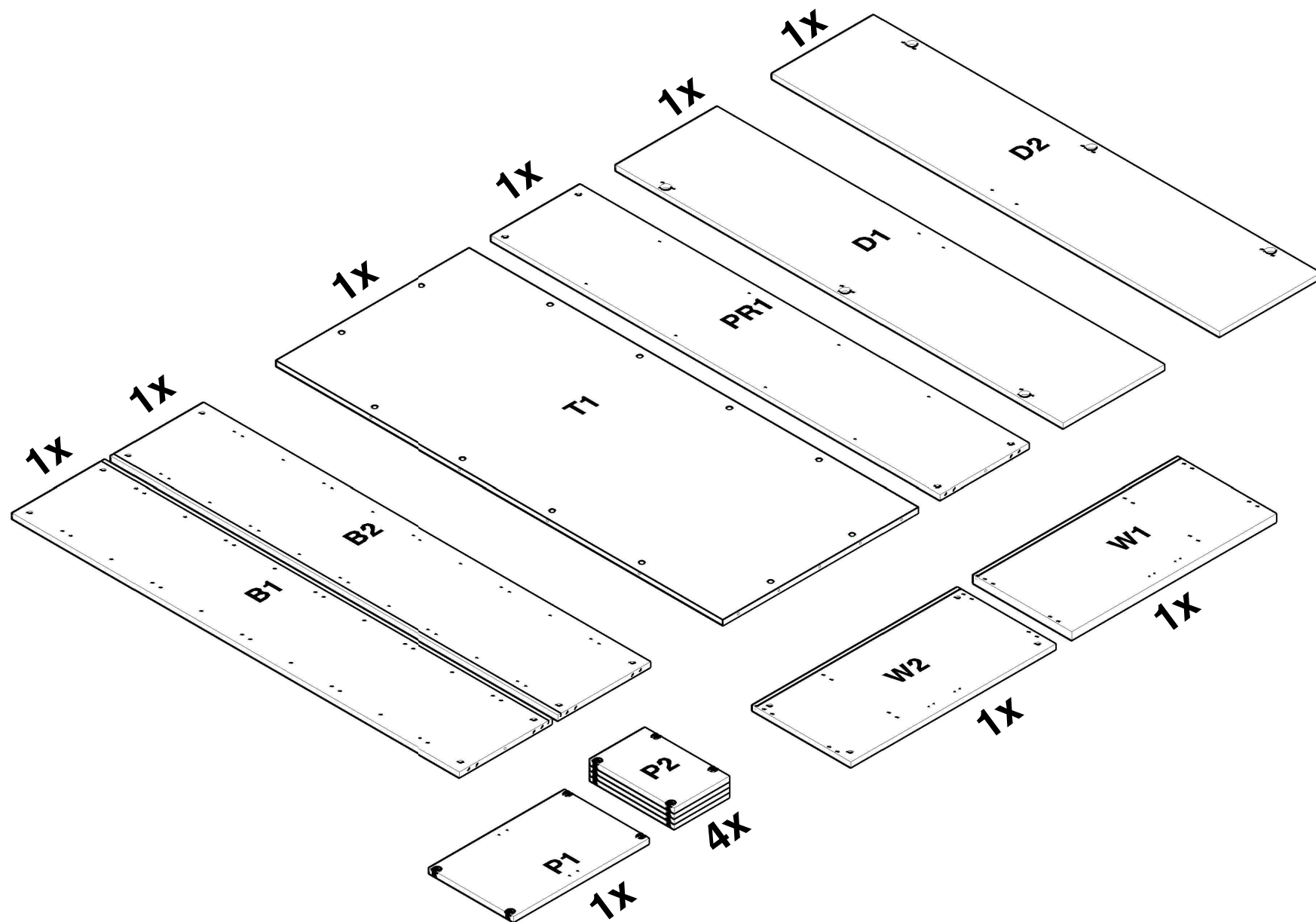
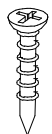

8x

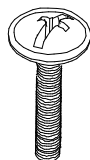

4x

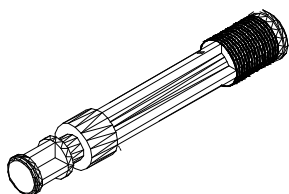

24x

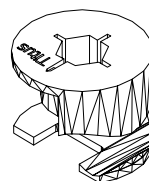

24x

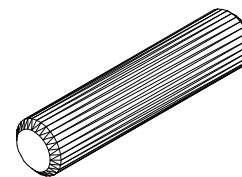

22x



20

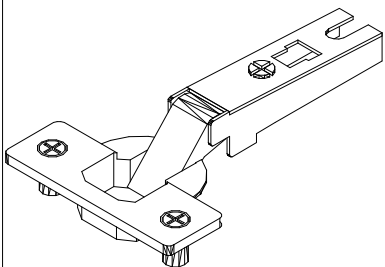

6x

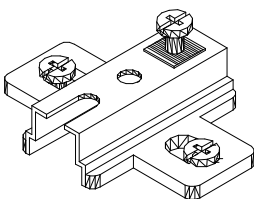

6x

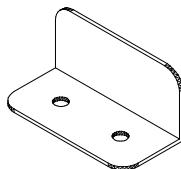

2x



2x

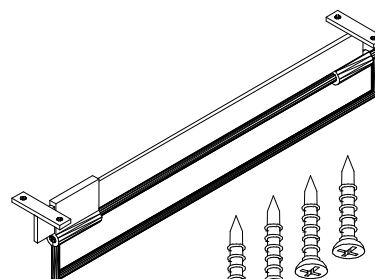

1x



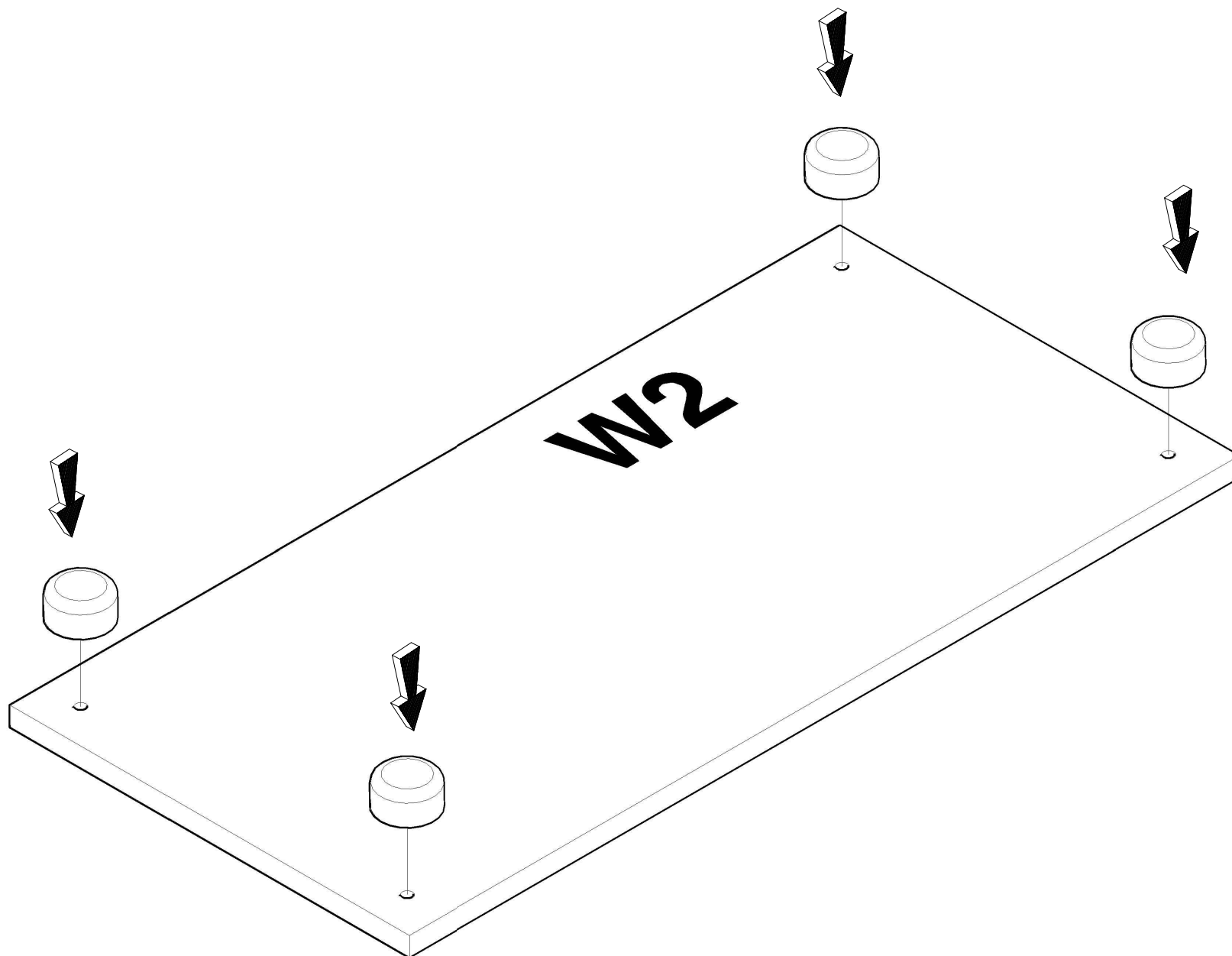

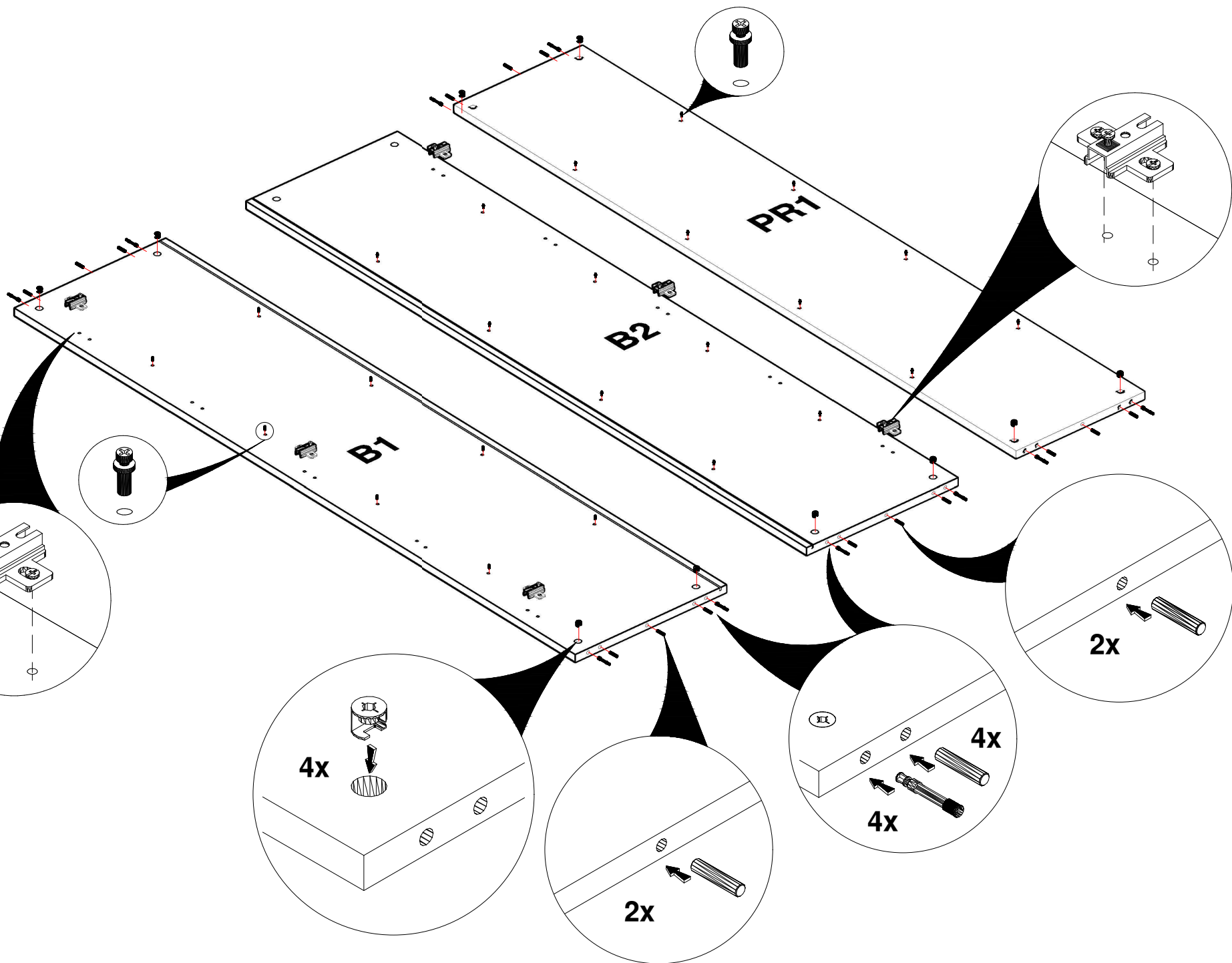

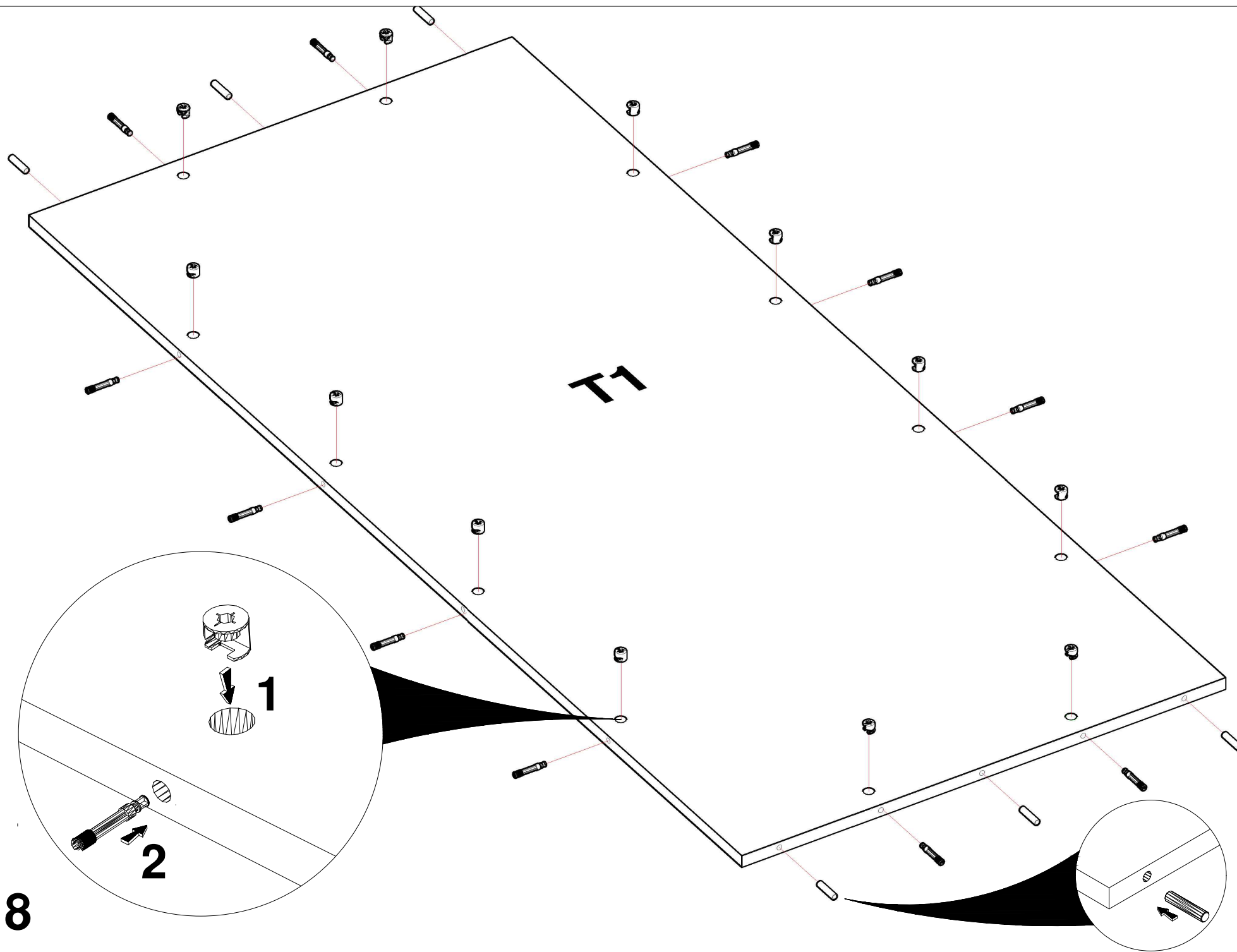

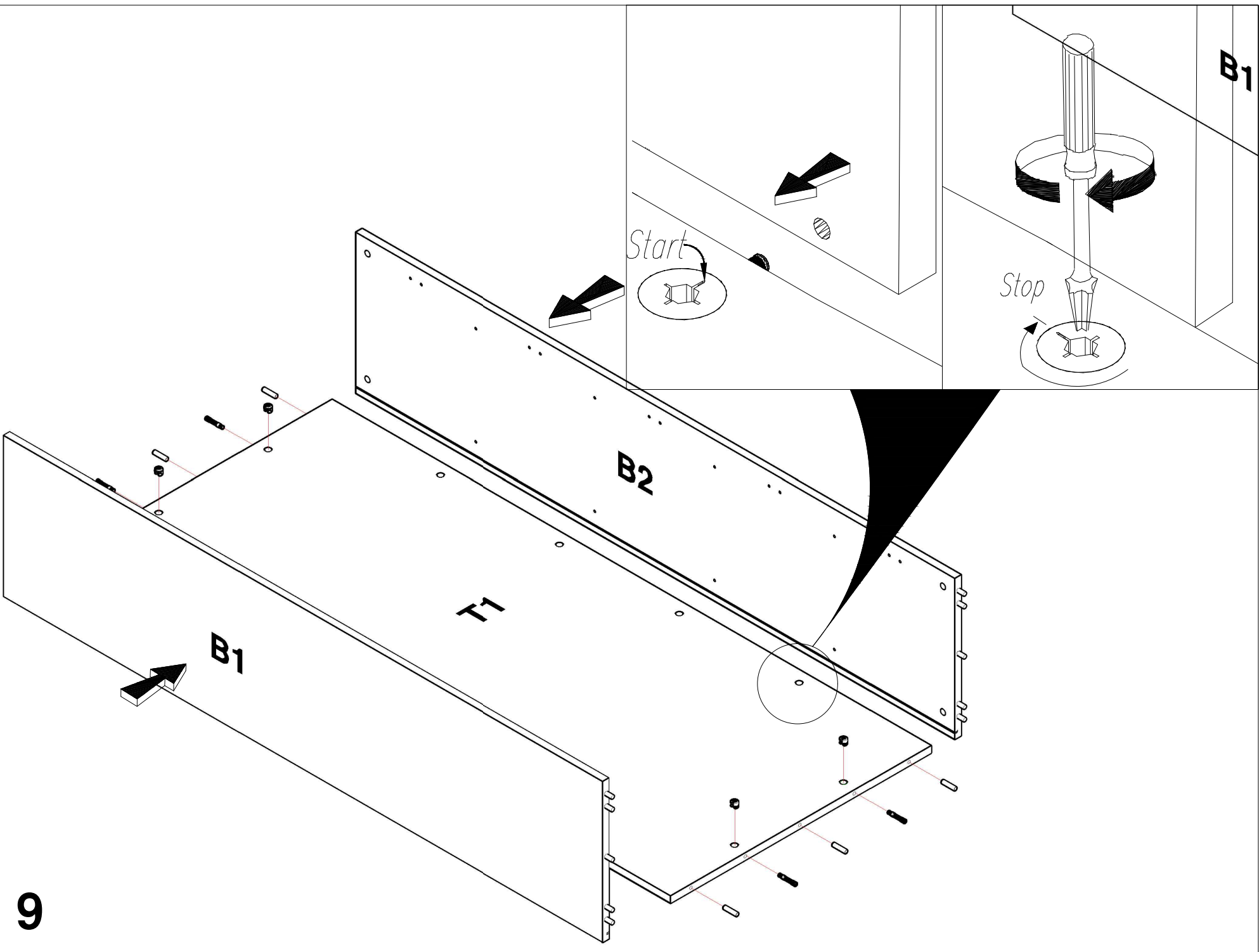

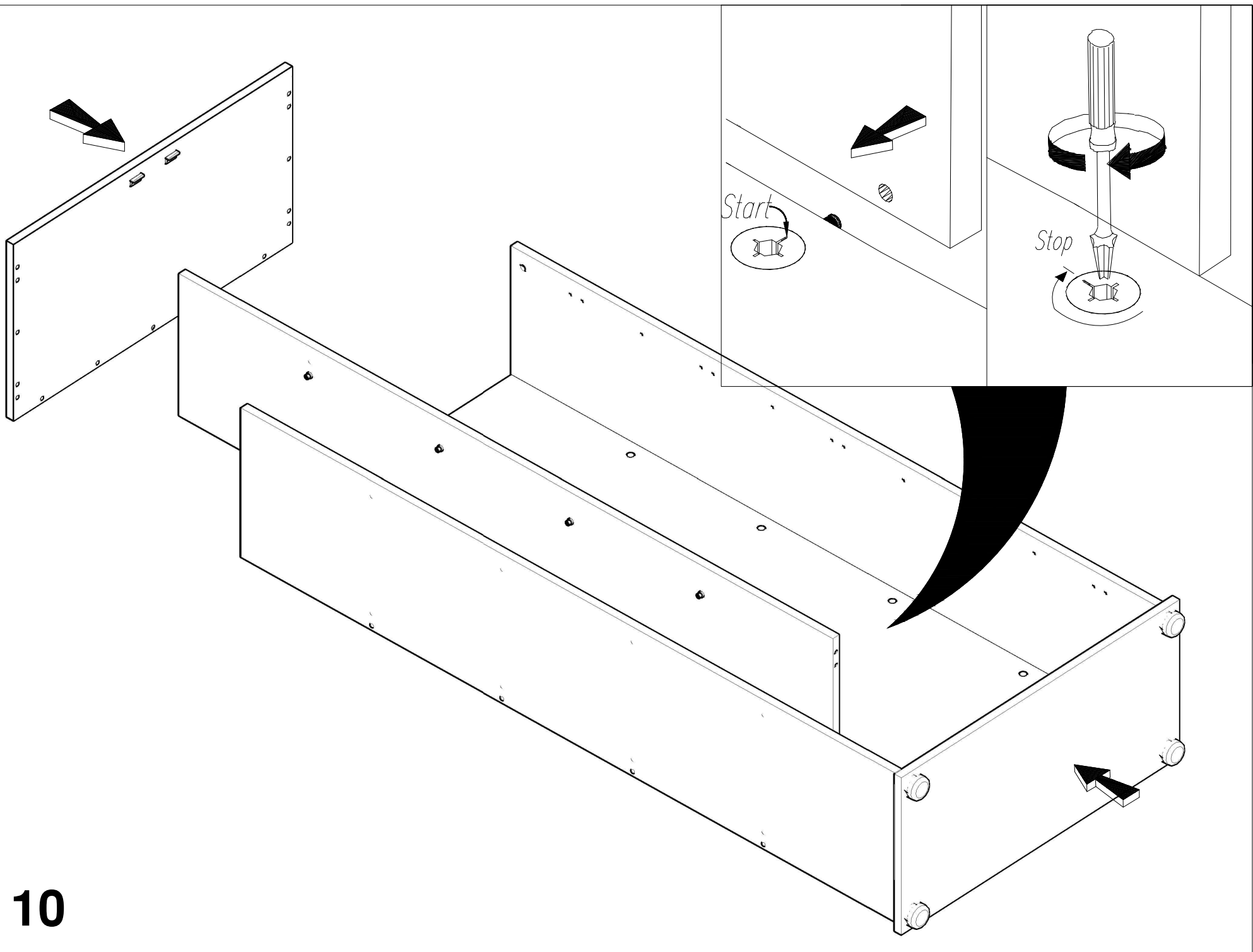

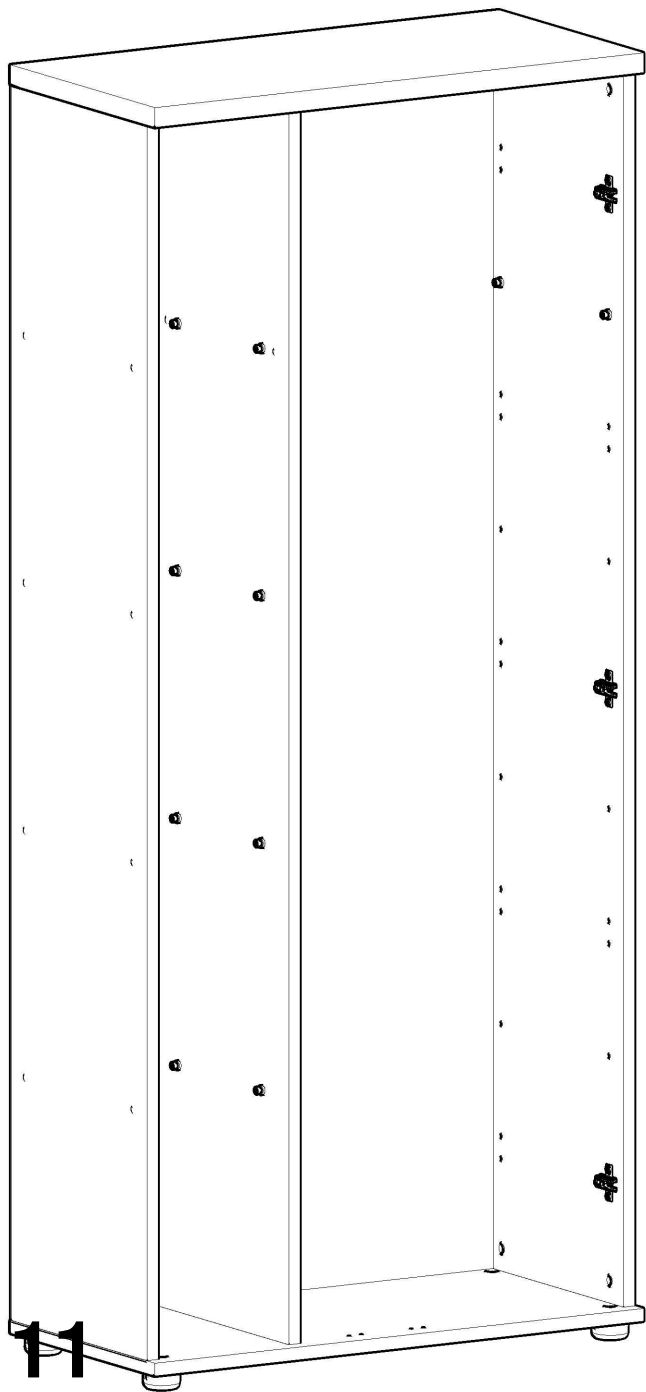

11

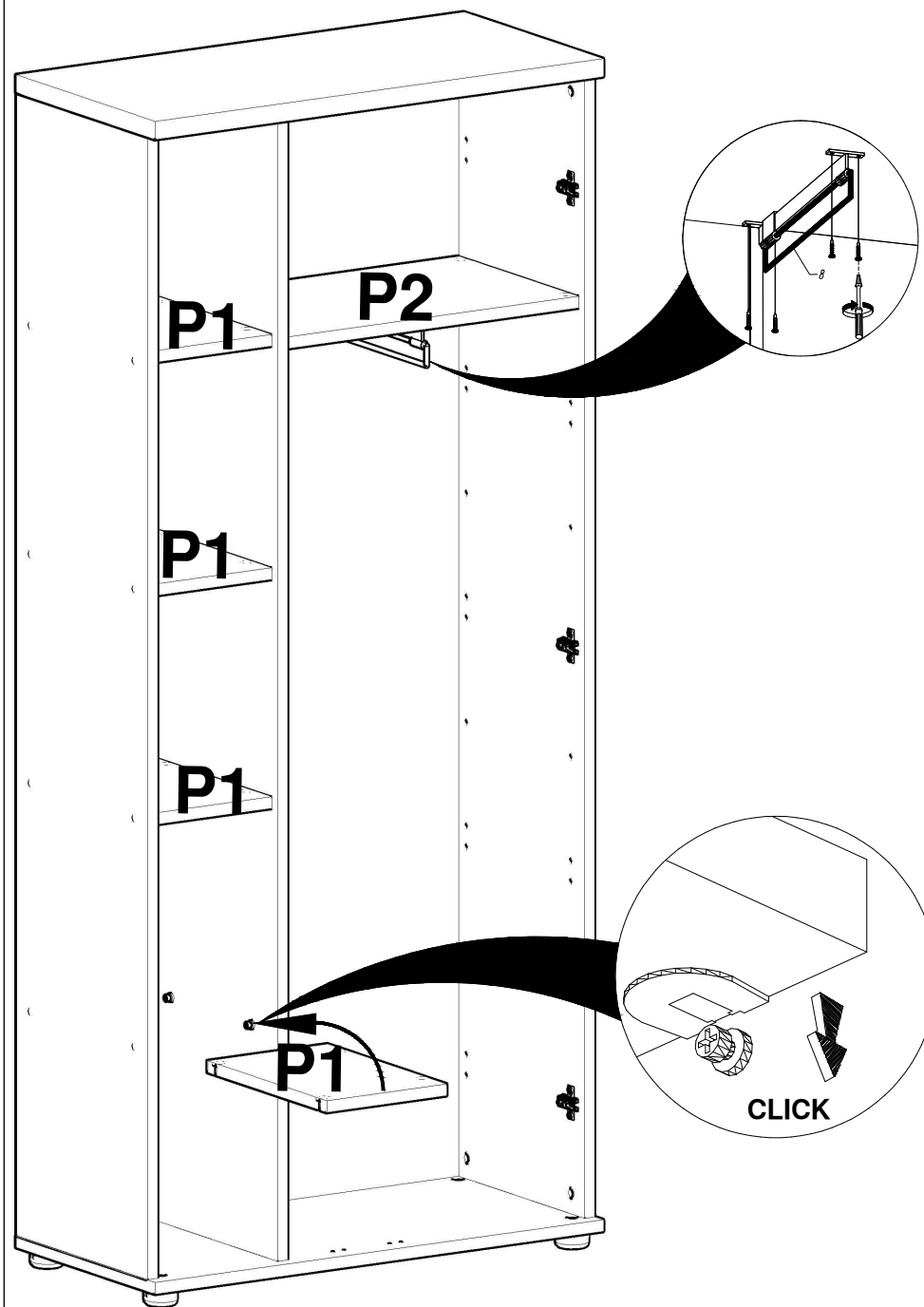

12

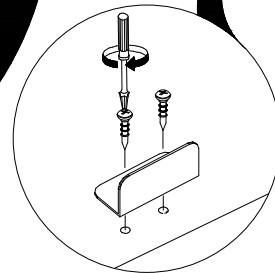
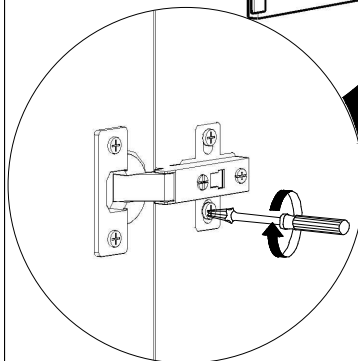
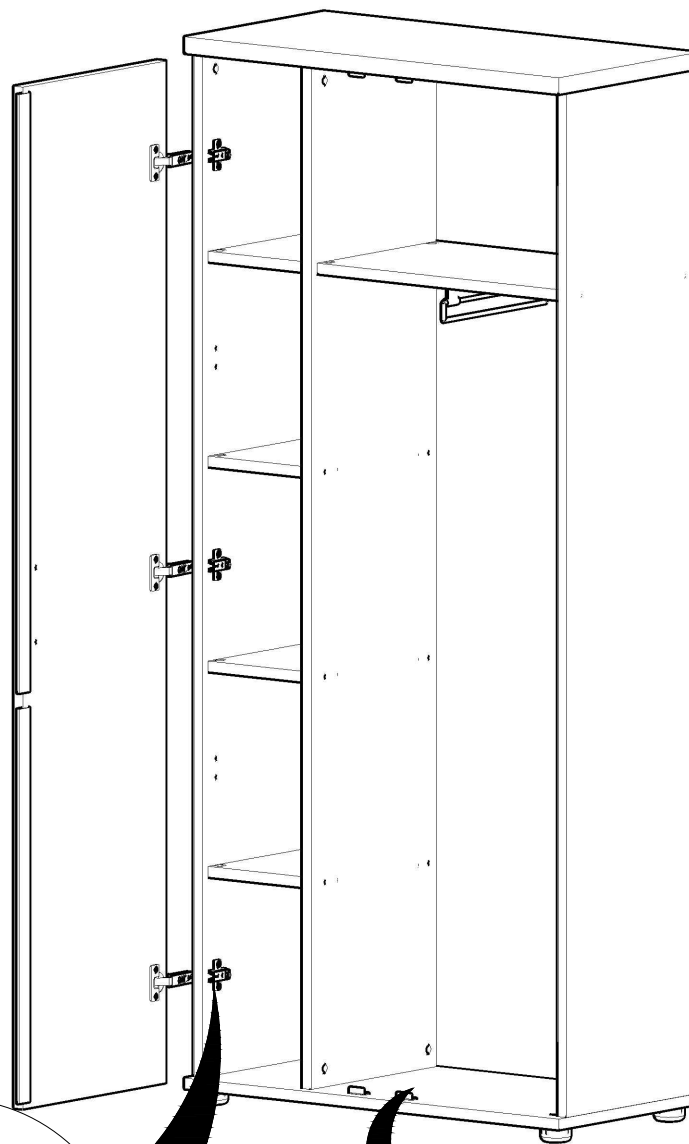
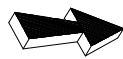
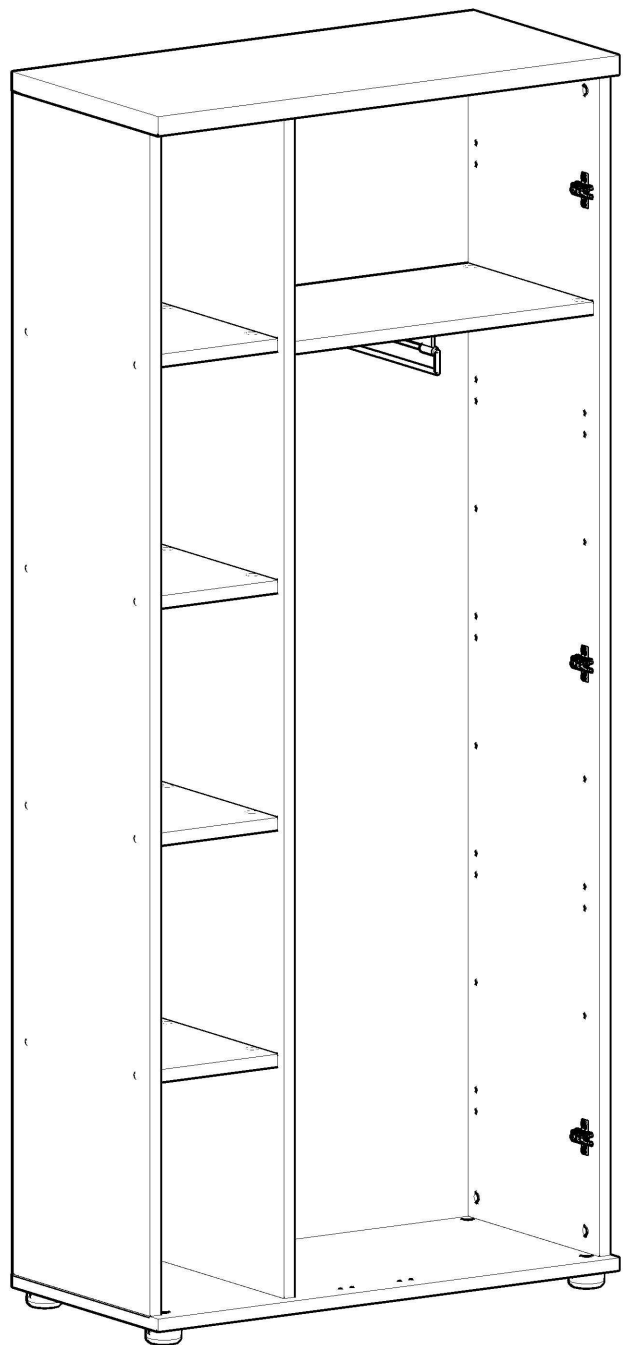

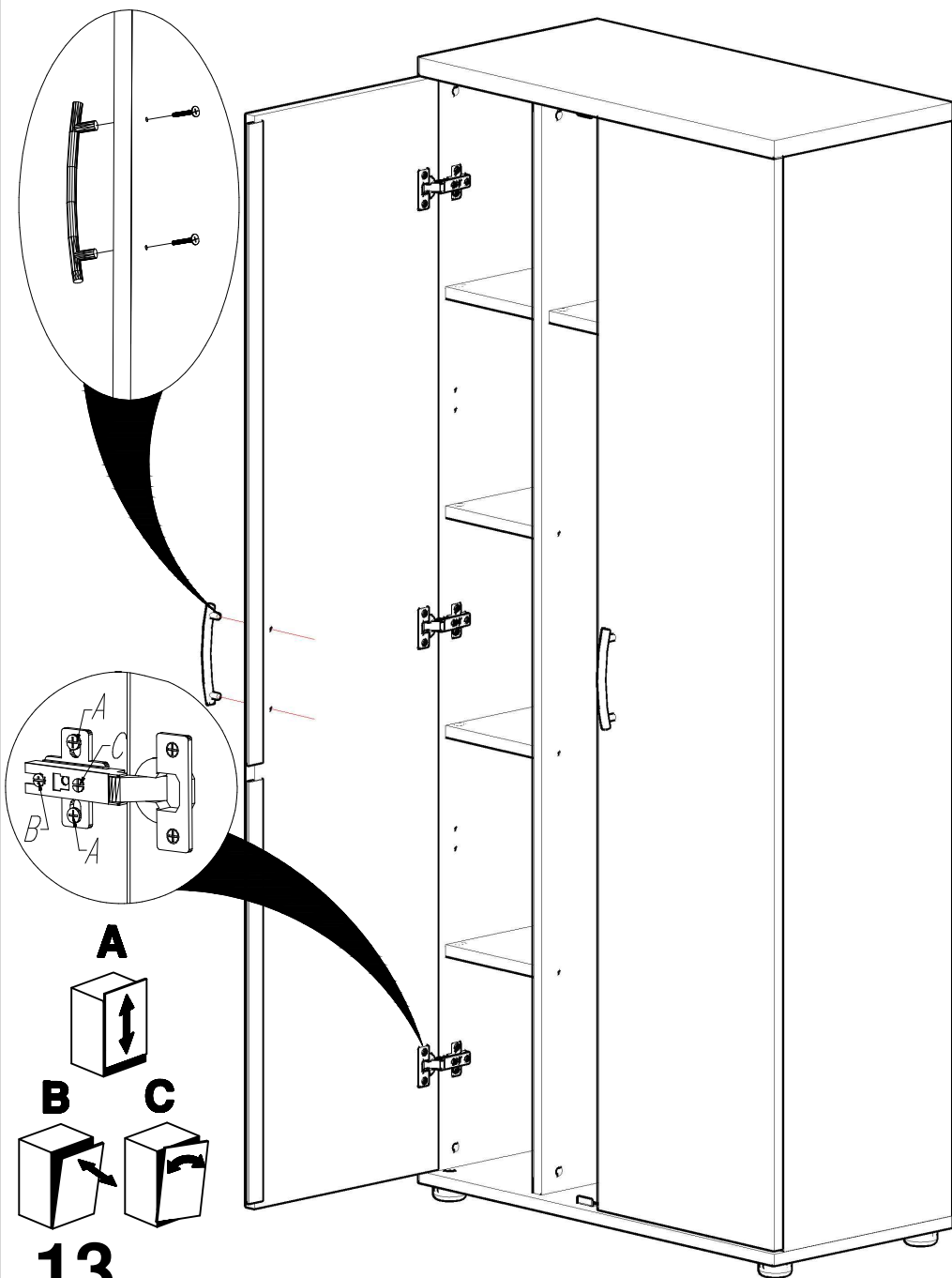

13

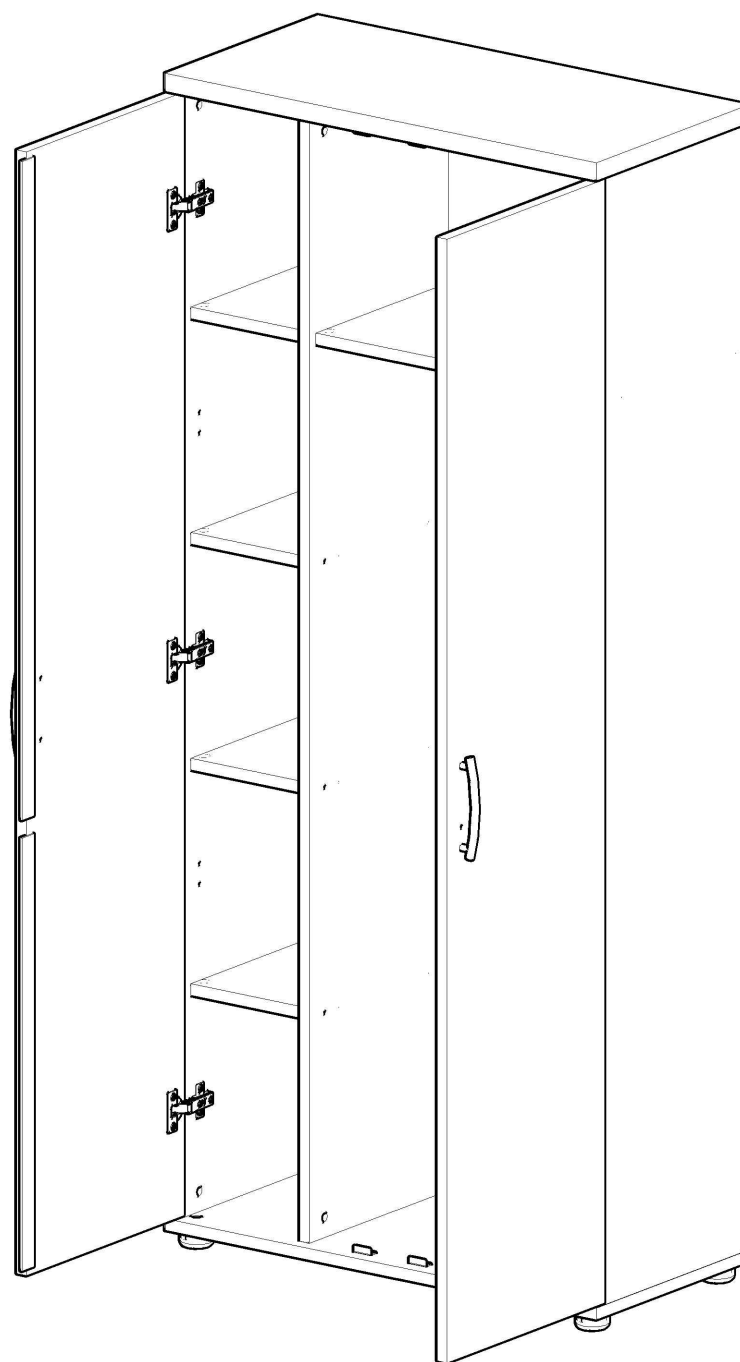

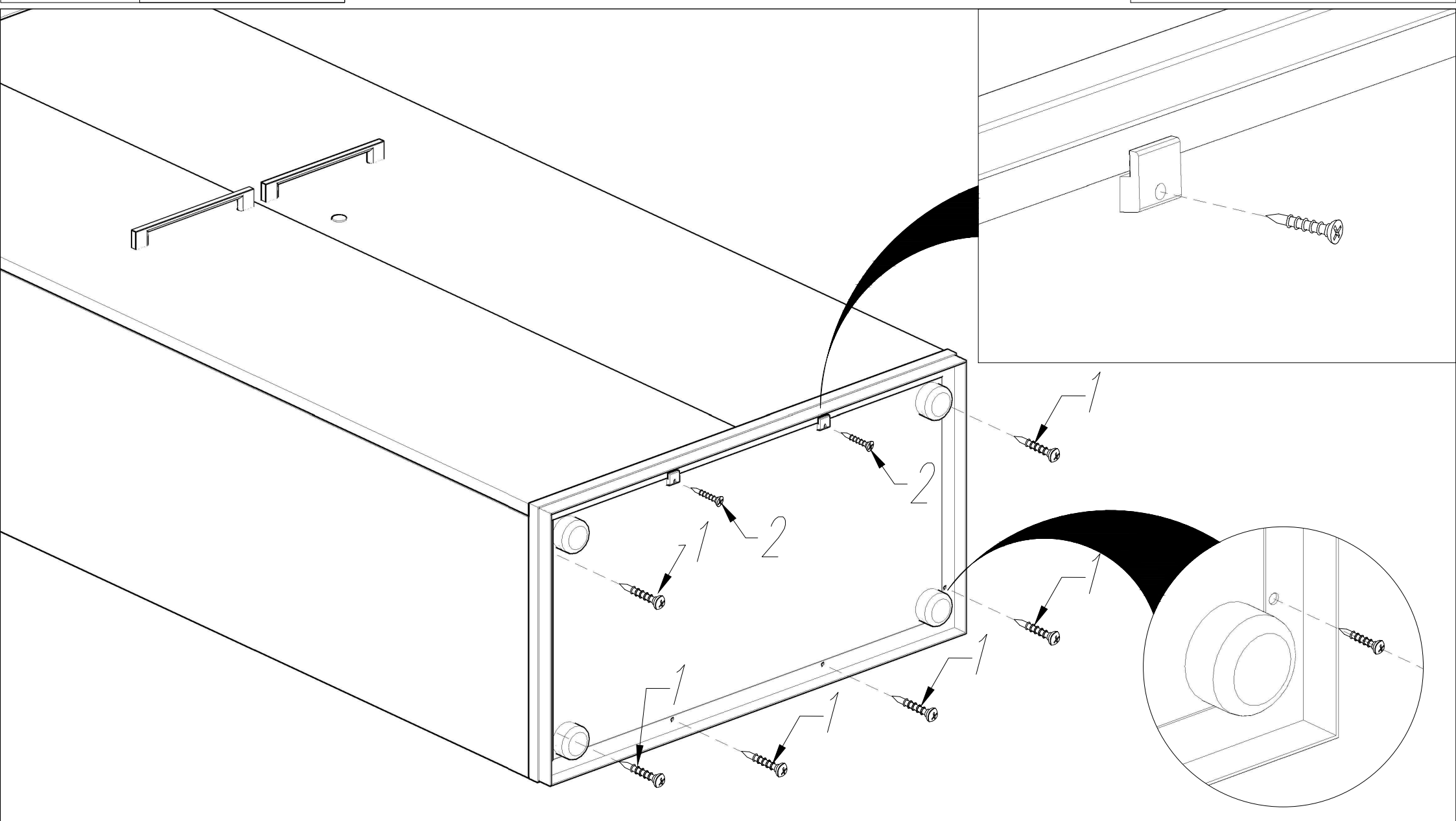
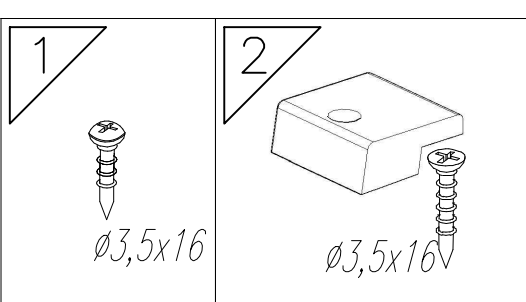

A

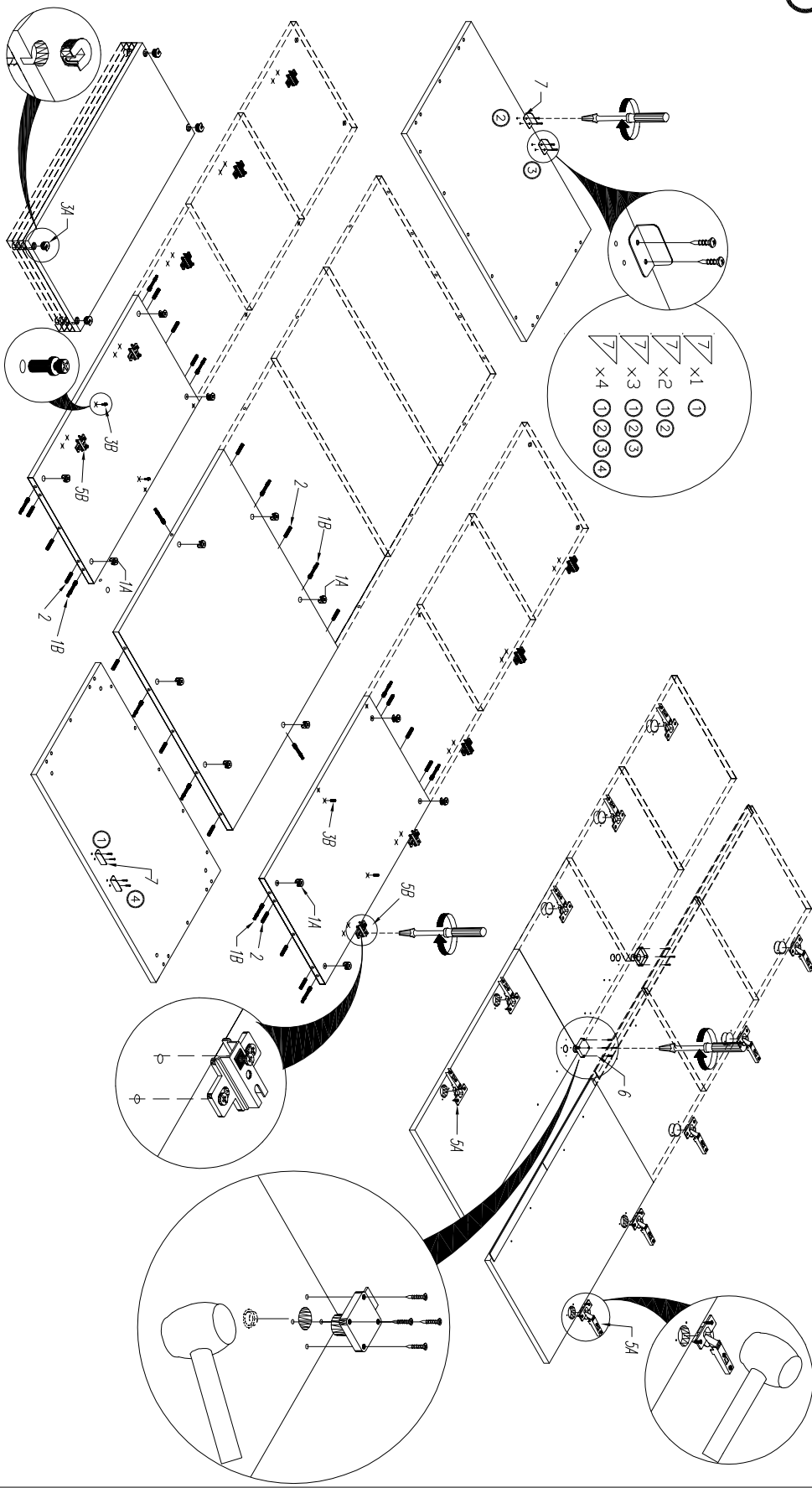

B

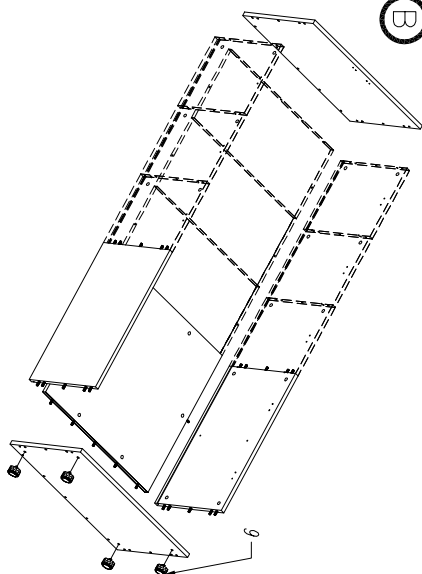

C

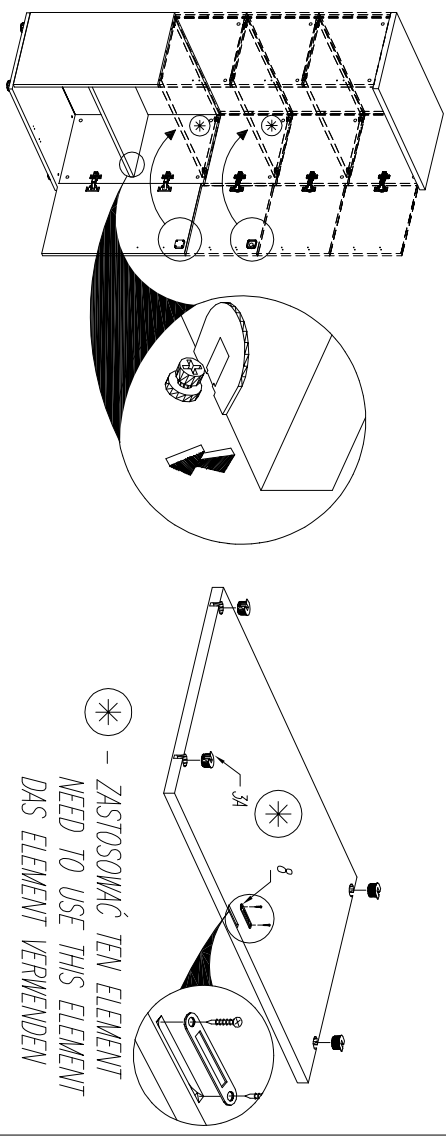

KOLEJNOŚĆ MONTAŻU
MIMOSRODOW I KOLKOW.
THE FITTINGS SEQUENCE OF THE
CAMS AND DOWELS.
DIE MONTAGEABFOLGE VON
EXZENTERN UND DÜBELN.

1

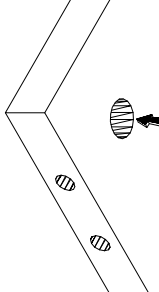

2

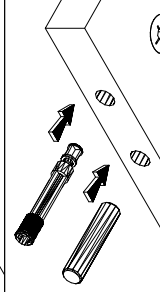

3

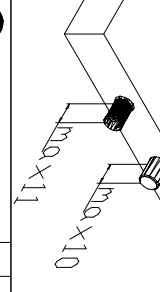

4

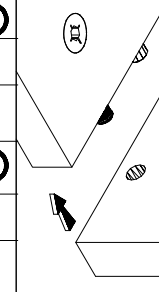

5

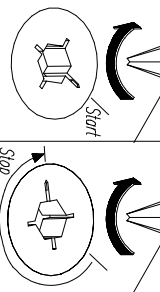

Start

Stop 225°

D

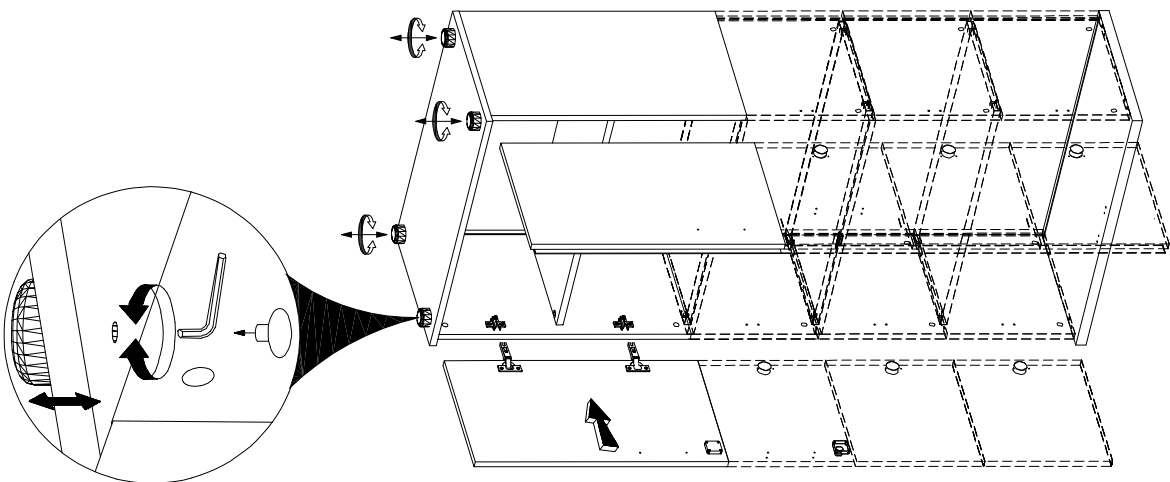

E

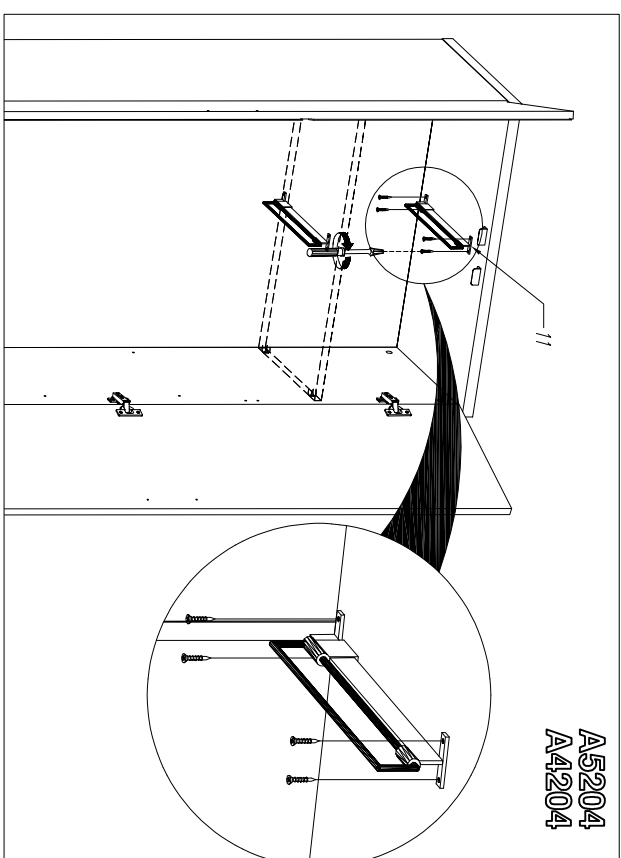
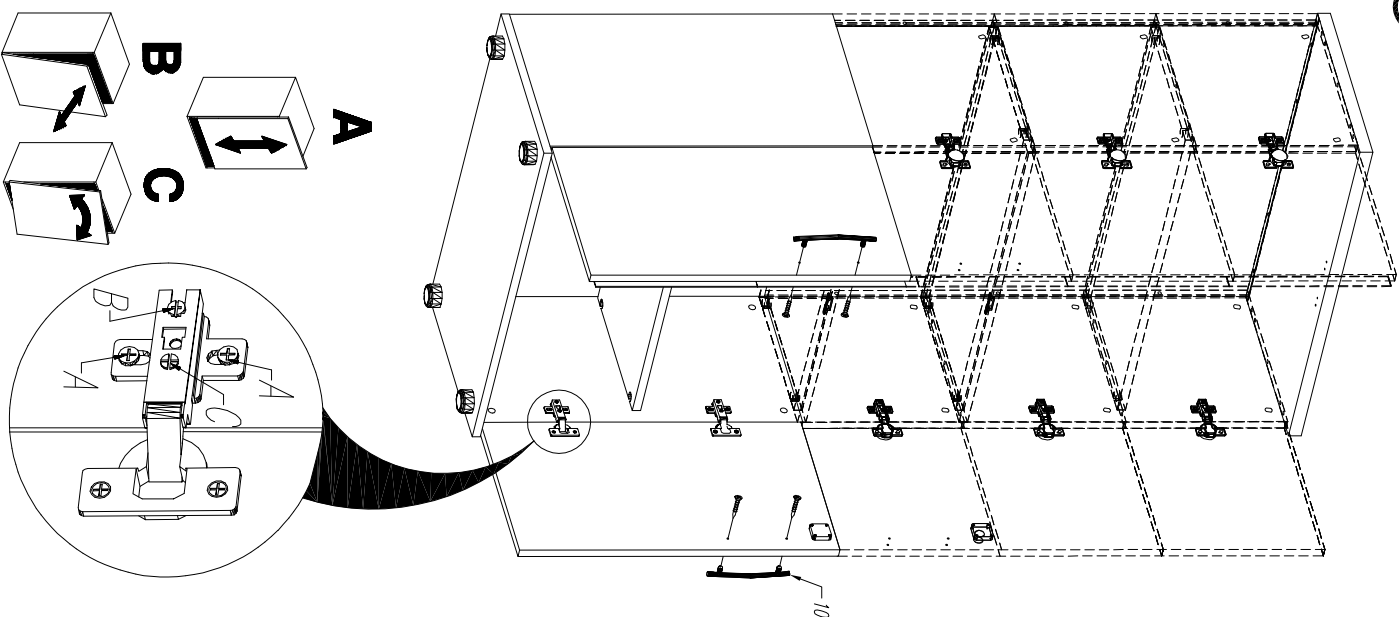

A5204
A4204

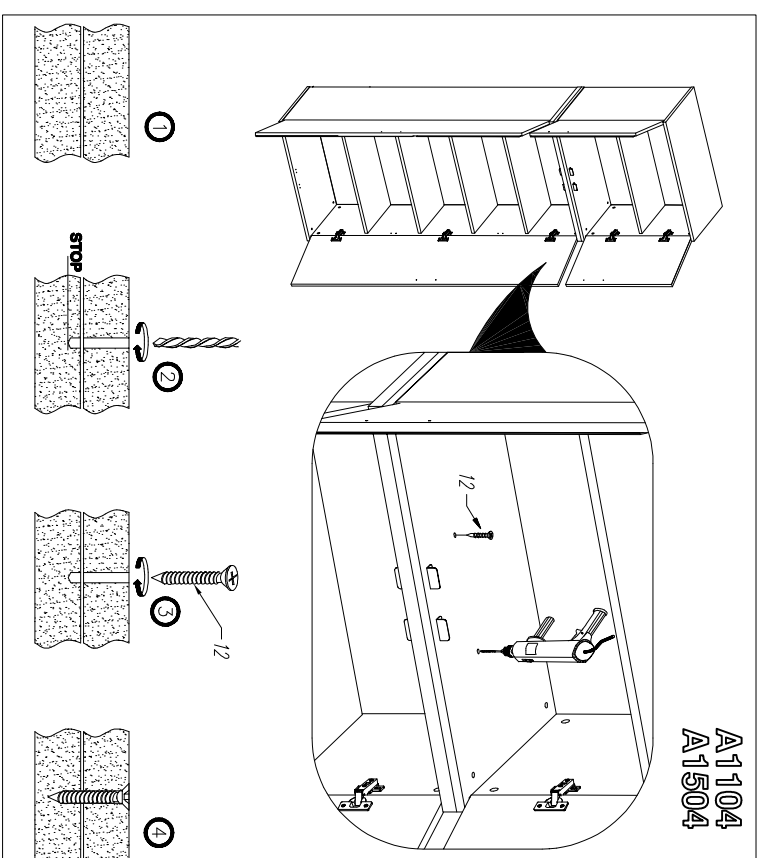

A1104
A1504

