

A5104TM

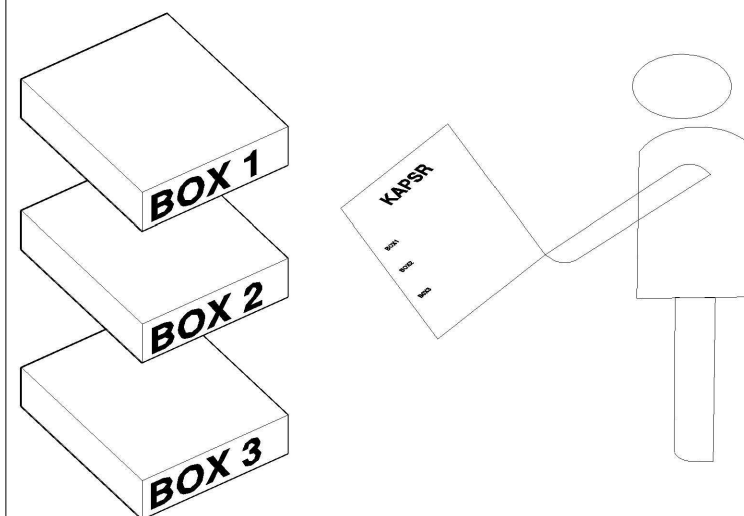

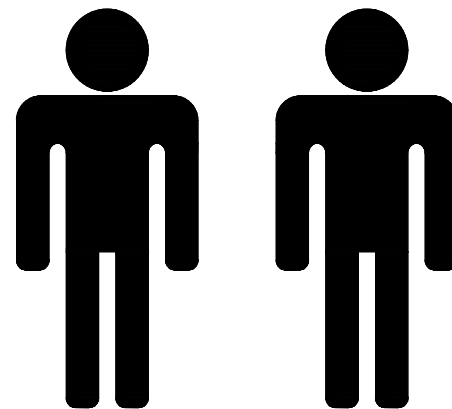

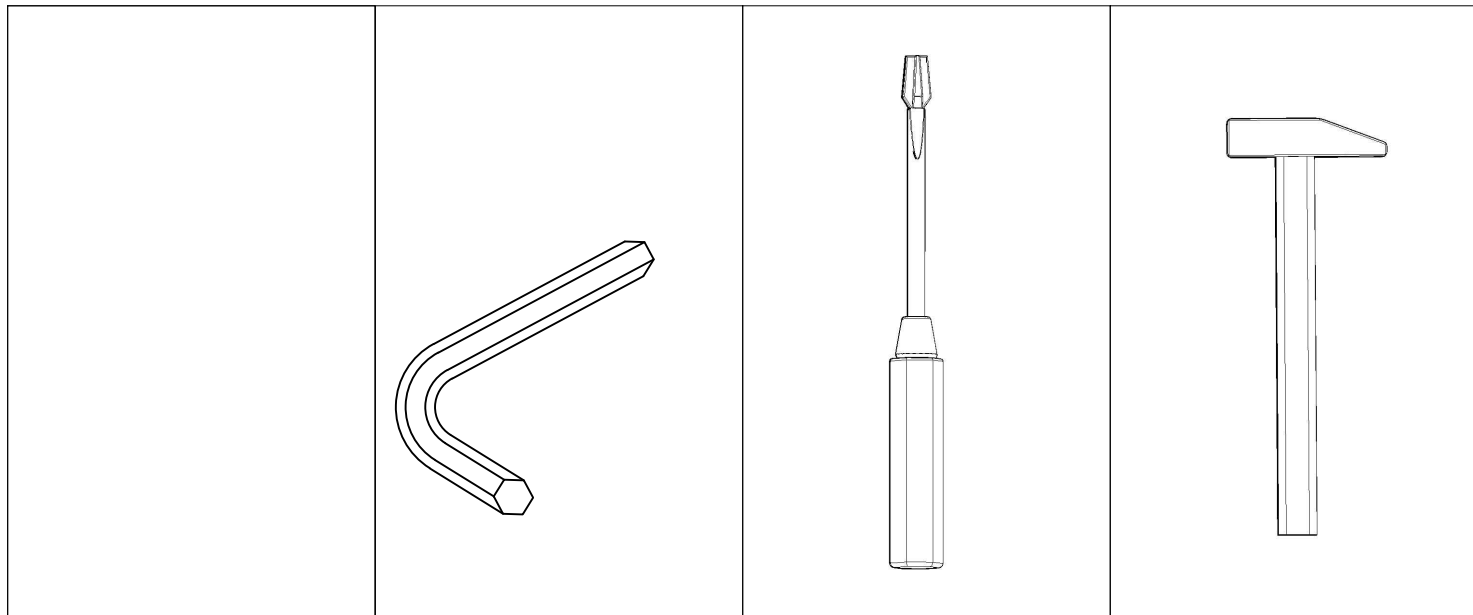

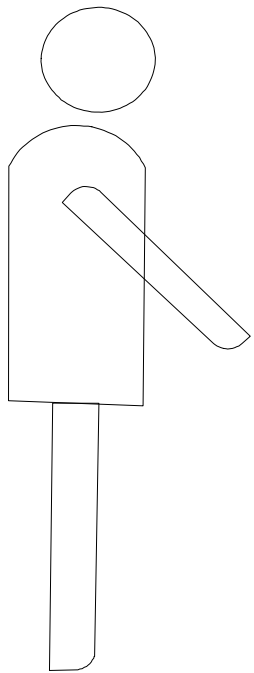
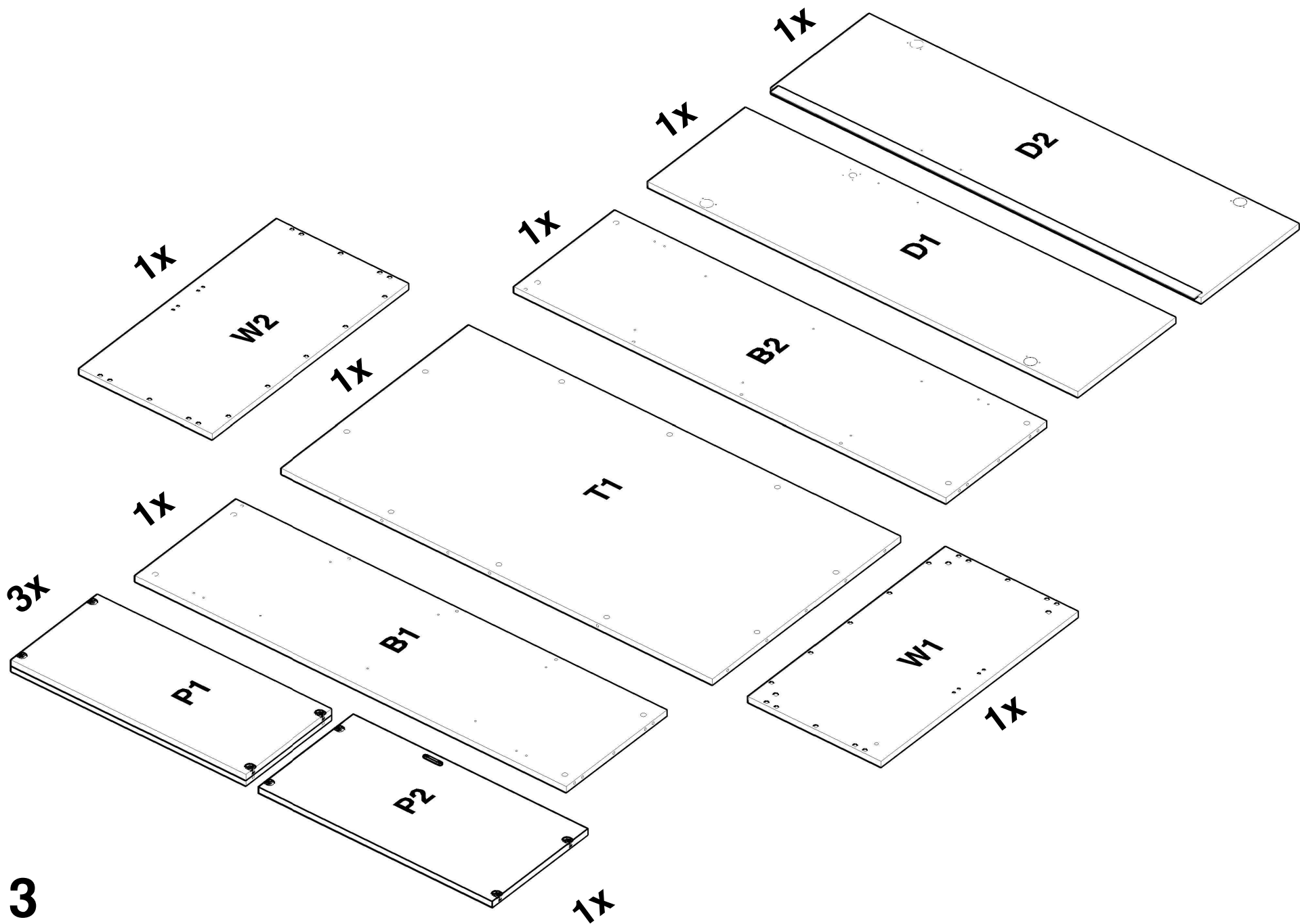
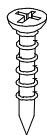

4x

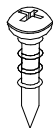

6x

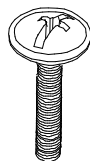

4x

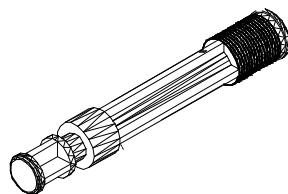

16x

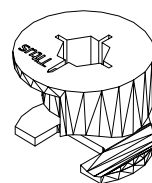

16x

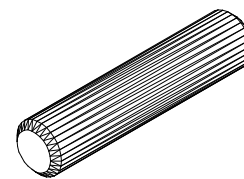

20x



12x

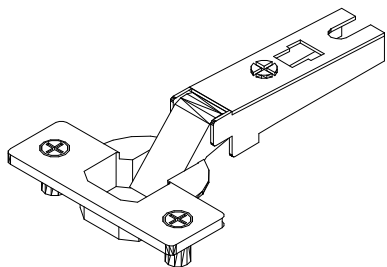

4x

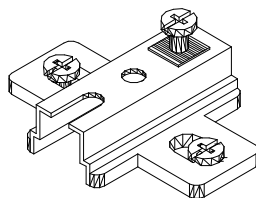

4x

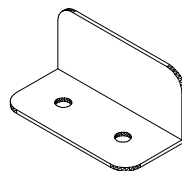

3x

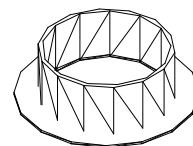

1x

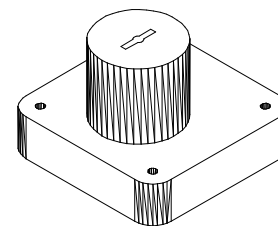

1x

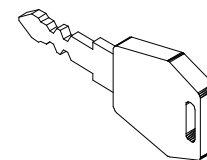

2x

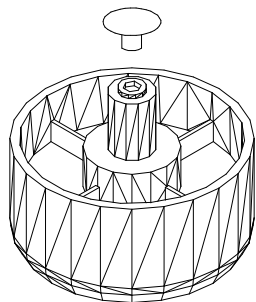

4x

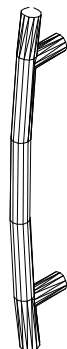

2x

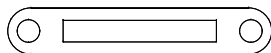

1x

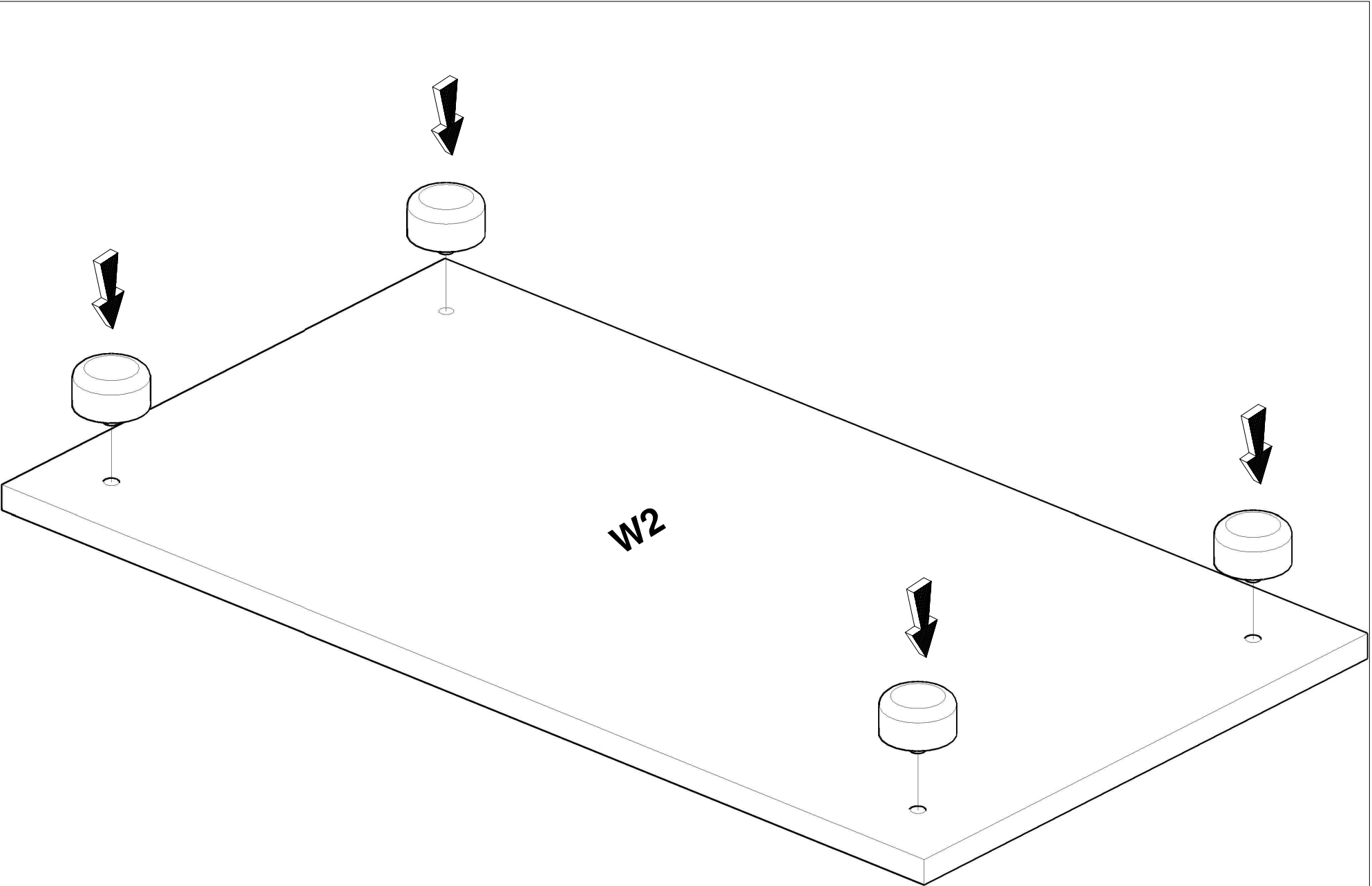

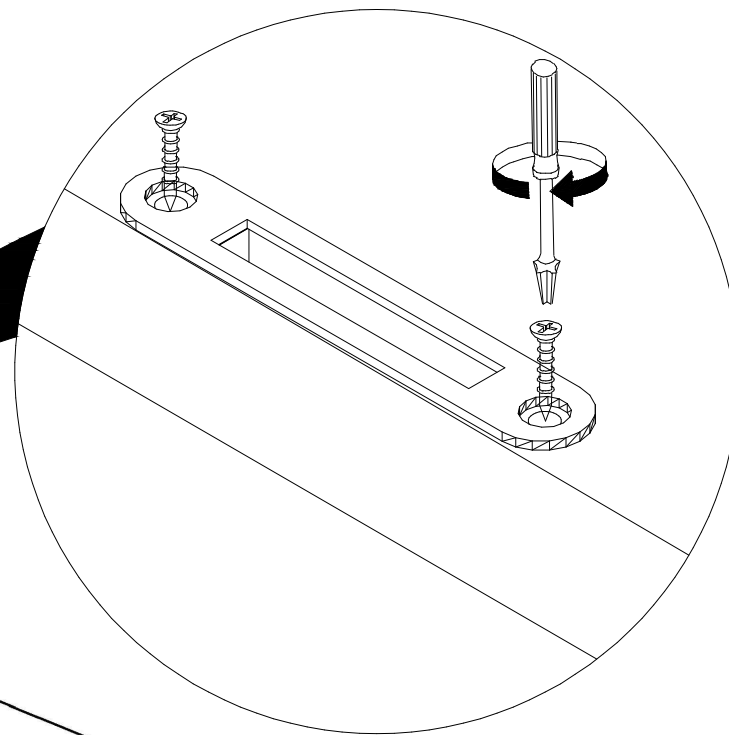
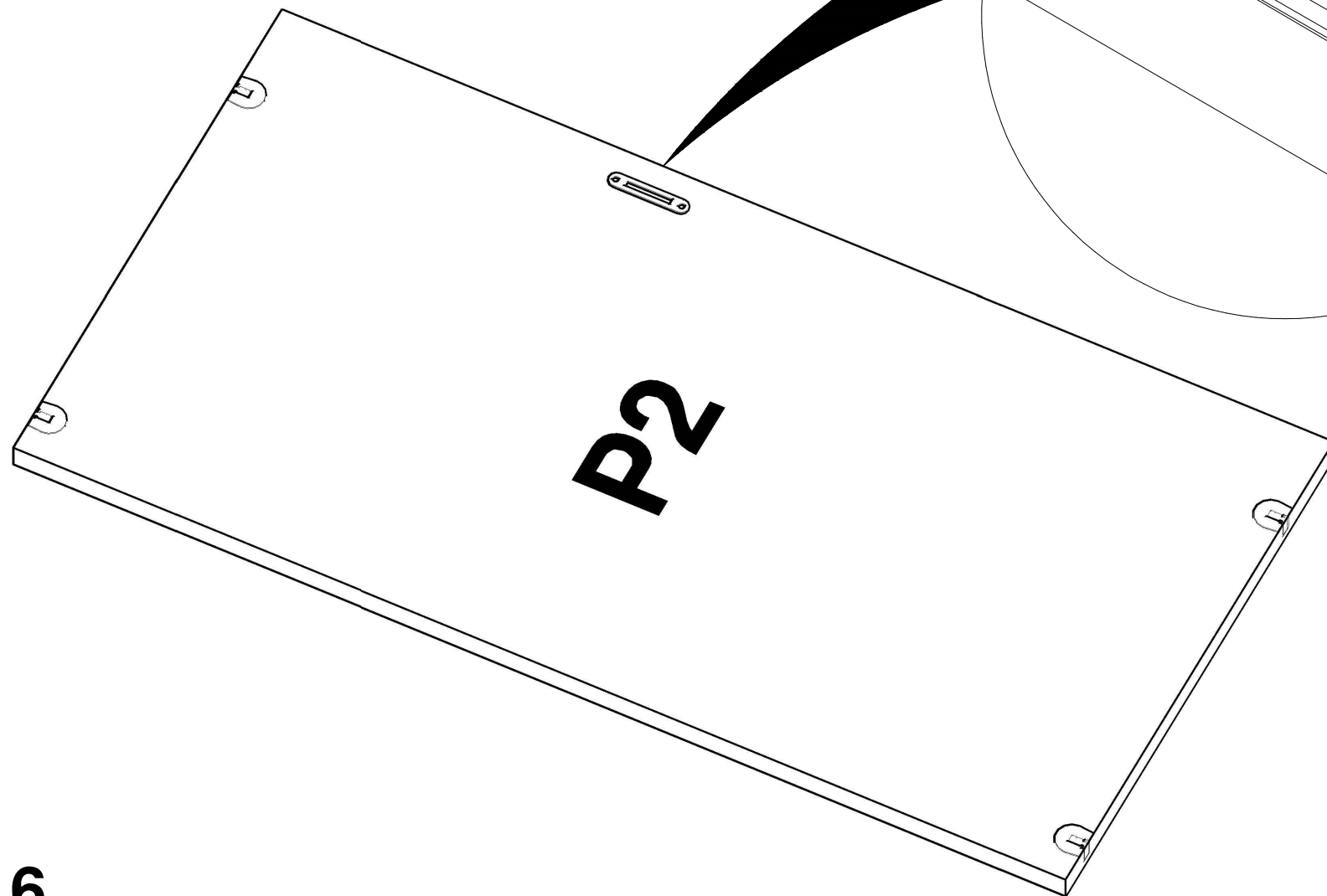

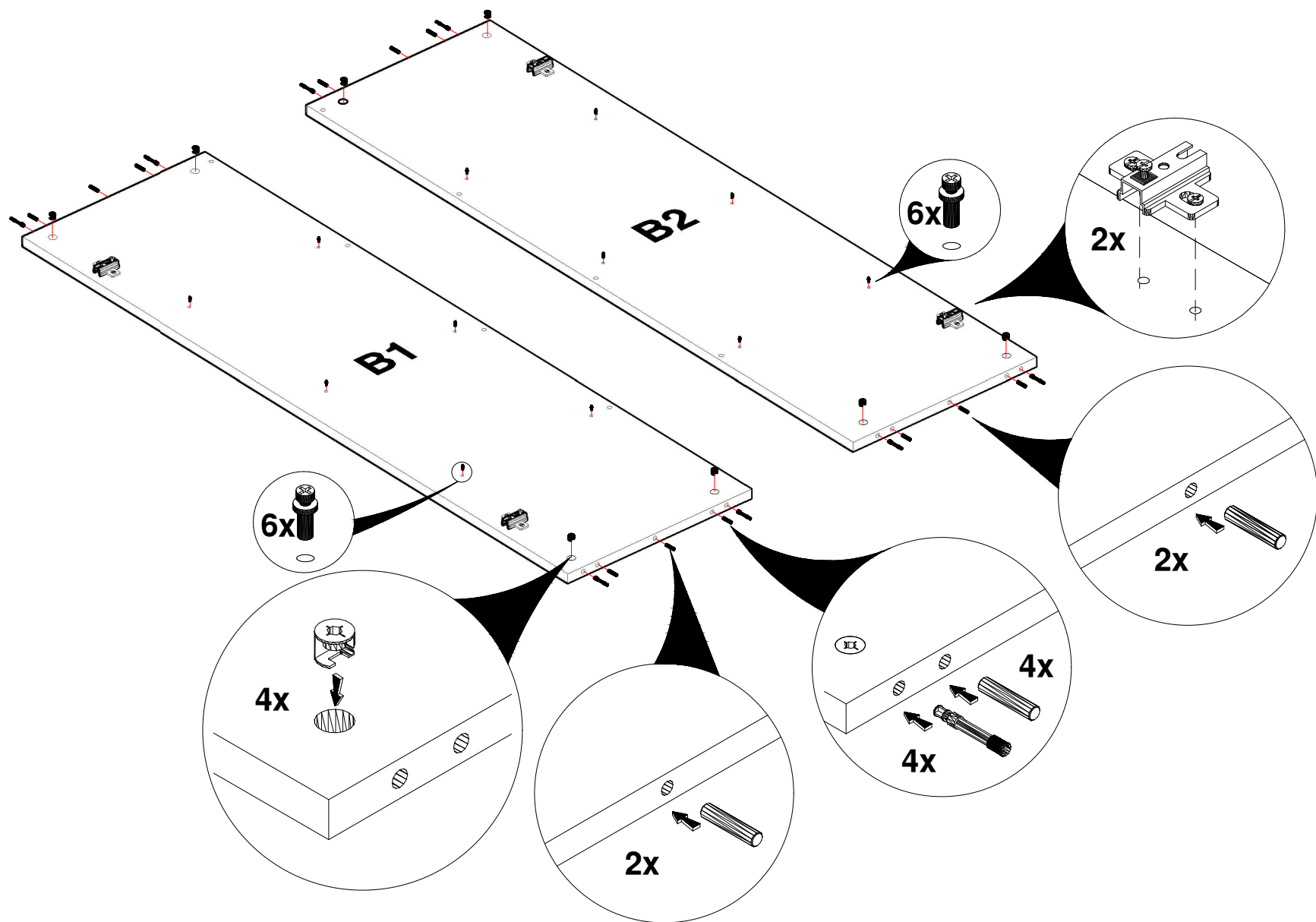

8

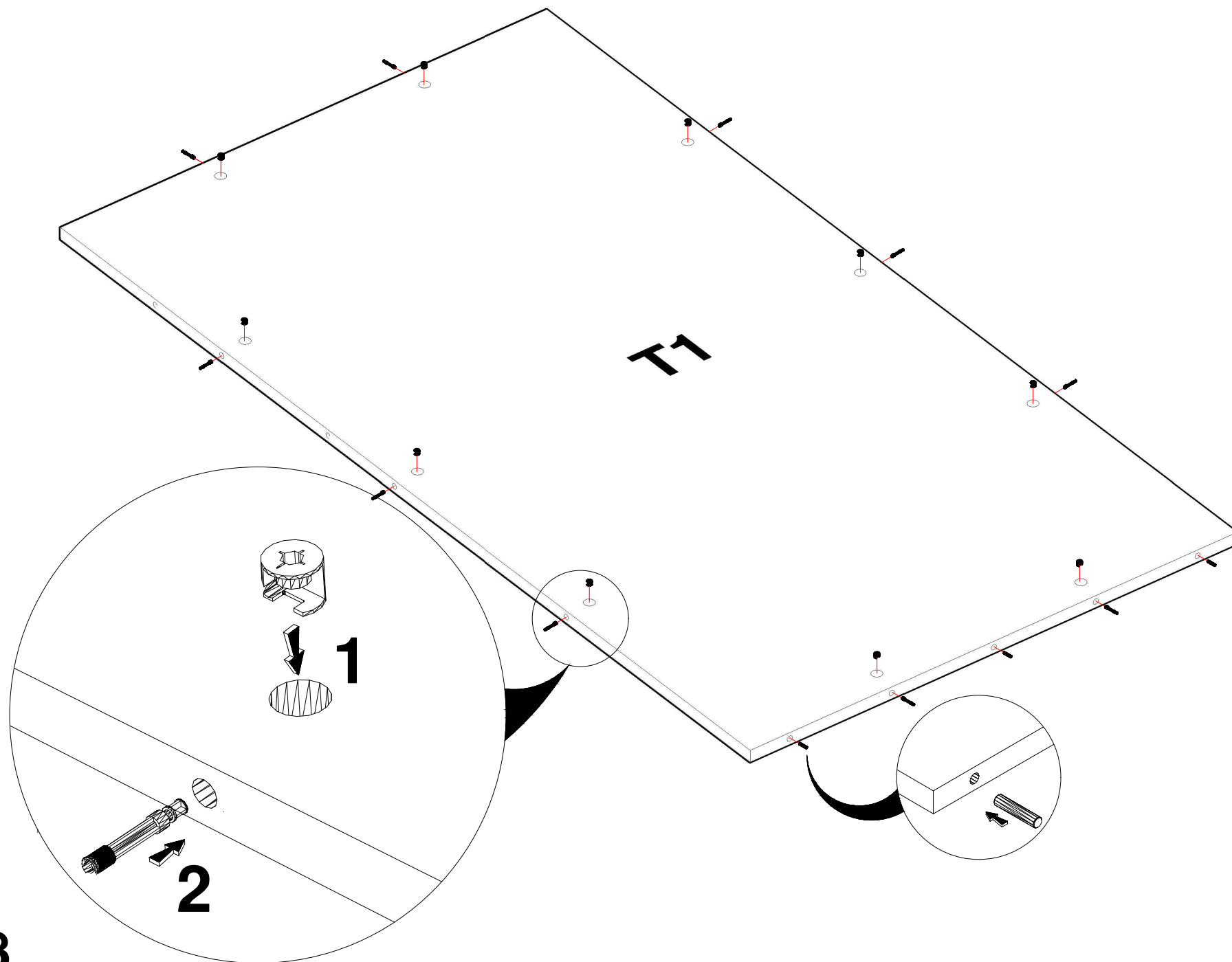

9

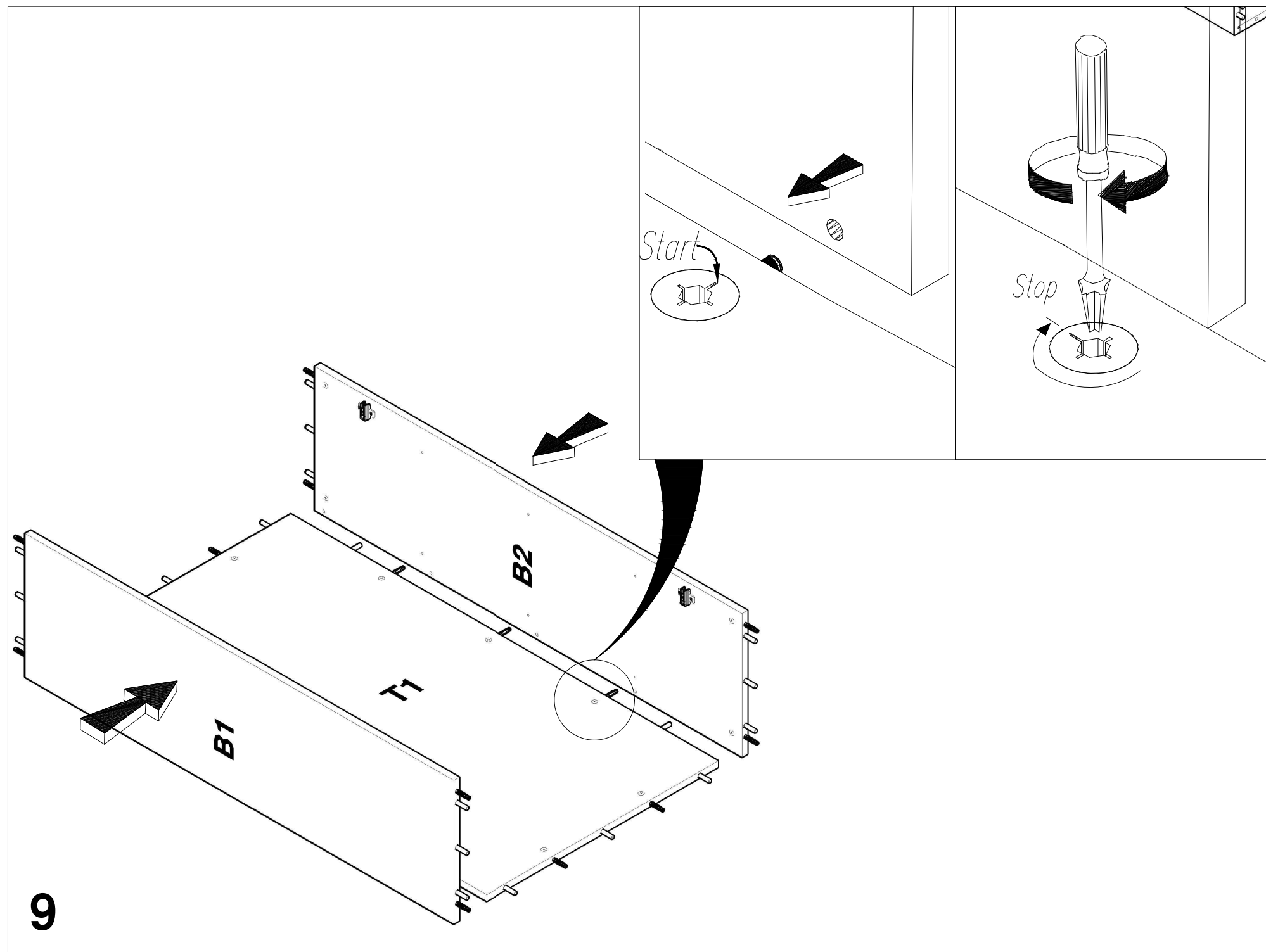

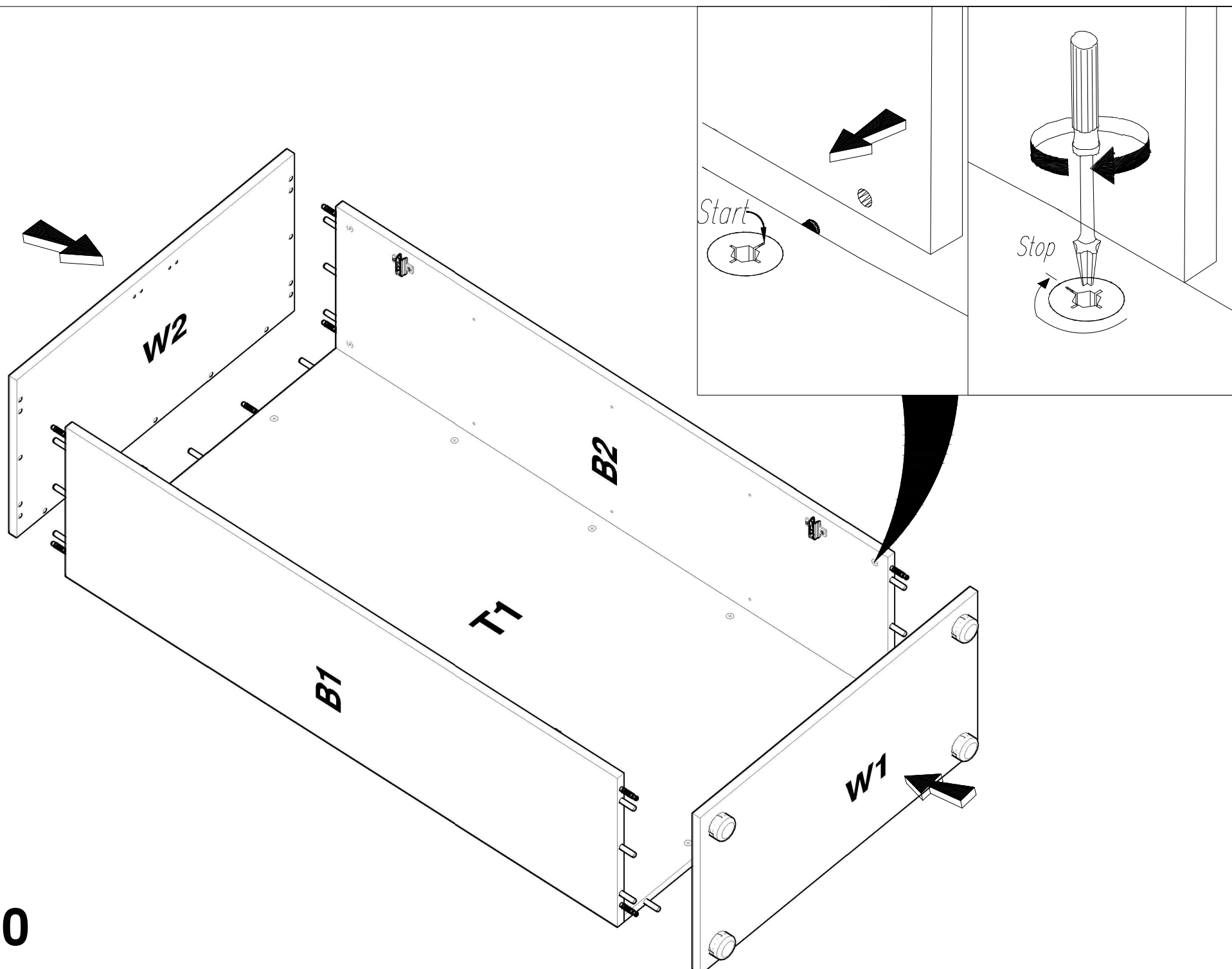

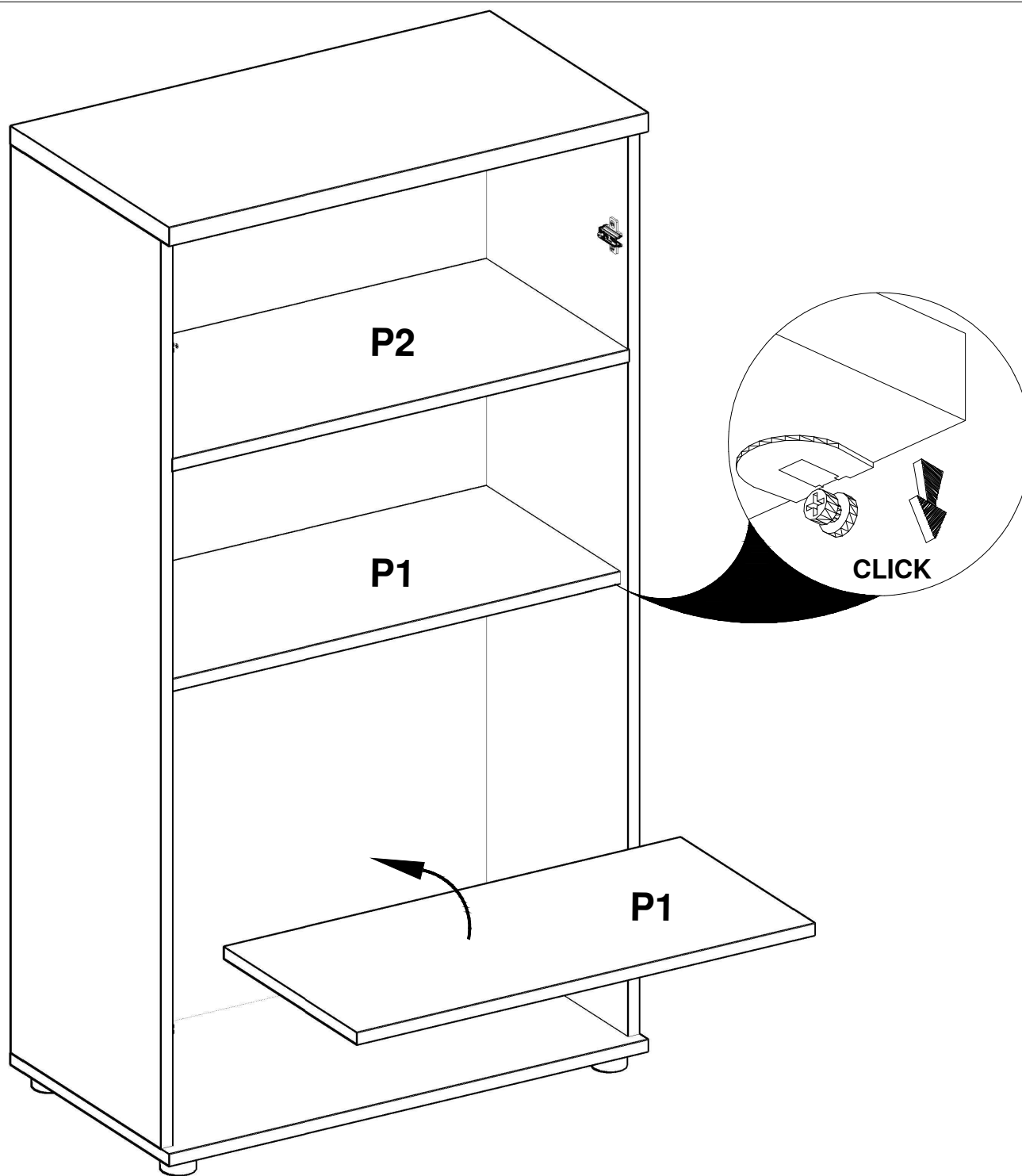

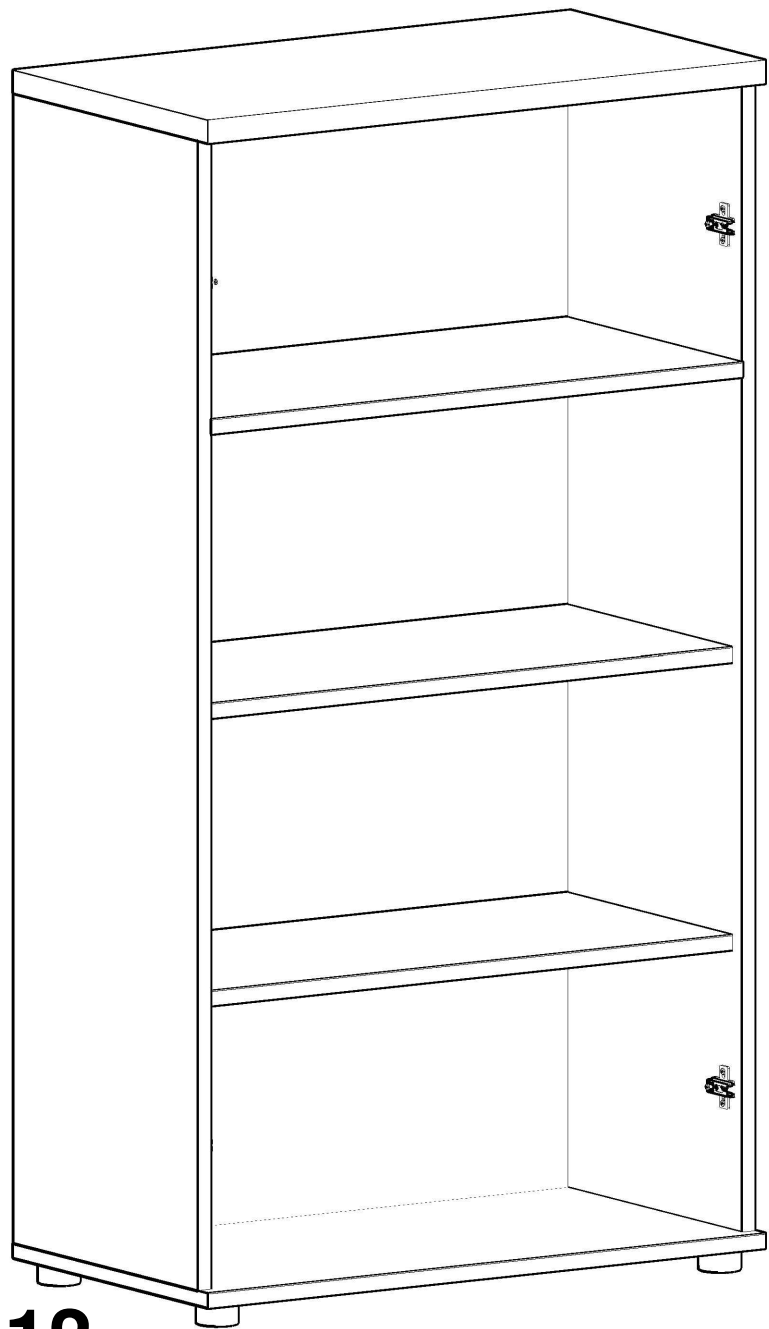

12

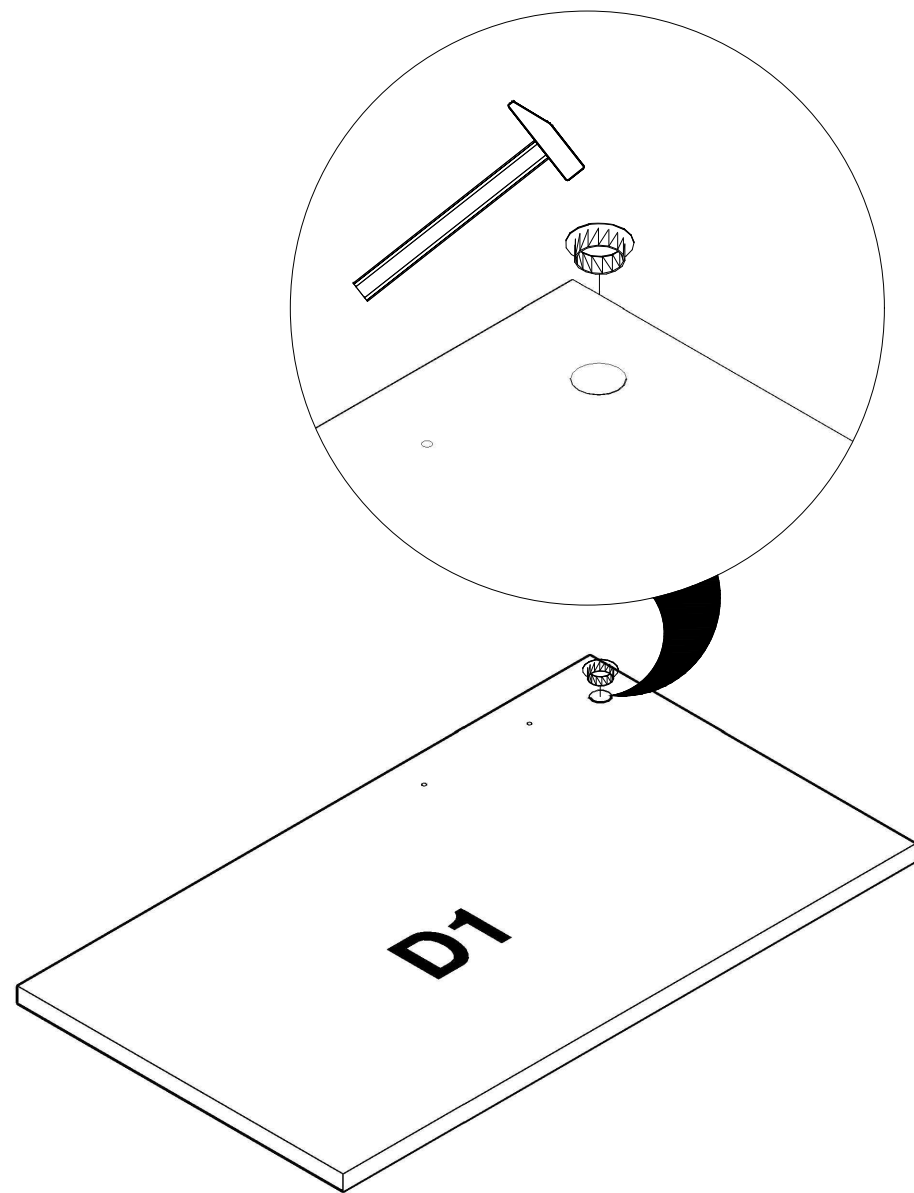

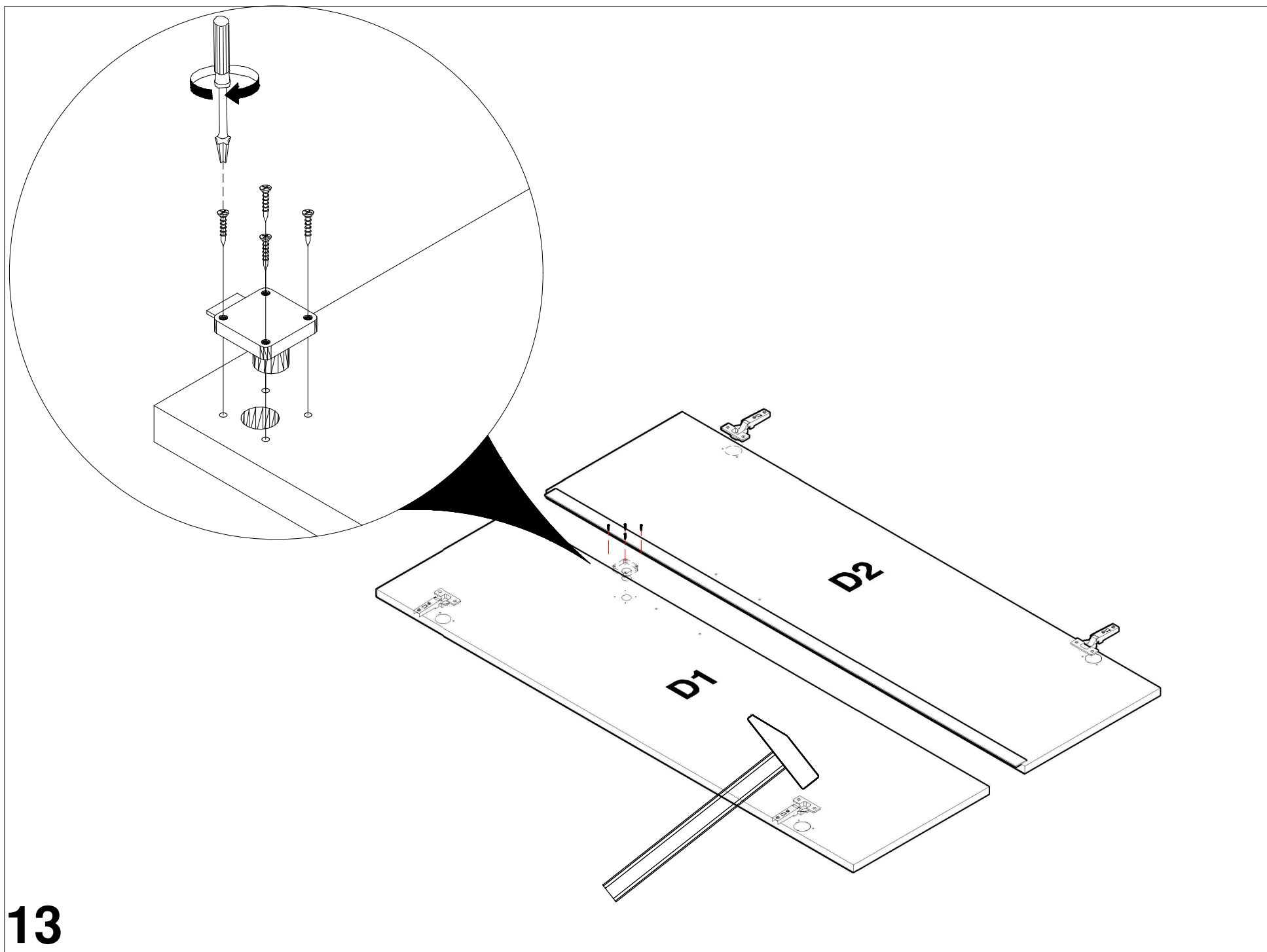

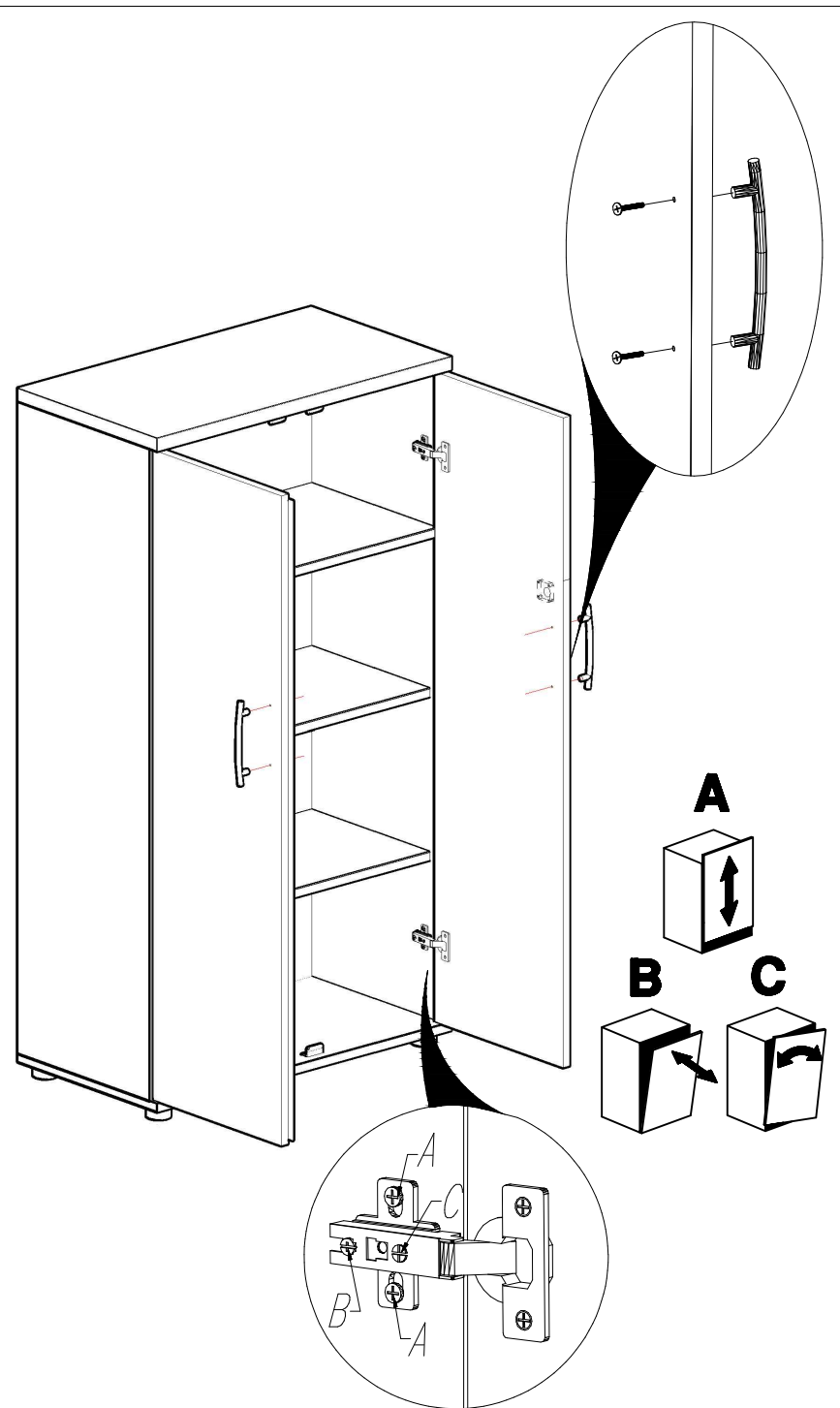
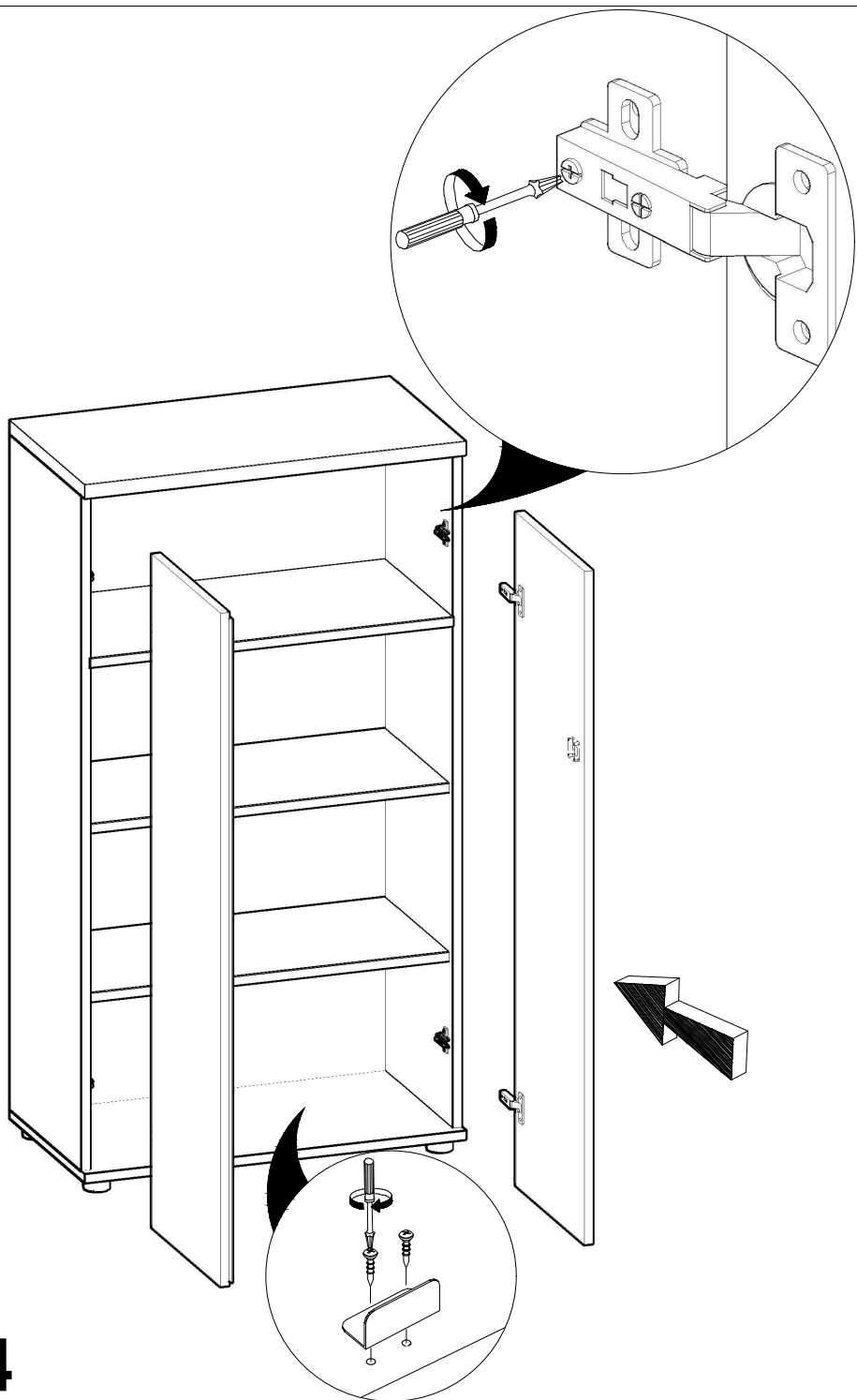

A52P4

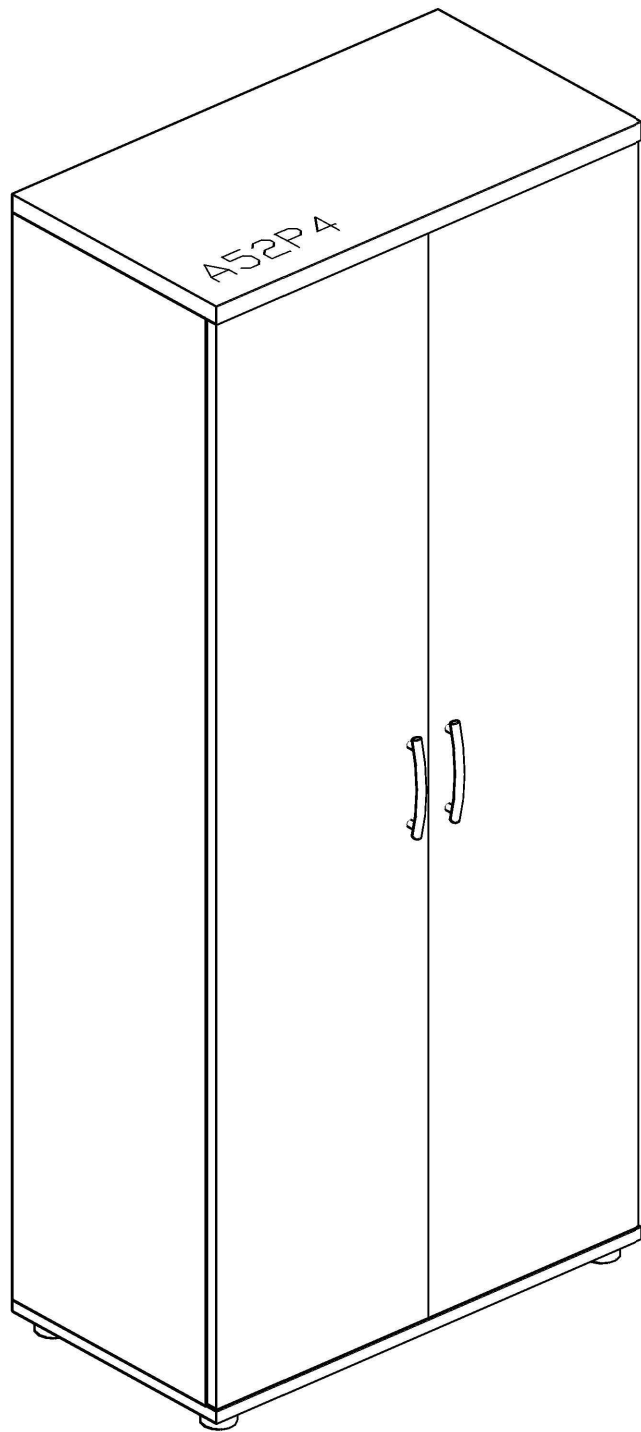

1

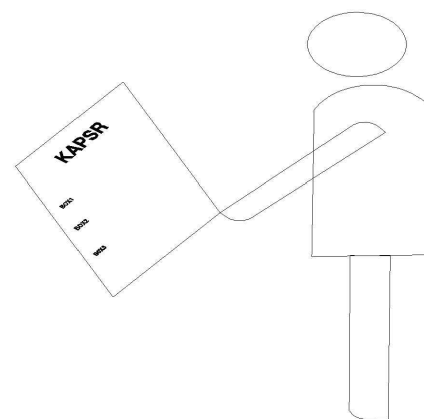
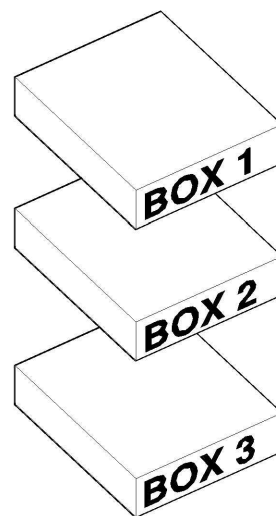

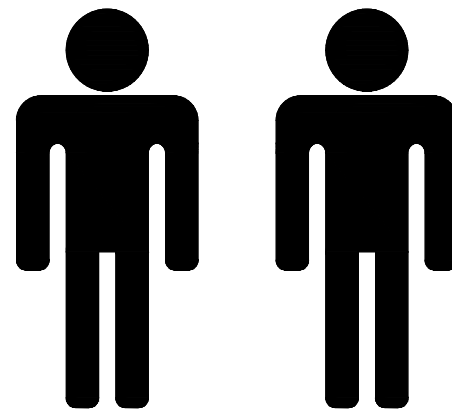
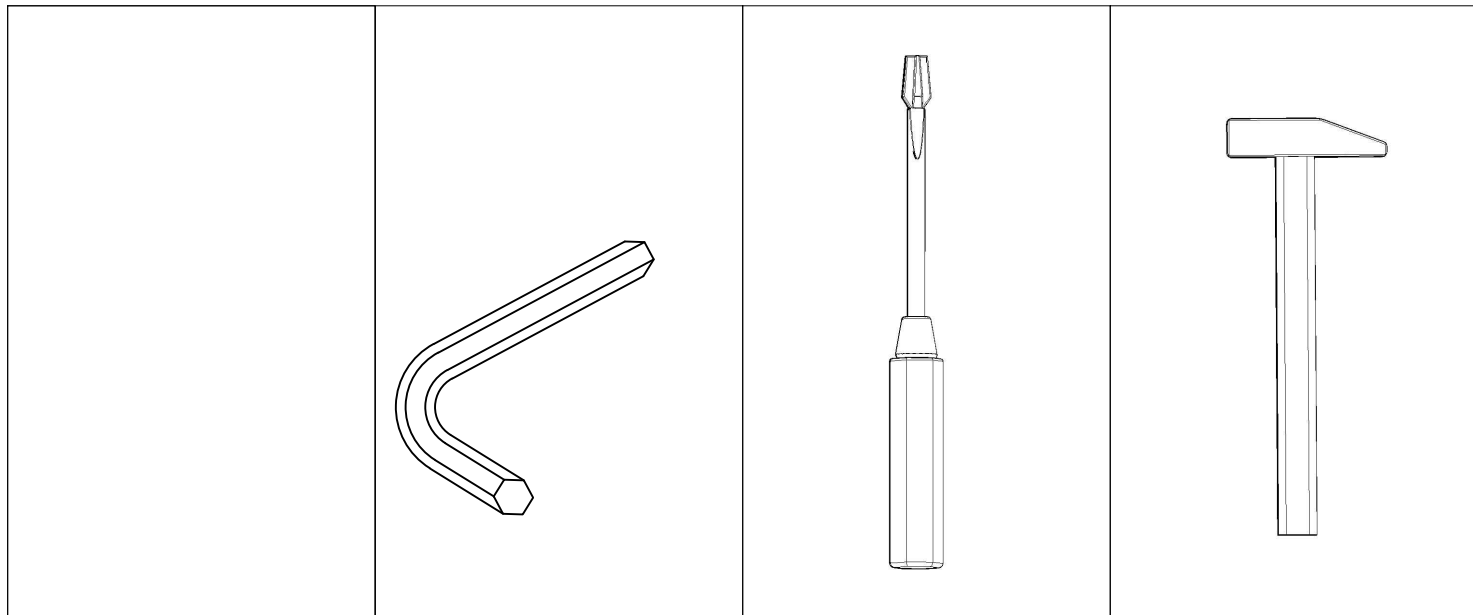
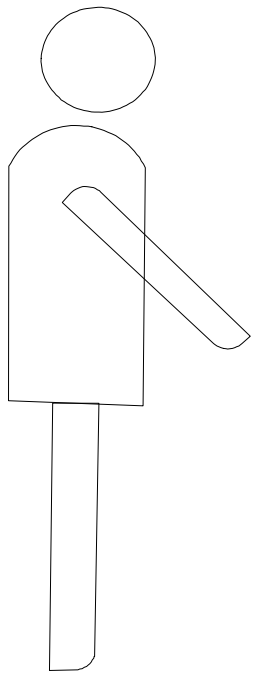

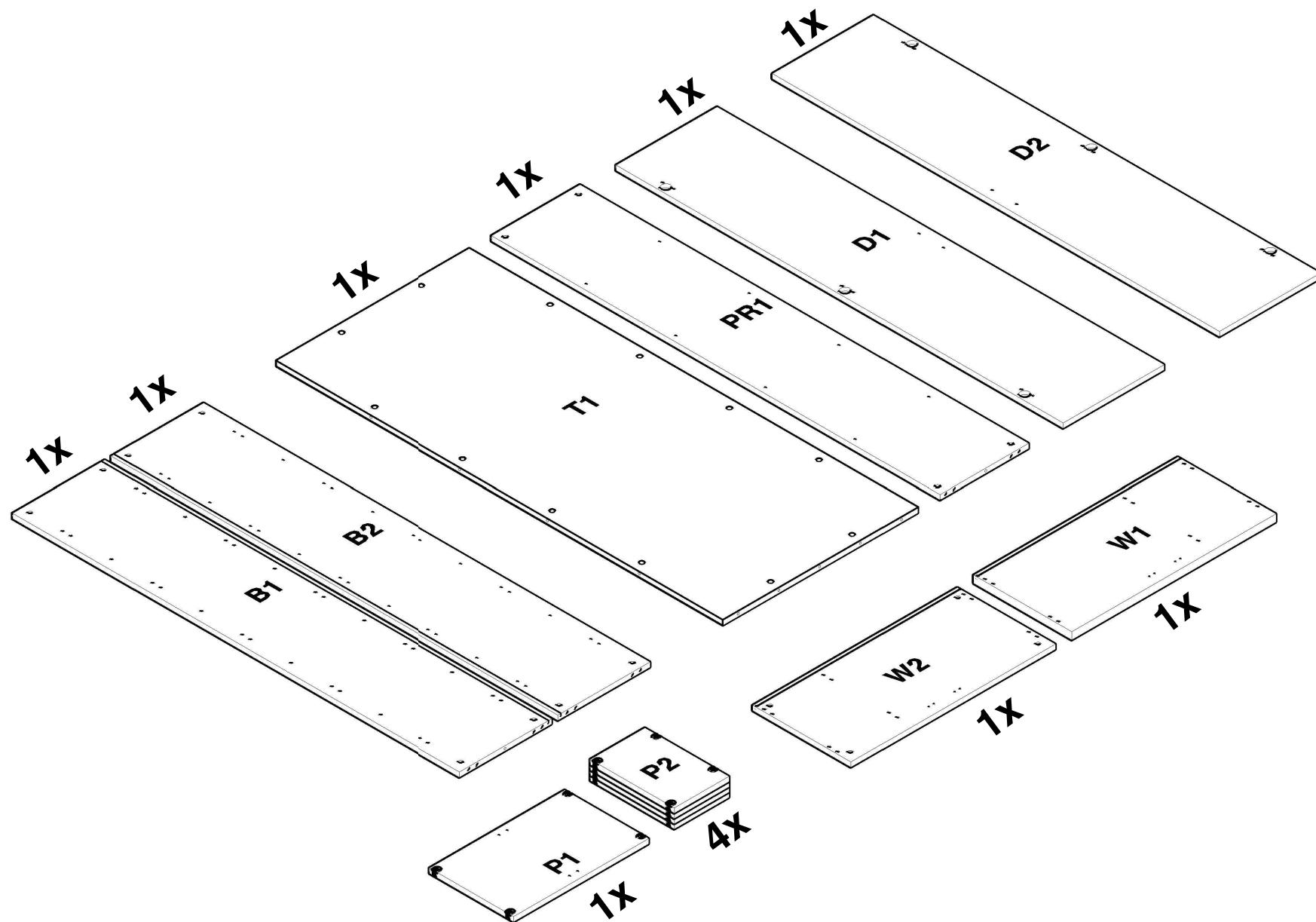

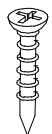

8x

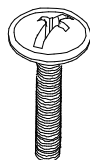

4x

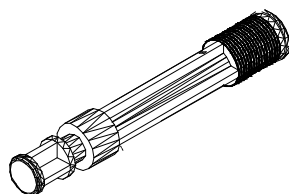

24x

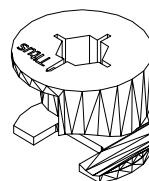

24x

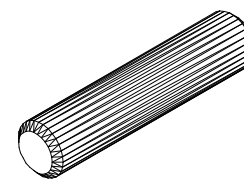

22x



20

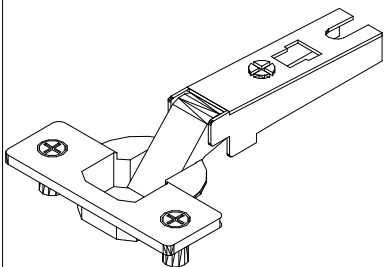

6x

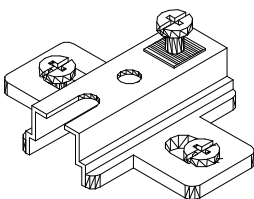

6x

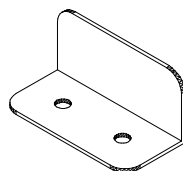

2x

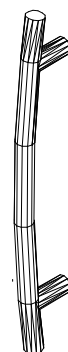

2x

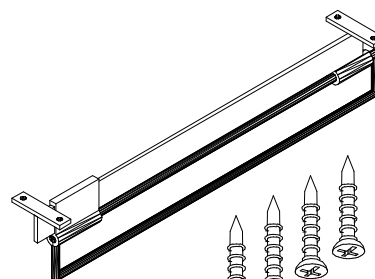

1x



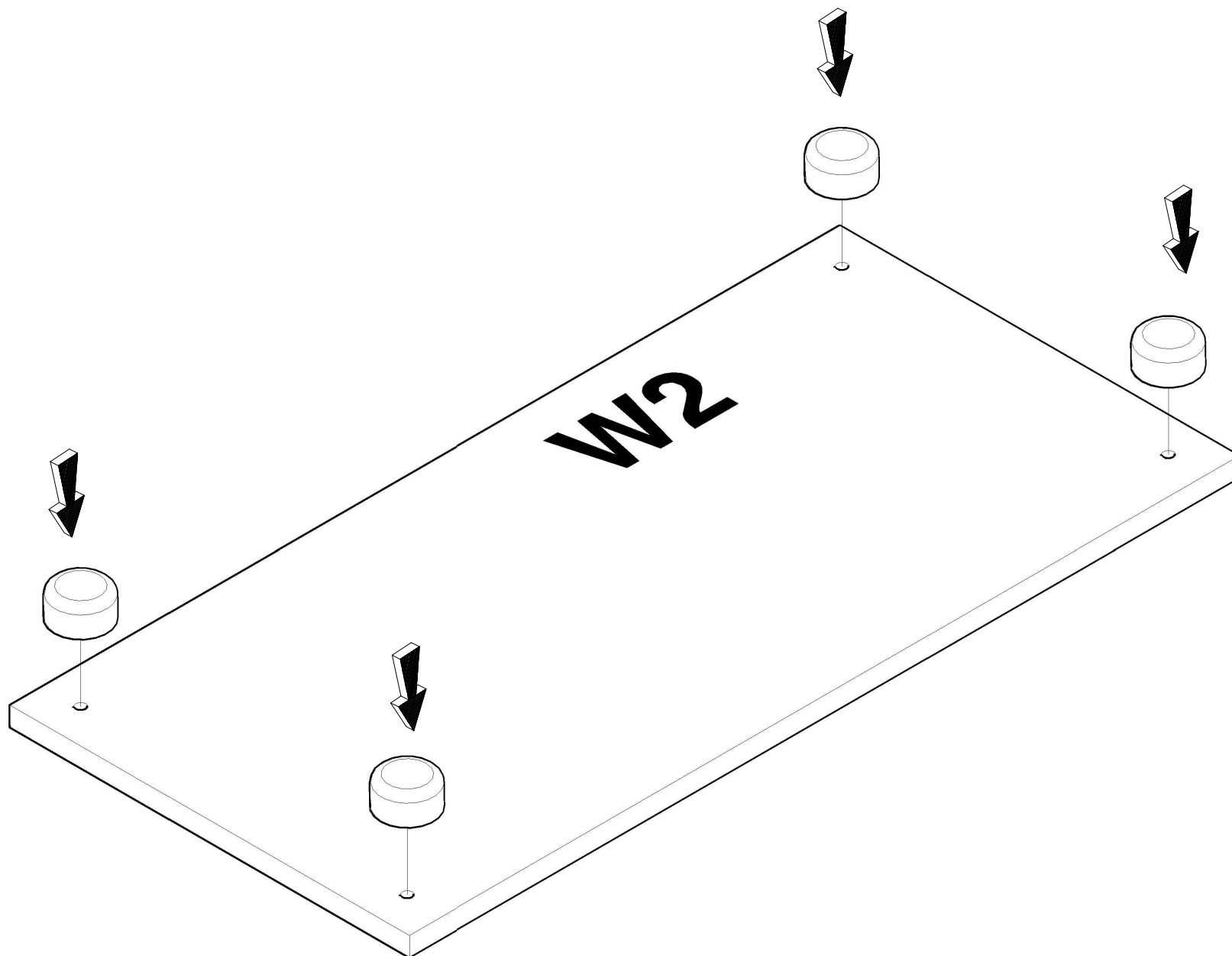

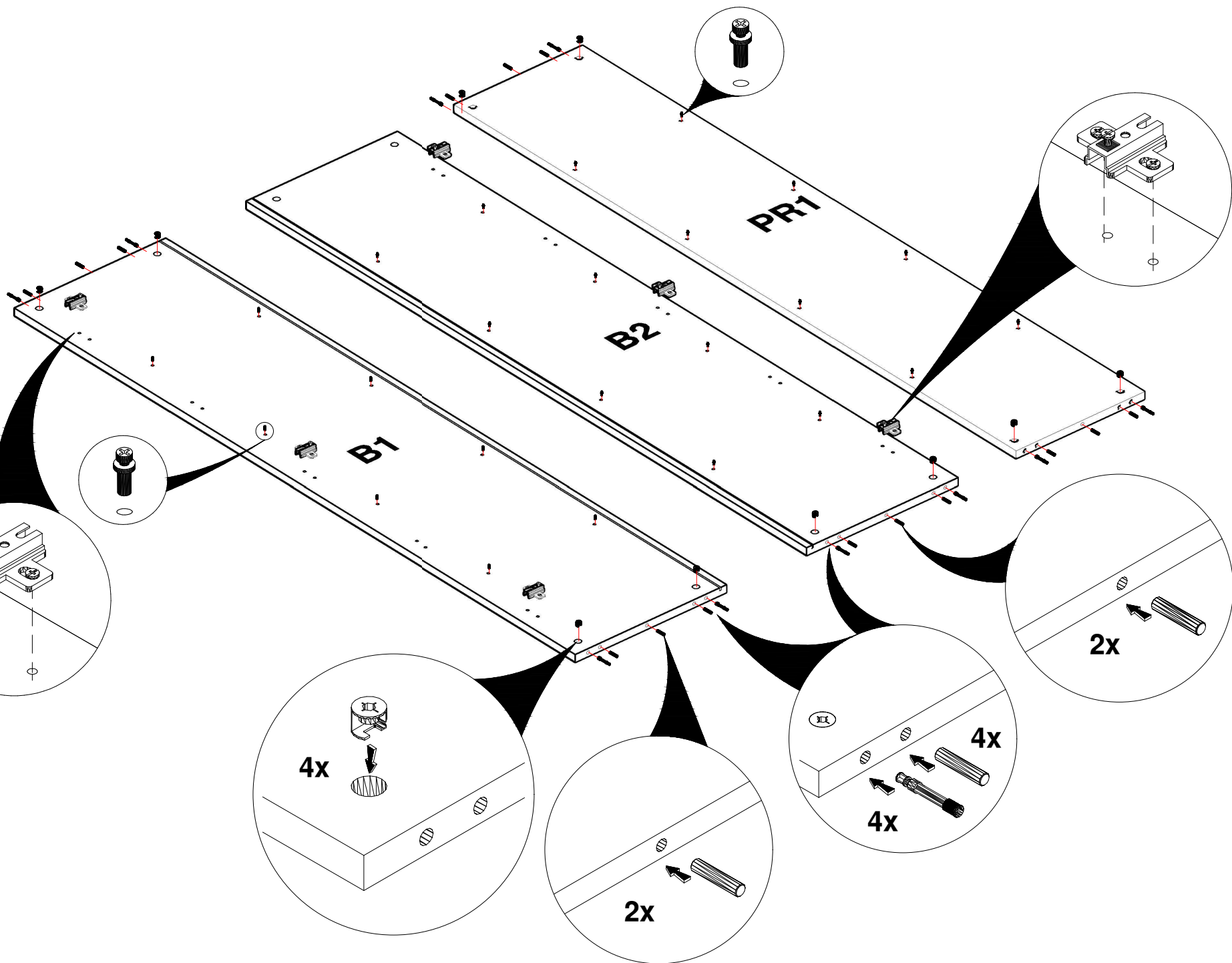

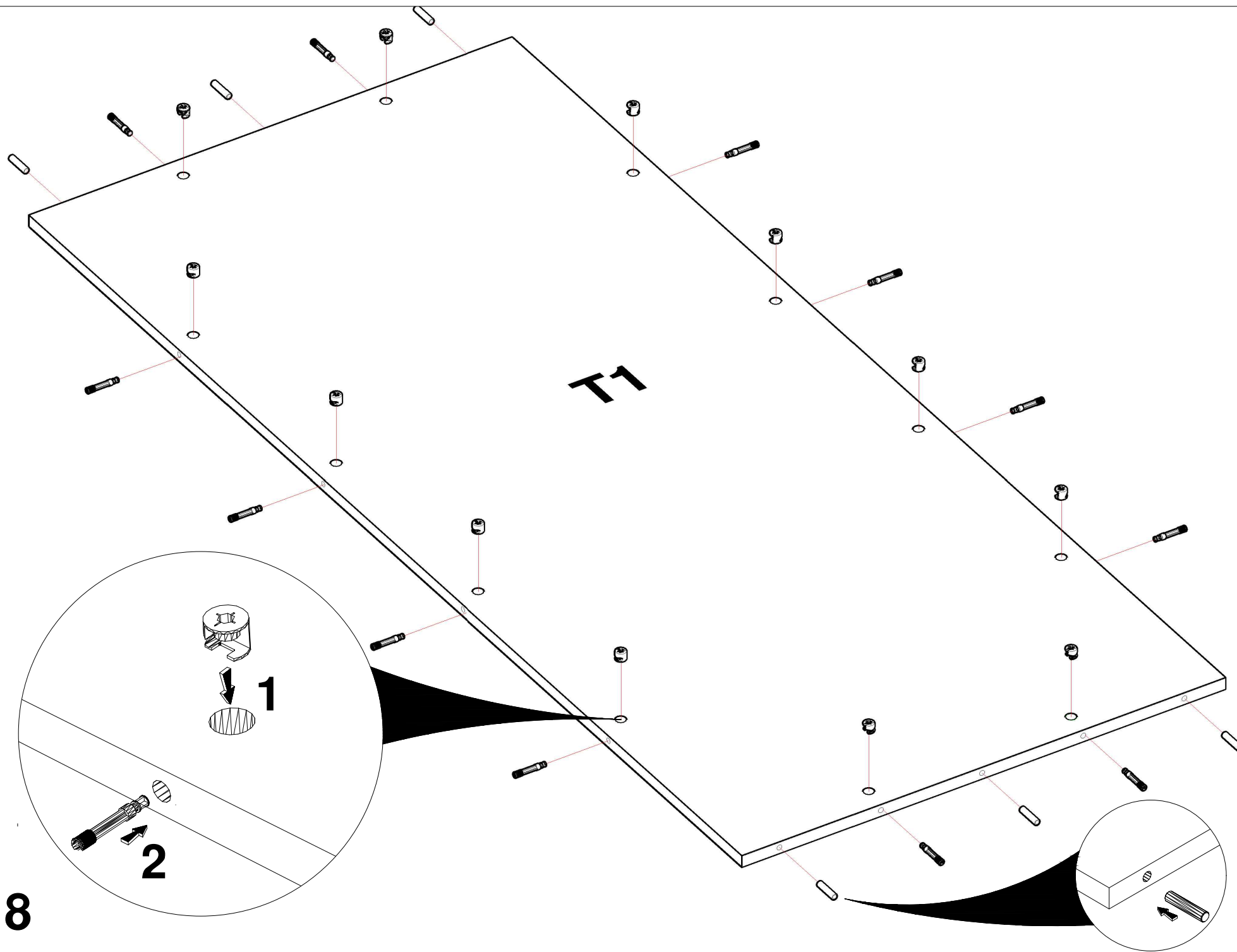

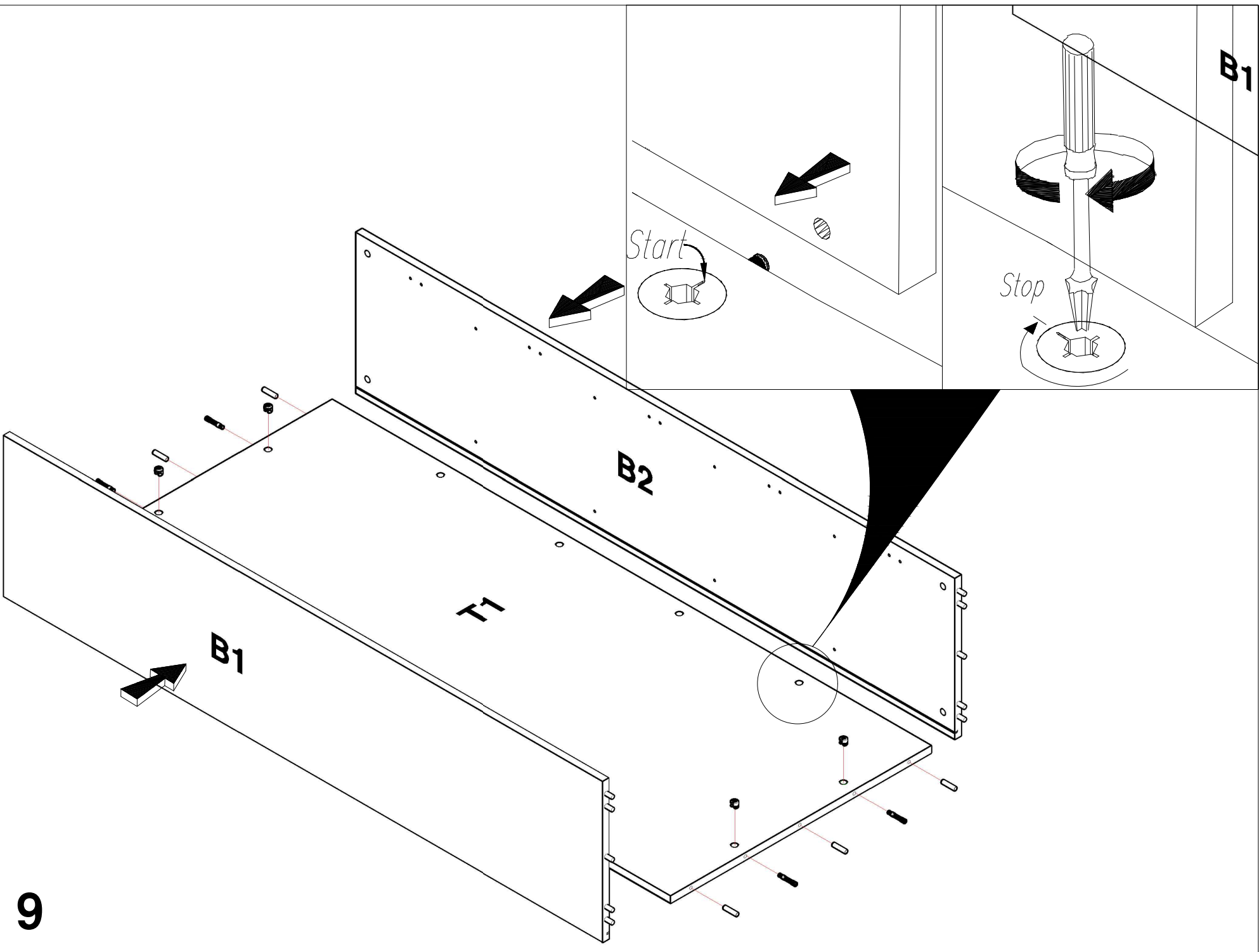

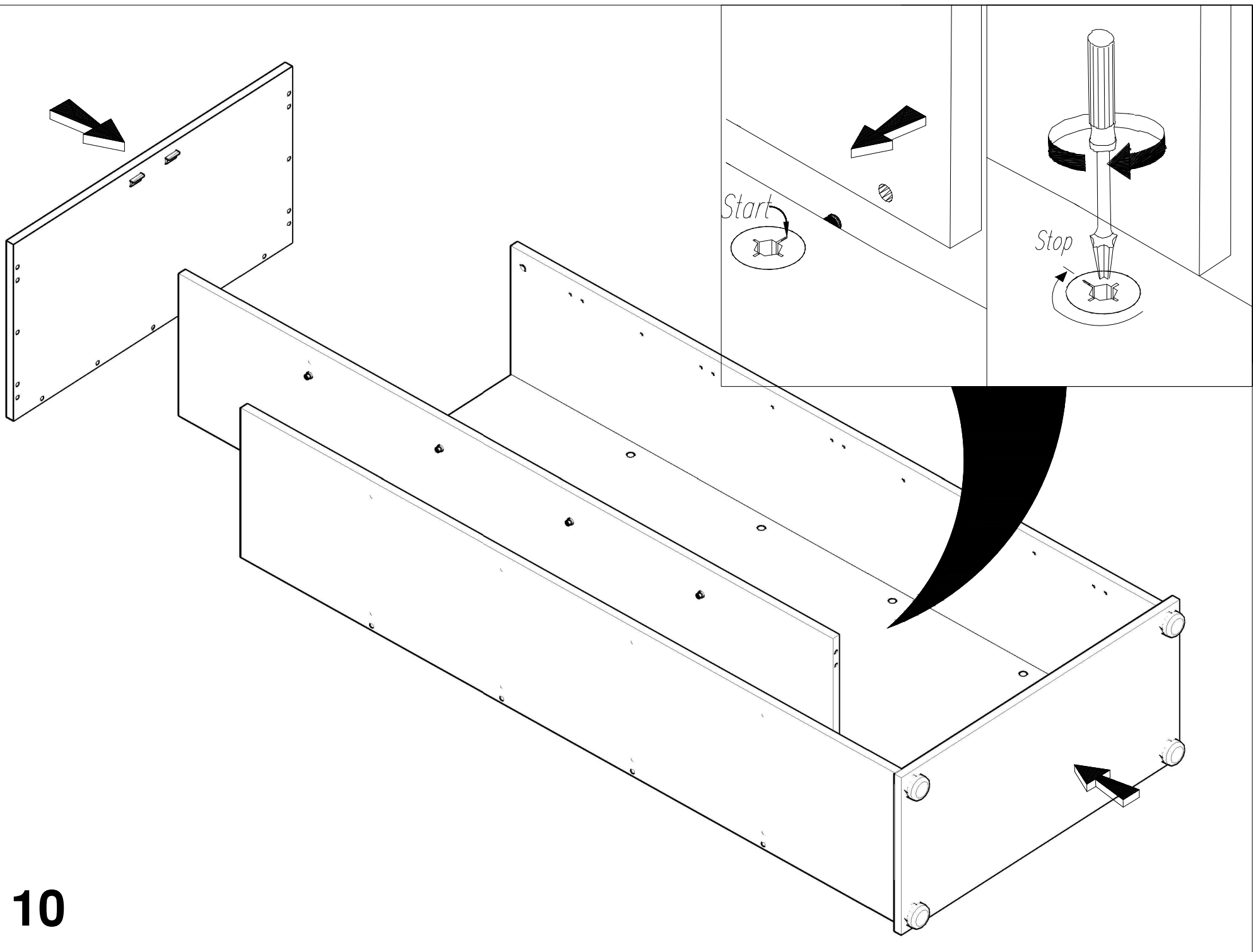

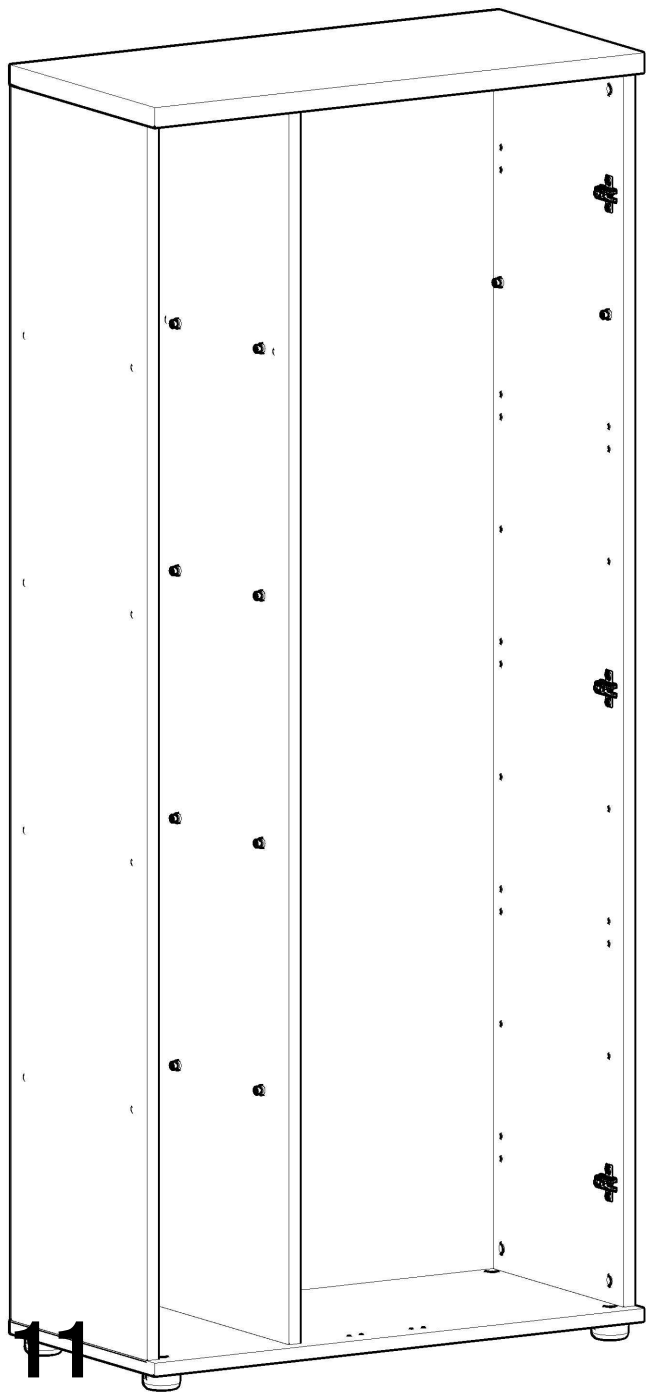

11

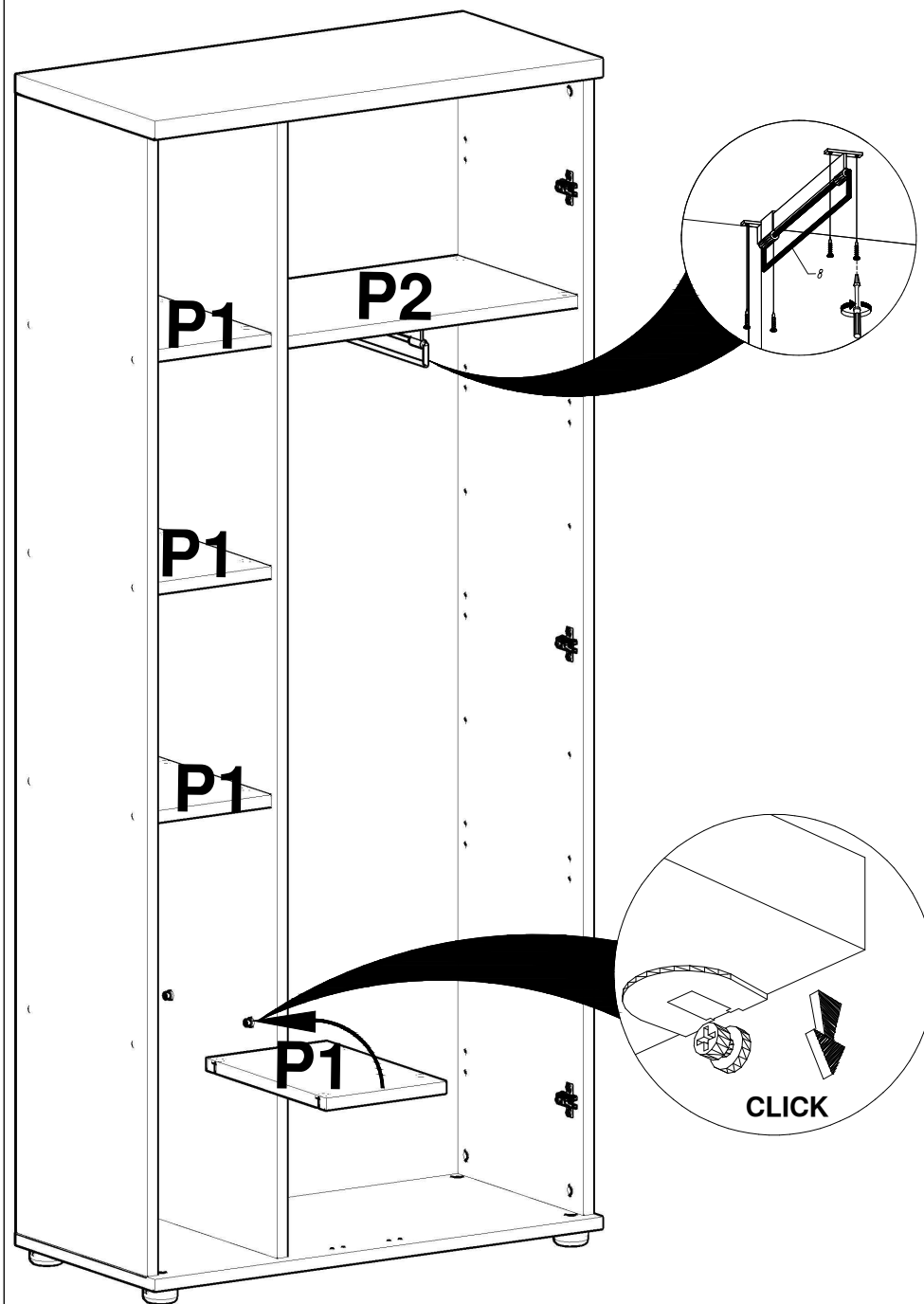

12

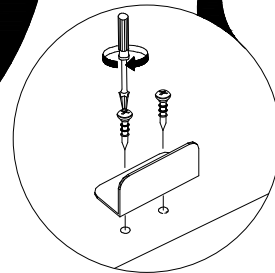
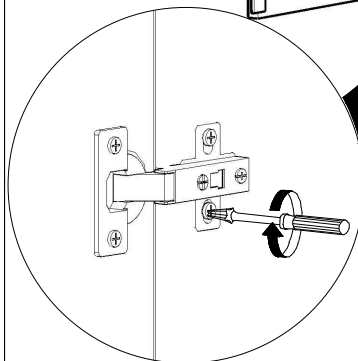
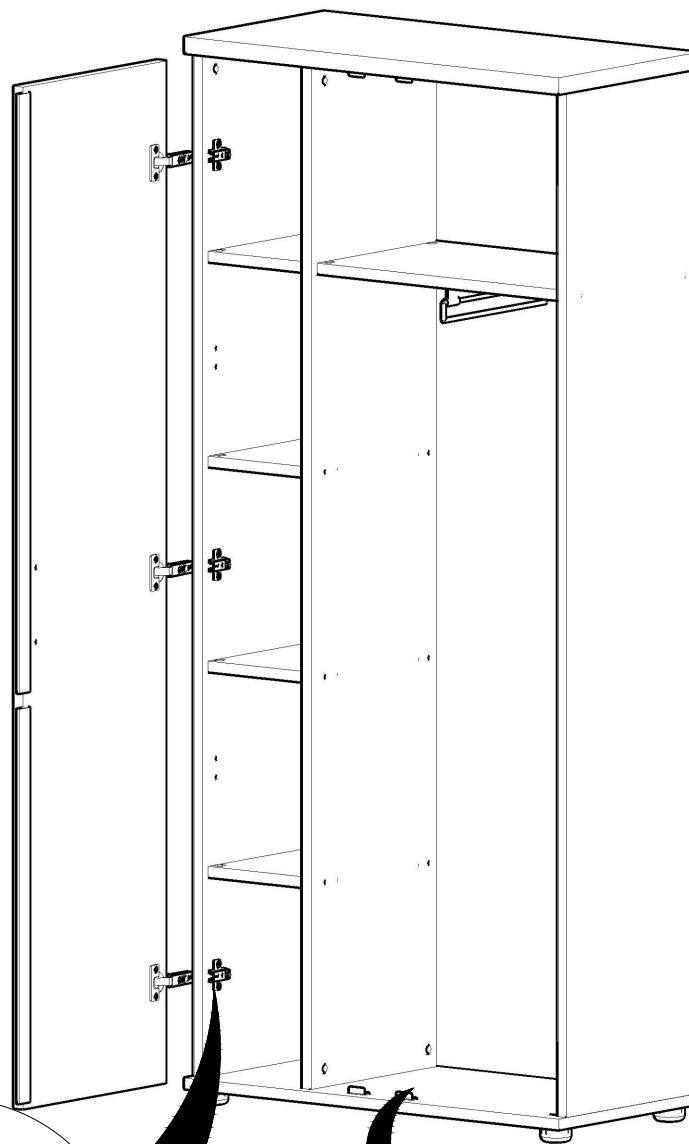
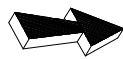
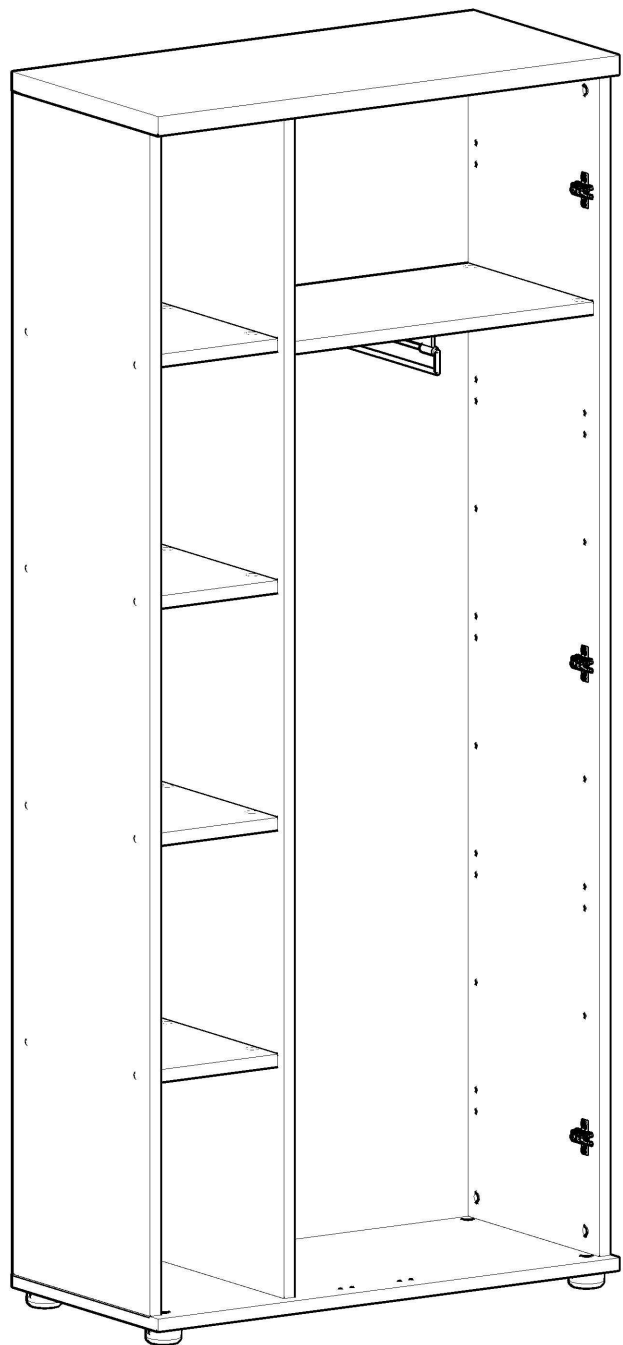

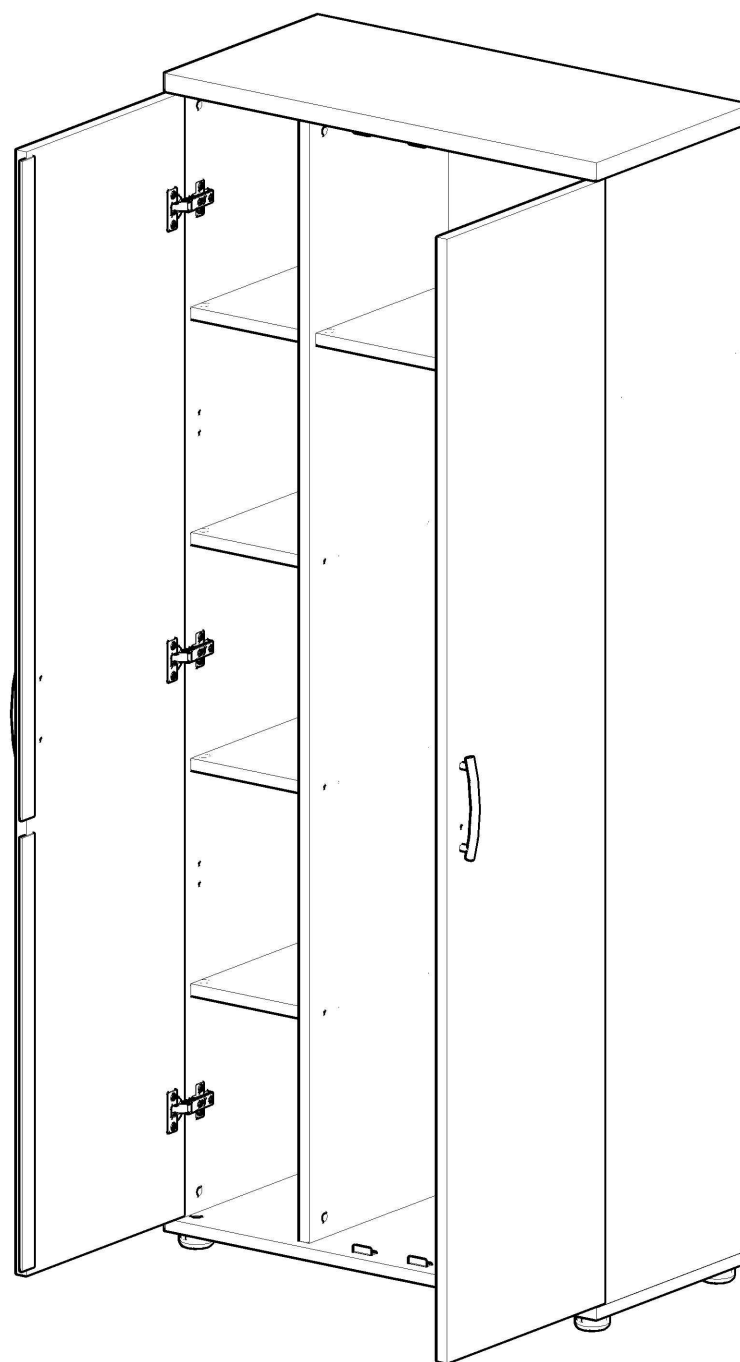
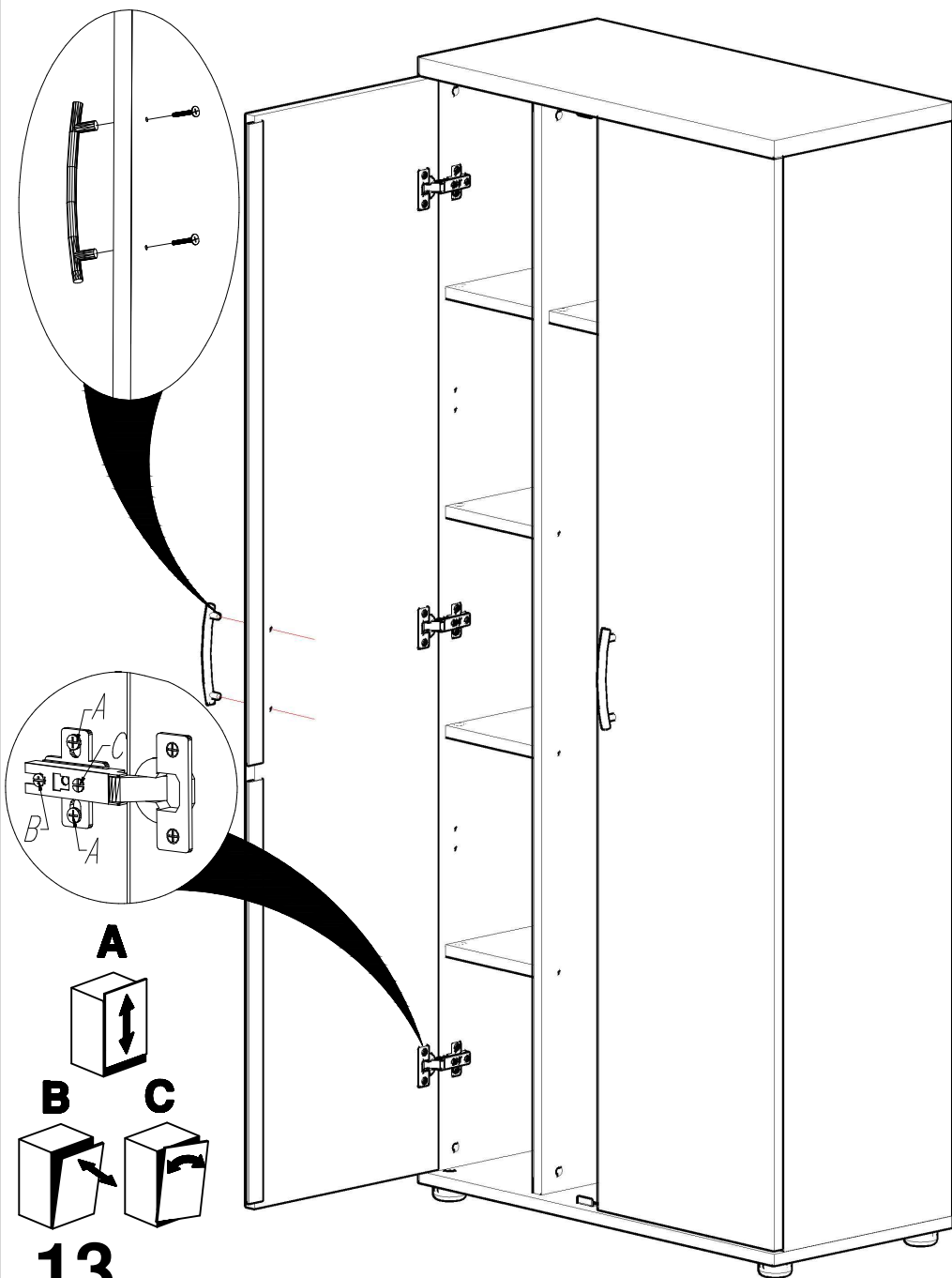

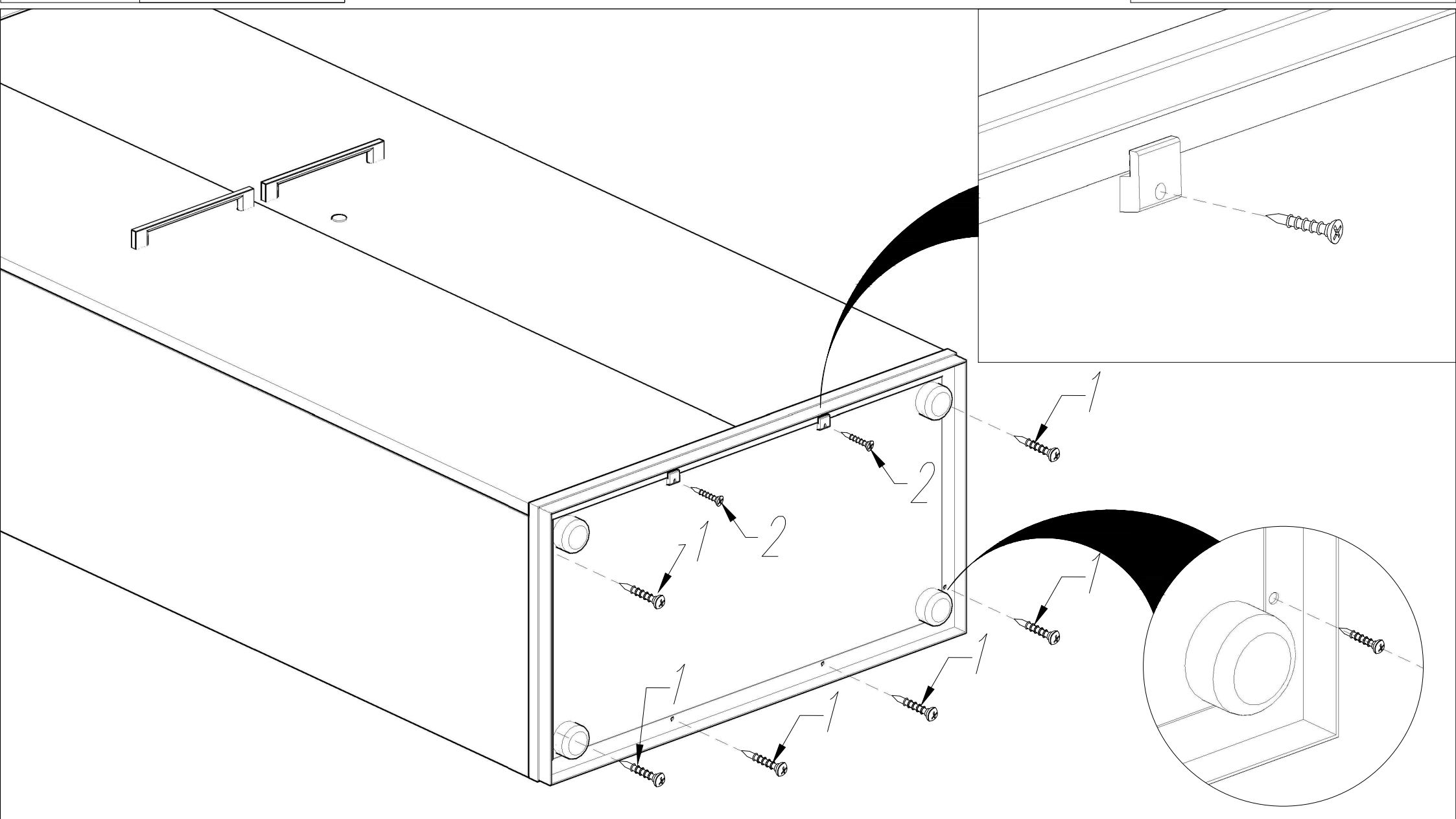
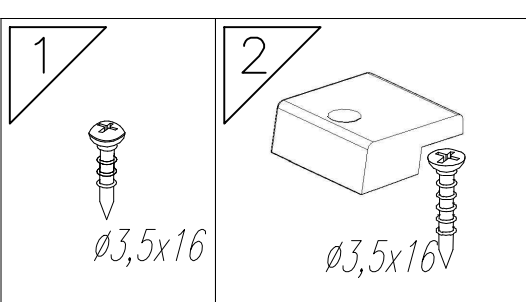

A

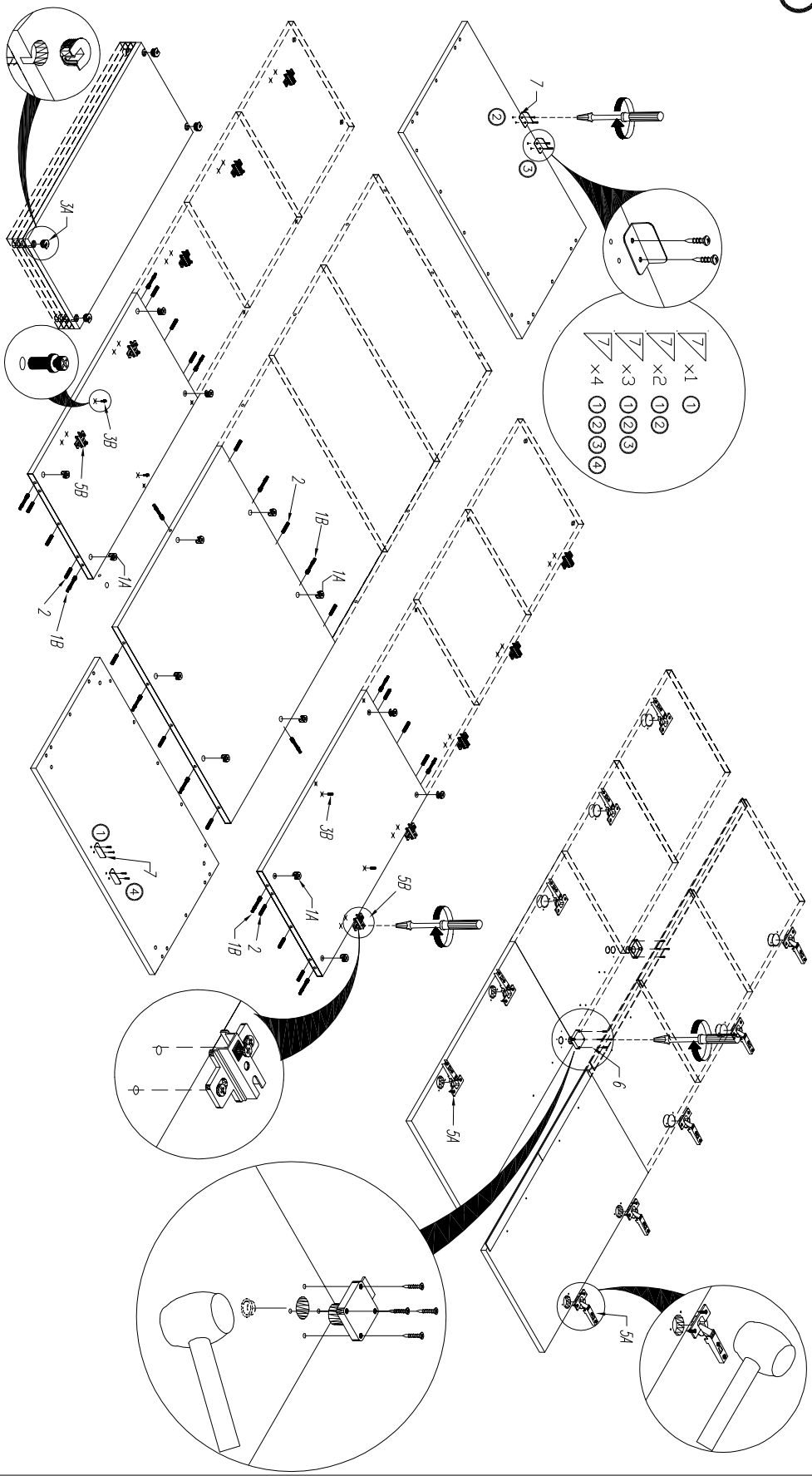

B

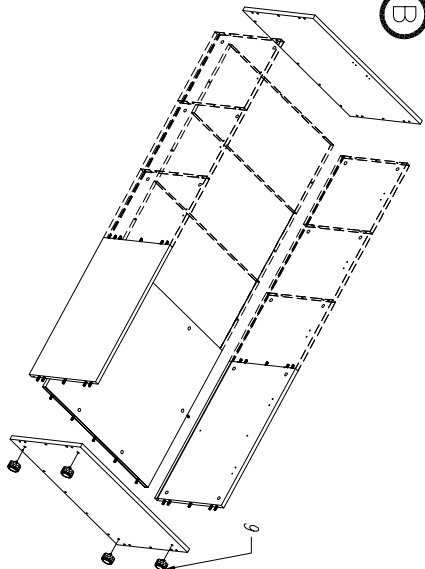

C

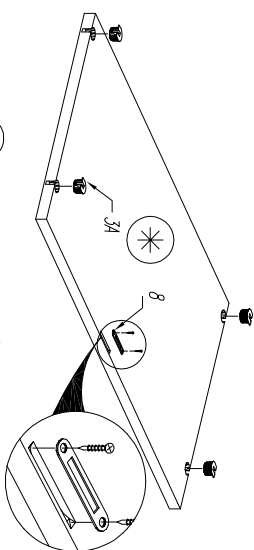
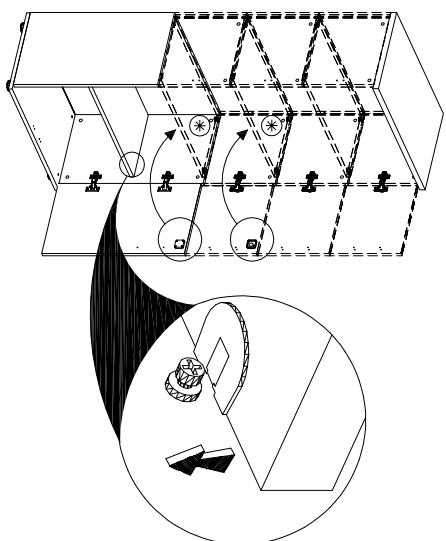

(*) – ZASTOSOWAĆ TEN ELEMENT
NEED TO USE THIS ELEMENT
DAS ELEMENT VERWENDEN

KOLEJNOŚĆ MONTAŻU
MIMOSRODOW I KOLKOW.
THE FITTINGS SEQUENCE OF THE
CAMS AND DOWELS.
DIE MONTAGEABFOLGE VON
EXZENTERN UND DÜBELN.

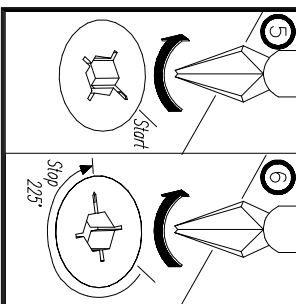
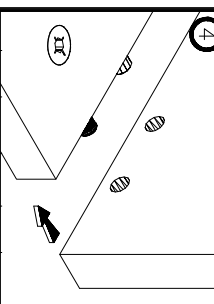
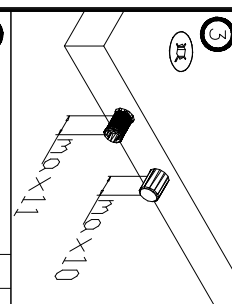
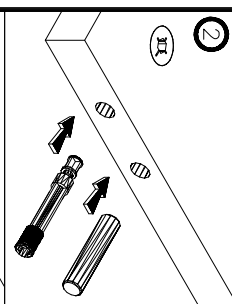
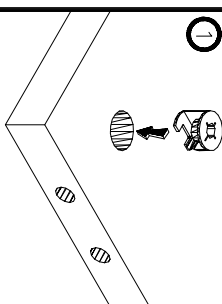

D

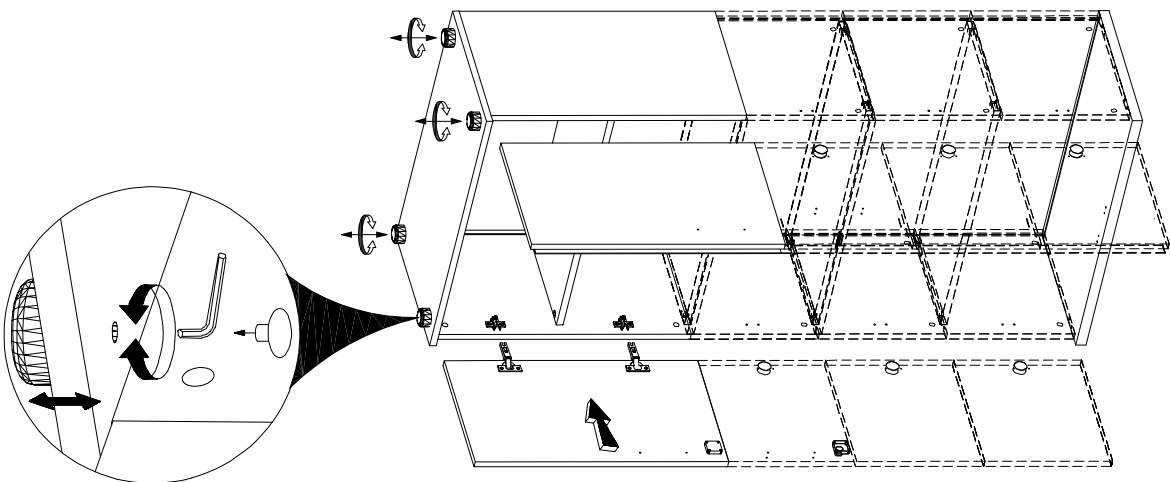

E

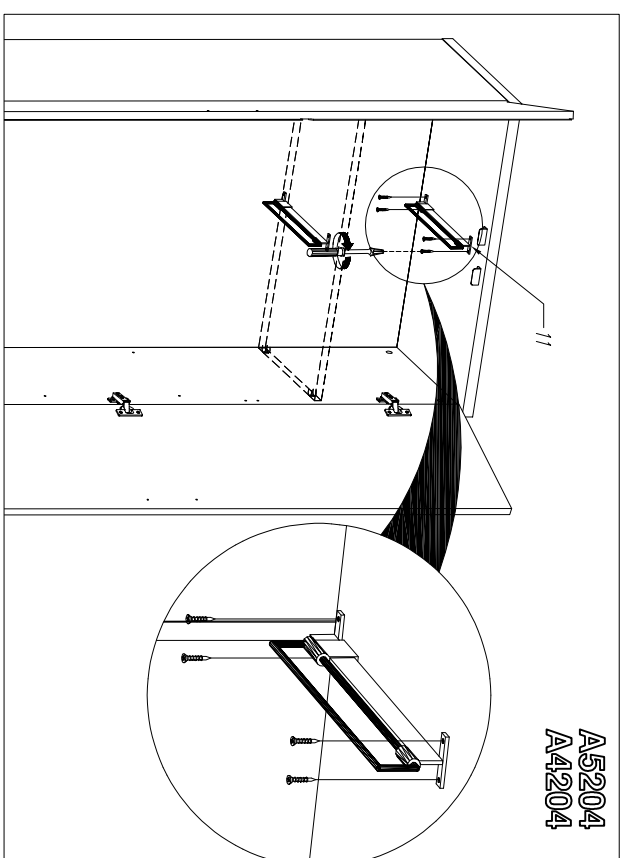
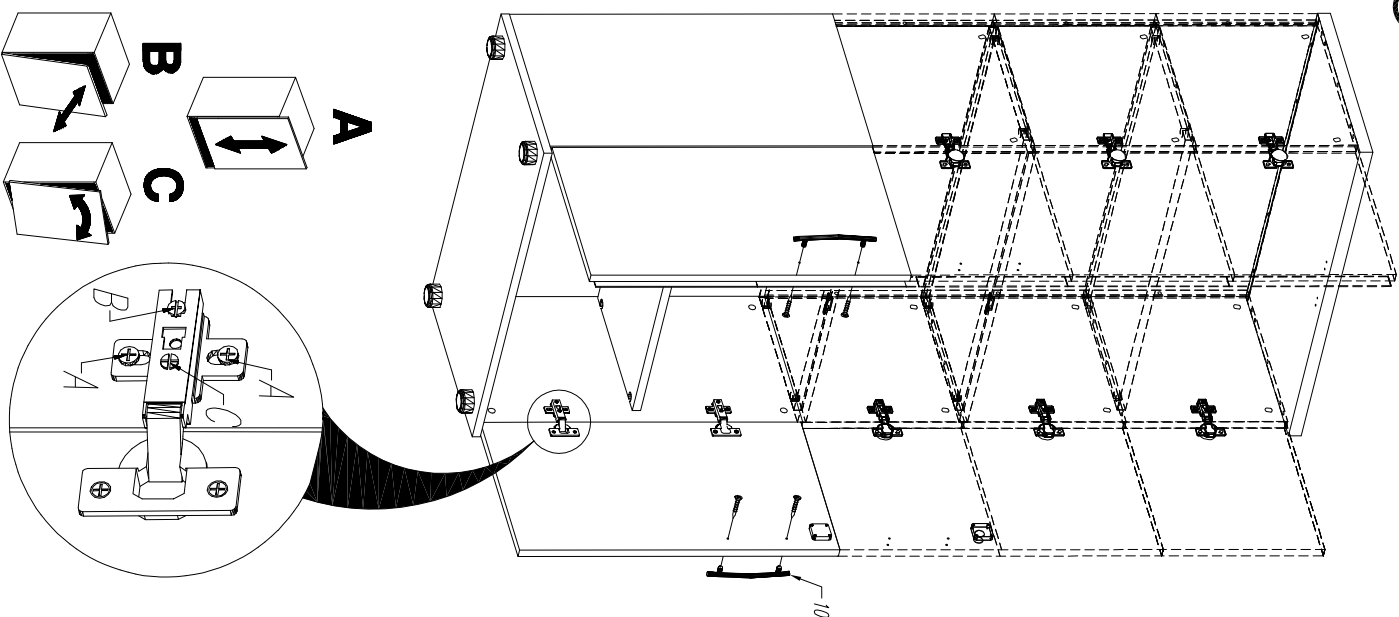

A5204
A4204

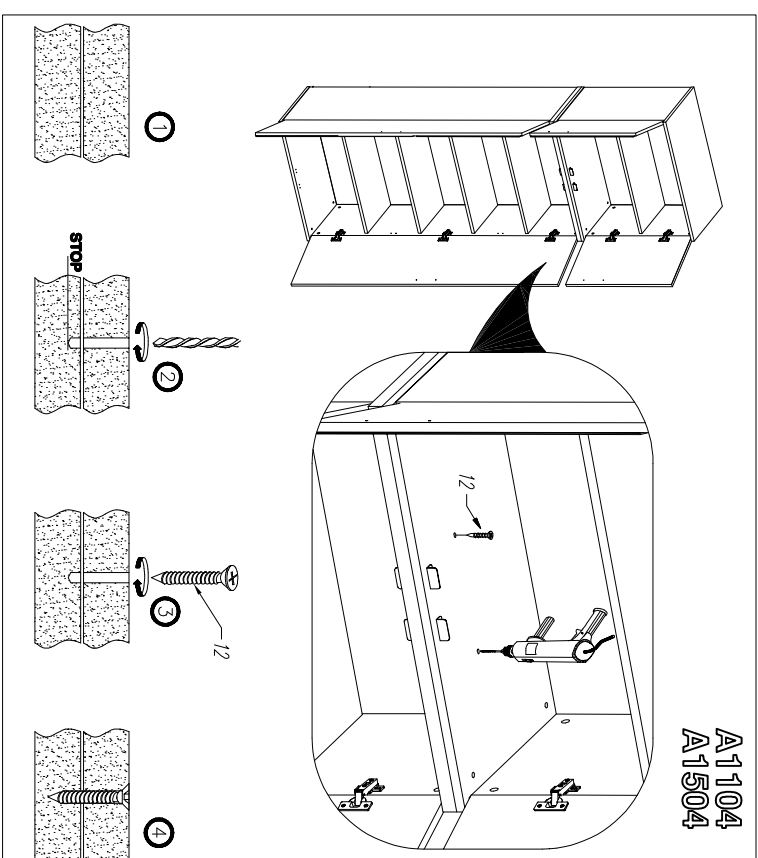

A1104
A1504

