

A3404

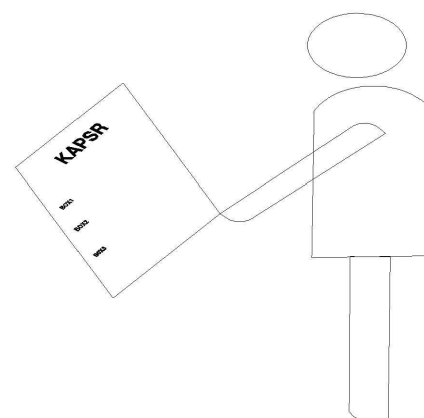

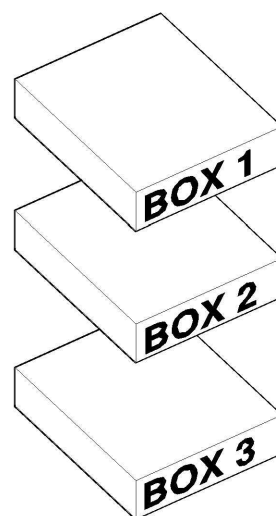

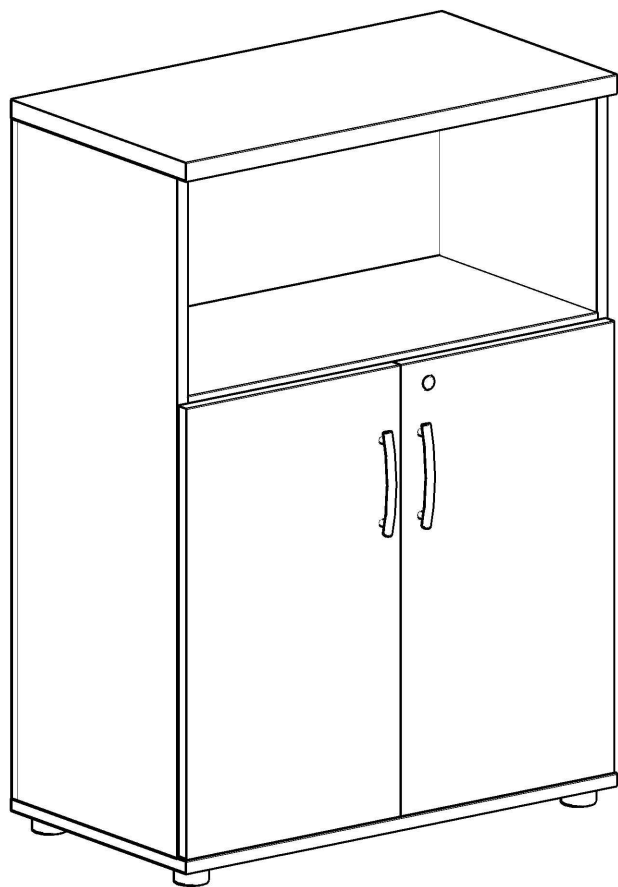

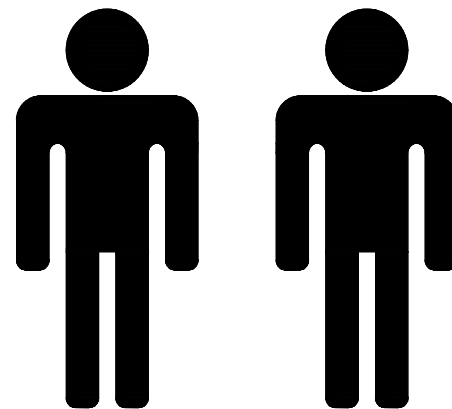
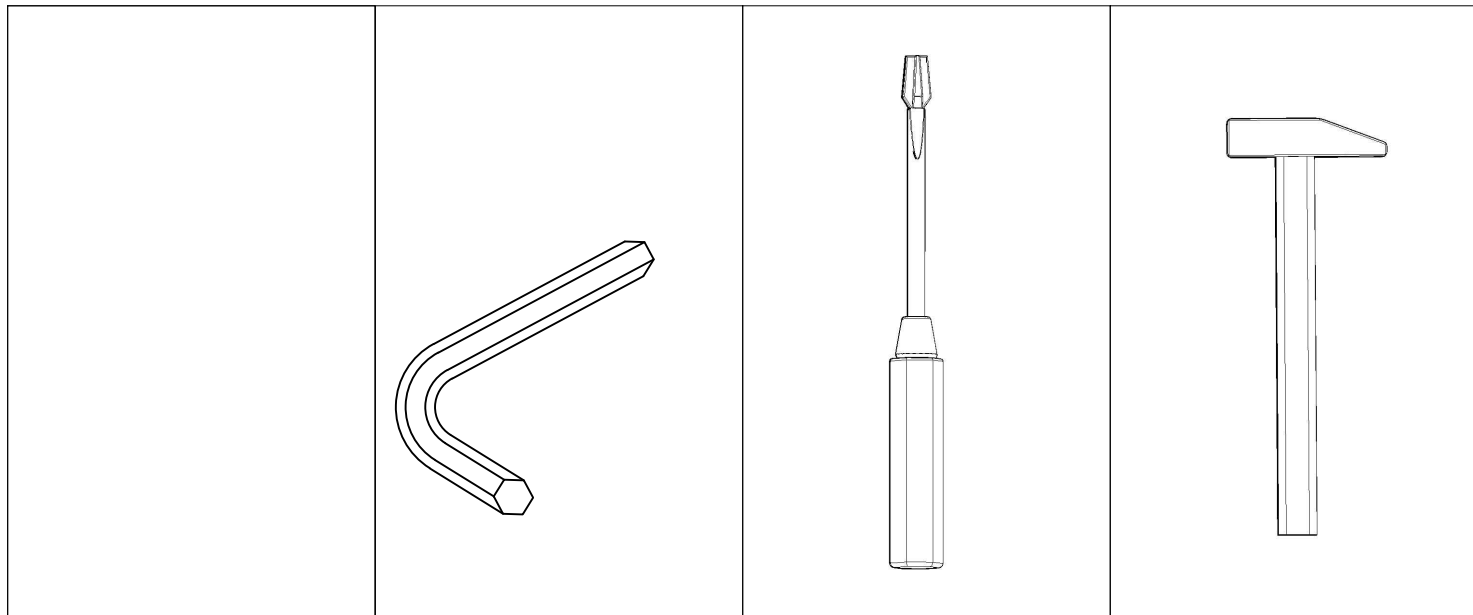
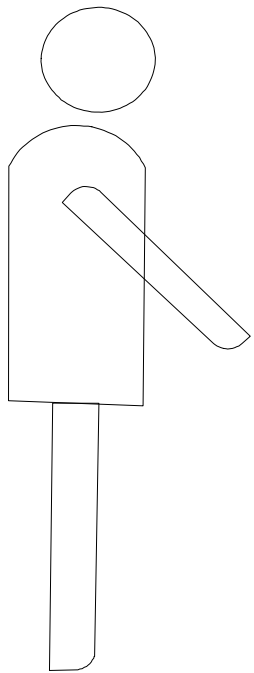
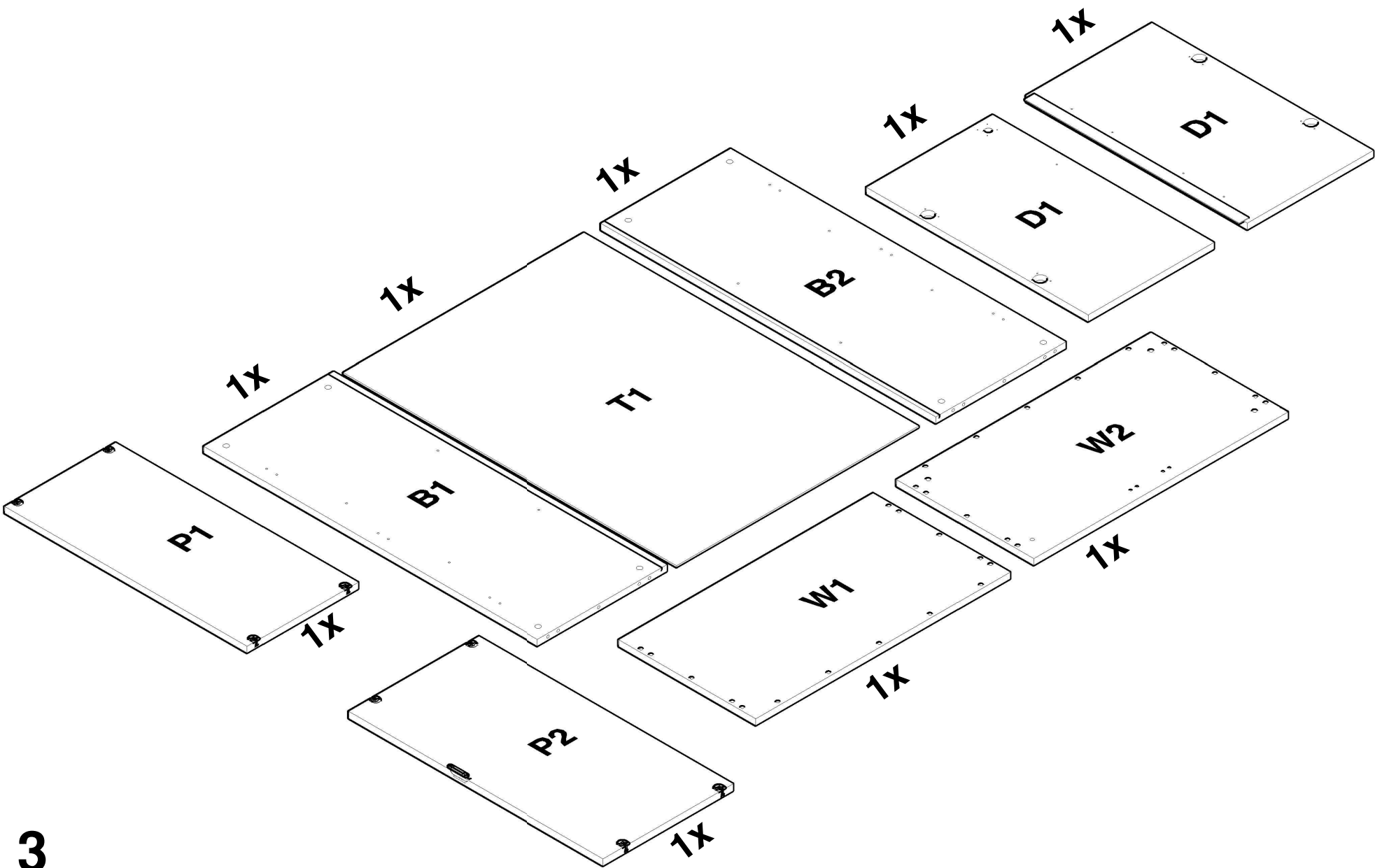
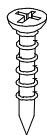

4x

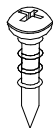

6X

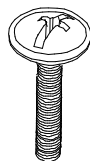

2x

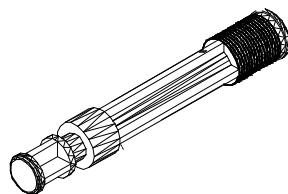

8x

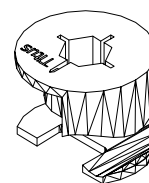

8x

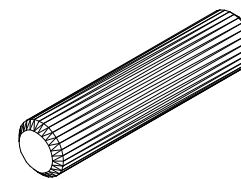

8x



8x

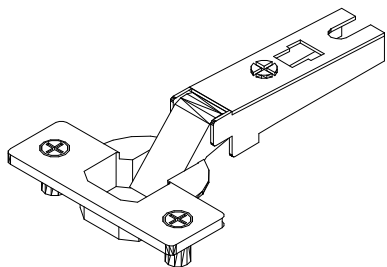

4x

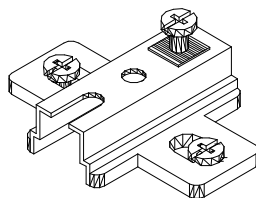

4x

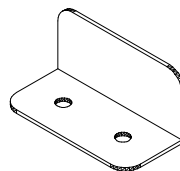

3x

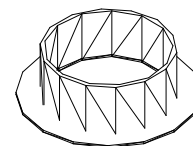

1x

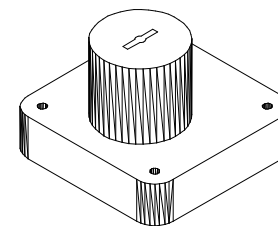

1x

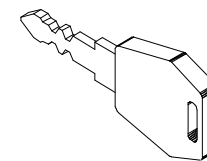

1x

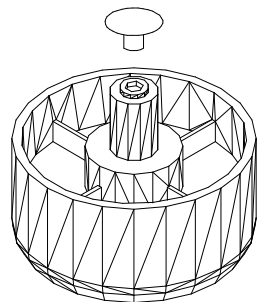

4x

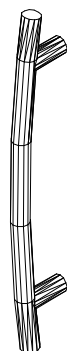

2x

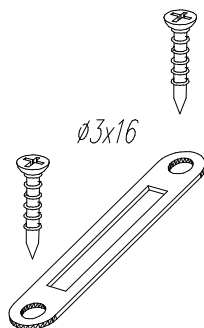

1x

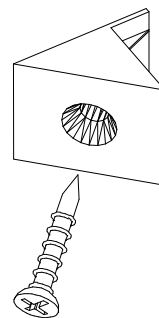

6x

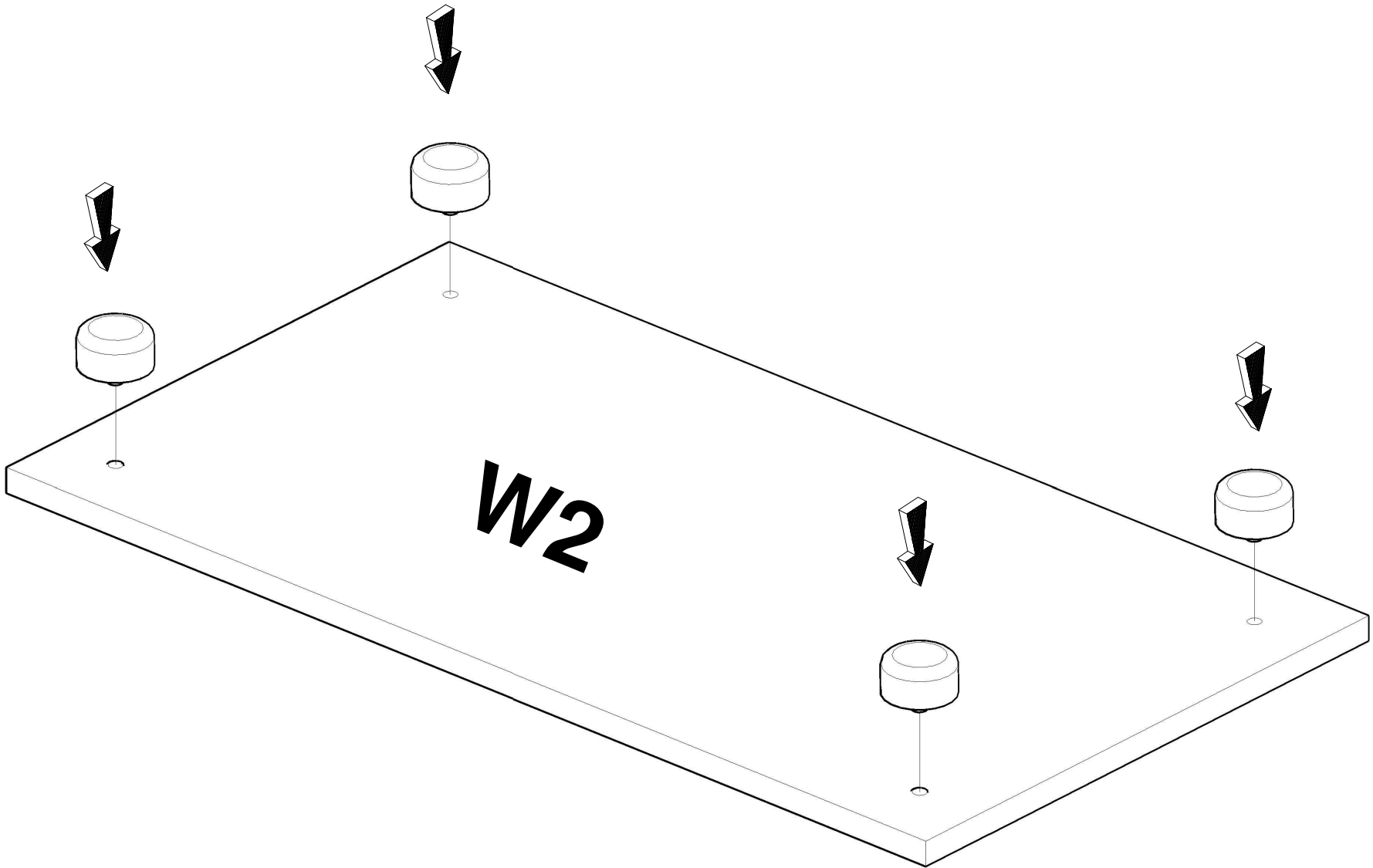

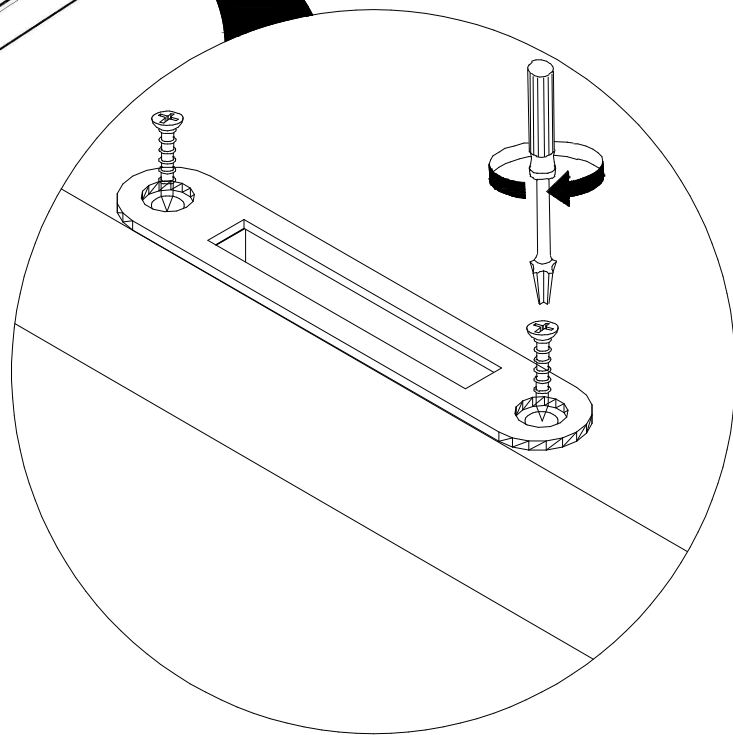
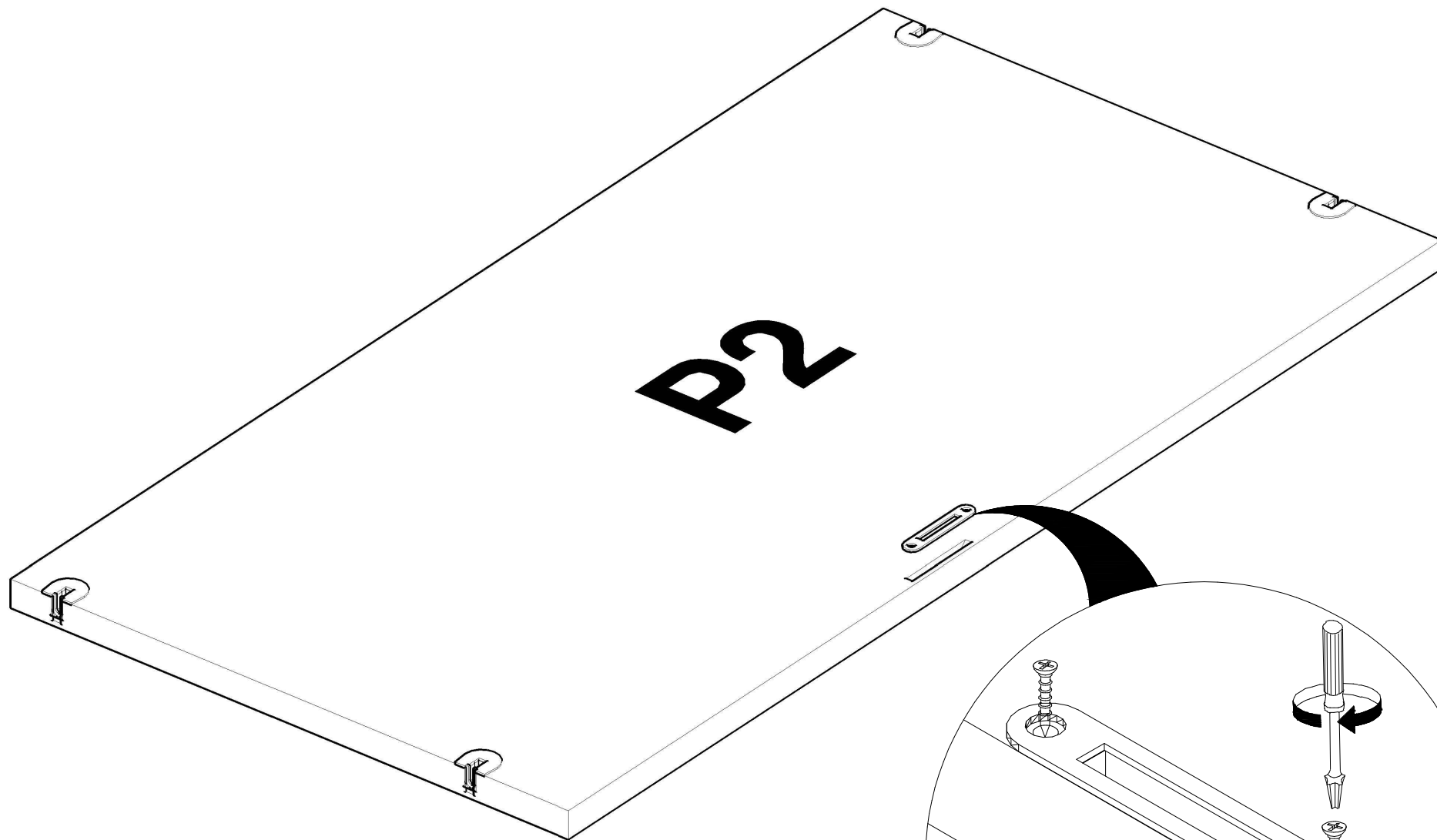

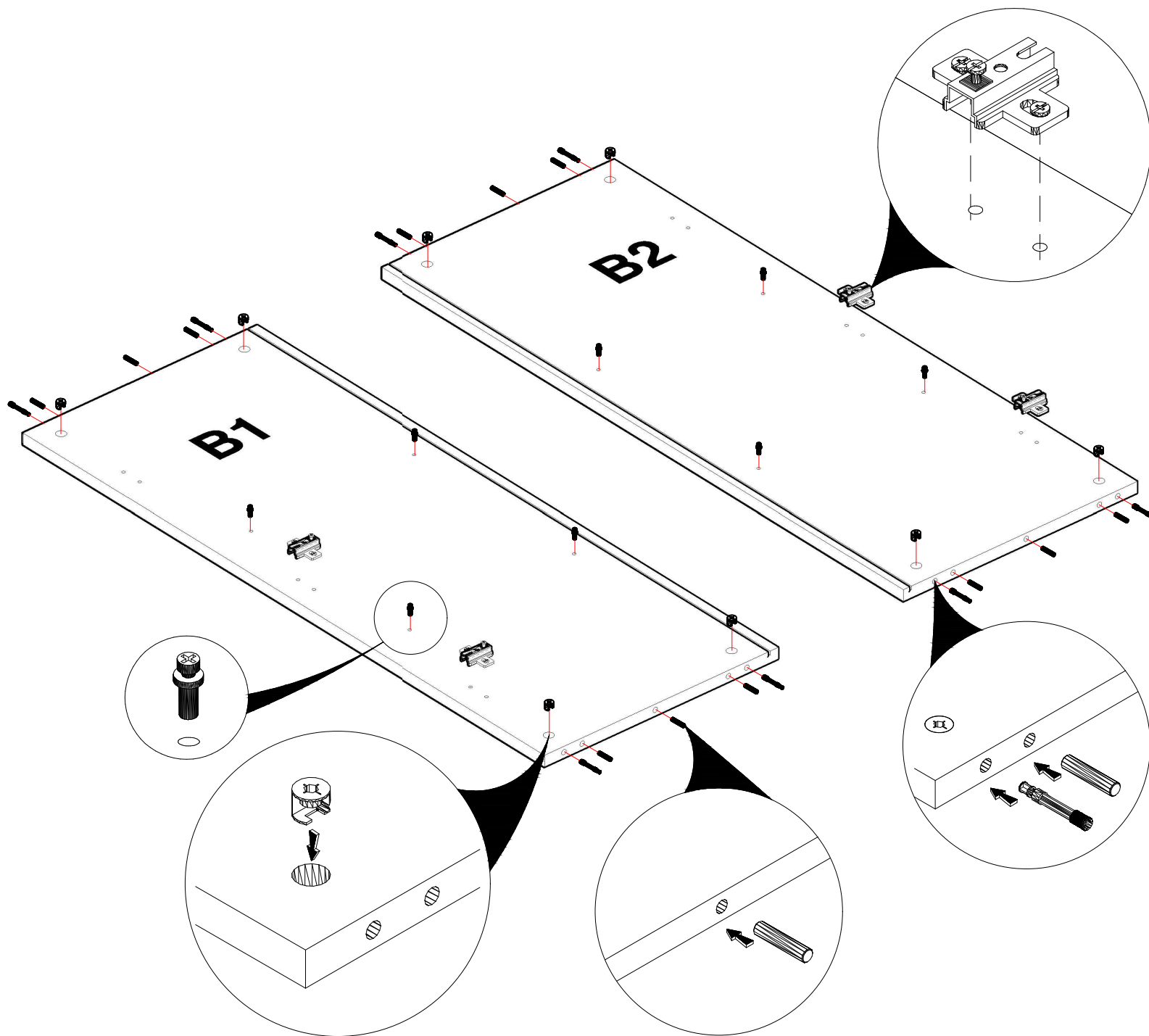

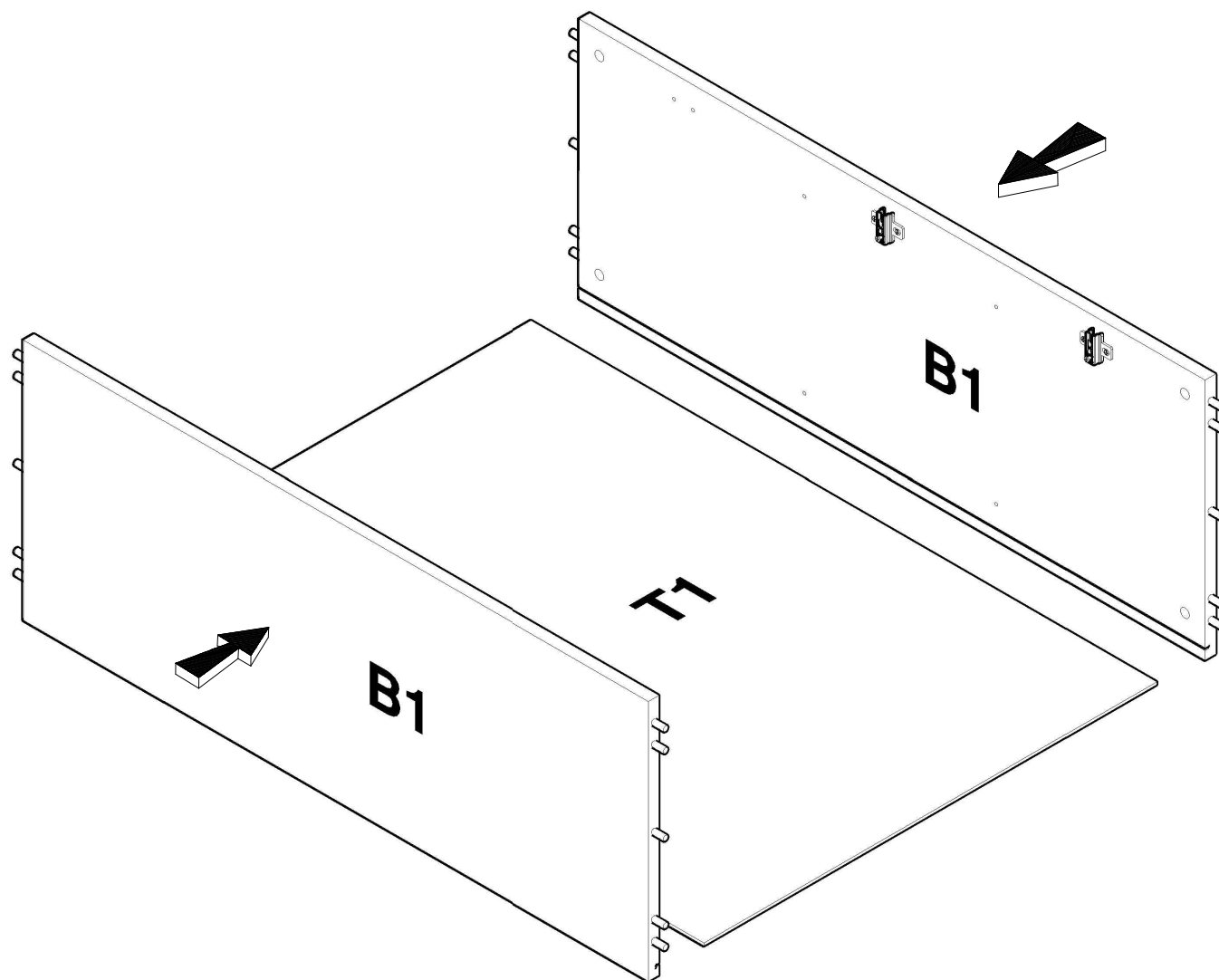

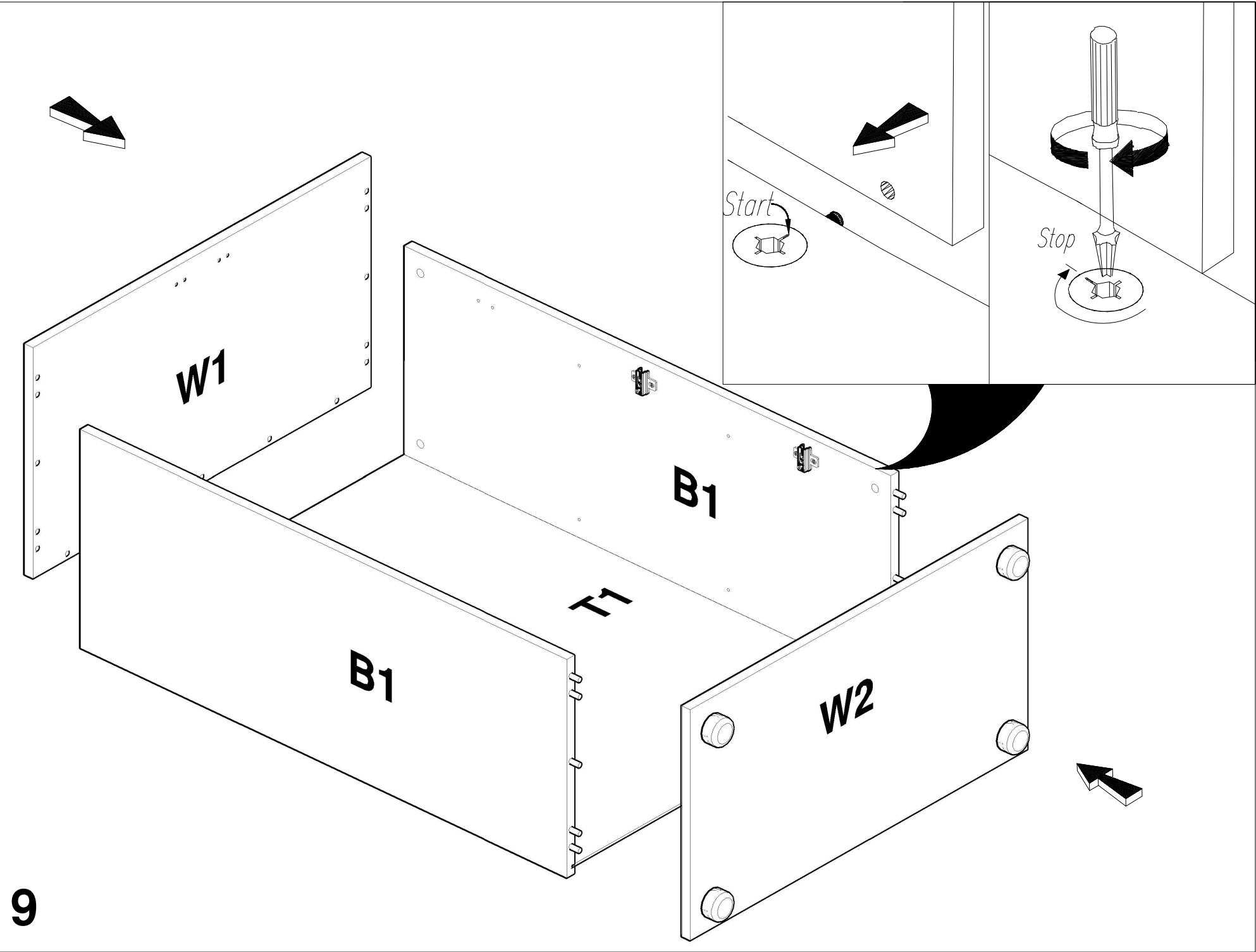

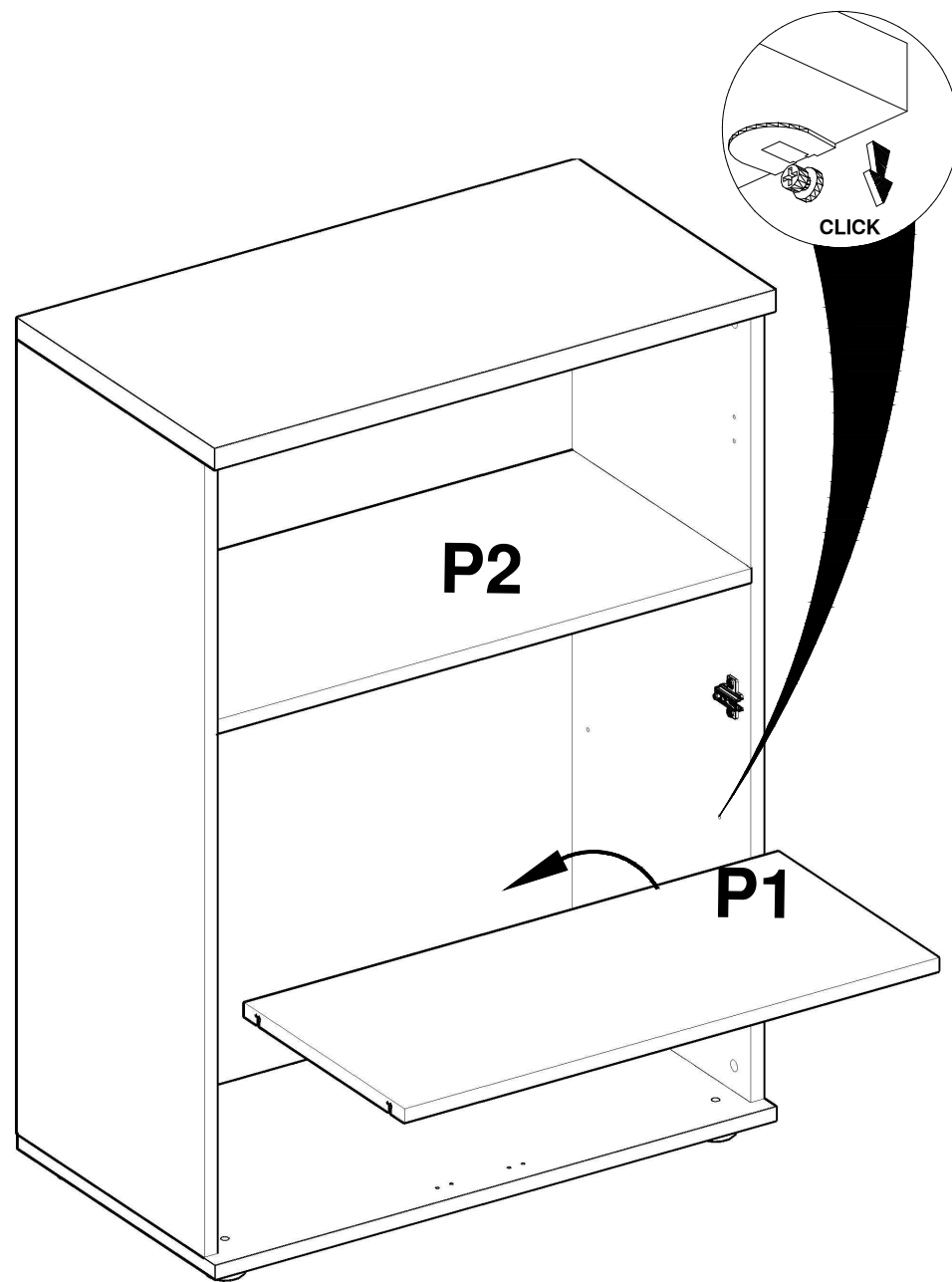
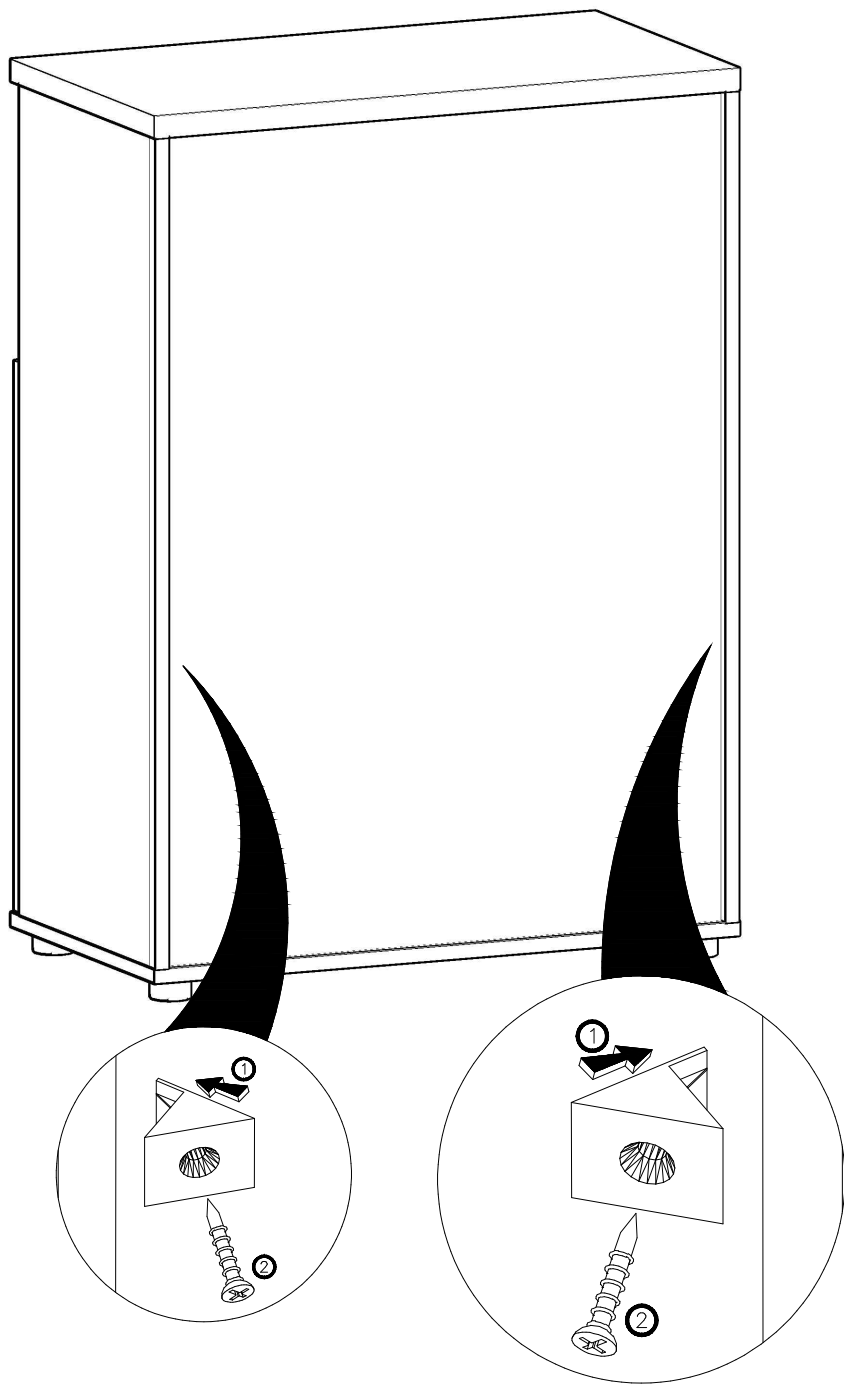

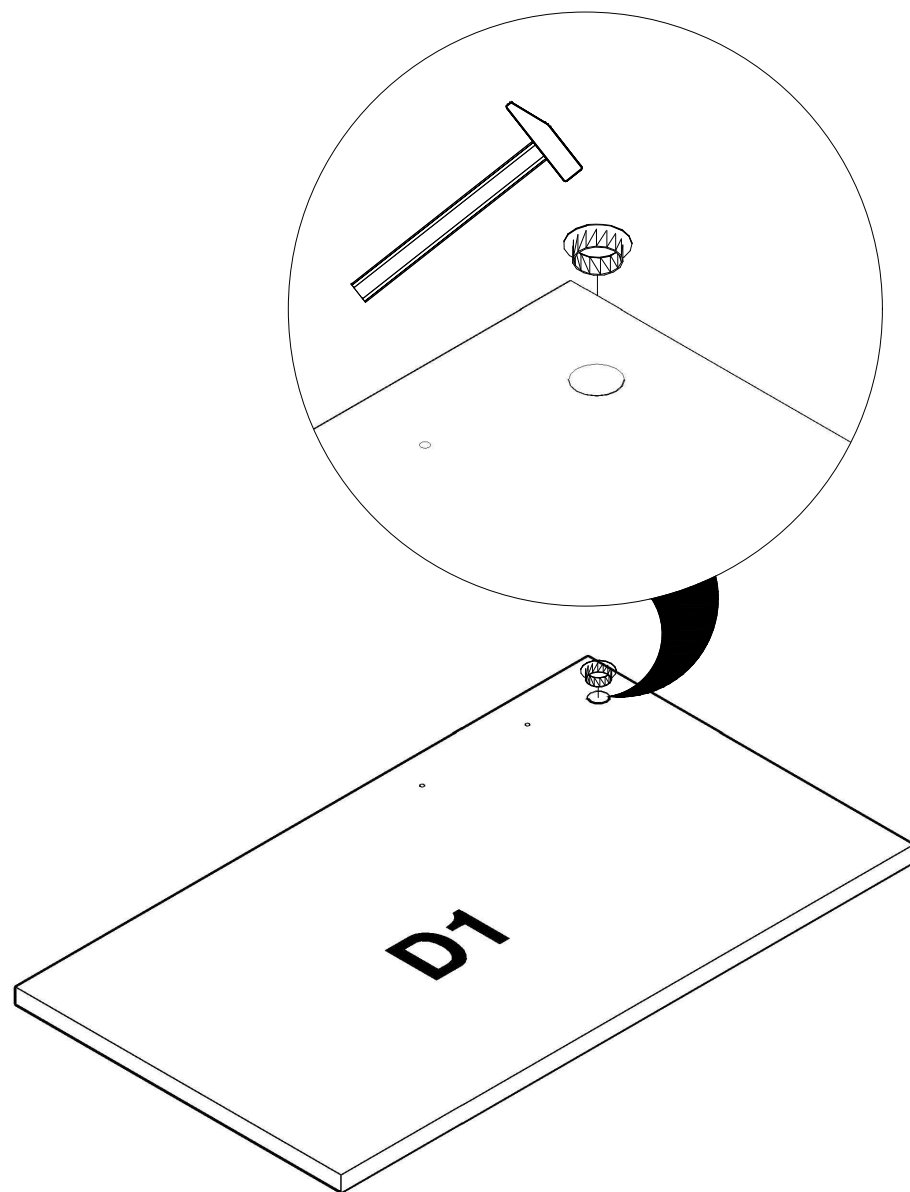
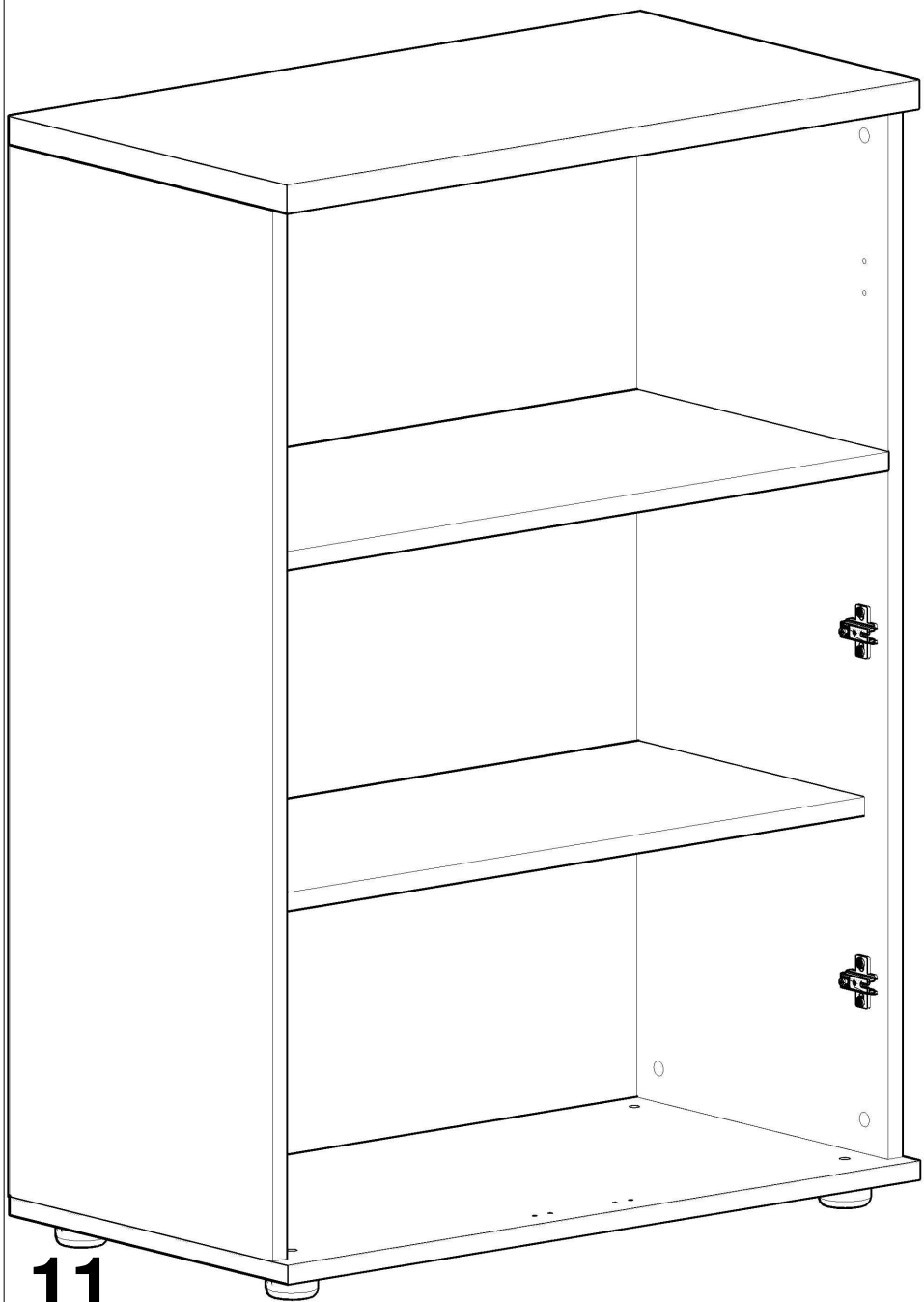

D1

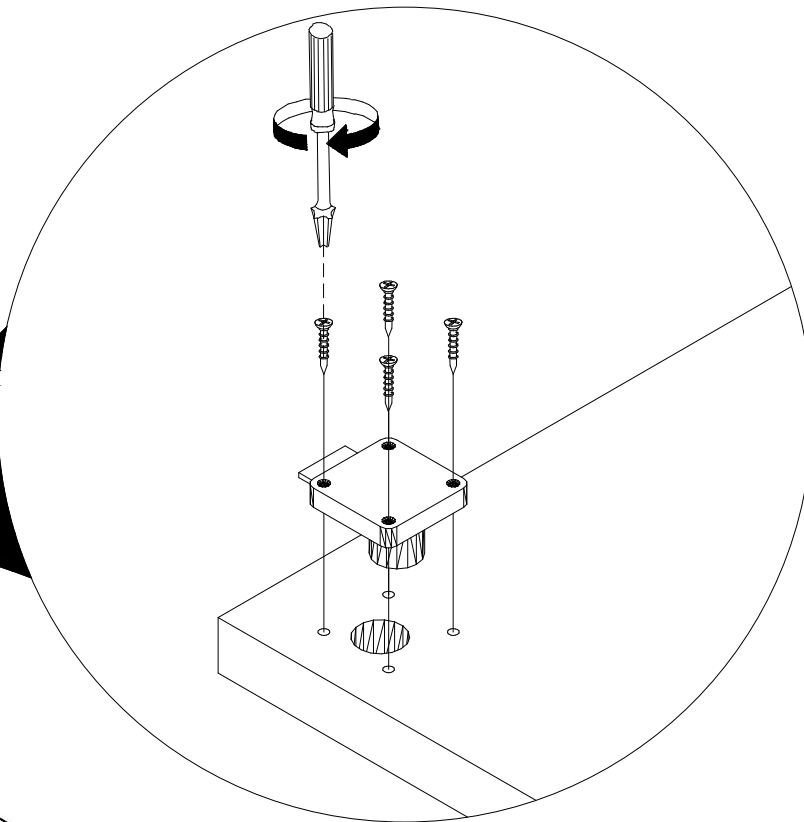

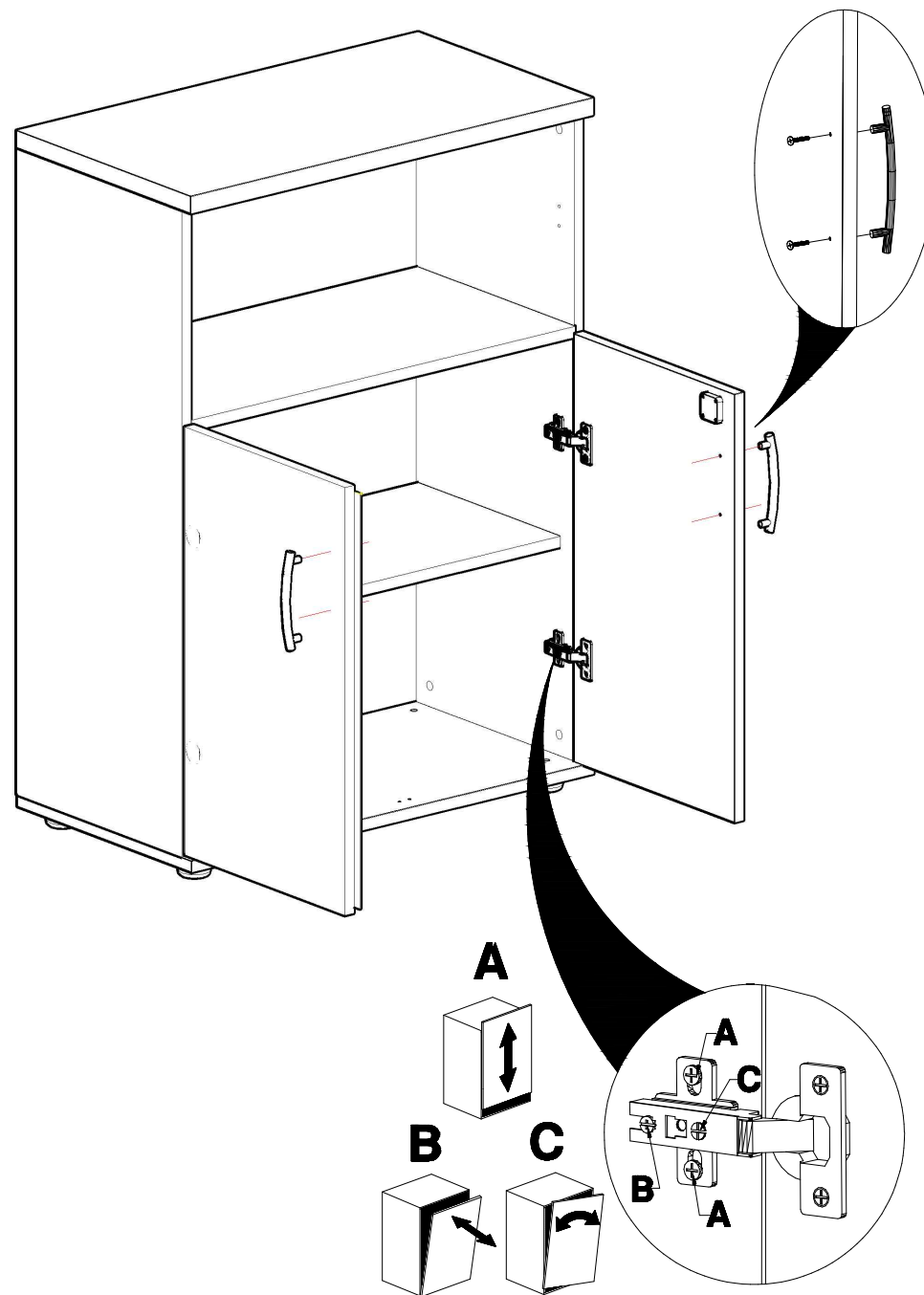
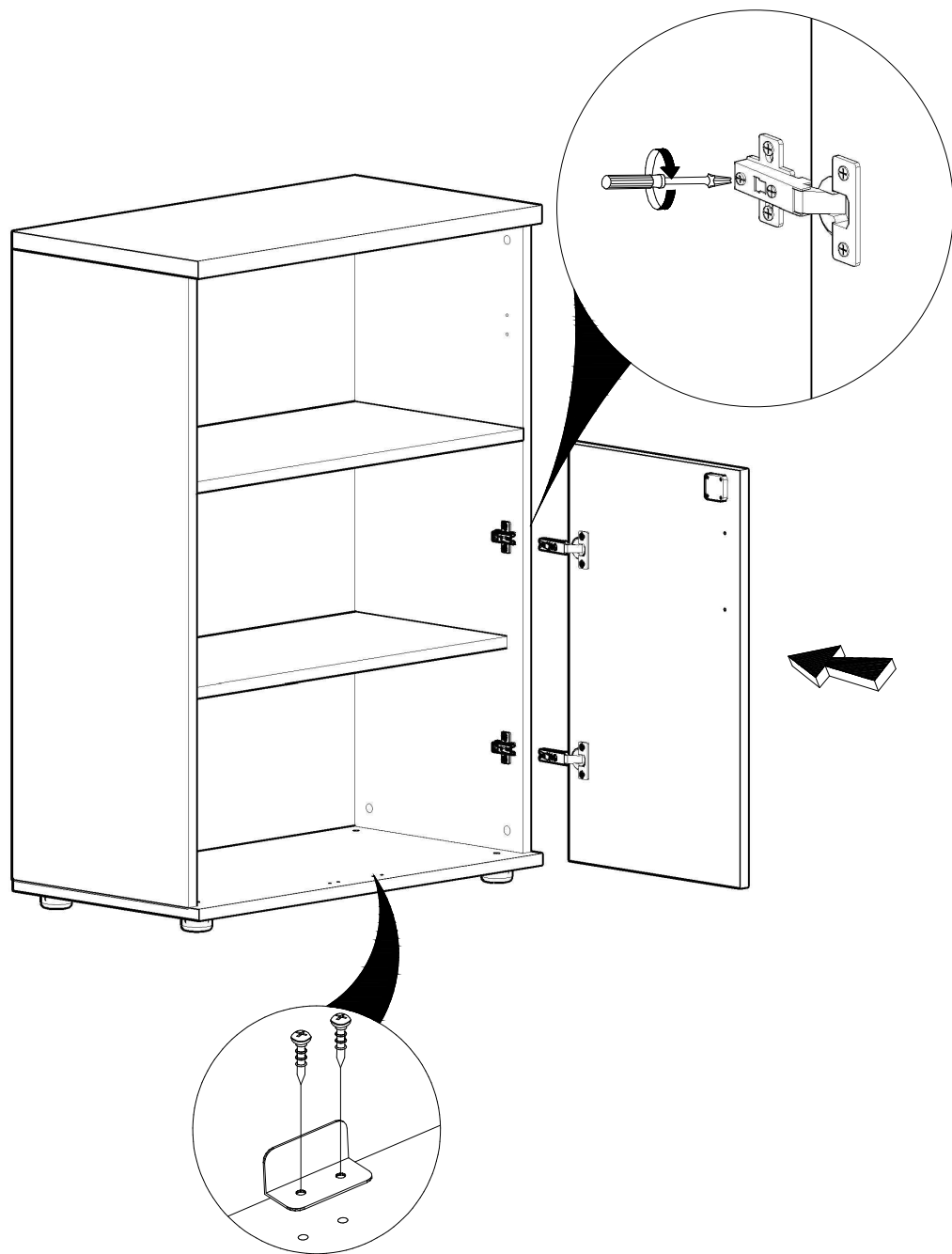

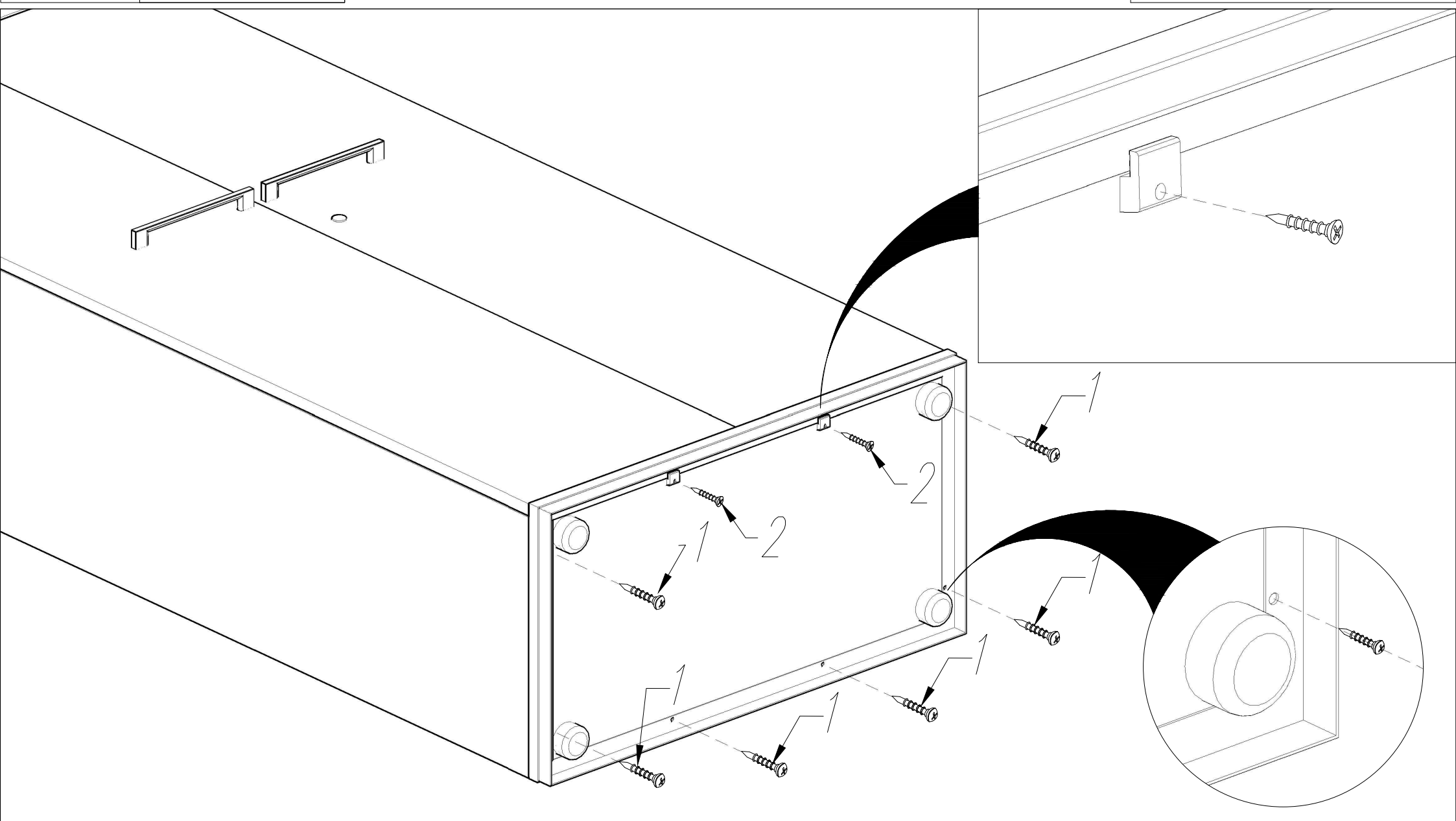
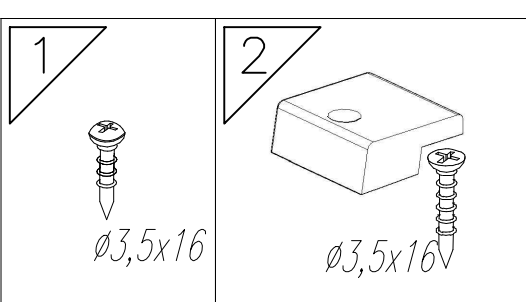

A

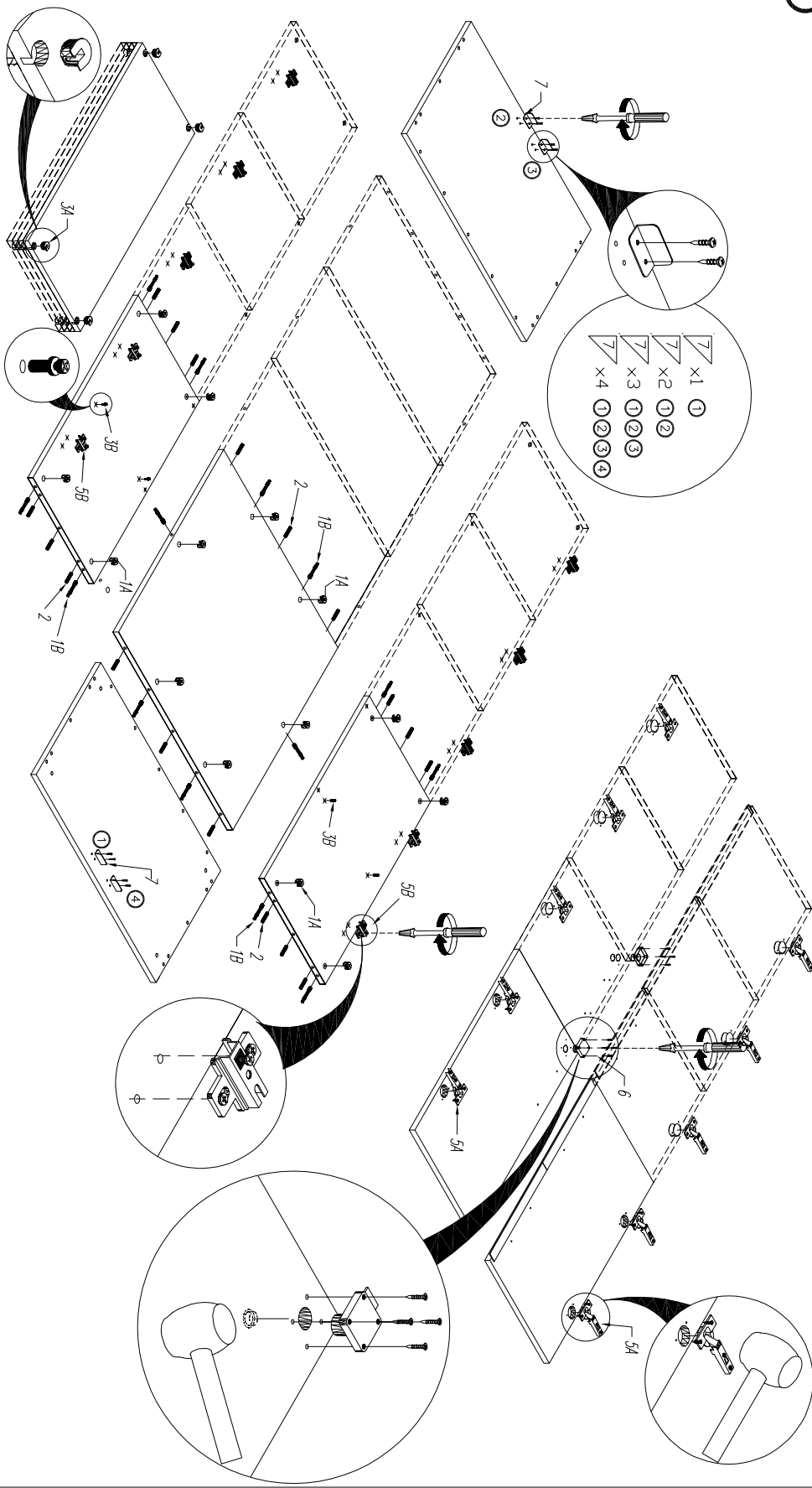

- 7 x1 ①
- 7 x2 ②
- 7 x3 ③
- 7 x4 ④
- ① ② ③ ④

B

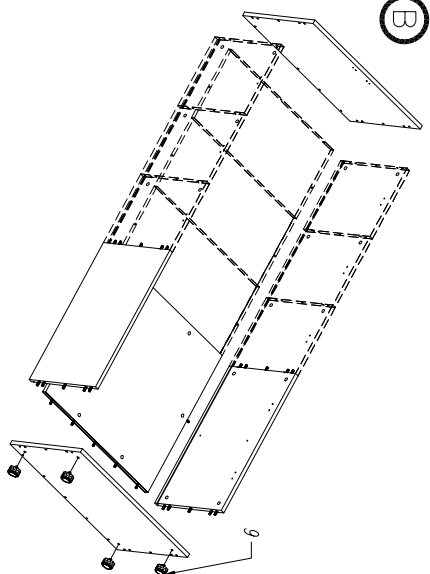

C

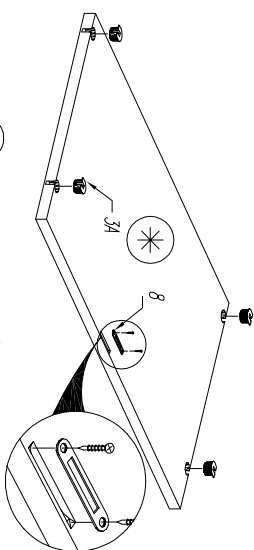
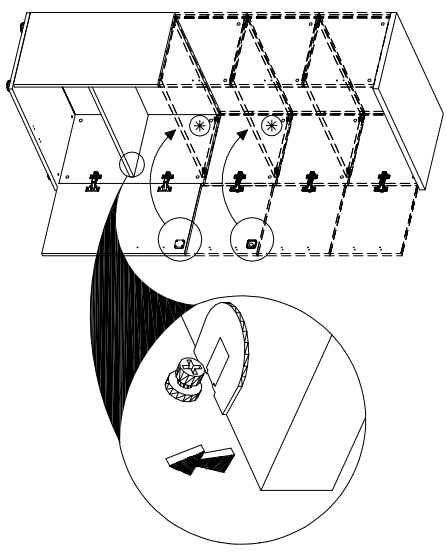

* – ZASTOSOWAĆ TEN ELEMENT
NEED TO USE THIS ELEMENT
DAS ELEMENT VERWENDEN

KOLEJNOŚĆ MONTAŻU
MIMOSRODOW I KOLKOW.
THE FITTINGS SEQUENCE OF THE
CAMS AND DOWELS.
DIE MONTAGEABFOLGE VON
EXZENTERN UND DÜBELN.

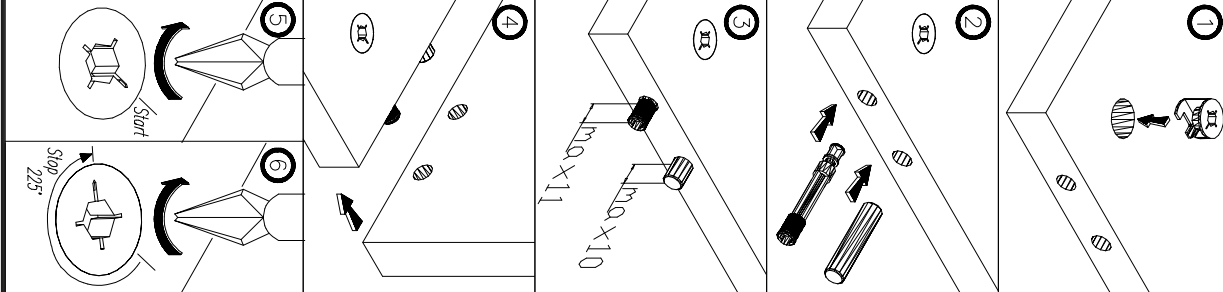

D

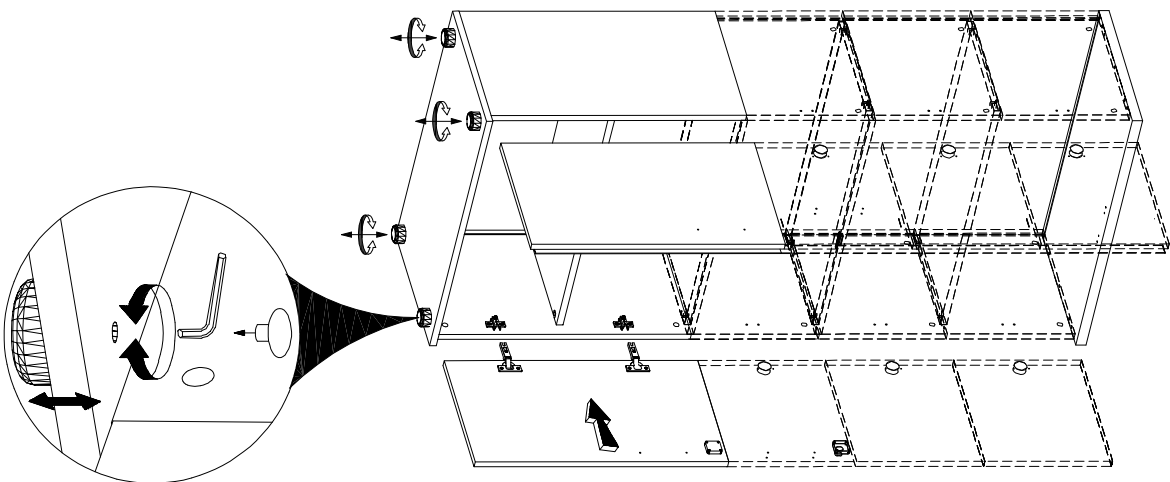

E

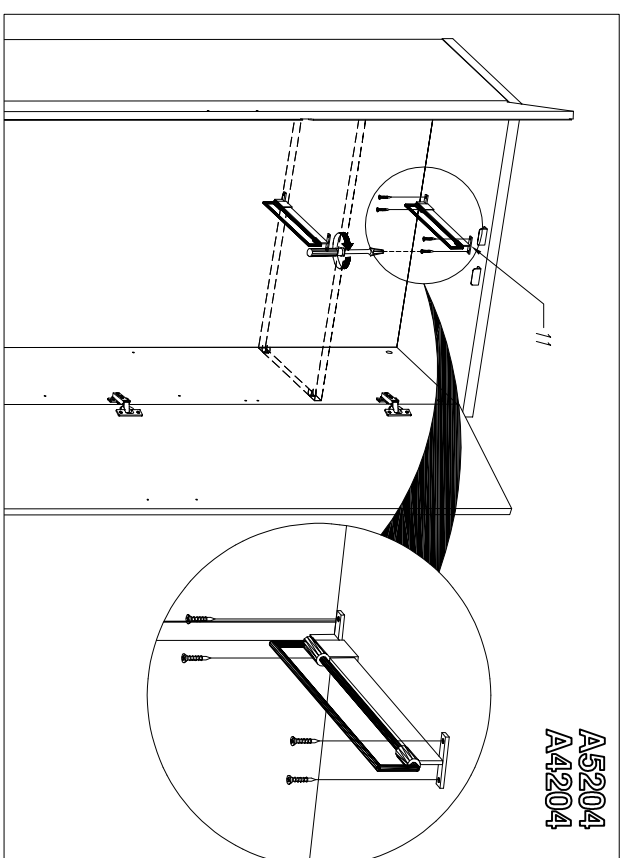
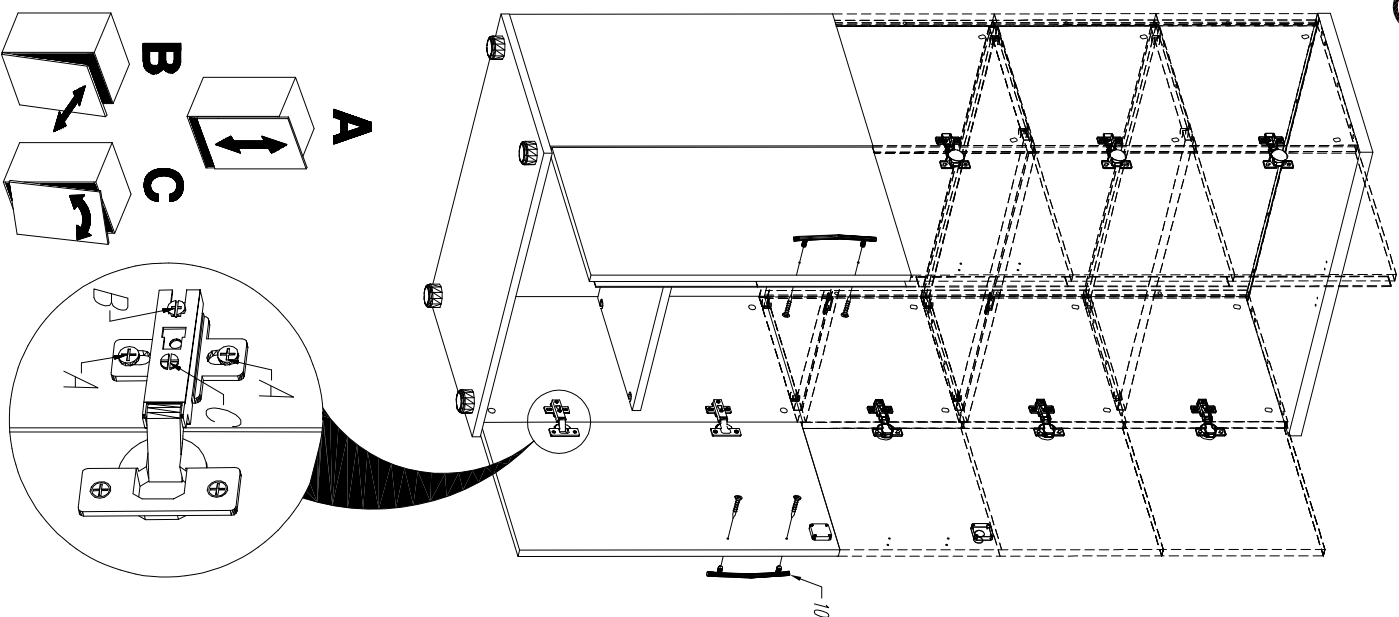

A5204
A4204

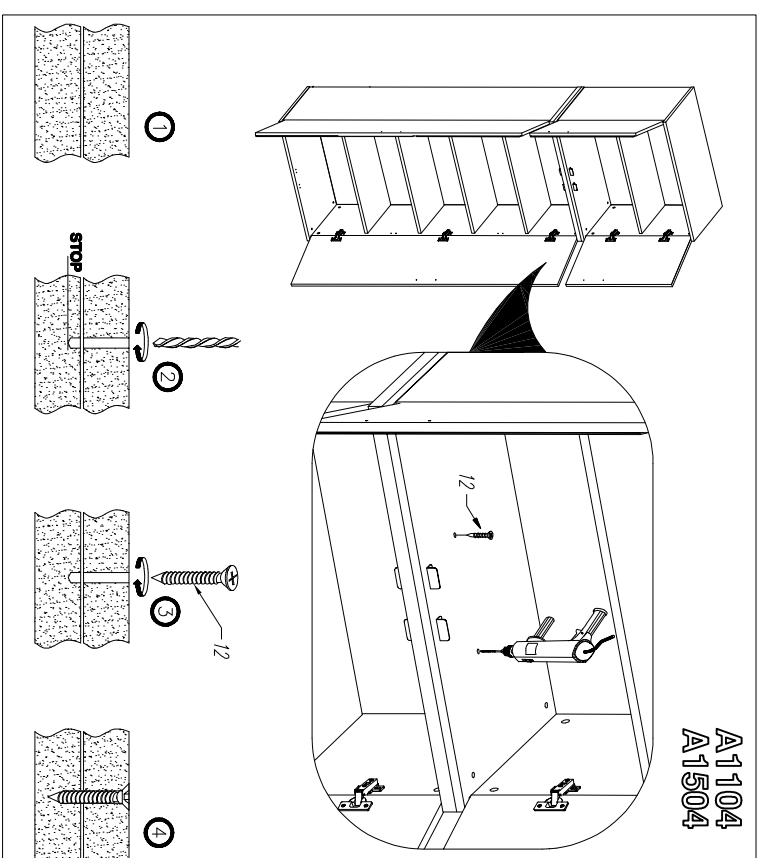

A1104
A1504

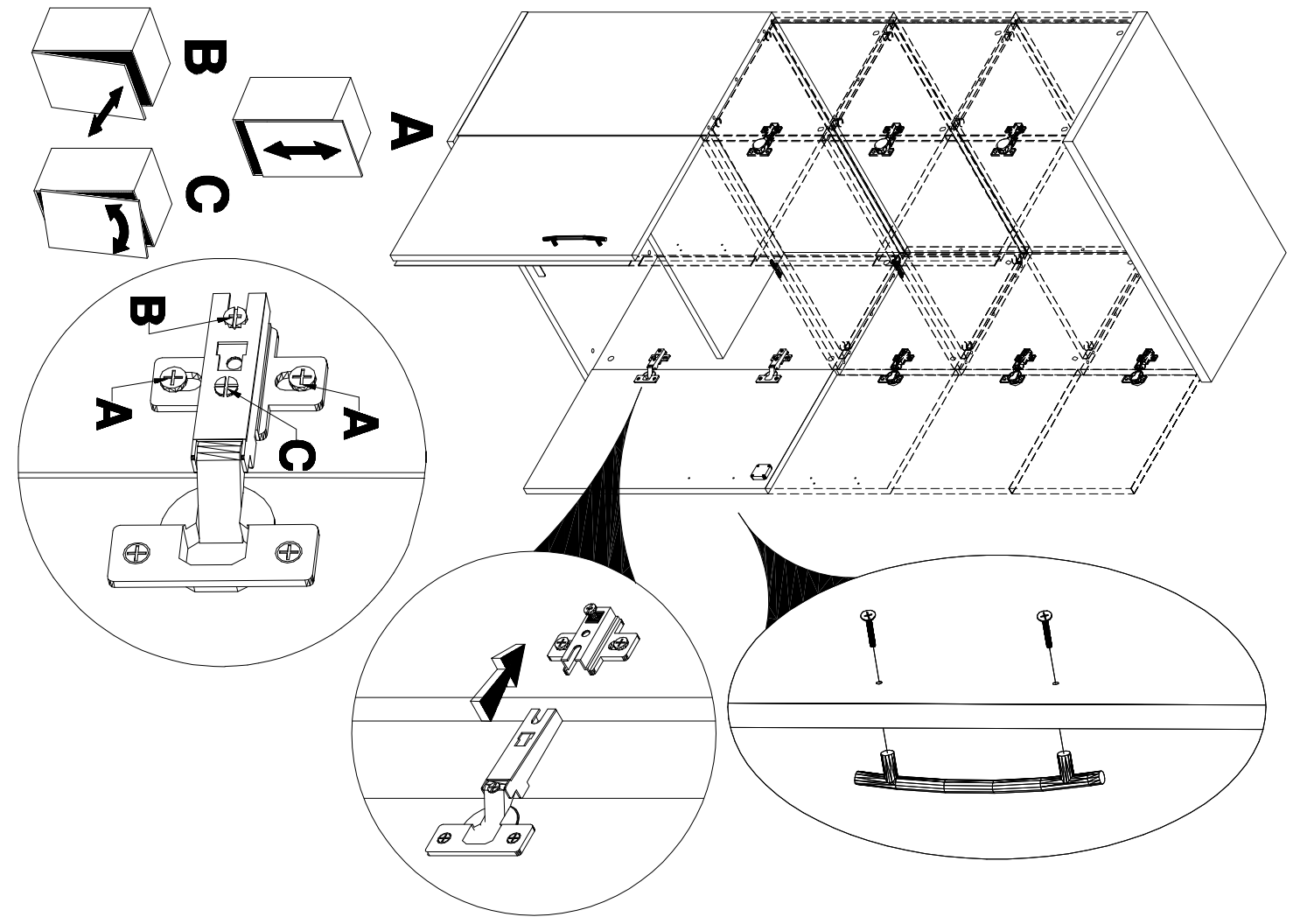
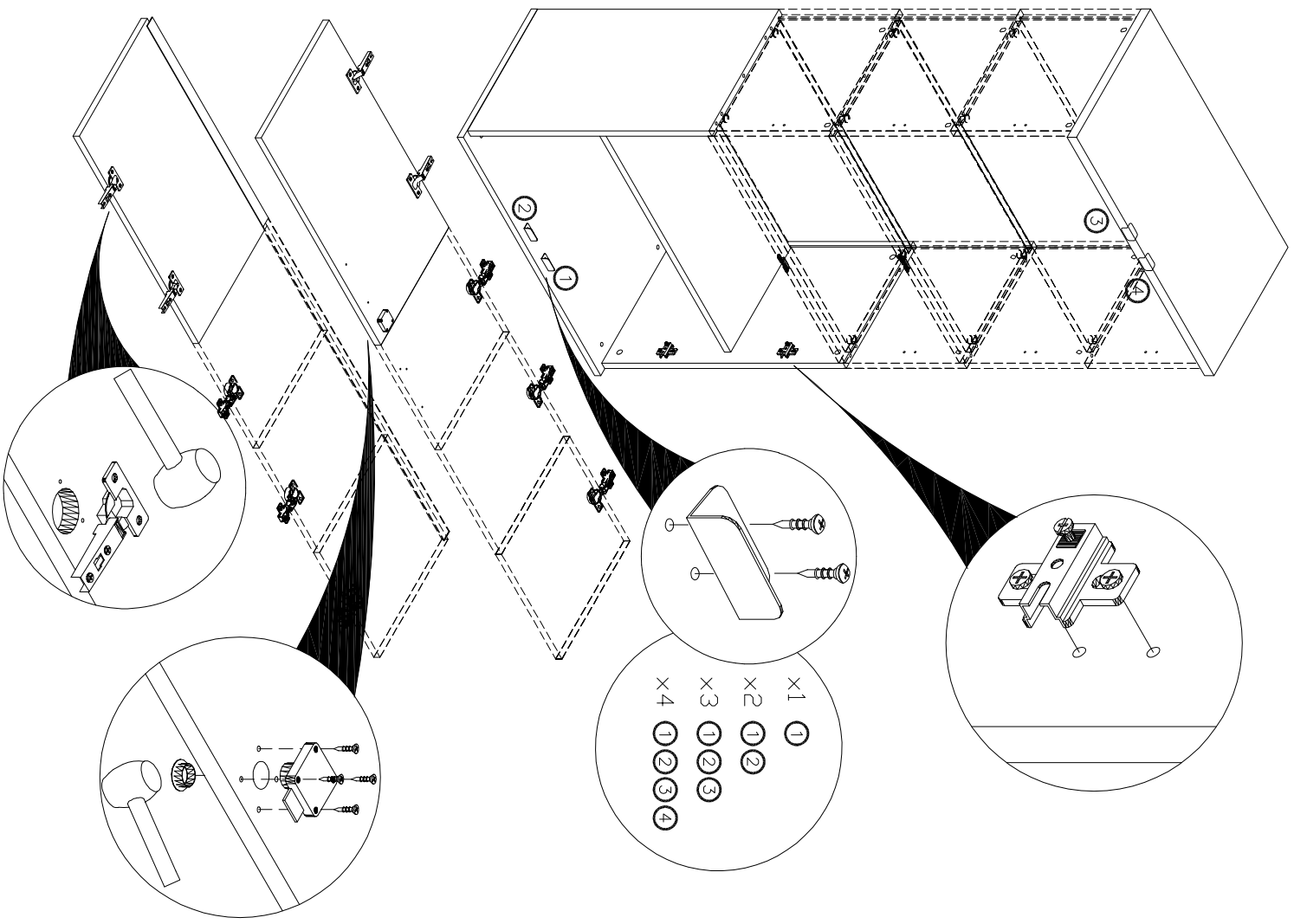

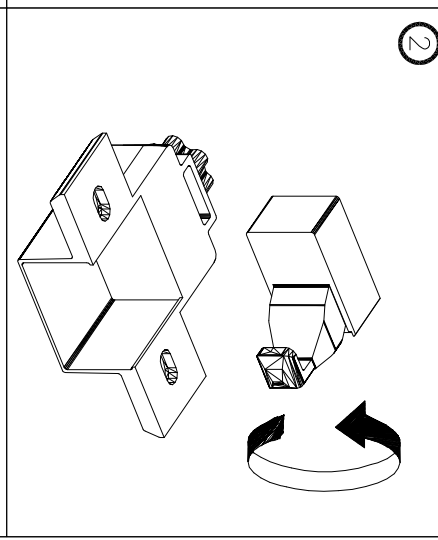
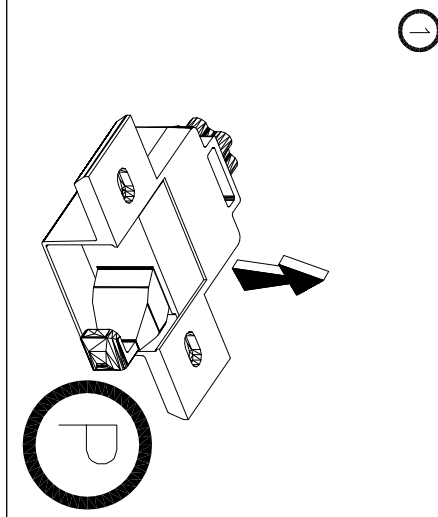
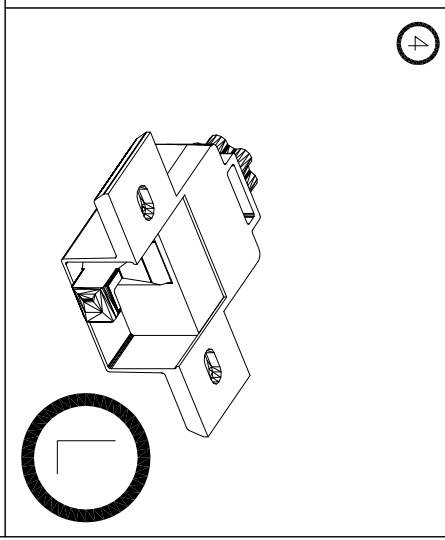
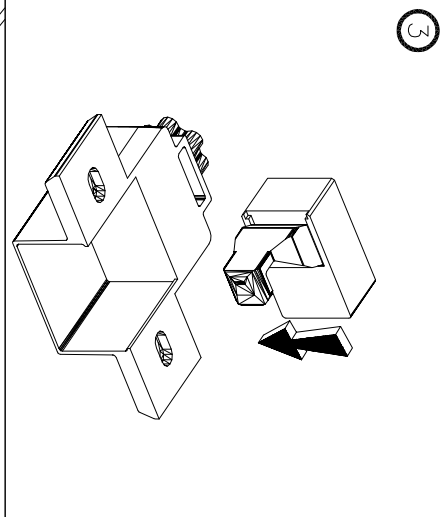
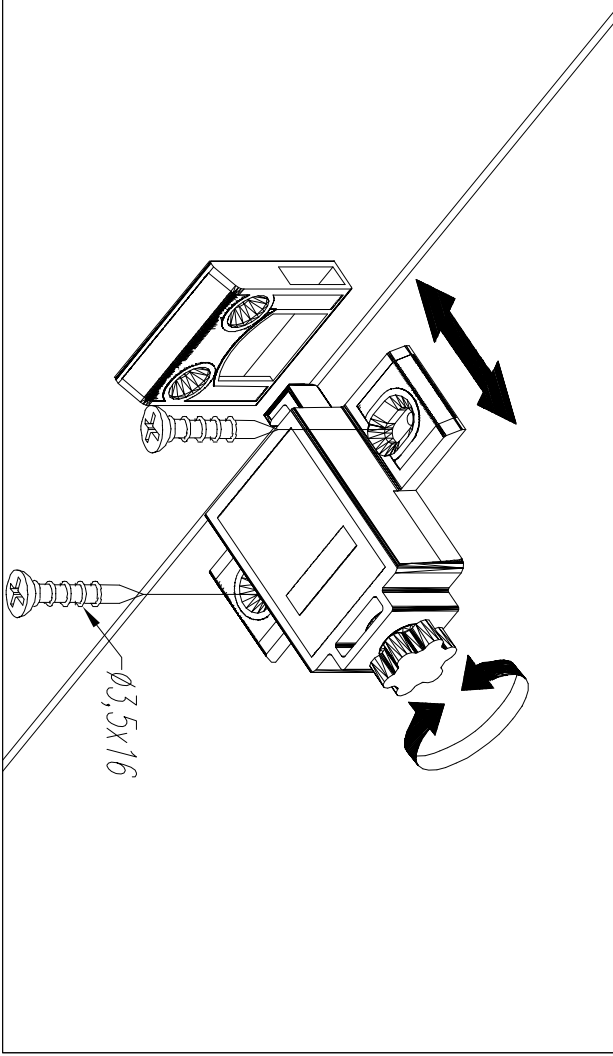
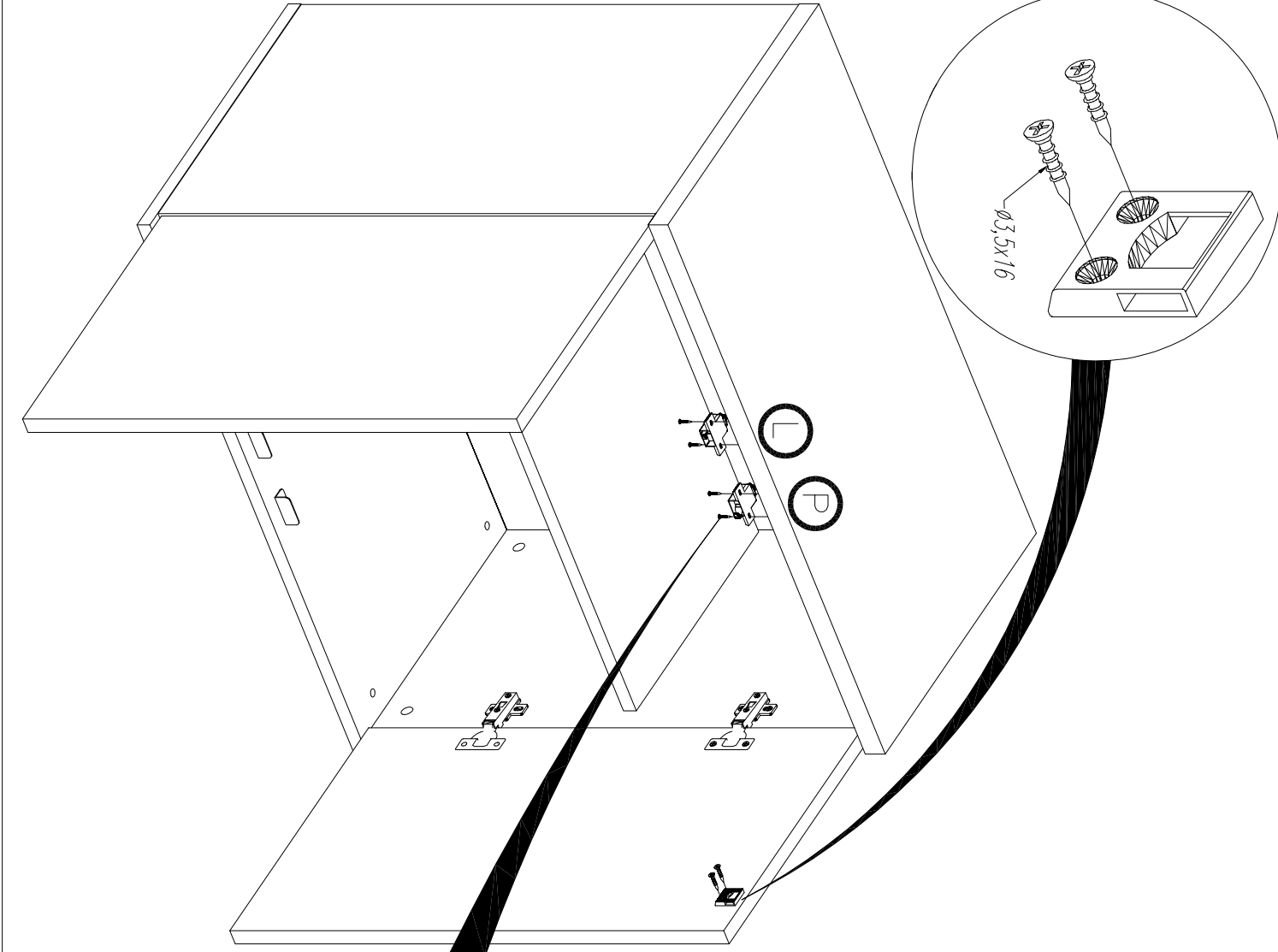

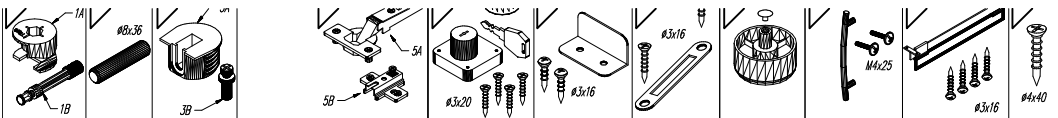

A

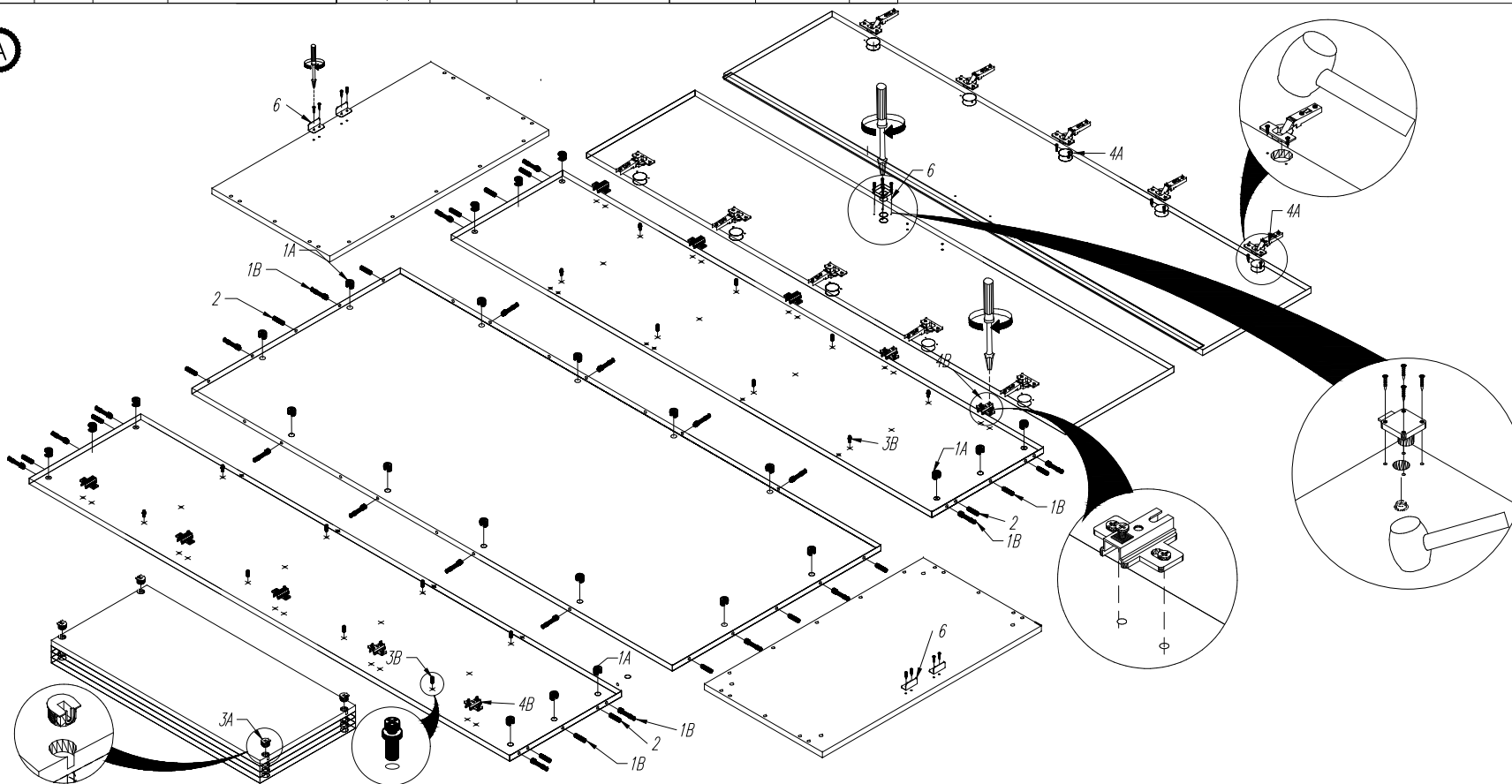

B

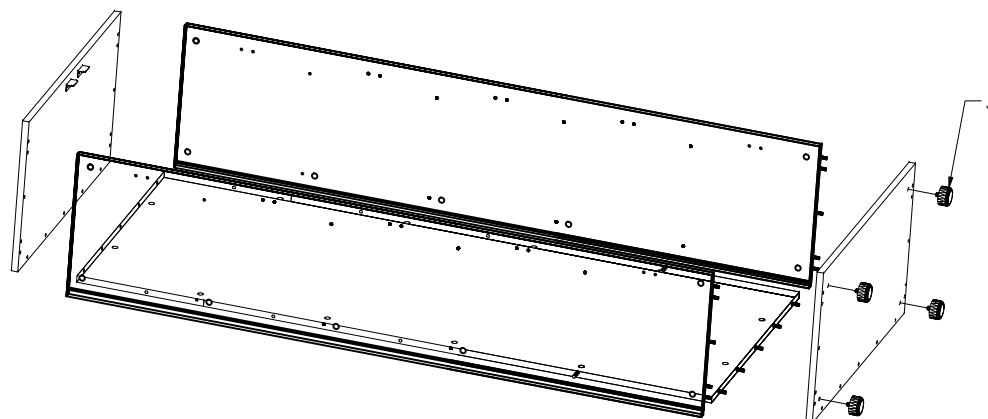

KOLEJNOŚĆ MONTAŻU
MIMOŚRODÓW I KOŁKÓW.
THE FITTINGS SEQUENCE OF THE
CAMS AND DOWELS.
DIE MONTAGEABFOLGE VON
EXZENTERN UND DÜBELN.

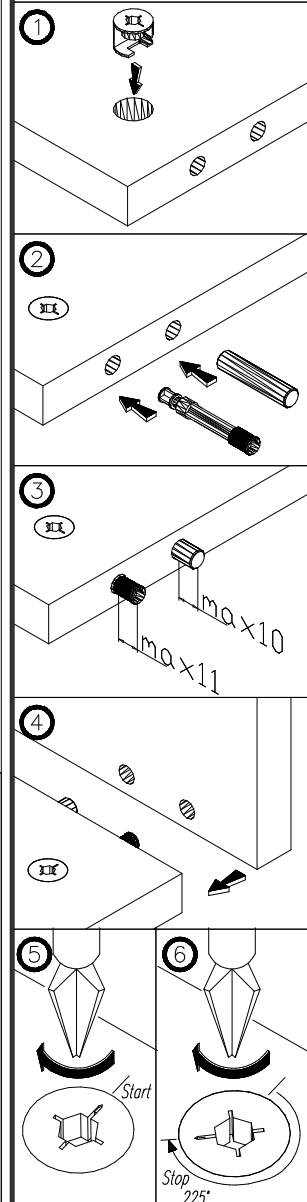

C

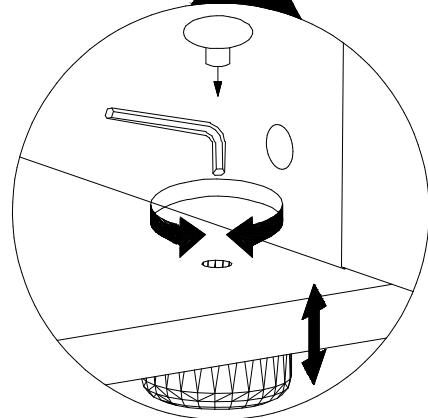
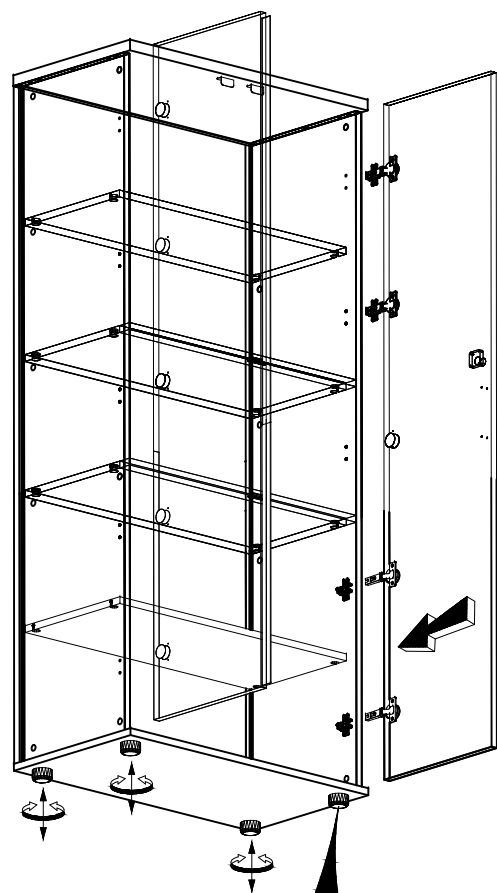

D

