

4x

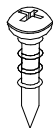

6X

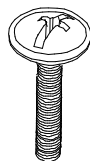

2x

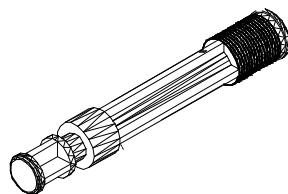

22x

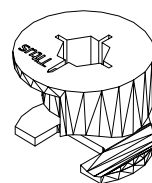

22x

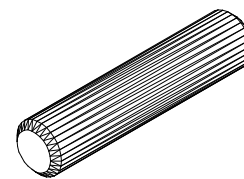

12x



4x

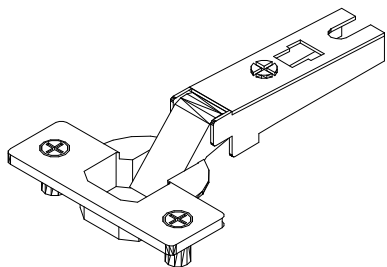

2x

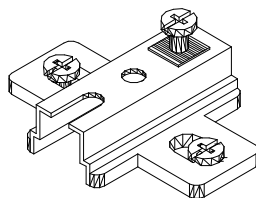

2x

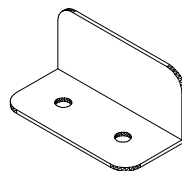

1x

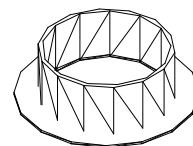

1x

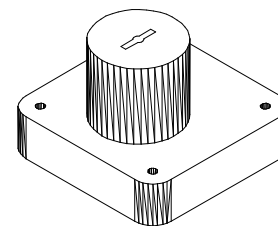

1x

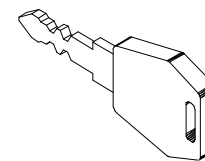

1x

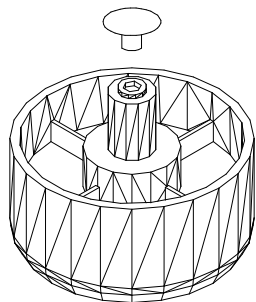

4x

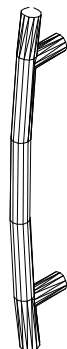

1x

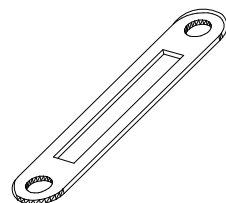

1x

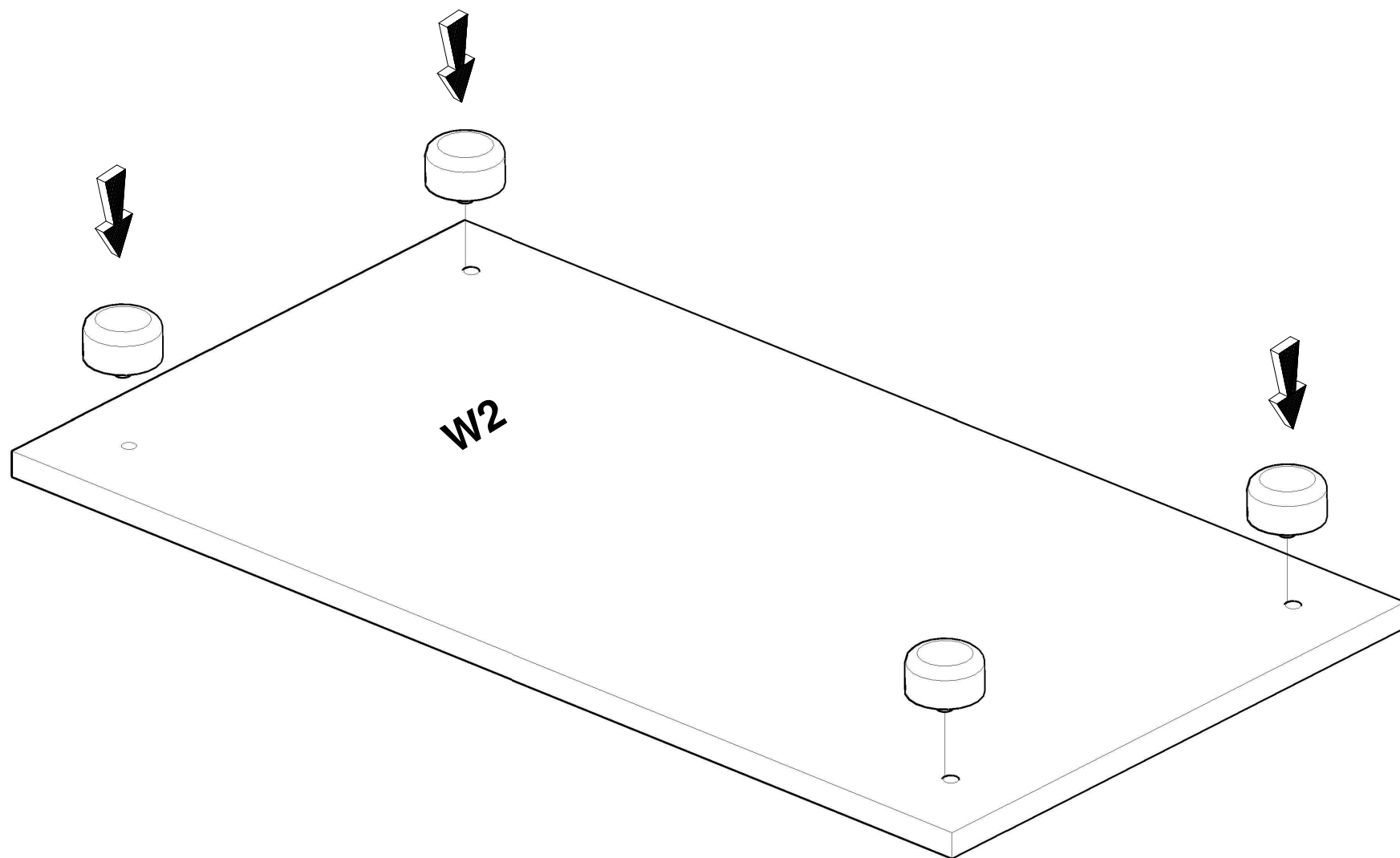

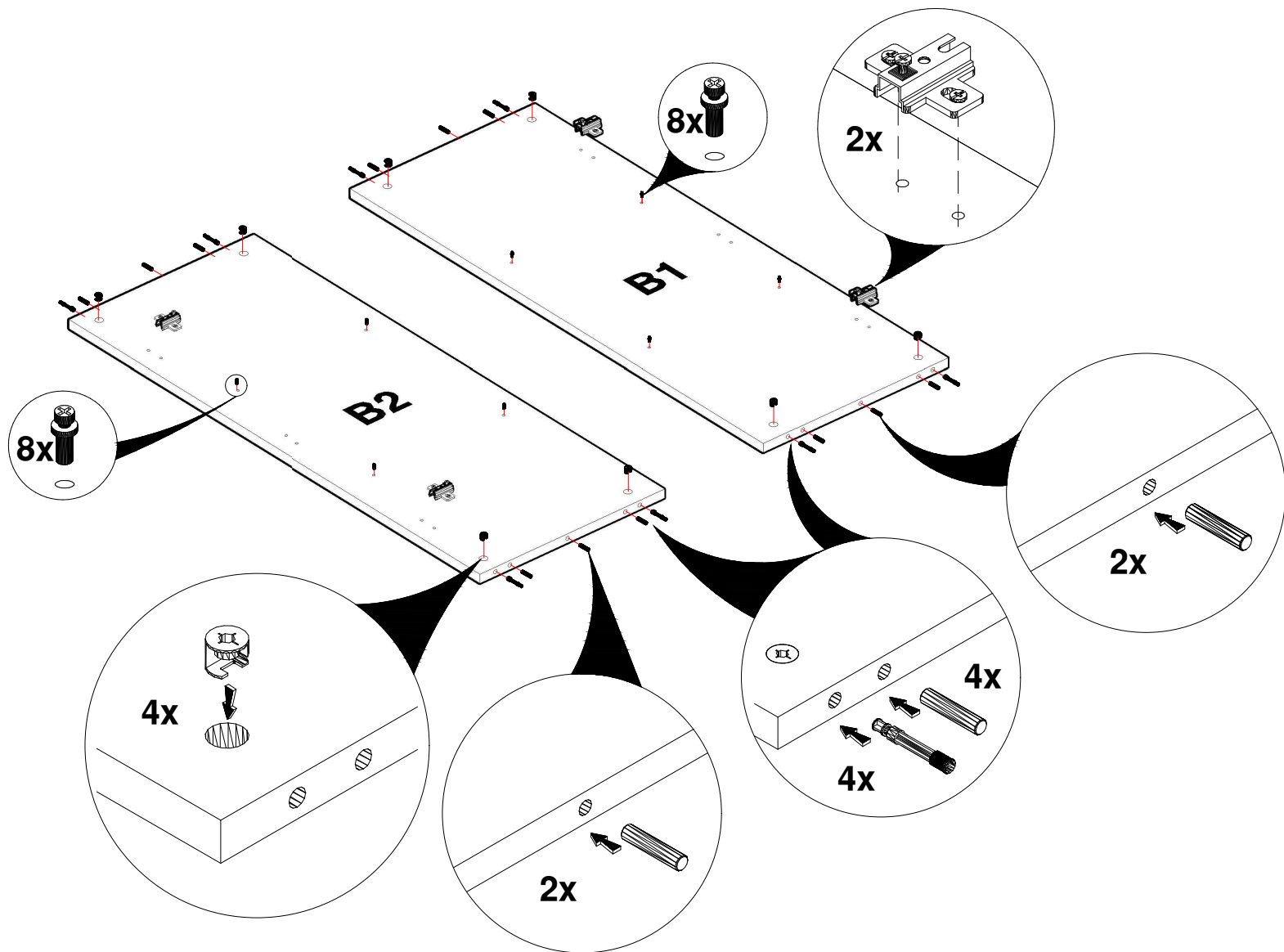

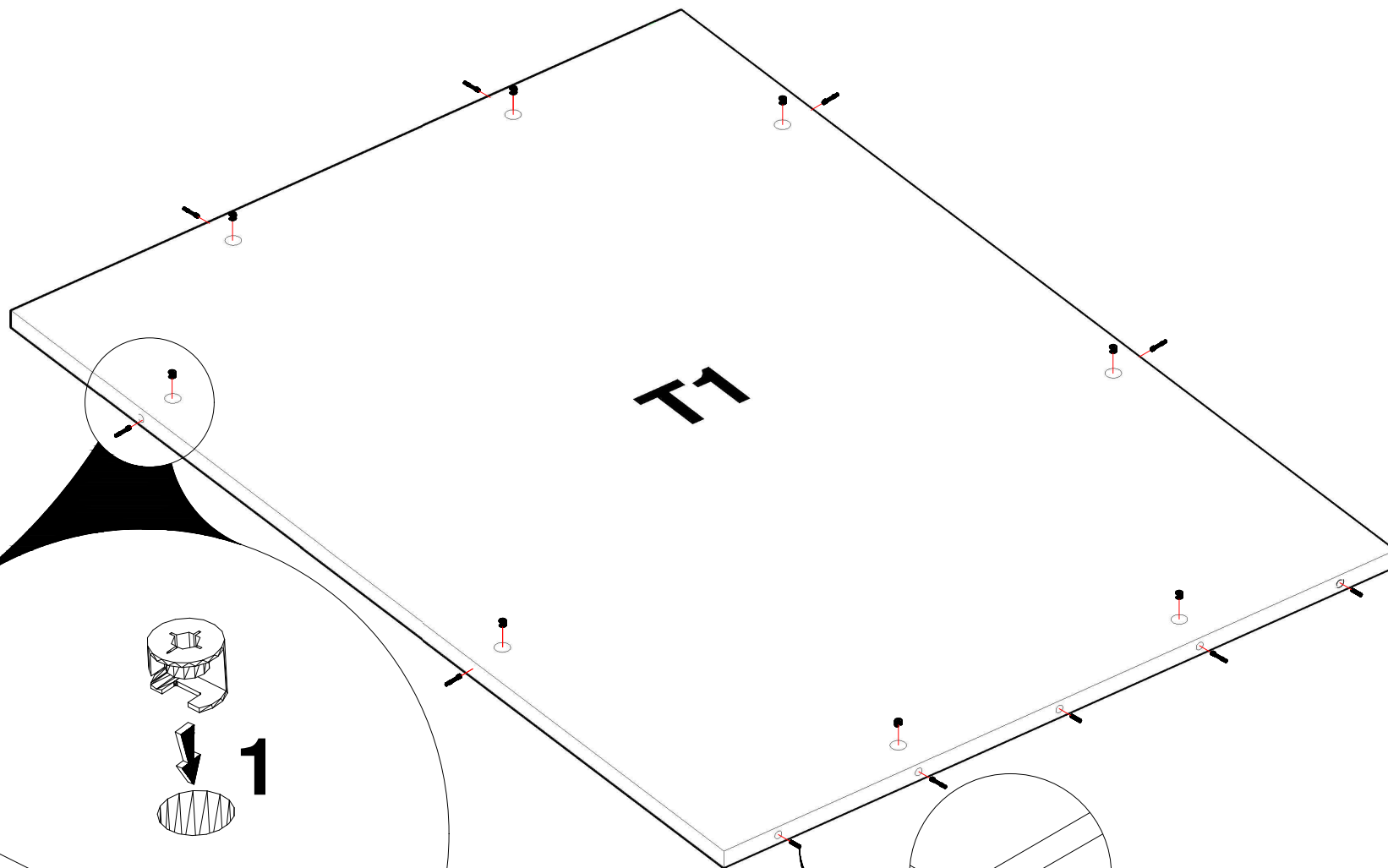

11

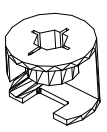

1

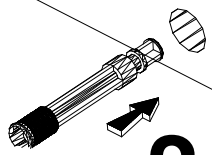

2

7

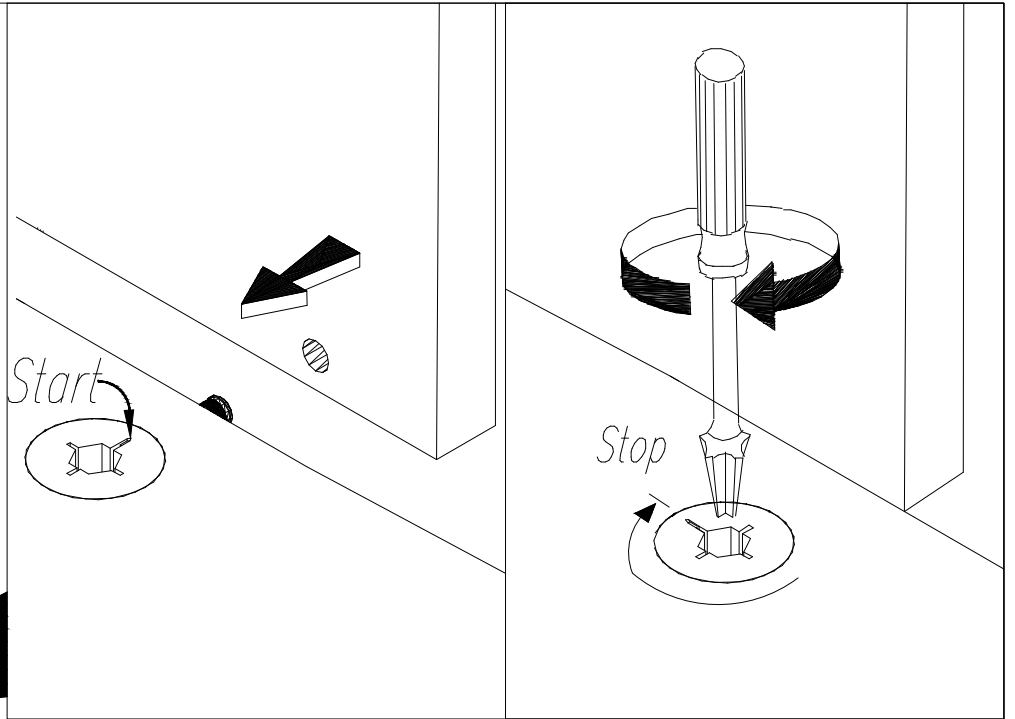
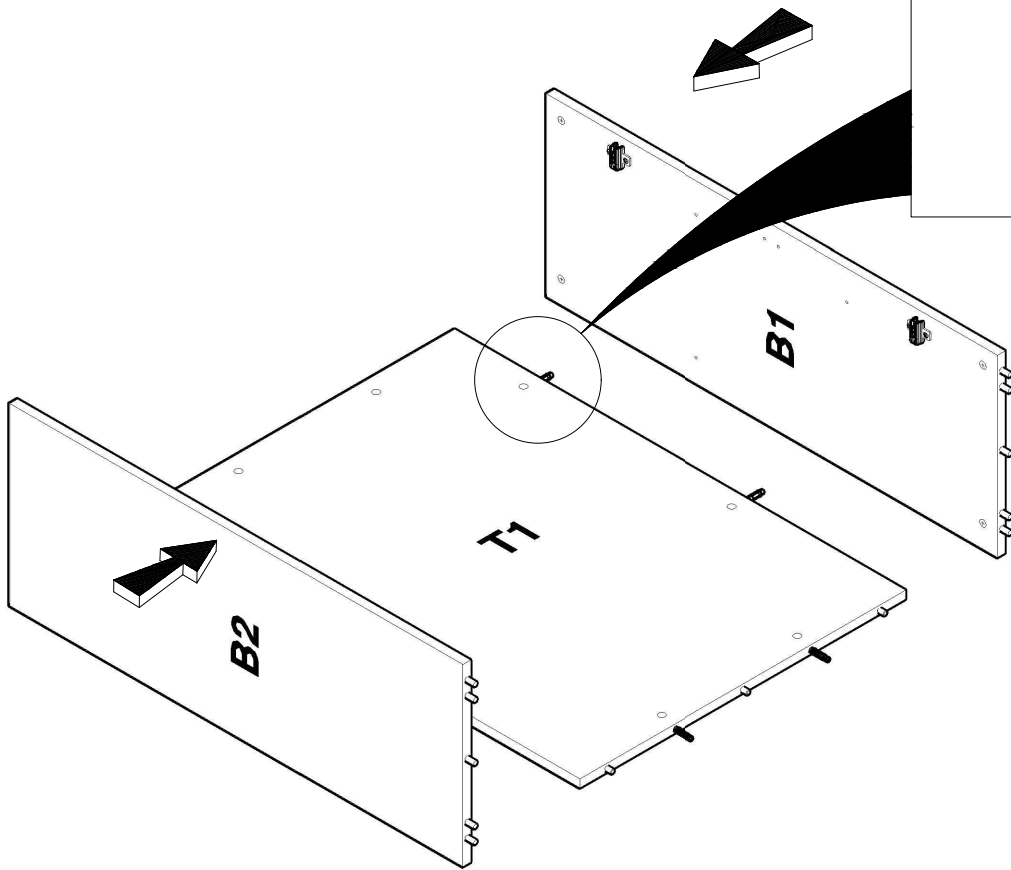

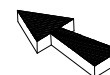
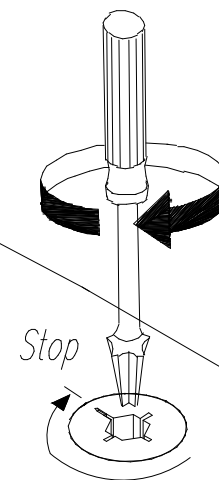
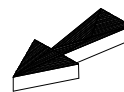
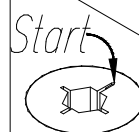
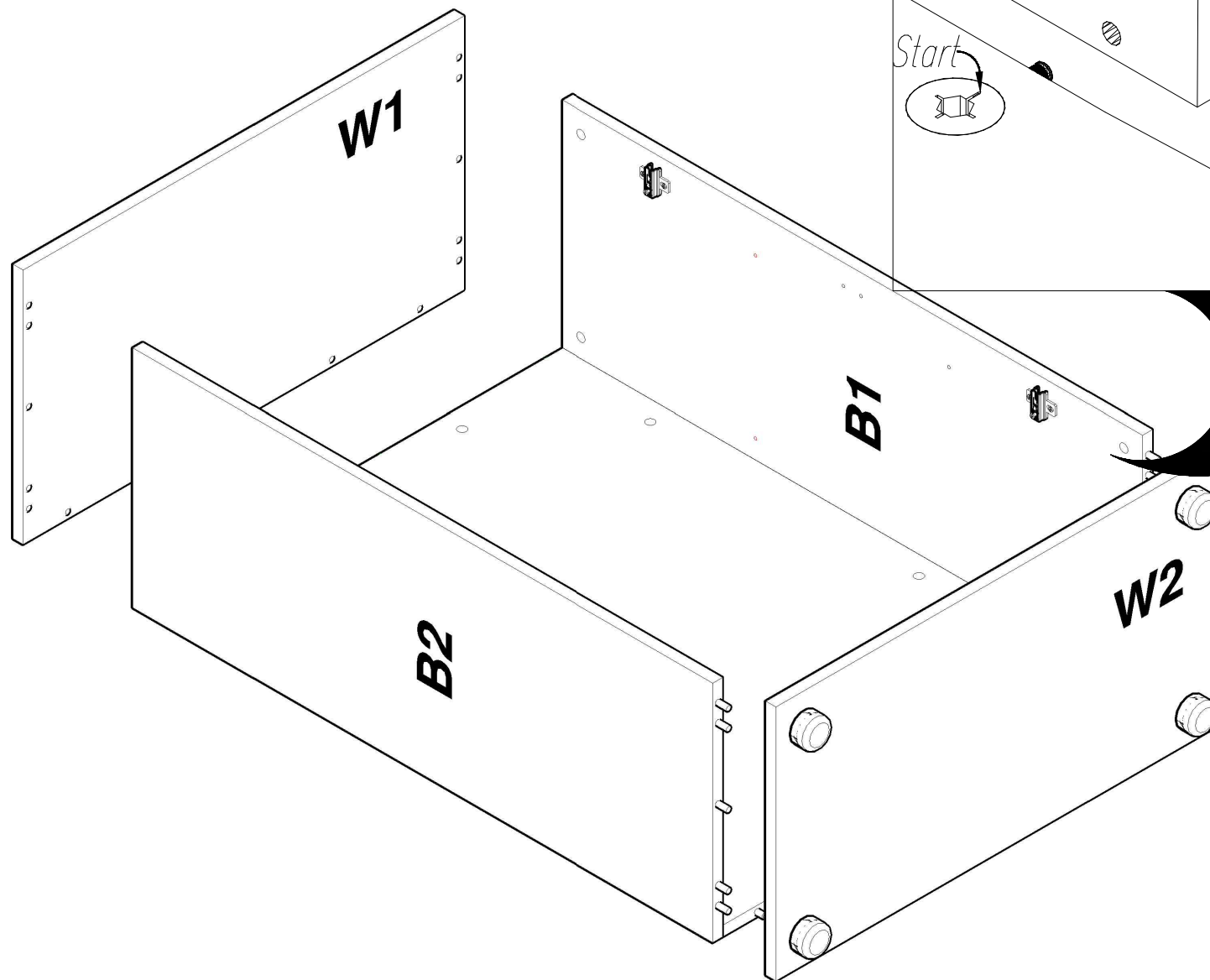
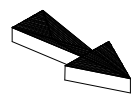

10

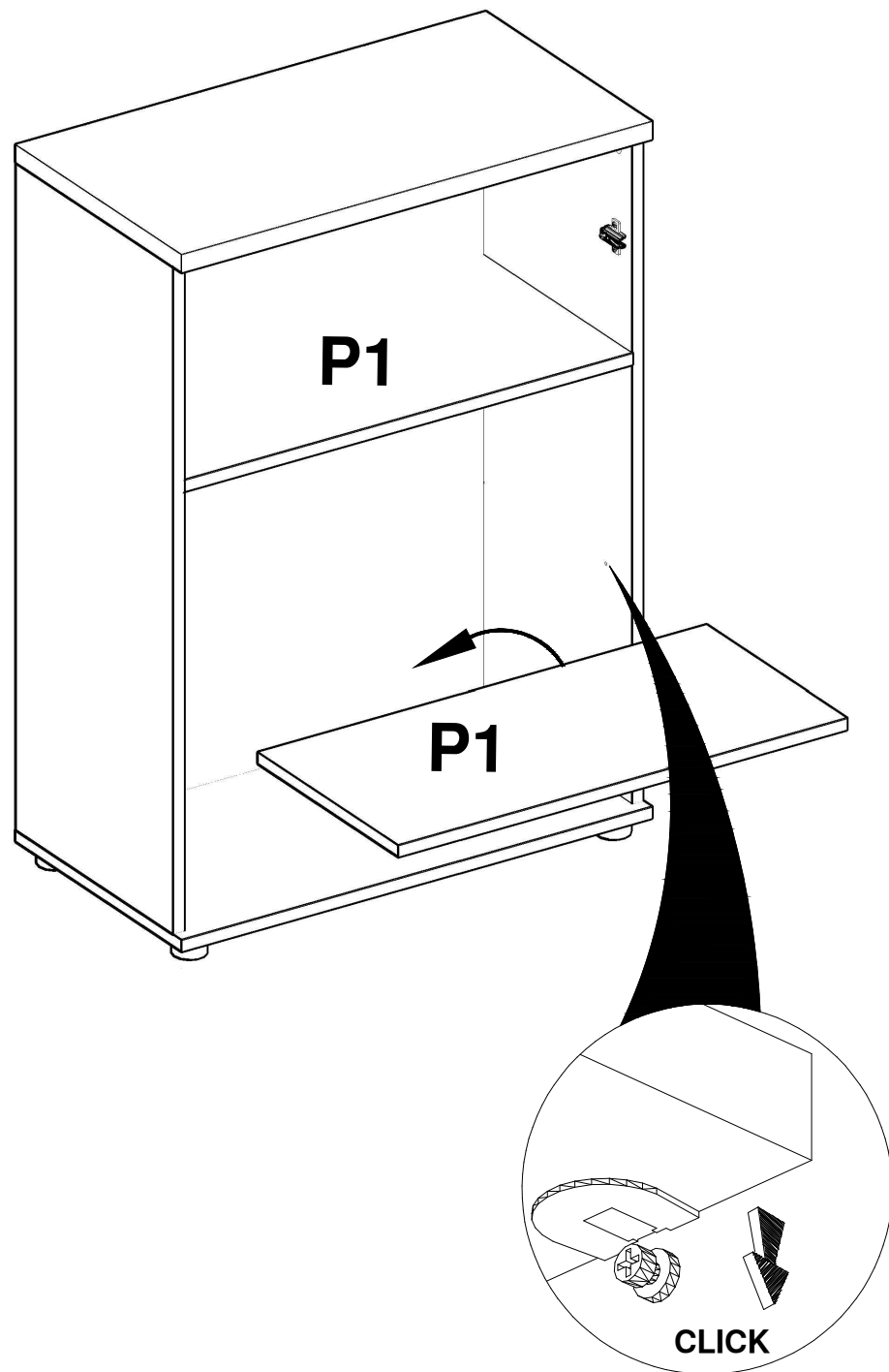
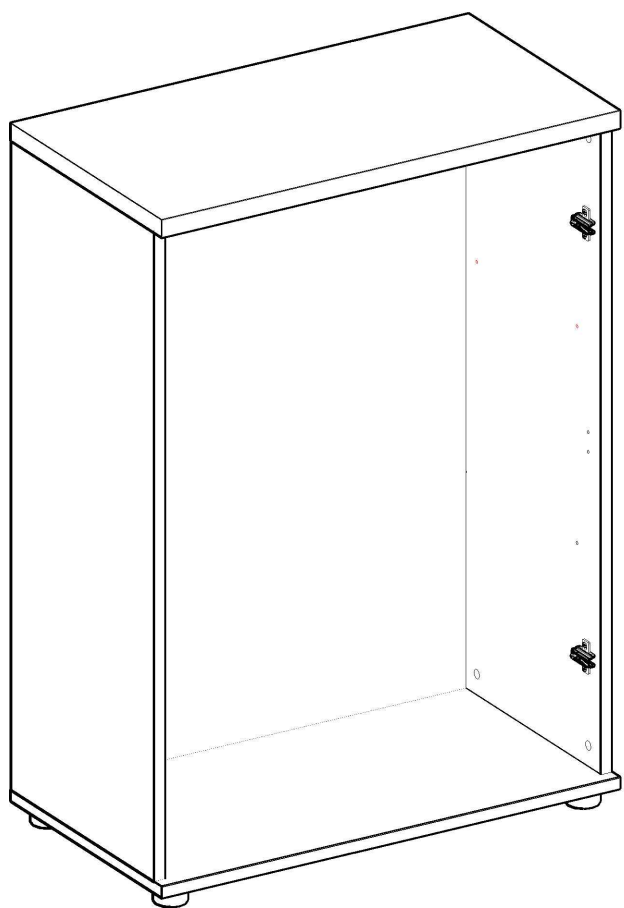

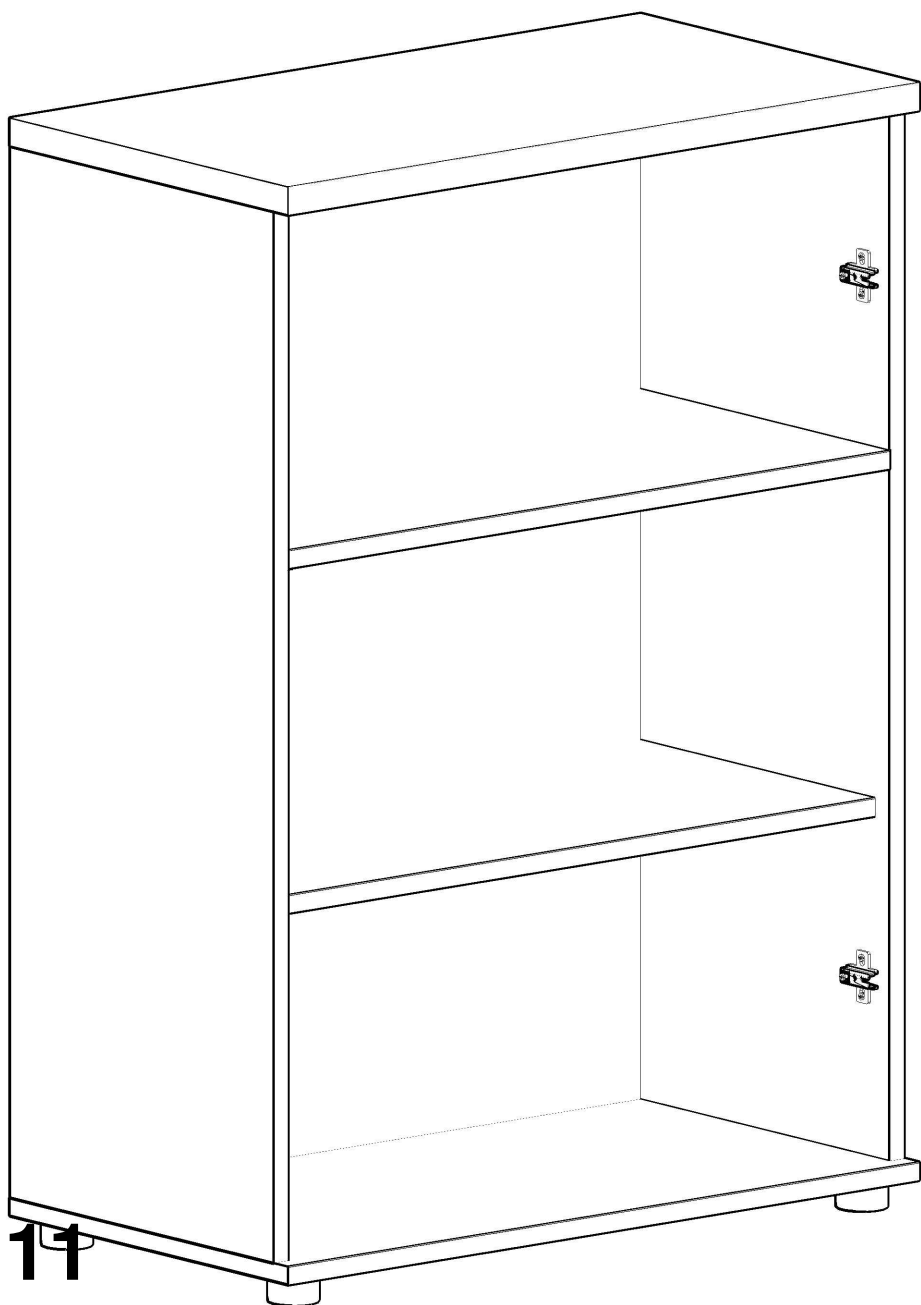

11

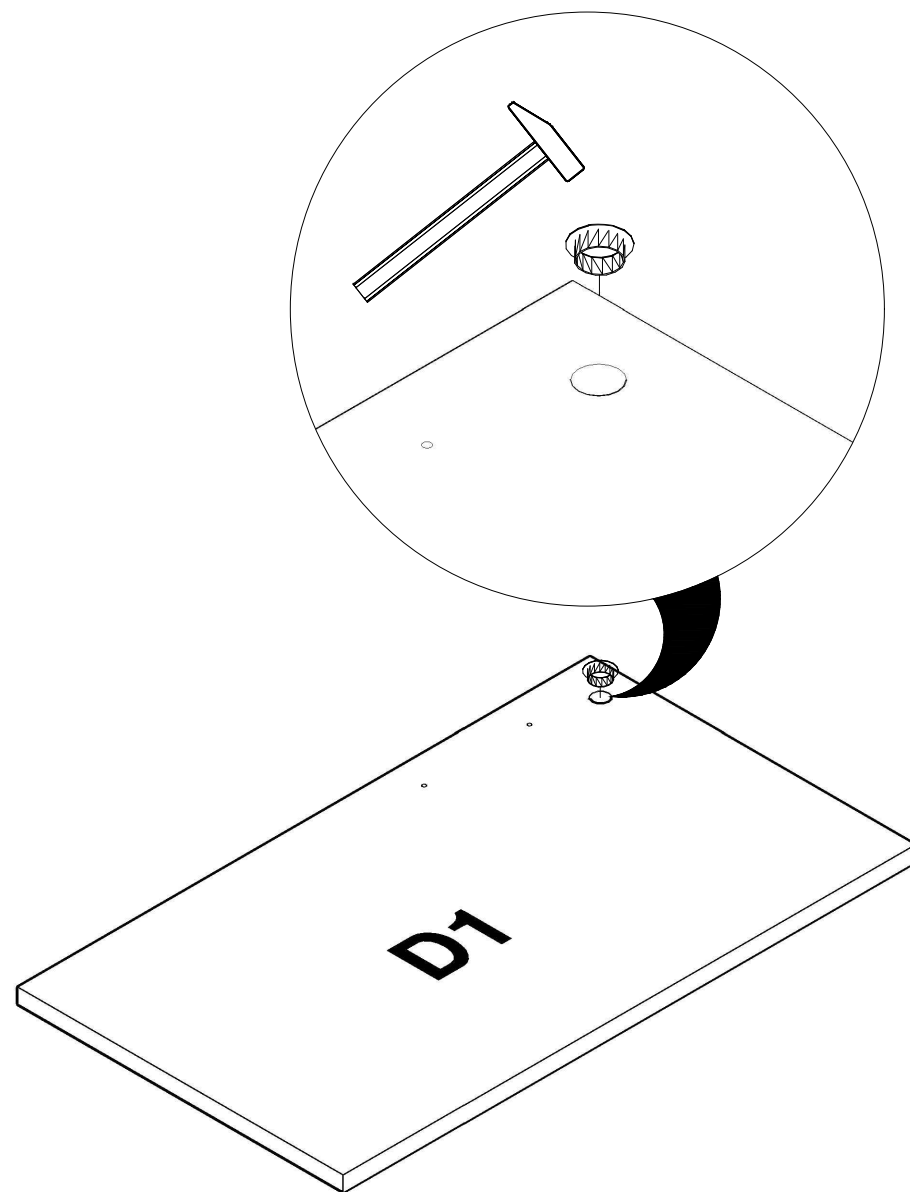

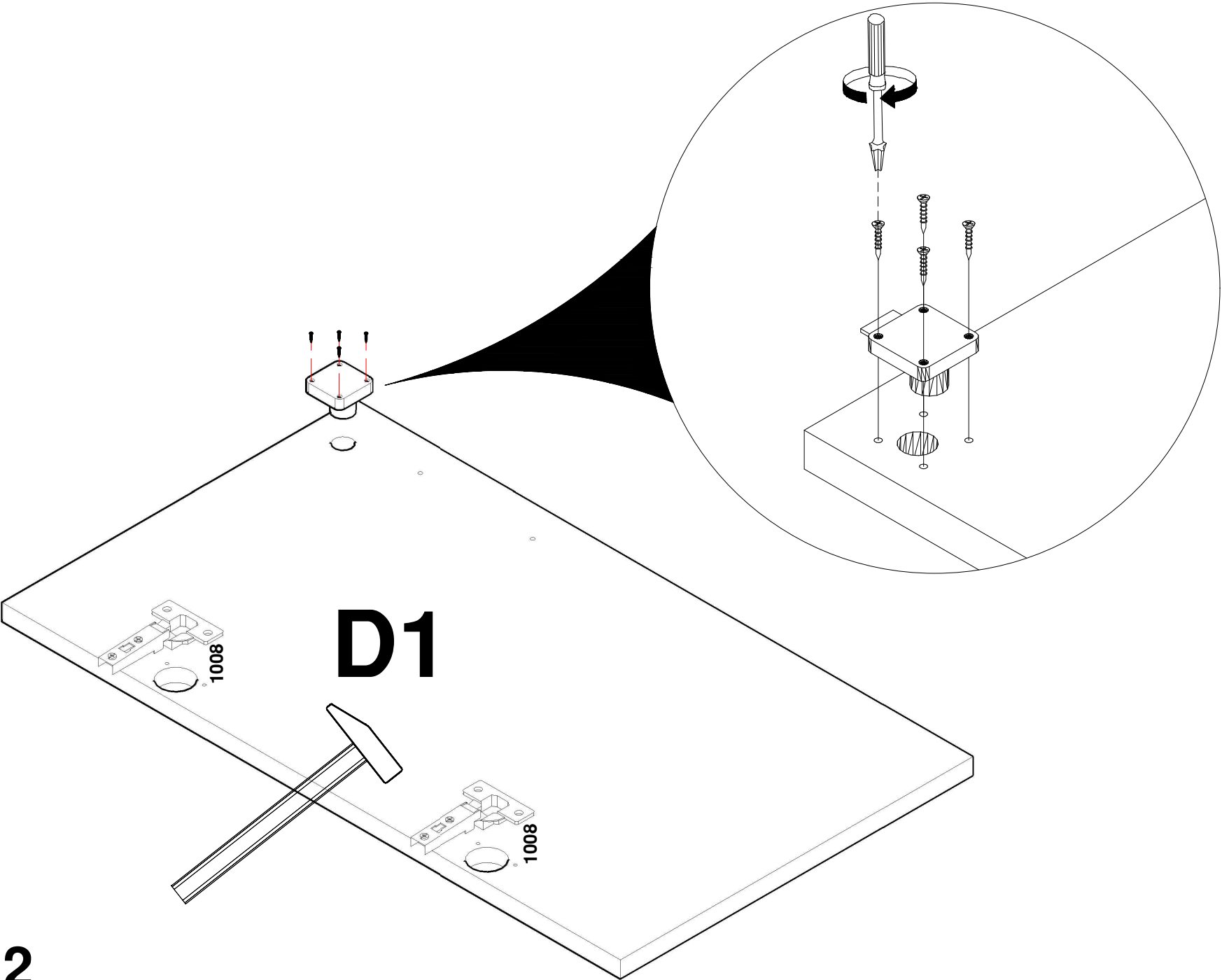

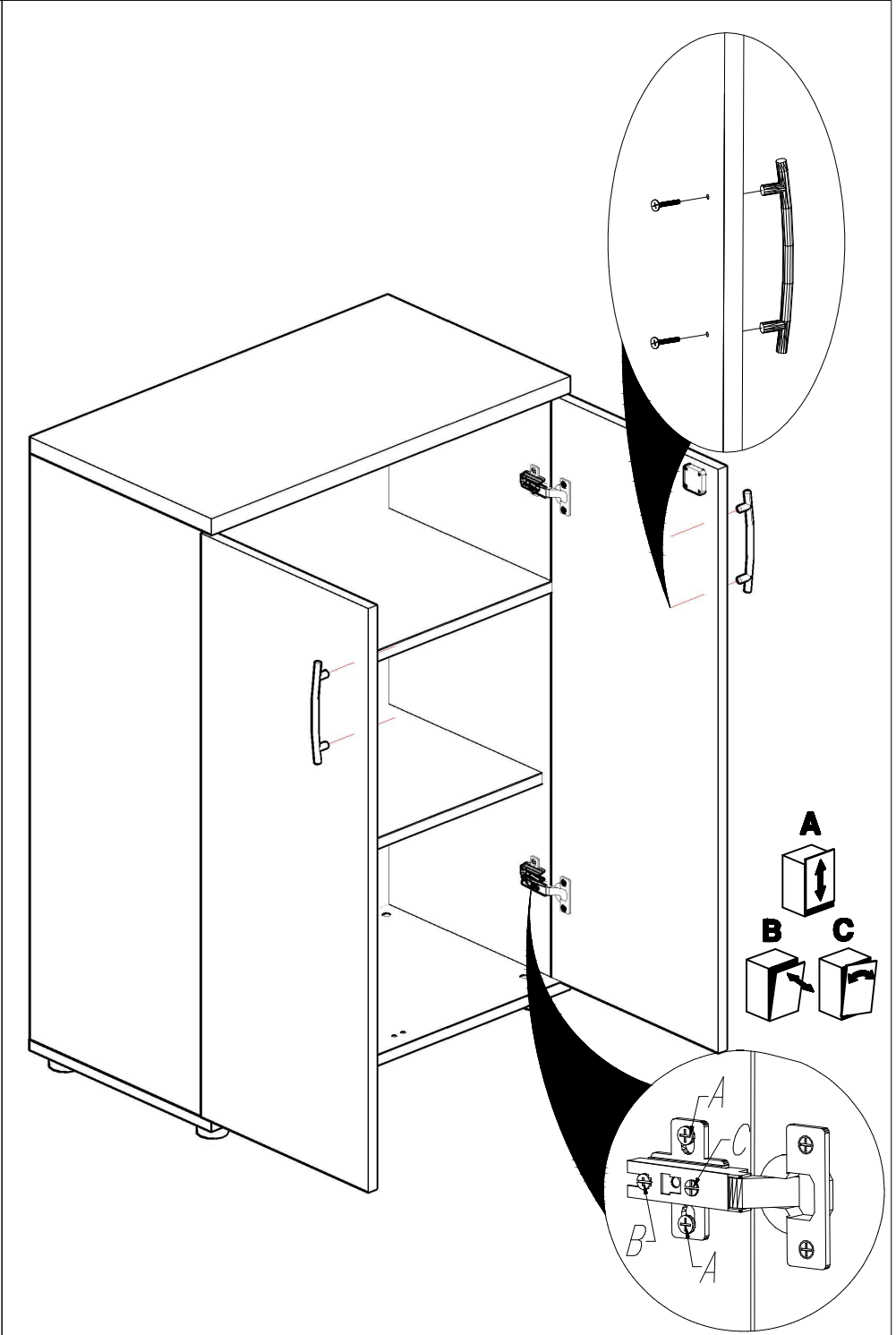
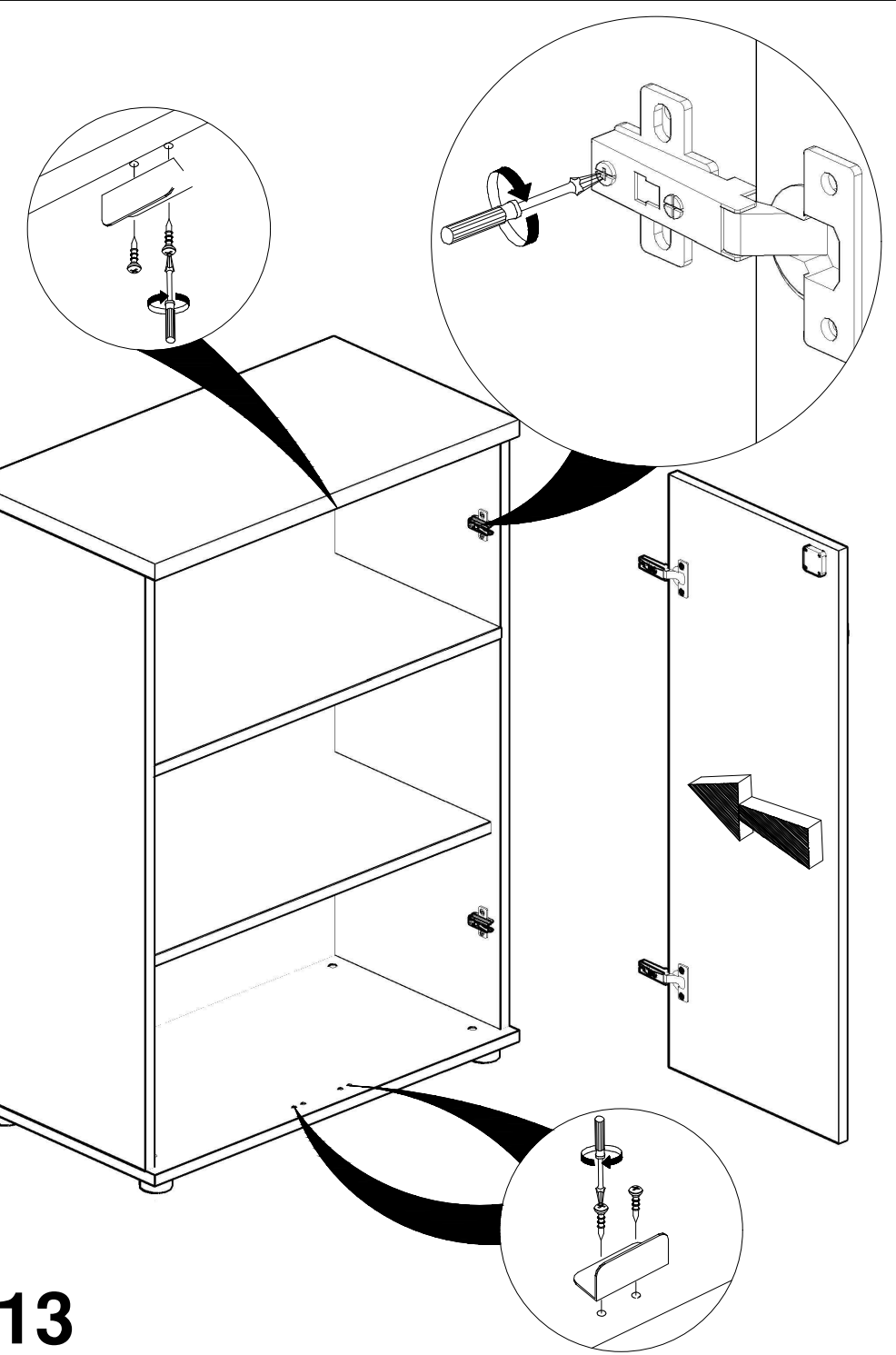

A

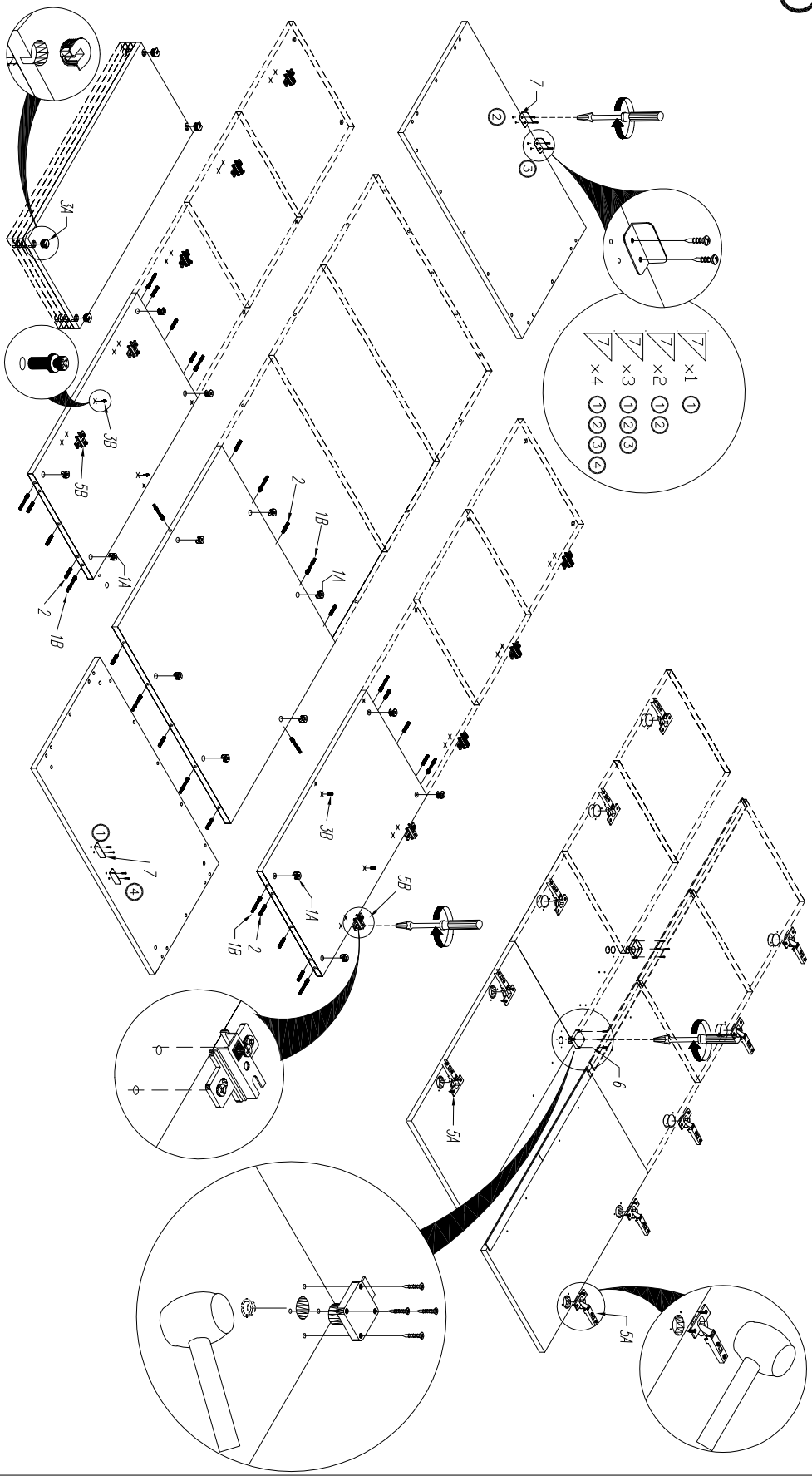

B

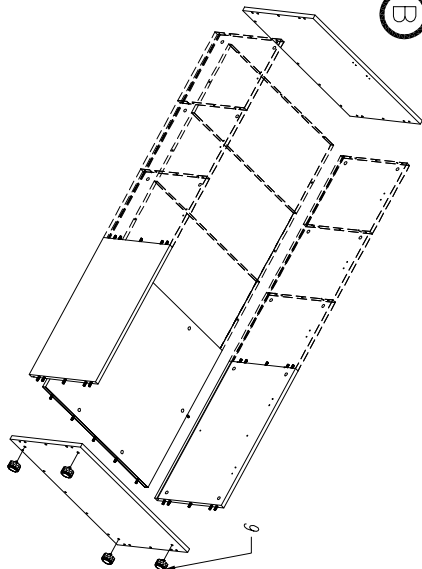

C

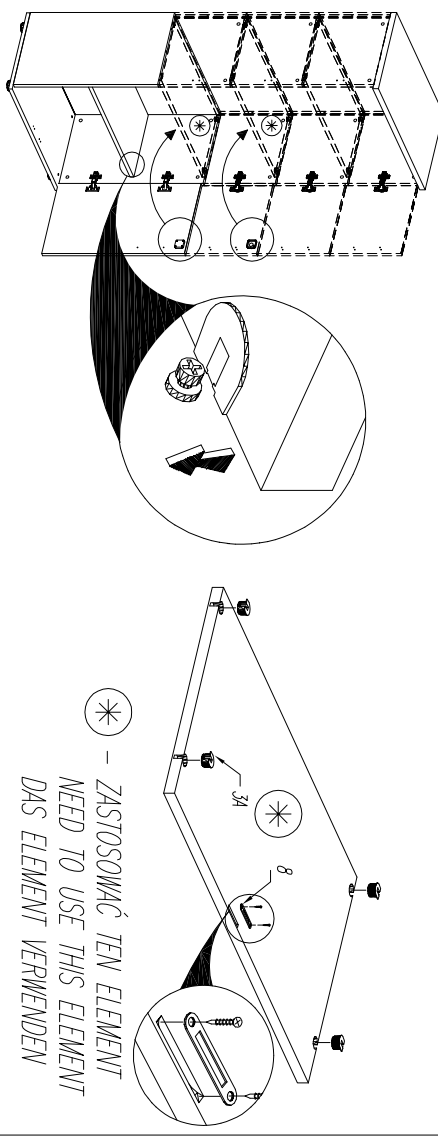

KOLEJNOŚĆ MONTAŻU
MIMOSRODOW I KOLKOW.
THE FITTINGS SEQUENCE OF THE
CAMS AND DOWELS.
DIE MONTAGEABFOLGE VON
EXZENTERN UND DÜBELN.

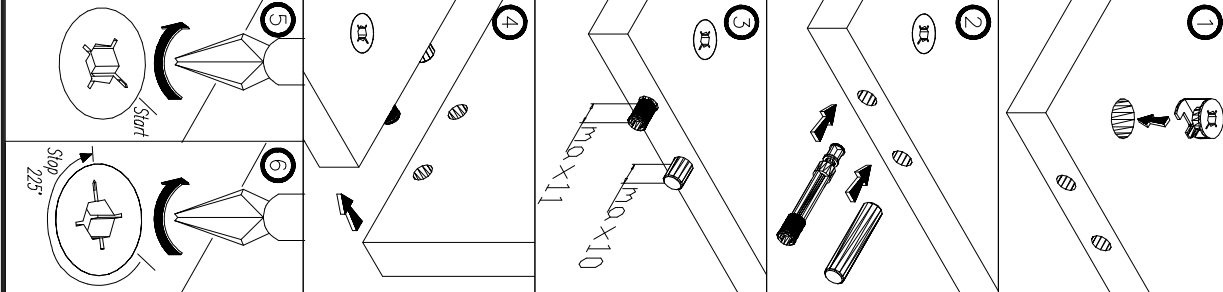

D

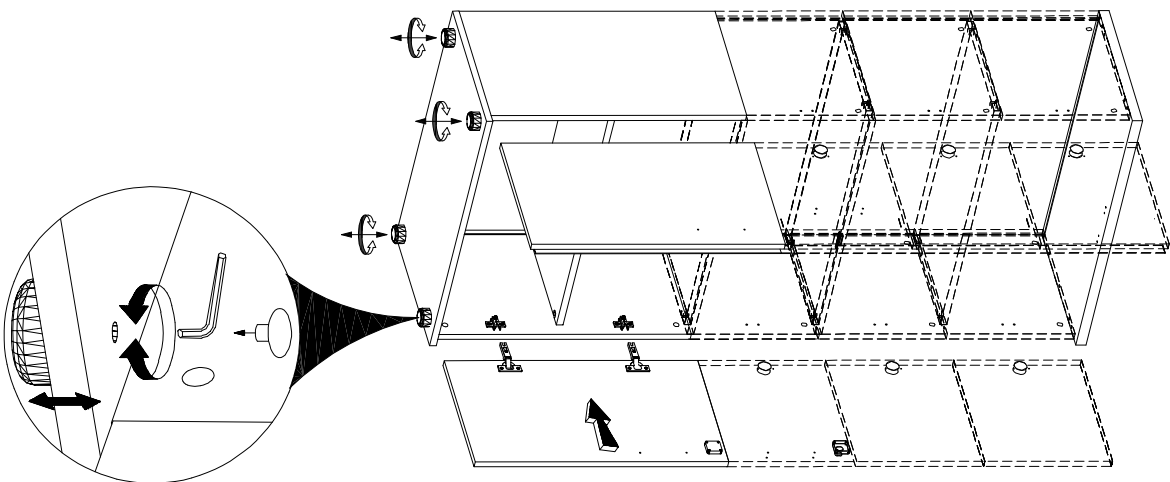

E

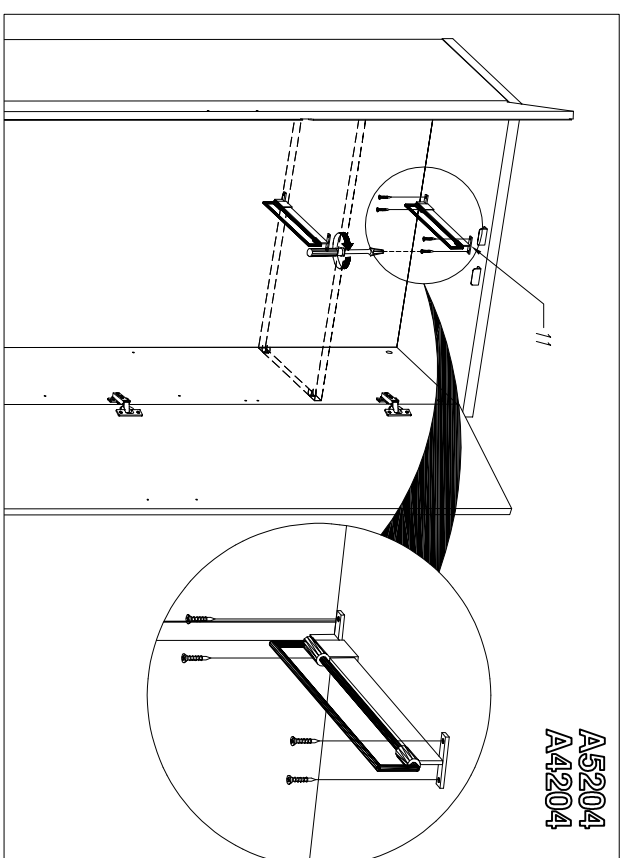
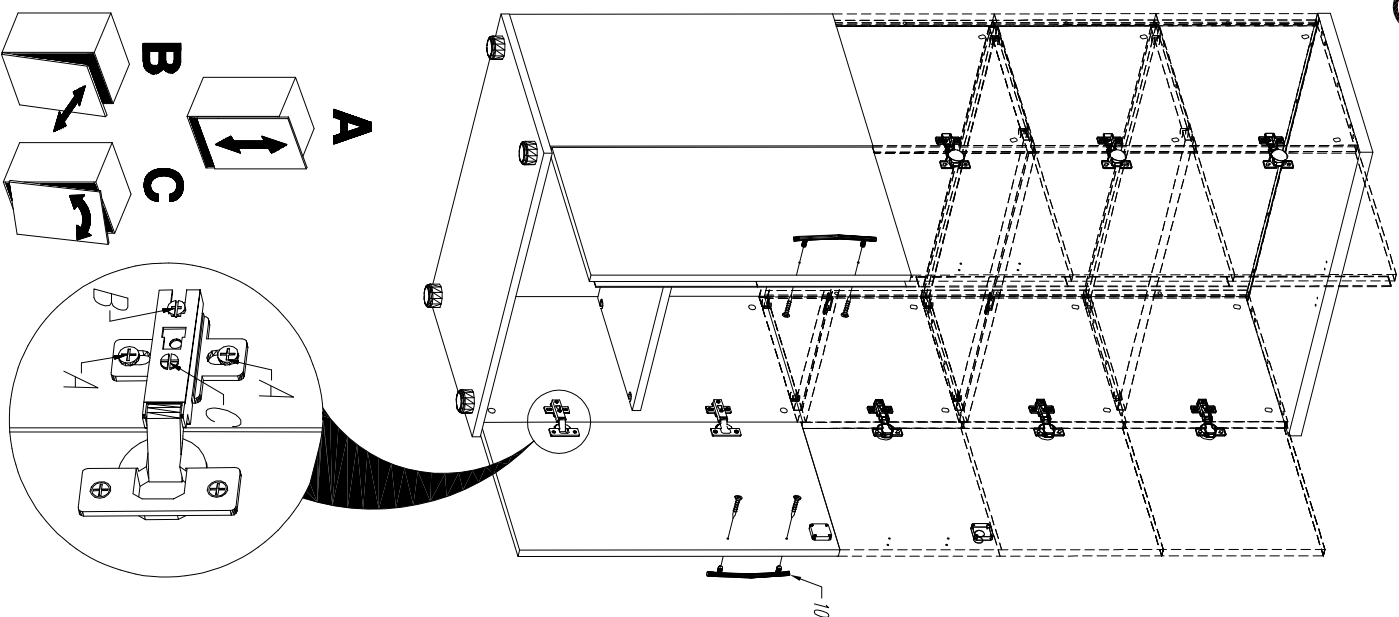

A5204
A4204

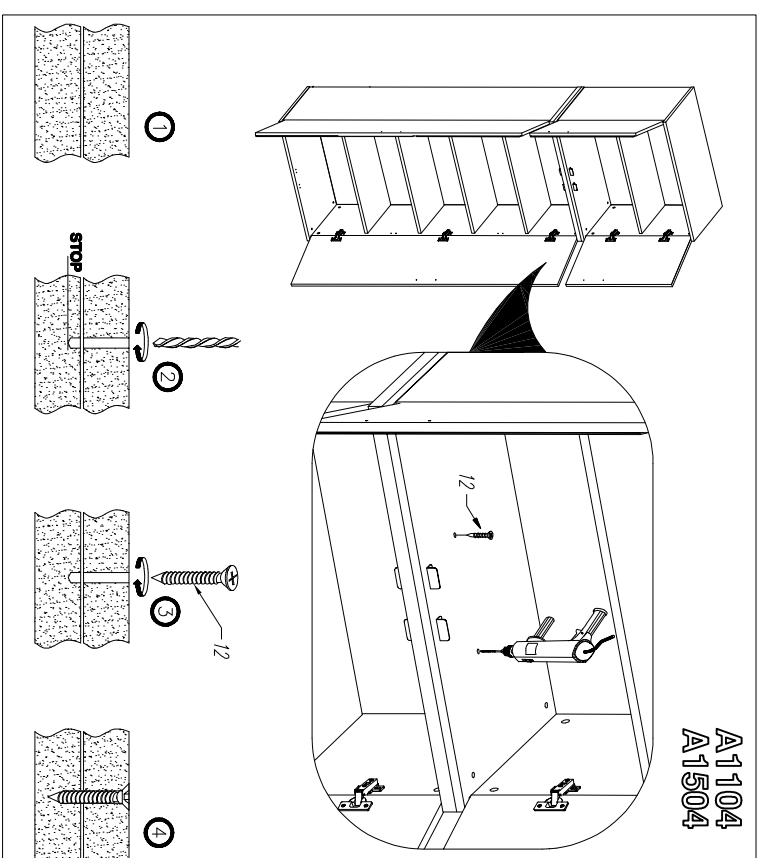

A1104
A1504

